

SURVEY BY: KUNIGLER BOOK 426
DRAWN BY: BERRY
CHECKED BY: ANLE

SURVEY BY: KUNIGLER BOOK 422
DRAWN BY: BERRY
CHECKED BY: ANLE

B.M. 106.65 TOP OLD CB. N.L. WALKER & W.C.B. HIRAM

B.M. 153.40 STD. N.E. COR. LINCOLN & WOODLAWN

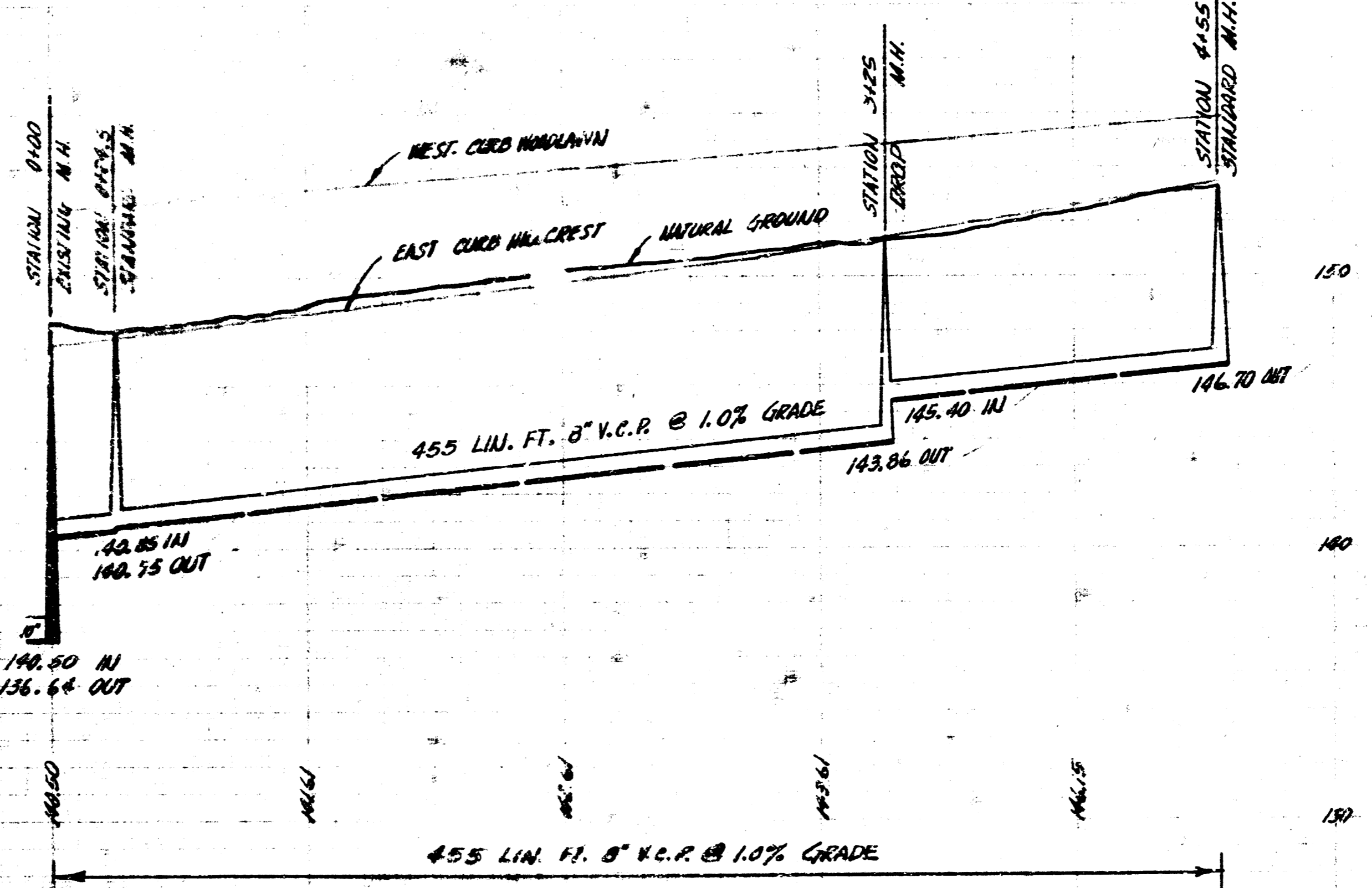
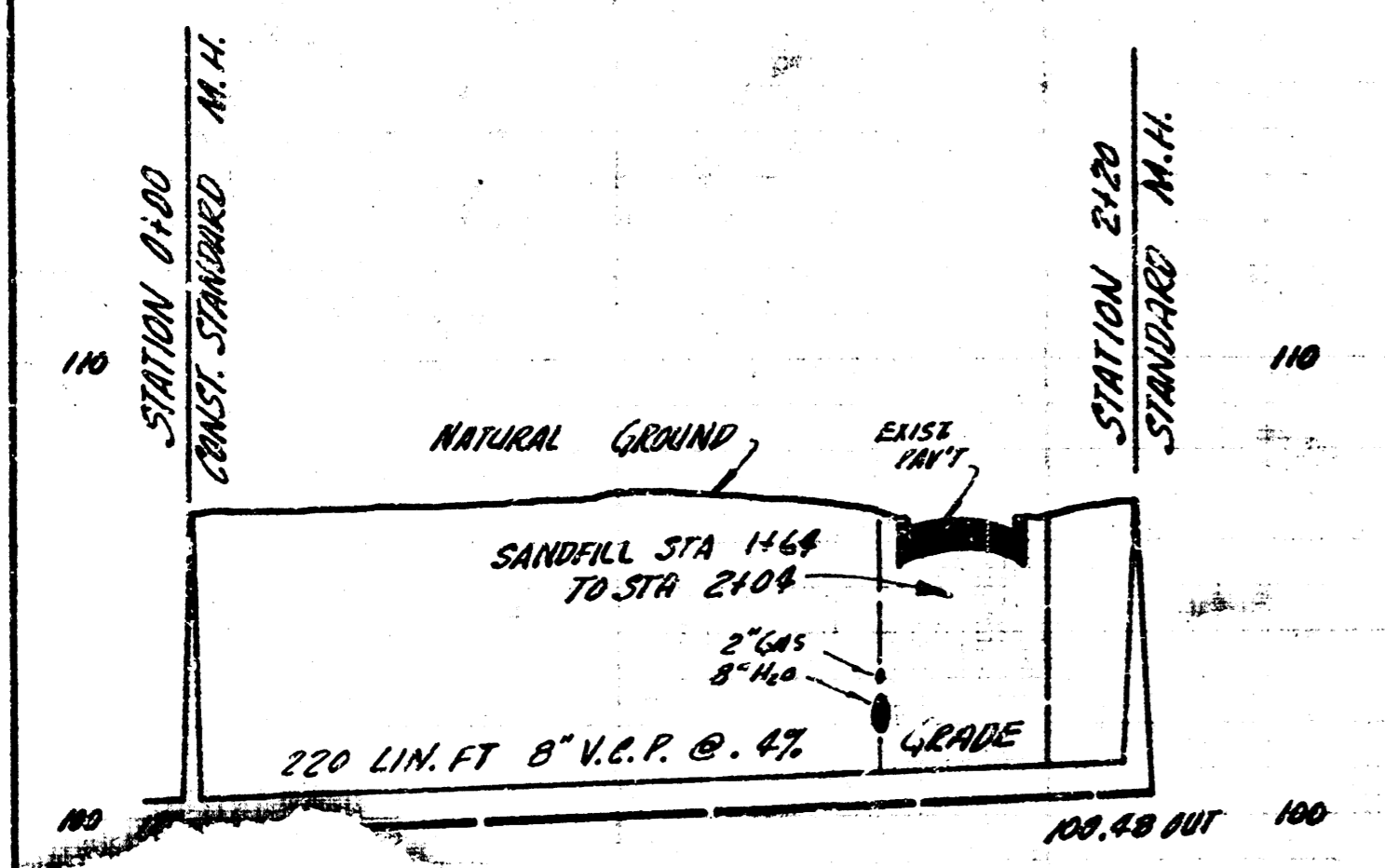

8" V.C.R. @ .4% GRADE

455 LIN. FT. 8" V.C.R. @ 1.0% GRADE

EXT. TO SUB. B SAN. SEWER #21
CITY OF WICHITA, KANSAS
B.E. SMITH CITY ENGINEER
PRIVATE JOB MARCH 1957

LAT. 17 SUB. 3 W. 1.S.
CITY OF WICHITA, KANSAS
B.E. SMITH CITY ENGINEER
PRIVATE JOB DATE - FEB. 1957

