

Note: Manhole Stations on Line 4 to be set as indicated on this plan.

611.0037 Top of Spike N13. Pole 39' Pole Top of 10' N13. Middle
 571.1687 N. 2m. P.H. 010 North Line 2nd of East Brookside Turnway

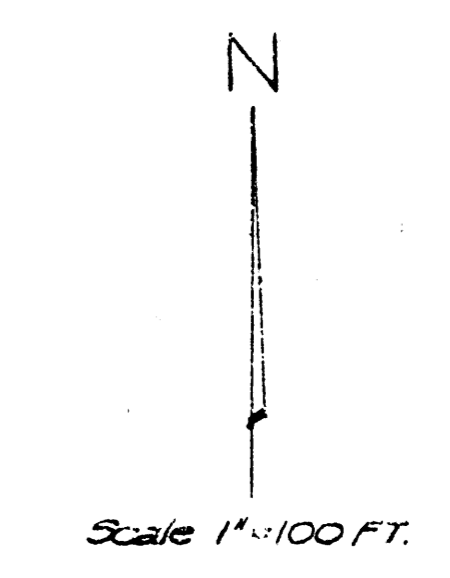

LAT. 47, DRY CREEK SUBMAIN, SS. 12
 WICHITA, KANSAS
 1950

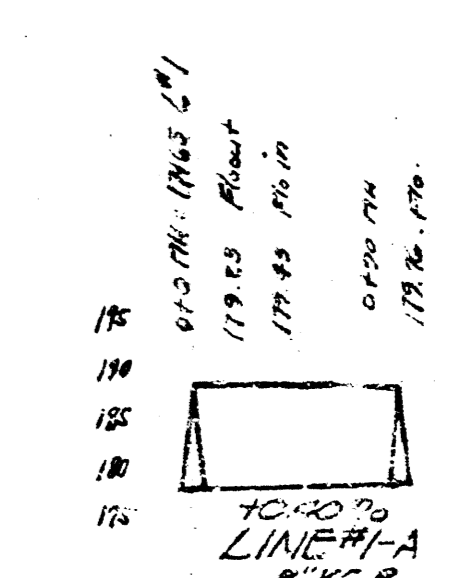
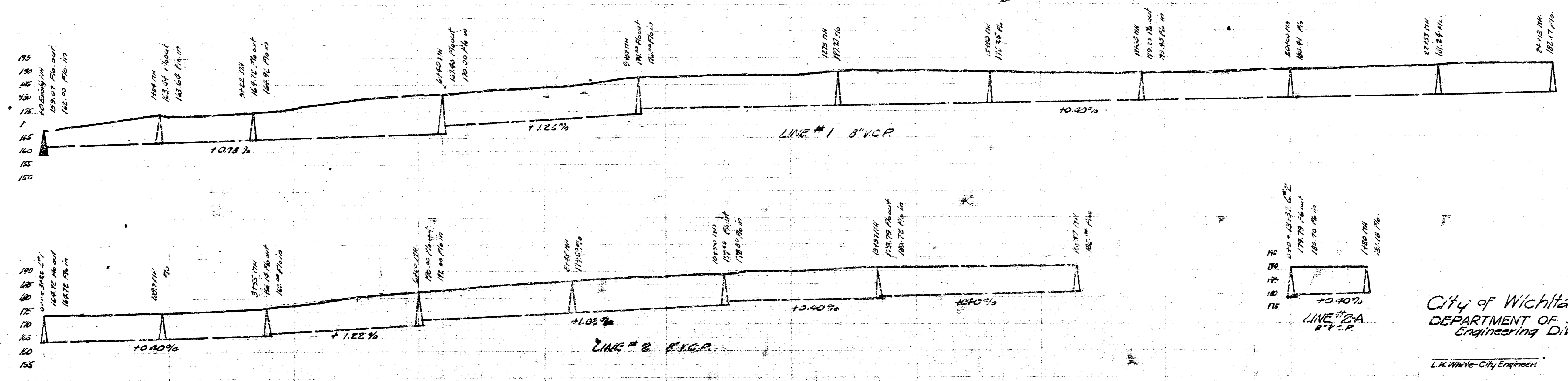

City of Wichita, Kansas
 DEPARTMENT OF SERVICE
 Engineering Division
 L.R. Wier - City Engineer Date

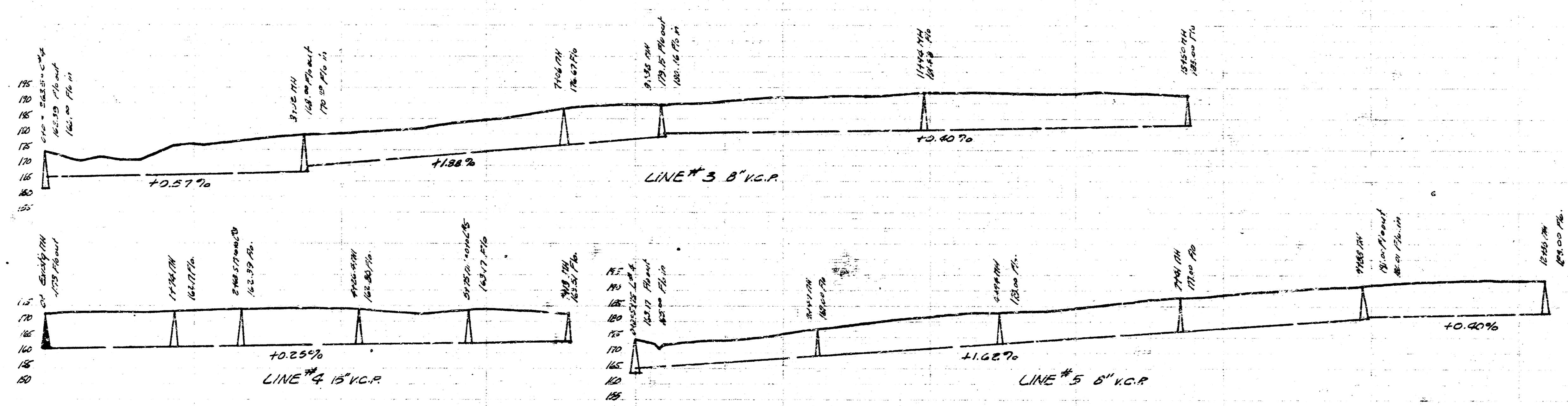

Original Elevation
11-10-10