

B. M. 128.75 1" out on NE corner conc. base to Flood light on NW cor. 21st and Amidon.

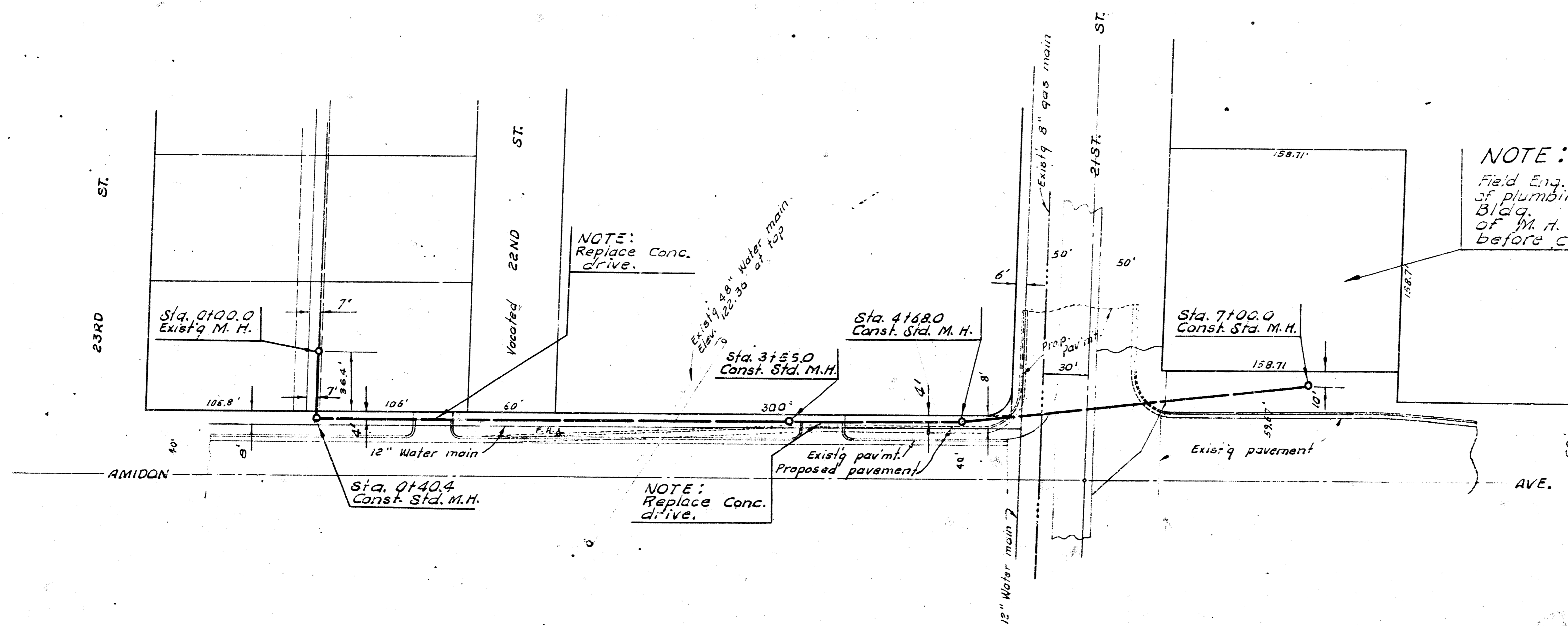

NOTE:
Field Eng. is to check elev. of plumbing out of existing Bldg. Also check elev. of M.H. at Sta. 0100.0 before construction.

NOTE:
Replace Conc. drive.

NOTE:
Replace Conc. drive.

Plan scale 1" = 40' Horiz.
Profile scale 1" = 4' Vert.

Survey by W. M. Checked by

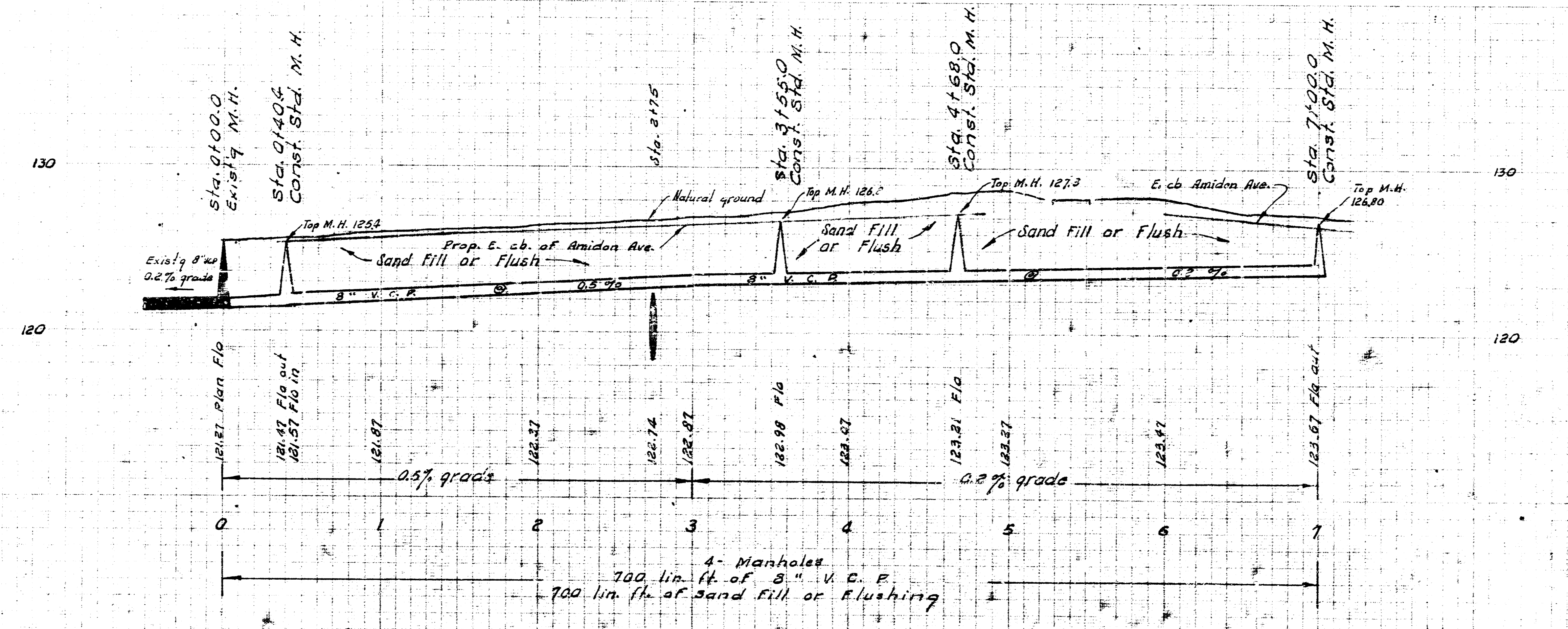

EXTENSION TO
LAT. 22, S. S. NO. 22
CITY OF WICHITA, KANSAS
B. E. SMITH CITY ENGINEER
APRIL 1965 PRIVATE CONTRACT