

Surveyed by A. F. BK AR 845
Checked by J. W. ...

B. M. 136.71' cut on NE cor. wk to Pleasant Valley School
at SL 37th St. No. and 10' E. of WL St. Clair St. No.

WOMERS PLEASANT
VALLEY SECOND
ADDITION

Sta. 3121.1 Const.
Std. M.H. Type "A"
Install stub S.

Sta. 0100.0
Exist. manhole

NOTE: Replace
A.C. mat.

Sta. 2147.1
Const. Std. M.H.
Type "A"

NOTE: Field Engr. to verify the
elev. of existing manhole
at Sta. 0100.0 prior to
construction.

NOTE TO CONTRACTOR:
The enclosed will be considered
as a guide only. It is the
contractor's responsibility to
verify all dimensions and
elevations in the field.

Plan Scale 1" = 40'
Profile Scale 1" = 40' vert.

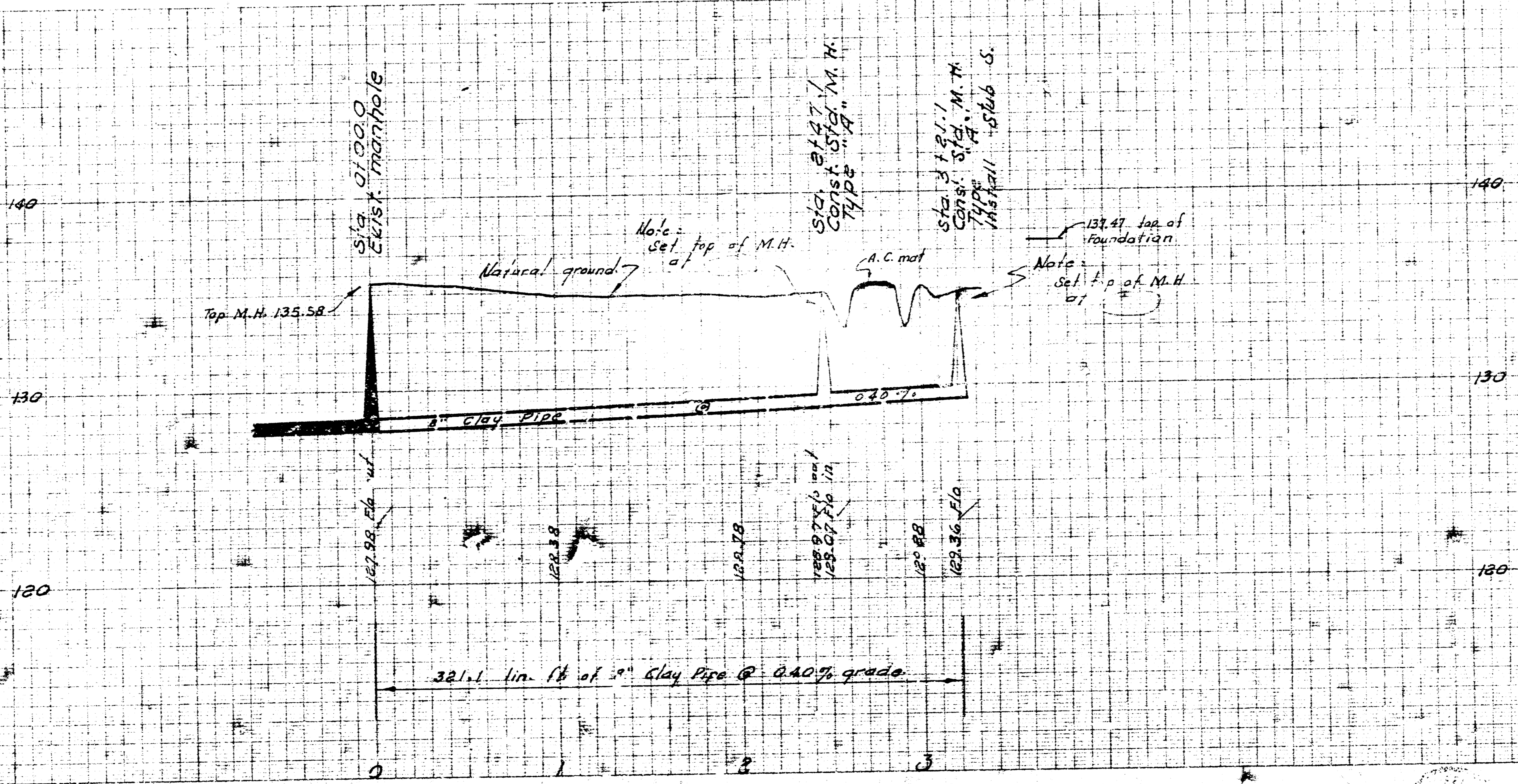
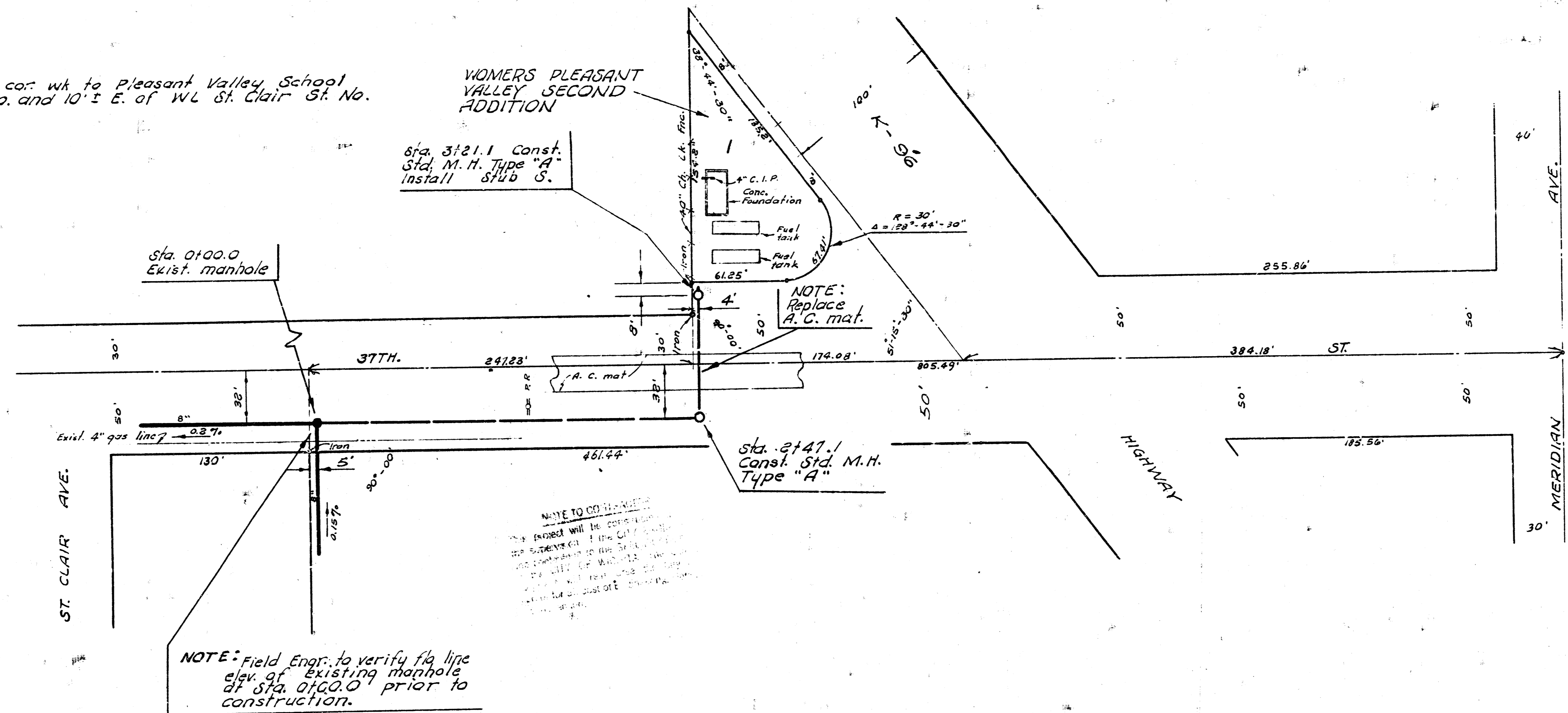

LAT. 22, SUBMAIN 21, S. S. NO. 22
CITY OF WICHITA, KANSAS
B. E. SMITH CITY ENGINEER
APRIL 1970 PRIVATE CONTRACT

2 1 3 5