

2 5 58 2 0 8 Steve 31a 2 58

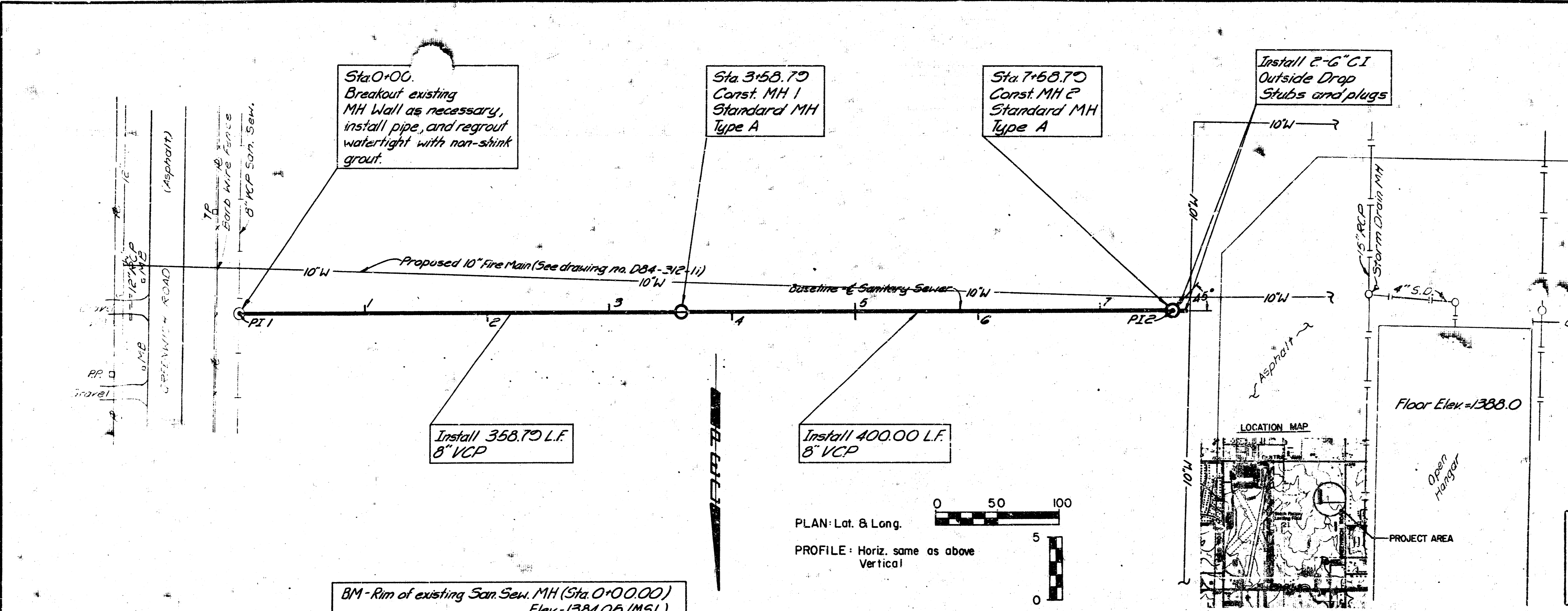

- GENERAL NOTES**
1. THE CONTRACTOR SHALL CONTAIN HIS OPERATIONS TO PERMIT TRAFFIC THROUGH GREENICH ROAD AT ALL TIMES. THE CONTRACTOR SHALL ERECT MARKING SIGNS, FLASHING LIGHTS, AND BARRICADES TO ENSURE SAFETY.
 2. THE CONTRACTOR SHALL COORDINATE CONSTRUCTION WITH BEECH AIRCRAFT CORPORATION, PLANT ENGINEERING DEPARTMENT.
 3. ALL CONSTRUCTION AND MATERIALS TO COMPLY WITH CITY OF WICHITA SPECIFICATIONS AND STANDARDS UNLESS OTHERWISE NOTED.
 4. ANY FENCE DAMAGED DURING CONSTRUCTION SHALL BE REPAIRED AND REPLACED TO EXISTING CONDITION.
 5. ALL EXCESS EXCAVATION AND DEBRIS SHALL BE REMOVED FROM THE JOB SITE BY THE CONTRACTOR AND DISPOSED OF AS DIRECTED BY THE OWNER.
 6. SAND BACKFILL SHALL COMPLY WITH CITY OF WICHITA STANDARD SPECIFICATIONS AND SHALL BE FLUSHED TO 100% ASTM D698.
 7. INSPECTION SHALL BE BY PROFESSIONAL ENGINEERING CONSULTANTS, P.A.
 8. ALL BACKFILL FOR MANHOLES SHALL BE EQUIVALENT TO THAT SPECIFIED FOR THE ADJACENT SEWER LINES UNLESS OTHERWISE NOTED AND SHALL BE CONSIDERED SUBSIDIARY TO THE PRICE BID FOR MANHOLES.
 9. CONCRETE SHALL HAVE A 28-DAY COMPRESSIVE STRENGTH OF 4,000 PSI, 6.5 BAGS CEMENT/CY, 5.5 GAL. WATER/BAG. CONCRETE SHALL BE AIR ENTRAINED (5 TO 8%). AGGREGATE SHALL MEET SOUNDNESS TEST WITH A TOTAL LOSS NOT GREATER THAN 1% BY WEIGHT WHEN TESTED IN ACCORDANCE WITH ASTM C88. PERCENTAGE OF WEAR BY A LA ABRASION TEST, ASTM C131 SHALL BE LESS THAN 40%. COARSE AGGREGATE TO FINE (COARSE 45-80% RETAINED ON 3/8; FINE 40-75% RETAINED ON NO. 30 SIEVE) SHALL BE SUCH THAT NOT MORE THAN 70% COARSE AGGREGATE WILL PASS THE #4 SIEVE, SLUMP 1 TO 3 INCHES.
 10. THE CONTRACTOR SHALL ARRANGE FOR THE CITY OF WICHITA TO DO AIR TESTING AND TELEVISION INSPECTION OF THE COMPLETED SEWER LINE. TESTING AND INSPECTION SHALL BE PAID FOR BY THE CONTRACTOR IN ACCORDANCE WITH CITY OF WICHITA SPECIFICATIONS.

PLAN: Lat. & Long.
 PROFILE: Horiz. same as above
 Vertical

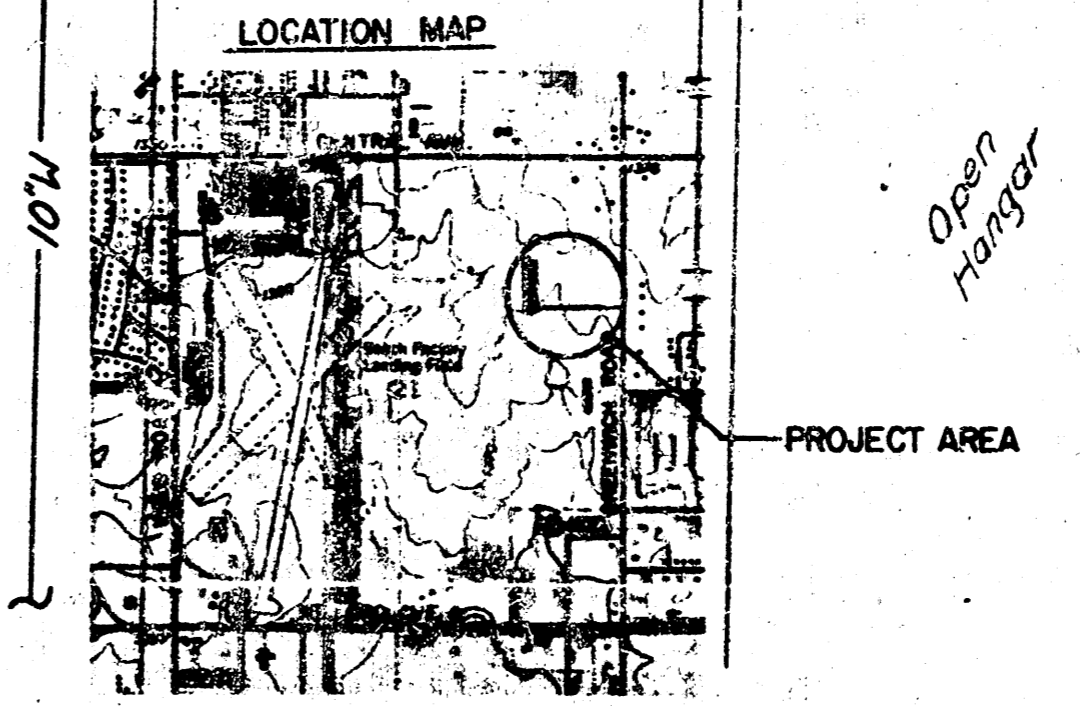
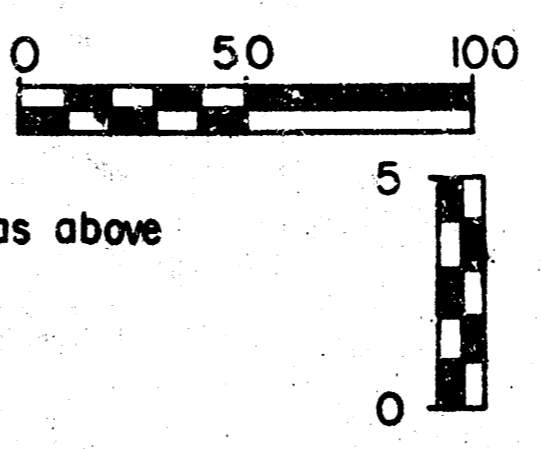

APPROVED AS NOTED
 CITY ENGINEER OF WICHITA
 Sanitary Sewers
 Date: 2/27/84
 Engineering No. 408

CITY OF WICHITA
 APPROVED: Approval does not relieve the contractor from any responsibility for errors or deviations from the contract requirements or for any deficiencies of equipment, work, or materials.
 Date: 2/27/84
 Engineering No. 408

BM - Rim of existing San. Sew. MH (Sta. 0+00.00)
 Elev. = 1384.05 (MSL)

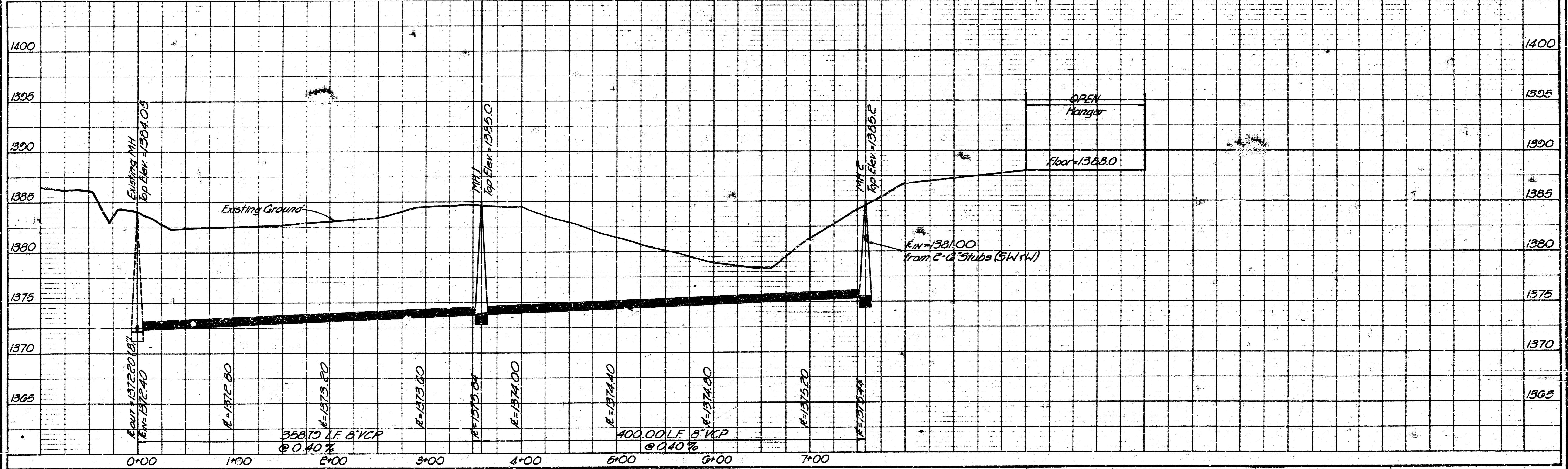

DO NOT TRIM THIS BORDER WHEN PRINTS ARE TO BE BOUND

DATE	NATURE OF REVISION	BY	CHKD.	APPR.

City of Wichita Project No. 465-76-245-80000-000-000-008

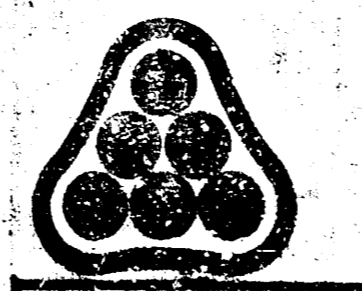
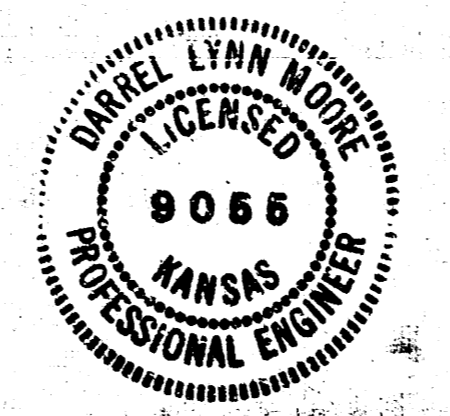

PROFESSIONAL ENGINEERING CONSULTANTS, P.A.
 WICHITA, KANSAS

BEECH AIRCRAFT CORP.
 COMPLETION CENTER

BEECH AIRCRAFT CORP.			
PLANT ENGINEERING DEPT.			
SANITARY SEWER EXTENSION			
DESIGNED BY	DATE	CHECKED	APPROVED
DLM	Feb/1984		
SCALE			

DO NOT TRIM THIS BORDER WHEN PRINTS ARE TO BE BOUND

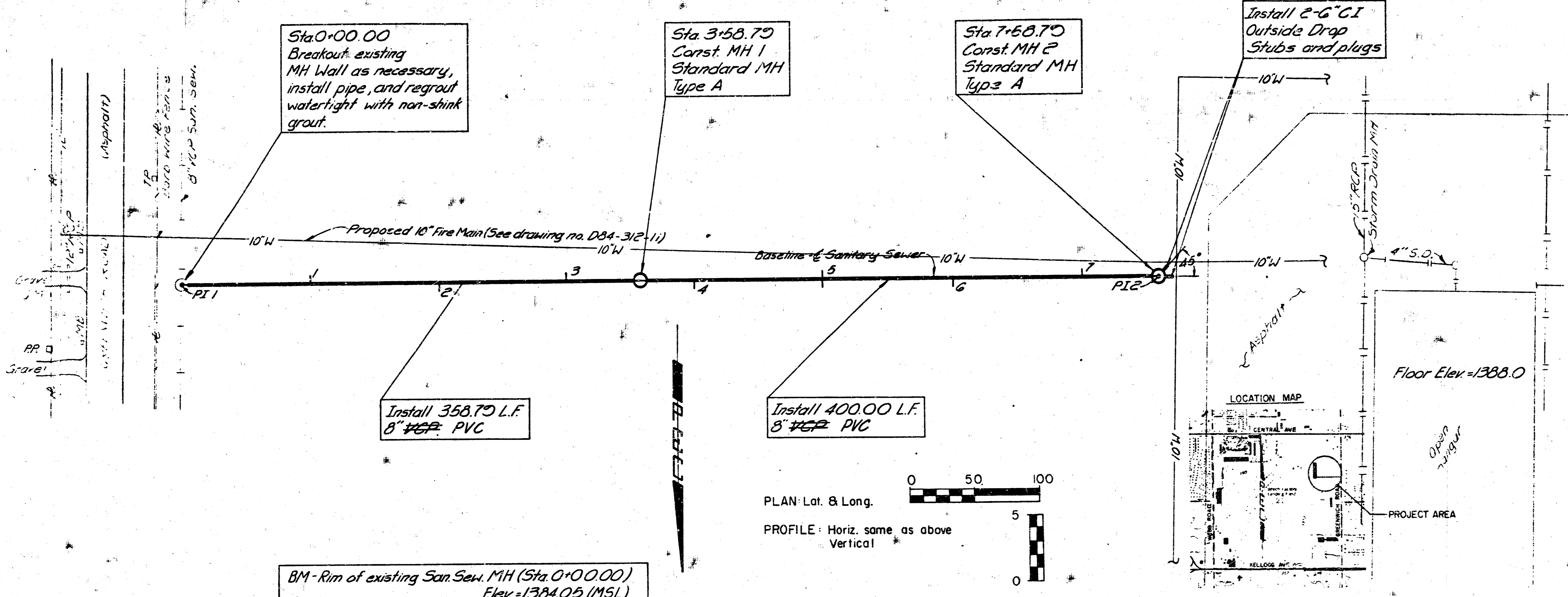

- GENERAL NOTES**
1. THE CONTRACTOR SHALL CONTAIN HIS OPERATIONS TO PERMIT TRAFFIC THROUGH GREENWICH ROAD AT ALL TIMES. THE CONTRACTOR SHALL ERECT WARNING SIGNS, FLASHING LIGHTS, AND BARRICADES TO ENSURE SAFETY.
 2. THE CONTRACTOR SHALL COORDINATE CONSTRUCTION WITH BEECH AIRCRAFT CORPORATION, PLANT ENGINEERING DEPARTMENT.
 3. ALL CONSTRUCTION AND MATERIALS TO COMPLY WITH CITY OF WICHITA SPECIFICATIONS AND STANDARDS UNLESS OTHERWISE NOTED.
 4. ANY FENCE DAMAGED DURING CONSTRUCTION SHALL BE REPAIRED AND REPLACED TO EXISTING CONDITION.
 5. ALL EXCESS EXCAVATION AND DEBRIS SHALL BE REMOVED FROM THE JOB SITE BY THE CONTRACTOR AND DISPOSED OF AS DIRECTED BY THE OWNER.
 6. SAND BACKFILL SHALL COMPLY WITH CITY OF WICHITA STANDARD SPECIFICATIONS AND SHALL BE FLUSHED TO 100% OF ASTM D698.
 7. INSPECTION SHALL BE BY PROFESSIONAL ENGINEERING CONSULTANTS, P.A.
 8. ALL BACKFILL FOR MANHOLES SHALL BE EQUIVALENT TO THAT SPECIFIED FOR THE ADJACENT SEWER LINES UNLESS OTHERWISE NOTED AND SHALL BE CONSIDERED SUBSIDIARY TO THE PRICE BID FOR MANHOLES.
 9. CONCRETE SHALL HAVE A 28-DAY COMPRESSIVE STRENGTH OF 4,000 PSI, 6.5 BAGS CEMENT/CY, 5.5 GAL. WATER/BA. CONCRETE SHALL BE AIR ENTRAINED (5 TO 8%). AGGREGATE SHALL MEET SOUNDNESS TEST WITH A TOTAL LOSS NOT GREATER THAN 18% BY WEIGHT WHEN TESTED IN ACCORDANCE WITH ASTM C88. PERCENTAGE OF WEAR BY A LA ABRASION TEST, ASTM C131 SHALL BE LESS THAN 40%. COARSE AGGREGATE TO FINE (COARSE 45-80% RETAINED ON 3/8; FINE 40-75% RETAINED ON NO. 30 SIEVE) SHALL BE SUCH THAT NOT MORE THAN 70% OR LESS THAN 40% WILL PASS THE #4 SIEVE, SLUMP 1 TO 3 INCHES.
 10. THE CONTRACTOR SHALL ARRANGE FOR THE CITY OF WICHITA TO DO AIR TESTING AND TELEVISION INSPECTION OF THE COMPLETED SEWER LINE. TESTING AND INSPECTION SHALL BE PAID FOR BY THE CONTRACTOR IN ACCORDANCE WITH CITY OF WICHITA SPECIFICATIONS.

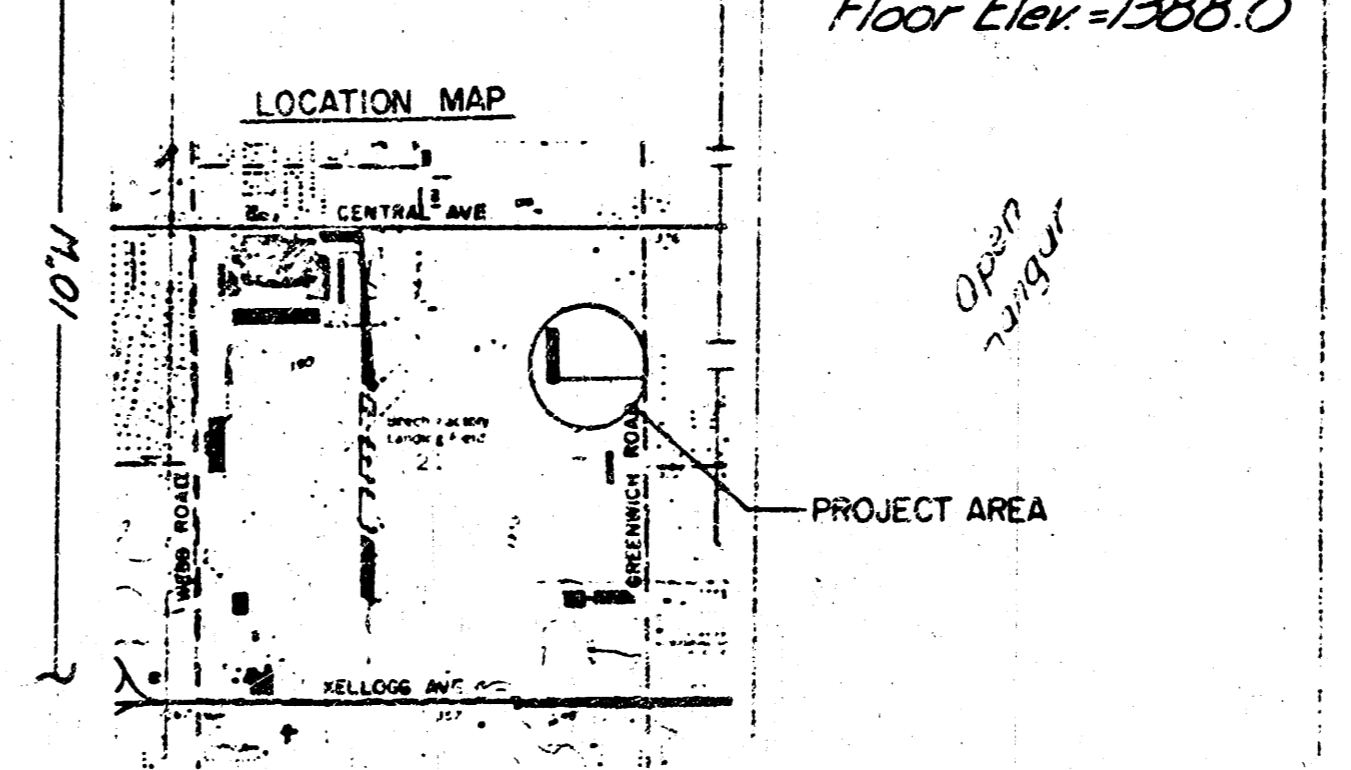
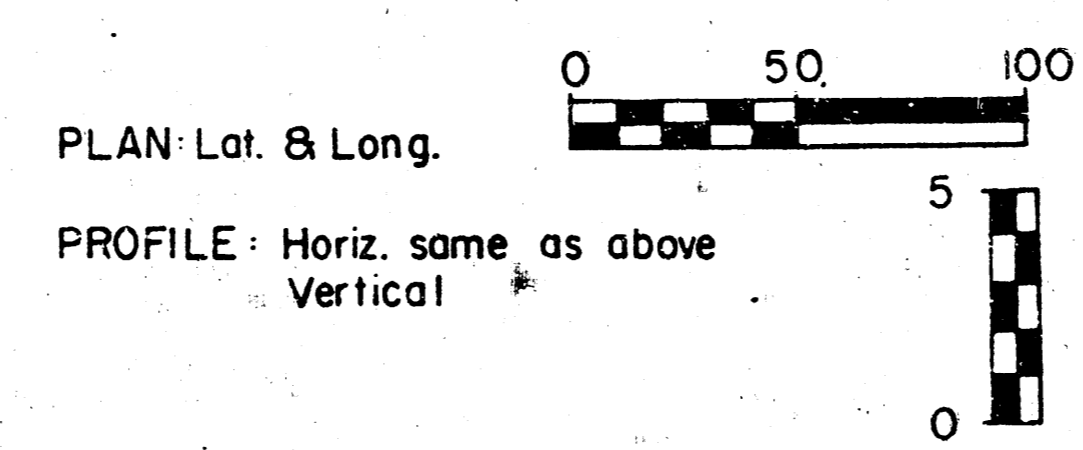

CITY OF WICHITA
 PROFESSIONAL ENGINEER
 DATE: 1/21/85
 BY: [Signature]
 TITLE: [Signature]

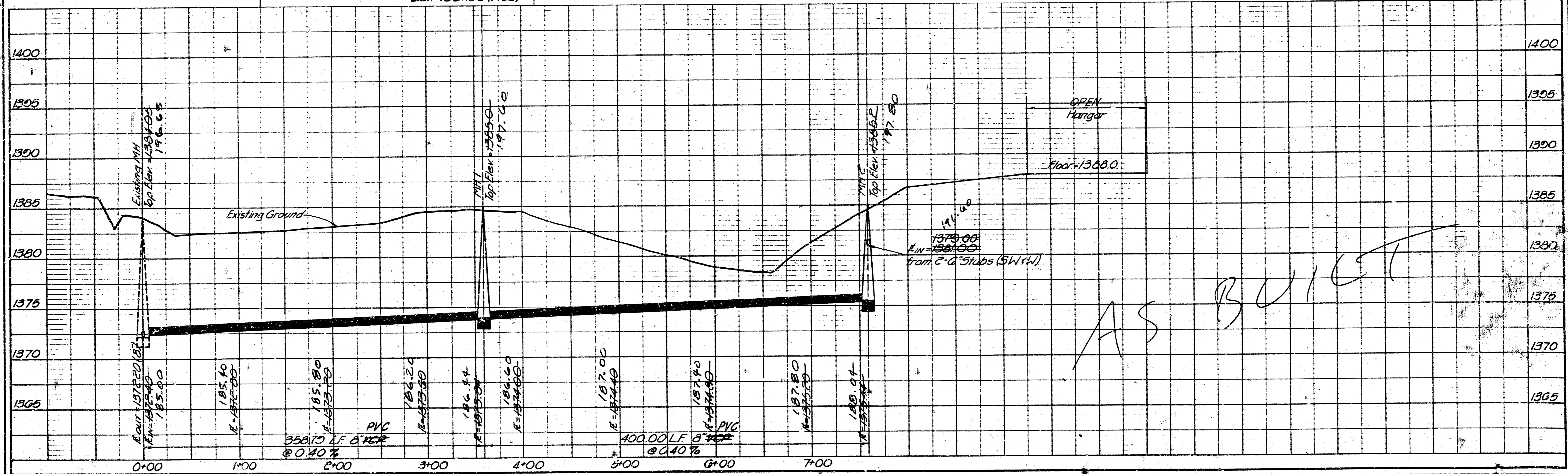

AS BUILT

		AS CONSTRUCTED PROJ. ENG. [Signature] DATE: 1/21/85 RES. ENGR. [Signature] DATE: 1/18/85	BEECH AIRCRAFT CORP. COMPLETION CENTER	BEECH AIRCRAFT CORP. PLANT ENGINEERING DEPT. SANITARY SEWER EXTENSION
City of Wichita Project No 468-76-245-000-000-000-000		PROFESSIONAL ENGINEERING CONSULTANTS, P.A. ENGINEERS WICHITA, KANSAS	REFERENCE DRAWINGS	APPROVED: [Signature] TITLE: [Signature] DATE: [Signature]