

DATE	BY	REVISION

DATE	BY	REVISION

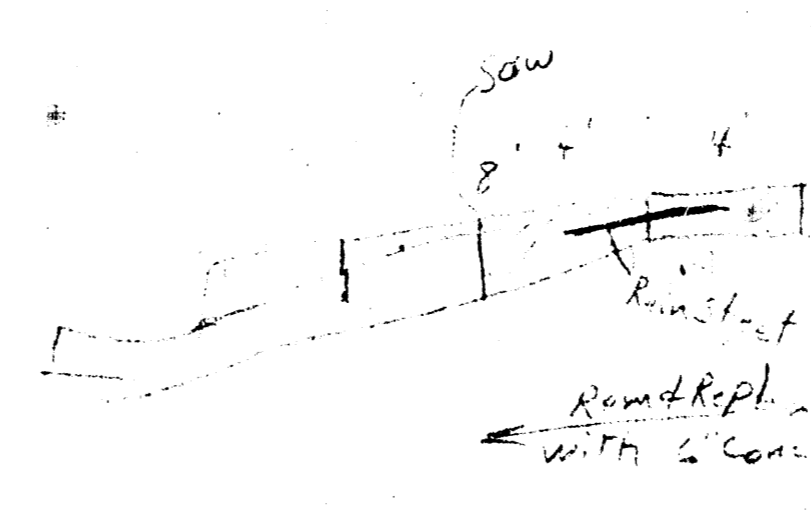
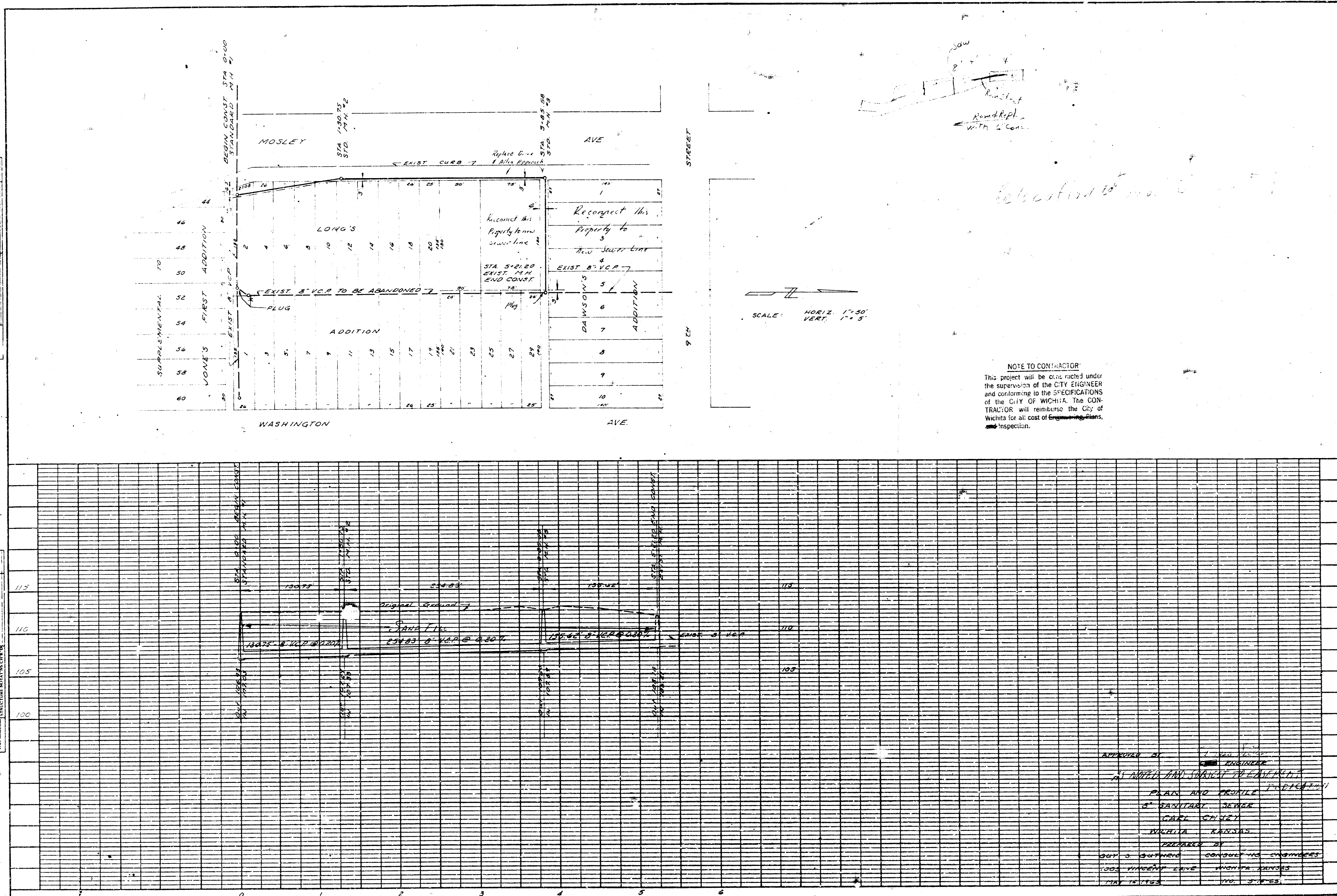

NOTE TO CONTRACTOR
 This project will be constructed under the supervision of the CITY ENGINEER and conforming to the SPECIFICATIONS of the CITY OF WICHITA. The CONTRACTOR will reimburse the City of Wichita for all cost of Engineering, Plans, Inspection.

APPROVED BY: [Signature]
 AS NOTED AND SHOWN TO CONFORM WITH
 PLANS AND PROFILE INDICATED
 8" SANITARY SEWER
 CUREL CHASE
 WICKELA RANSHAS
 PREPARED BY
 GUY S. BATHMAN CONSULTING ENGINEER
 1002 VINCENT AVE WICHITA KANSAS
 MAY 15 1923

Relocation East Sub D.S. # 1

