

The Contractor shall furnish the required performance and statutory bonds and enter into a contract within ten (10) days after the award has been made. These specifications shall become a part of the contract.

A certified check or cashier's check equal to 5% of the bid, shall be required and shall accompany the bid.

The Contractor shall obtain and pay for all permits.

The installation shall be guaranteed for a period of one (1) year, from date of acceptance of the work, covering materials and workmanship.

Payment will be made in full within thirty (30) days after approval by Owner and final acceptance of the work.

**SCOPE OF WORK**

This contract shall include the furnishing of all material and labor required for the following:

**Dodge**  
Building one new manhole, connecting three new 12" lines and two existing 12" lines to it, laying approximately 419 feet of 12" Vitrified Clay Pipe plus 90 feet of 12" Dickey P.V.C. 12" Vitrified Clay Pipe, laying approximately 275 feet of 8" Vitrified Clay Pipe and constructing drop inlet into city manhole.

**Eureka**  
Laying approximately 16 feet of 8" Vitrified Clay Pipe from city manhole and terminating it with a "y" and observation hole, laying approximately 270 feet of 8" Vitrified Clay Pipe from the "y" to the building.

**SPECIFICATIONS**

All pipe shall be Vitrified Clay except for ninety (90) feet which shall be Dickey P.V.C. Vitrified Clay as noted on the plans.

This work shall be done under the supervision of and meet with the approval of the City Engineering Department of the City of Wichita.

The Contractor shall reimburse the City Engineering Department for any expenses incurred in connection with this work.

BOARD OF EDUCATION  
Office of Director of Purchases  
428 South Broadway  
Wichita 2, Kansas

June 20, 1958

**SANITARY SEWER CONNECTIONS AT DODGE AND EUREKA**

**NOTICE TO BIDDERS**

The Wichita Board of Education, hereinafter designated the "Owner", invites your bid on connecting all buildings on the Dodge School premises at 4801 West 2nd, and on the Eureka School premises at 573 South West Street, to the Sanitary Sewers.

Bids will be accepted until 2:00 p.m., July 9, 1958, at the office of the Director of Purchases, 428 South Broadway, Wichita, Kansas, at which time they will be opened publicly, read and tabulated. No bidder may withdraw his bid for a period of fifteen (15) days from the time bids are opened.

The Board of Education reserves the right to accept or reject any or all bids and/or waive informalities.

Copies of the Plans and Specifications required for bidding and estimating purposes may be obtained from the Staff Architect at the Board of Education Service Department, 2127 East Waterman.

Any items of the Plans and/or Specifications and of the contract documents which seem to be omissions, or errors or points not clear are to be called to the attention of the Owner, and the Owner will issue addenda to the Plans and Specifications clarifying same; and such addendum shall immediately be attached to the Plans and Specifications in the Contractor's possession, and in closing the contract, they will become a part of the contract documents. The Owner will not be held responsible for any oral or telephone instructions.

**GENERAL CONDITIONS**

It is the intent of these Plans and Specifications to include all labor and material necessary to make all connections to Sanitary Sewers at the specified location.

The work to be done shall be performed prior to August 30, 1958.

The bidder shall visit the sites, make his measurements and become thoroughly familiar with the work to be done before submitting a bid.

The successful bidder, hereinafter designated the "Contractor," shall obtain and maintain Liability Insurance in an amount of not less than \$50,000 for injuries, including accidental death, to any one person, and subject to the same limit for each person, in an amount not less than \$100,000, on account of one accident; and Property Damage Insurance in an amount of not less than \$10,000 for one (1) accident. Compensation shall be statutory limits.

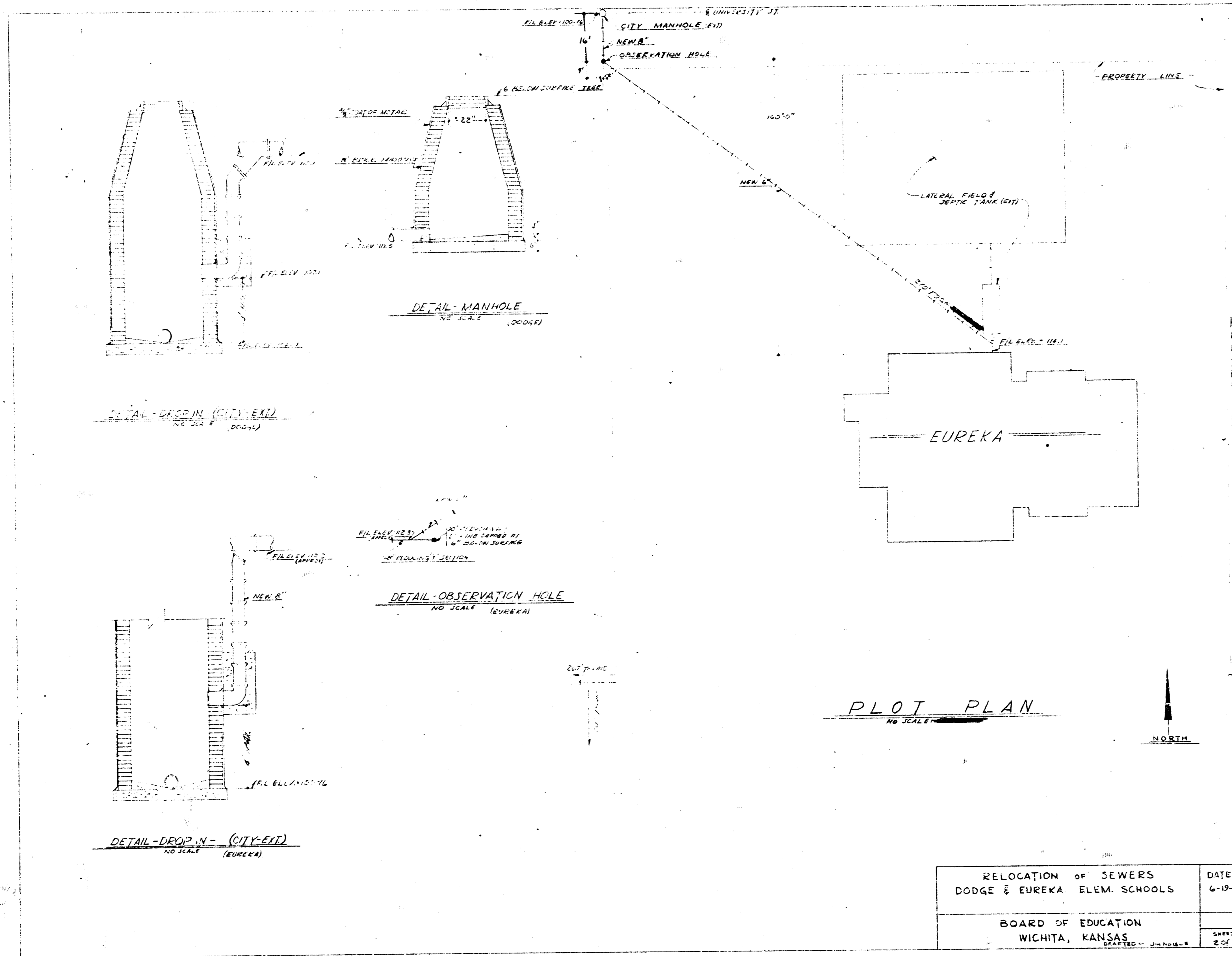

BOARD OF EDUCATION  
Office of Director of Purchases  
428 South Broadway  
Wichita 2, Kansas

June 20, 1958

SANITARY SEWER CONNECTIONS AT DODGE AND EUREKA

NOTICE TO BIDDERS

The Wichita Board of Education, hereinafter designated the "Owner", invites your bid on connecting all buildings on the Dodge School premises at 4501 West 2nd, and on the Eureka School premises at 573 South West Street, to the Sanitary Sewers.

Bids will be accepted until 2:00 p.m., July 9, 1958, at the office of the Director of Purchases, 428 South Broadway, Wichita, Kansas, at which time they will be opened publicly, read and tabulated. No bidder may withdraw his bid for a period of fifteen (15) days from the time bids are opened.

The Board of Education reserves the right to accept or reject any or all bids and/or waive irregularities.

Copies of the Plans and Specifications required for bidding and estimating purposes may be obtained from the Staff Architect at the Board of Education Service Department, 2127 East Waterman.

Any items of the Plans and/or Specifications and of the contract documents which seem to be omissions, or errors or points not clear are to be called to the attention of the Owner, and the Owner will issue addenda to the Plans and Specifications clarifying same; and such addenda shall immediately be attached to the Plans and Specifications in the Contractor's possession, and in closing the contract they will become a part of the contract documents. The Owner will not be held responsible for any oral or telephone instructions.

GENERAL CONDITIONS

It is the intent of these Plans and Specifications to include all labor and material necessary to make all connections to Sanitary Sewers at the specified locations.

The work to be done shall be performed prior to August 30, 1958.

The bidder shall visit the site, make his measurements and become thoroughly familiar with the work to be done before submitting a bid.

The successful bidder, hereinafter designated the "Contractor," shall obtain and maintain Liability Insurance in an amount of not less than \$50,000 for injuries, including accidental death, to any one person, and subject to the same limit for each person, in an amount not less than \$100,000, on account of one accident; and Property Damage Insurance in an amount of not less than \$10,000 for one (1) accident. Compensation shall be statutory limits.

The Contractor shall furnish the required performance and statutory bonds and enter into a contract within ten (10) days after the award has been made. These specifications shall become a part of the contract.

A certified check or cashier's check equal to 5% of the bid, shall be required and shall accompany the bid.

The Contractor shall obtain and pay for all permits.

The installation shall be guaranteed for a period of one (1) year, from date of acceptance of the work, covering materials and workmanship.

Payment will be made in full within thirty (30) days after approval by Owner and final acceptance of the work.

SCOPE OF WORK

This contract shall include the furnishing of all material and labor required for the following:

Dodge

Building one new manhole, connecting three new 4" lines and two existing 4" lines to it, laying approximately 119 feet of 4" Vitrified Clay Pipe plus 90 feet of 18" Dickey P.V.C. 18" Vitrified Clay Pipe, laying approximately 275 feet of 8" Vitrified Clay Pipe and constructing drop inlet into city manhole.

Eureka

Laying approximately 16 feet of 8" Vitrified Clay Pipe from city manhole and terminating it with a "y" and observation hole, laying approximately 270 feet of 6" Vitrified Clay Pipe from the "y" to the building.

SPECIFICATIONS

All pipe shall be Vitrified Clay except for ninety (90) feet which shall be Dickey P.V.C. Vitrified Clay as noted on the plans.

This work shall be done under the supervision of and meet with the approval of the City Engineering Department of the City of Wichita.

The Contractor shall reimburse the City Engineering Department for any expenses incurred in connection with this work.