

THE
LOYAL ORDER OF MOOSE

LODGE NO. 138

SANITARY SEWER

1958

EDIGER & COMPANY

Consulting Engineers & Architects

WICHITA, KANSAS

INDEX

- 1 SEWER DETAILS
- 2 PLAN & PROFILE
- 3 PLAN & PROFILE
- 4 PLAN & PROFILE

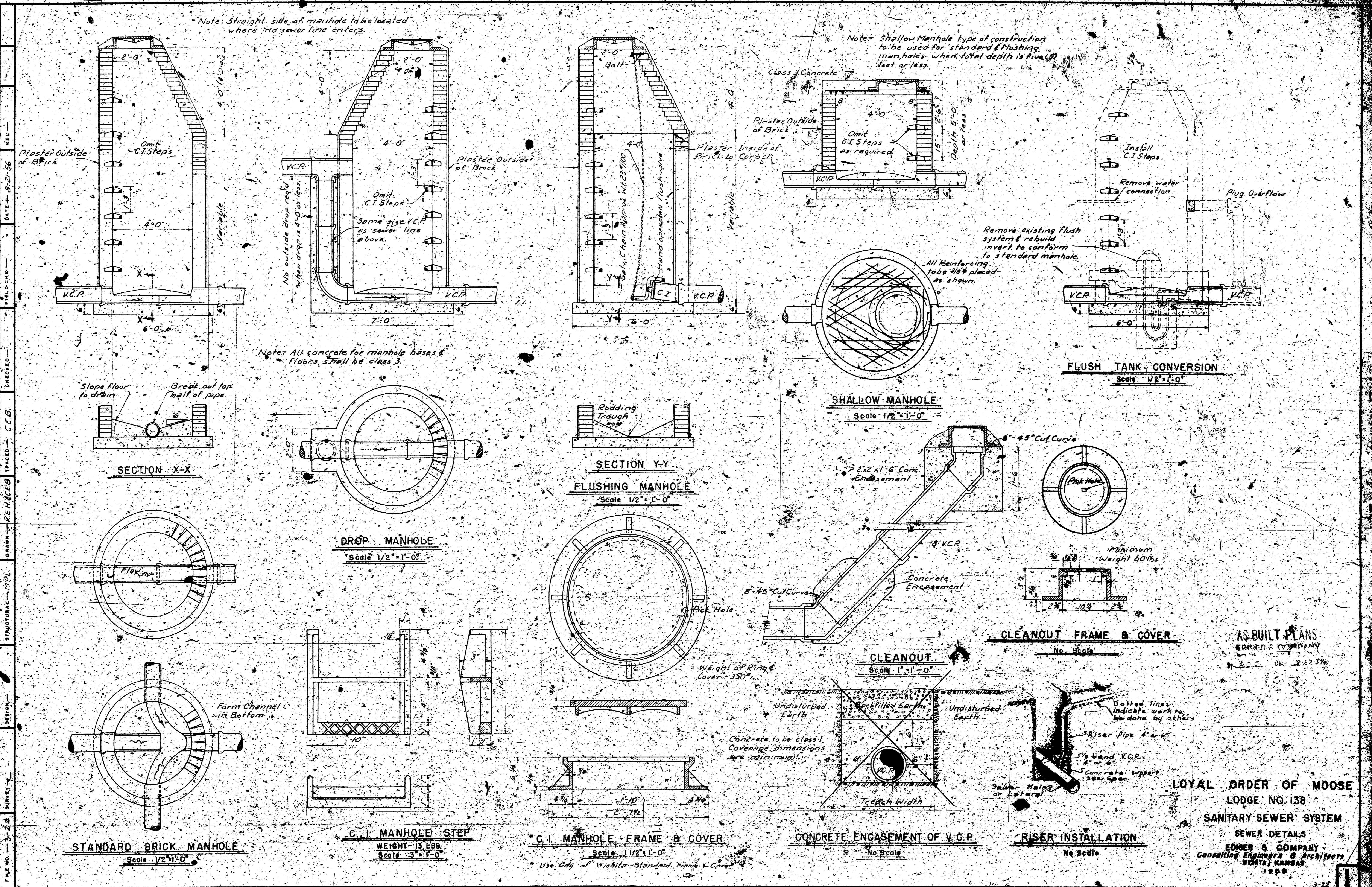

DATE: 8-21-36
 CHECKED: C.C.B.
 DRAWN: R.H.Z.
 REVISIONS: 1-72
 SURVEY: 3-24

Note: Straight side of manhole to be located where no sewer line enters.

Note: Shallow Manhole type of construction to be used for standard & flushing manholes when total depth is five (5) feet or less.

Note: All concrete for manhole bases & floors shall be class 3.

Remove existing flush system & rebuild invert to conform to standard manhole.
 All reinforcing bars placed as shown.

AS-BUILT PLANS
 EDGER & COMPANY
 227 S. 10th St.
 WICHITA, KANSAS

LOYAL ORDER OF MOOSE
 LODGE NO. 138
 SANITARY SEWER SYSTEM
 SEWER DETAILS
 EDGER & COMPANY
 Consulting Engineers & Architects
 WICHITA, KANSAS
 1938



LOYAL ORDER OF MOOSE
 LODGE NO. 136
 SANITARY SEWER SYSTEM
 PLAN & PROFILE
 EDGES & COMPANY
 Consulting Engineers & Architects
 WICHITA, KANSAS
 1958

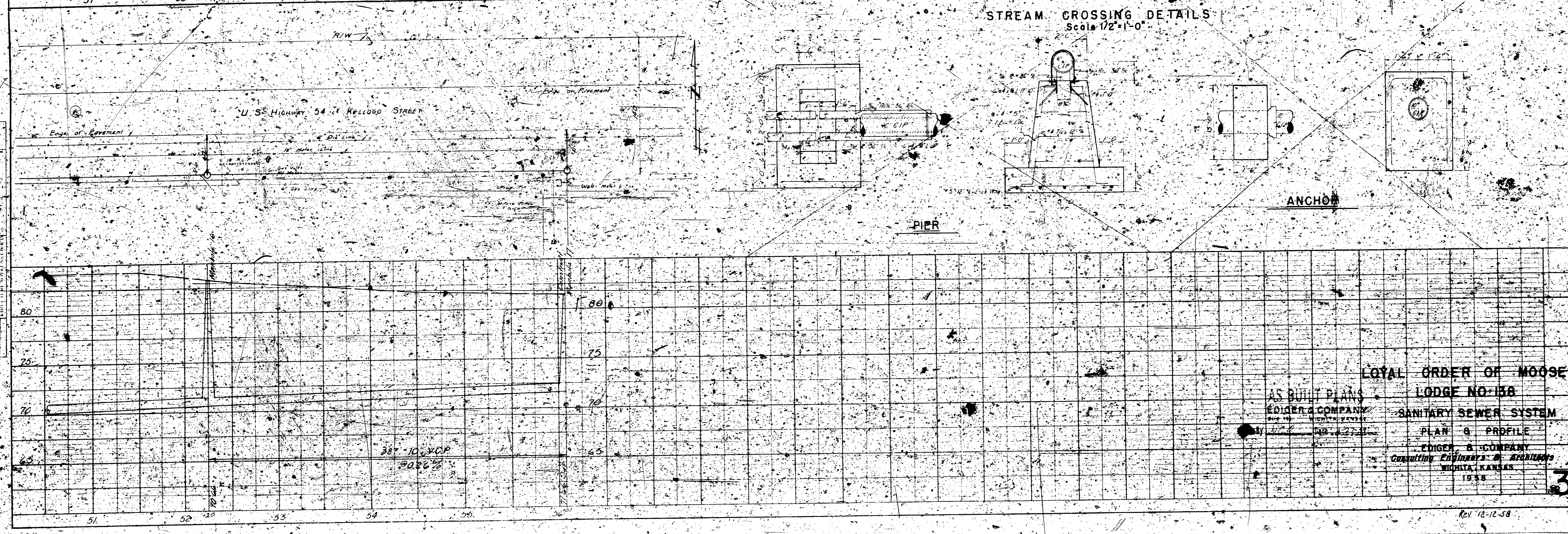
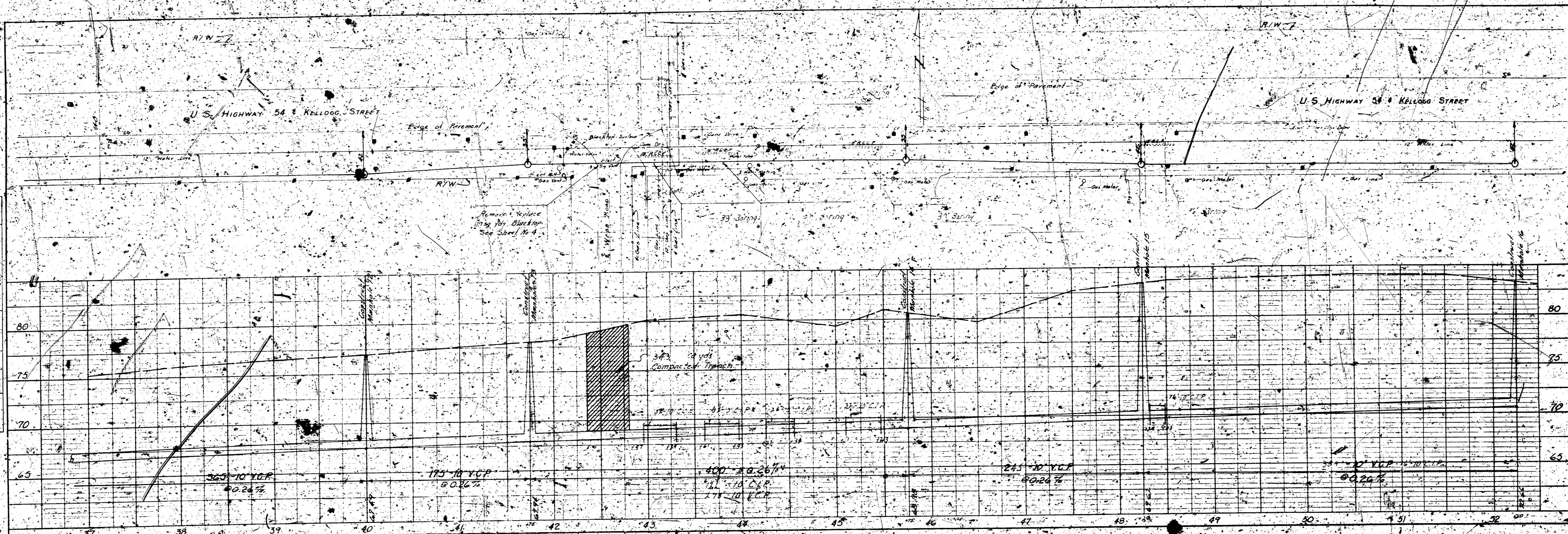

LOYAL ORDER OF MOOSE
 LODGE NO. 138
 SANITARY SEWER SYSTEM
 PLAN & PROFILE
 EDGER & COMPANY
 CIVIL ENGINEERS & ARCHITECTS
 WICHITA, KANSAS
 1938

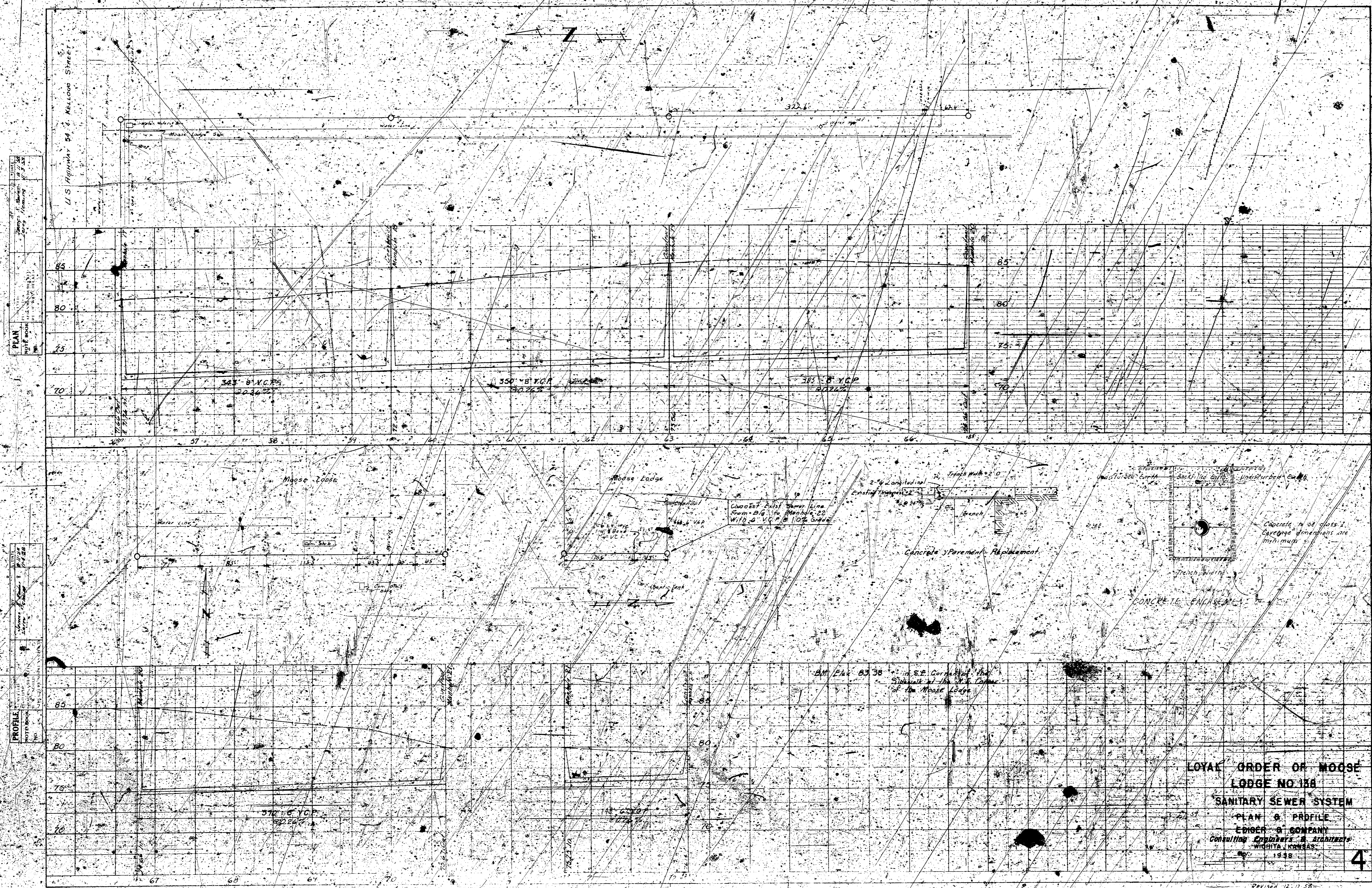

LOYAL ORDER OF MOOSE
 LODGE NO 158
 SANITARY SEWER SYSTEM
 PLAN & PROFILE
 EDISON & COMPANY
 Consulting Engineers & Architects
 WISCONSIN
 1938