

B.M. 95.305 R.R. Spike E. Side Double Fork 30' C.W. Tree 765' W. of Clarence on E Carey Lane

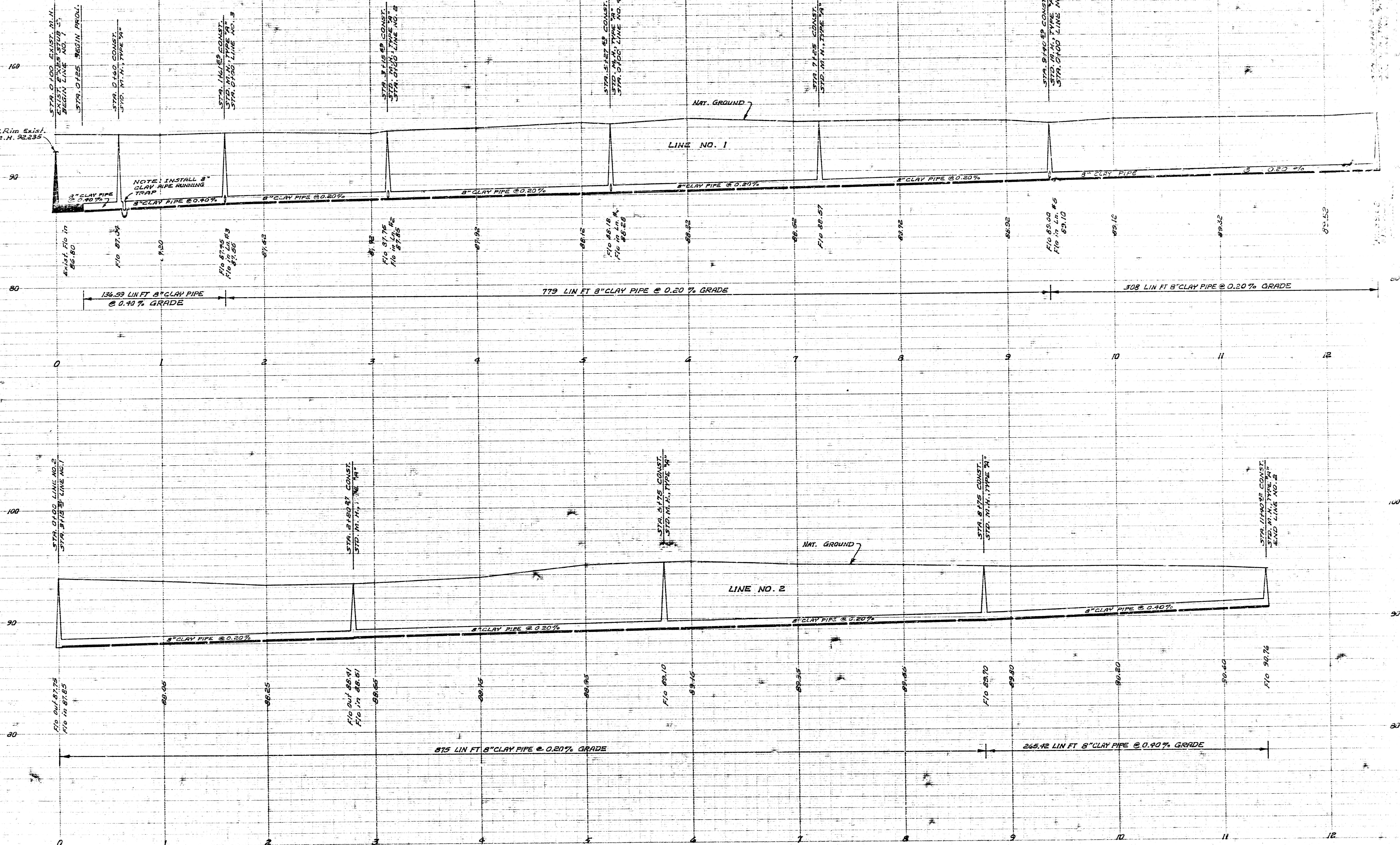

CHARLES PRINTING COMPANY
FACILITY PLANT A

CHARLES PRINTING COMPANY
FACILITY PLANT A

2/4

MOBIL MANOR MOBIL HOME PARK
SAN. SEWER



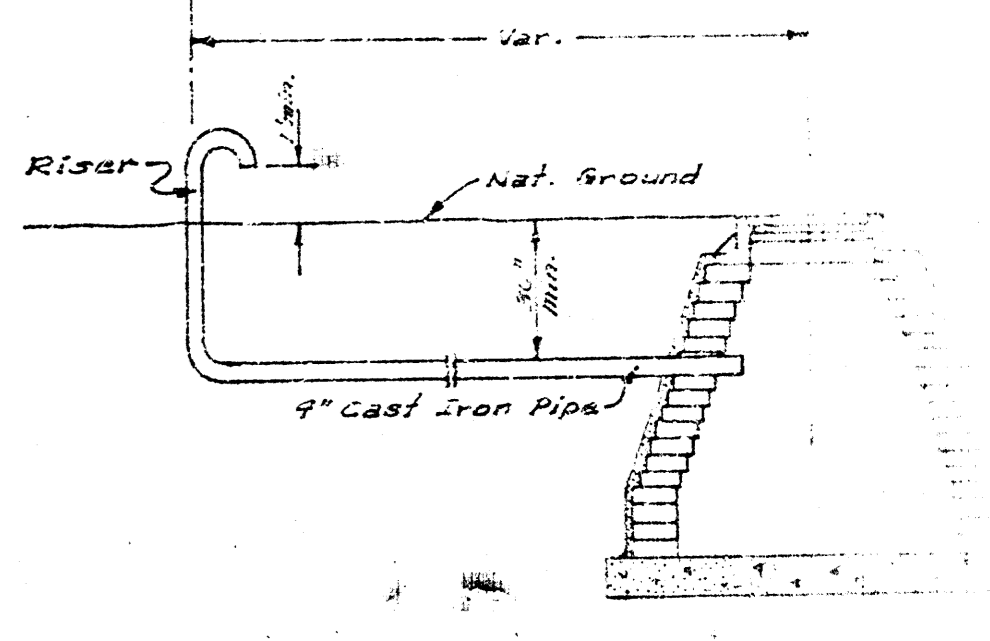
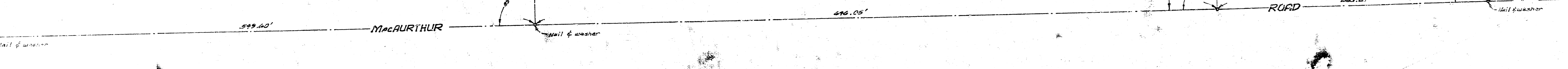
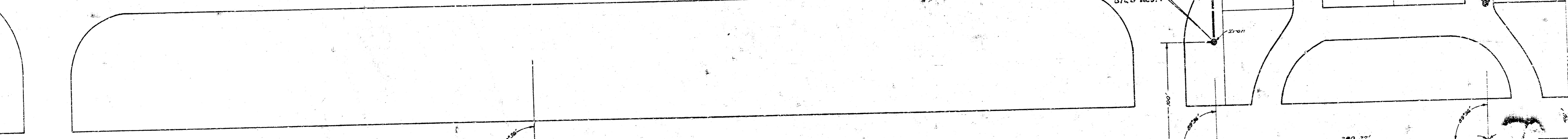
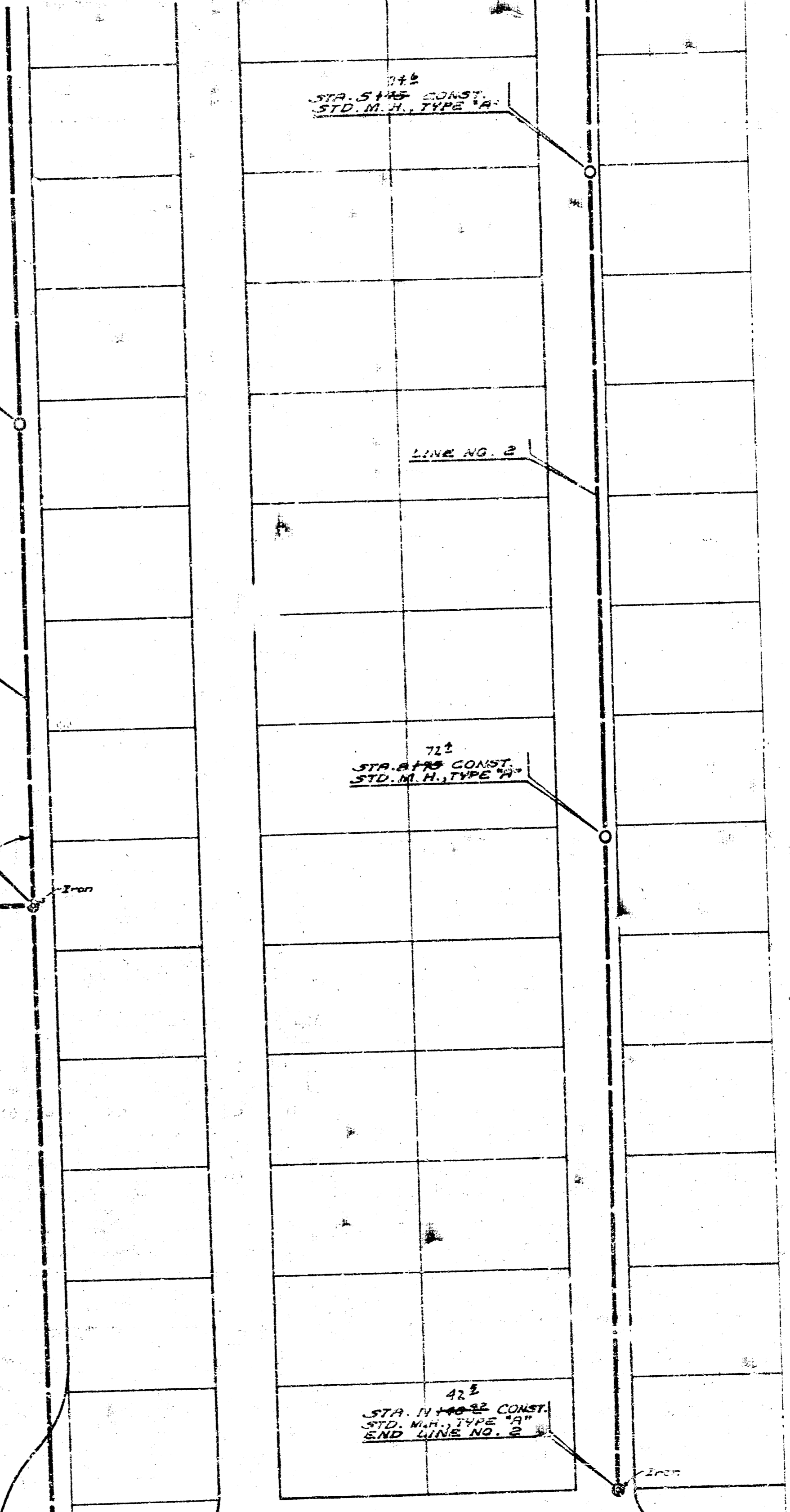
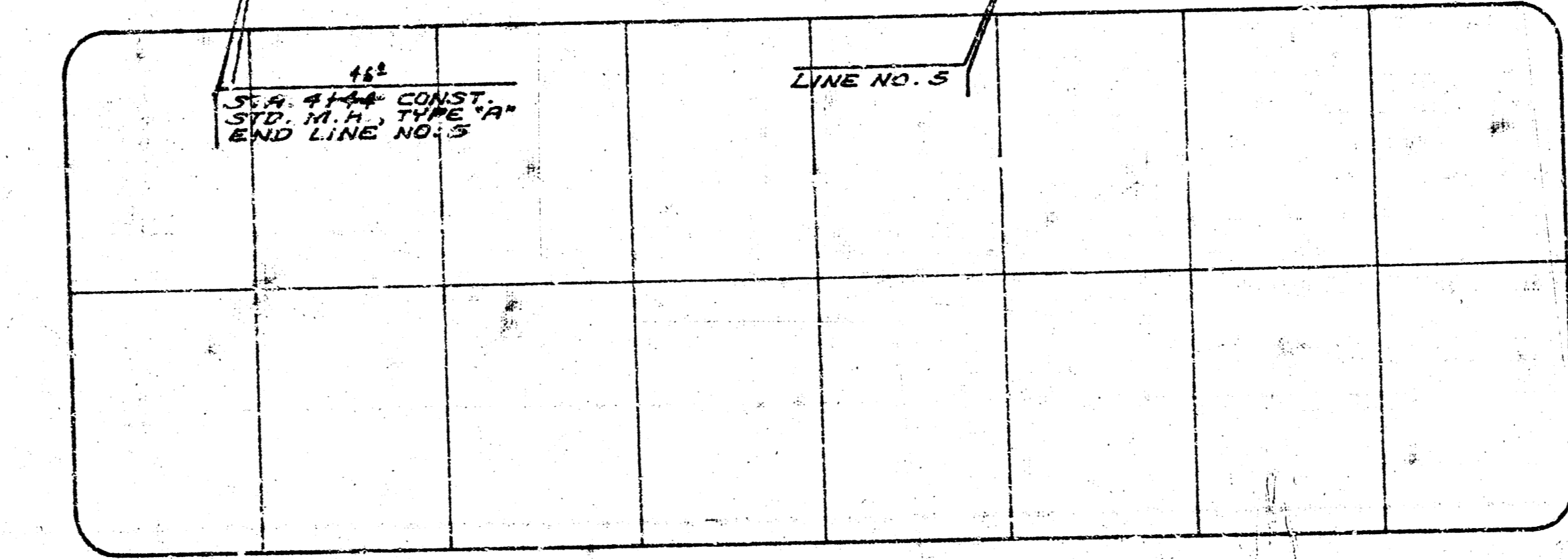
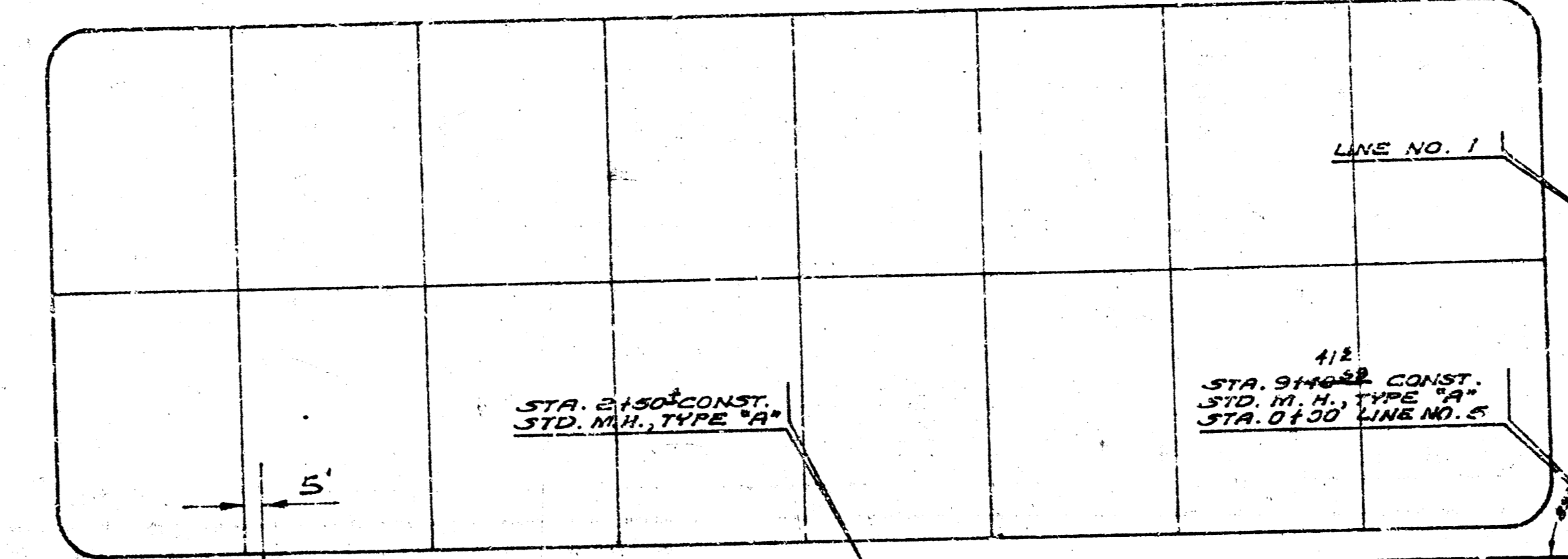
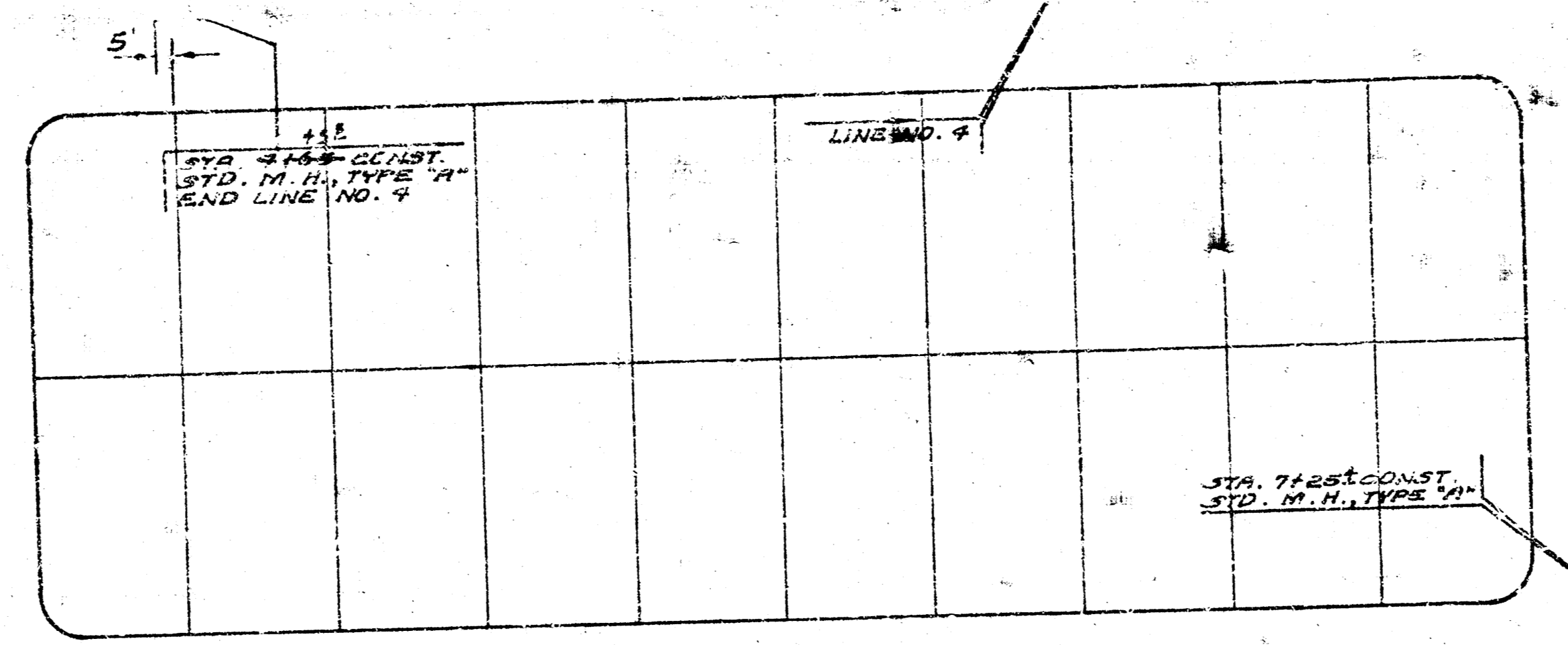
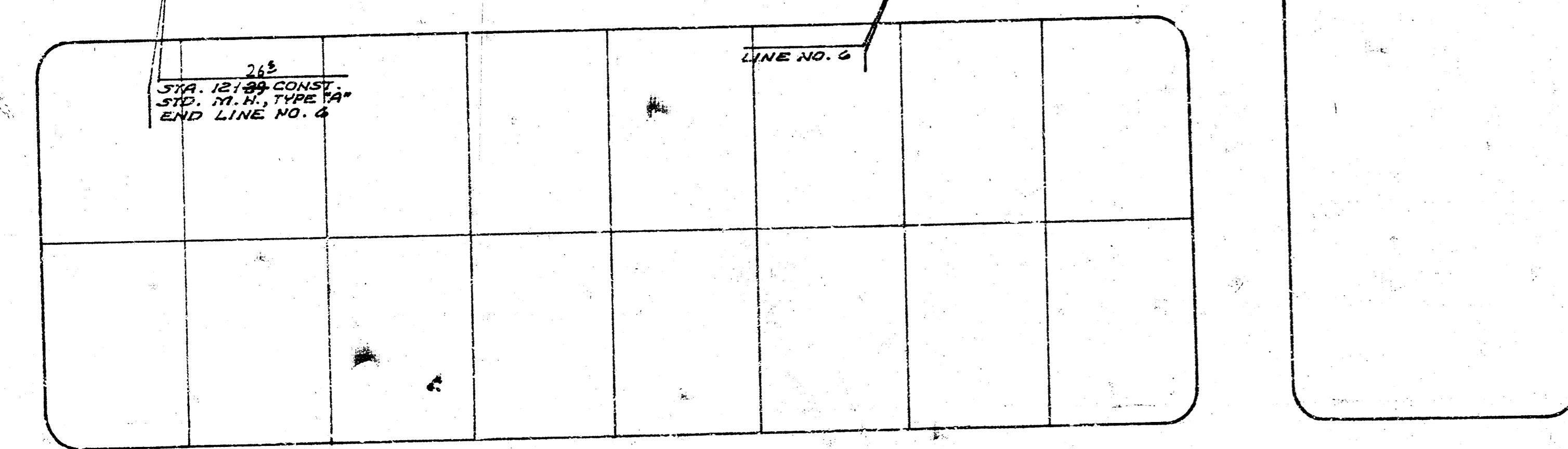
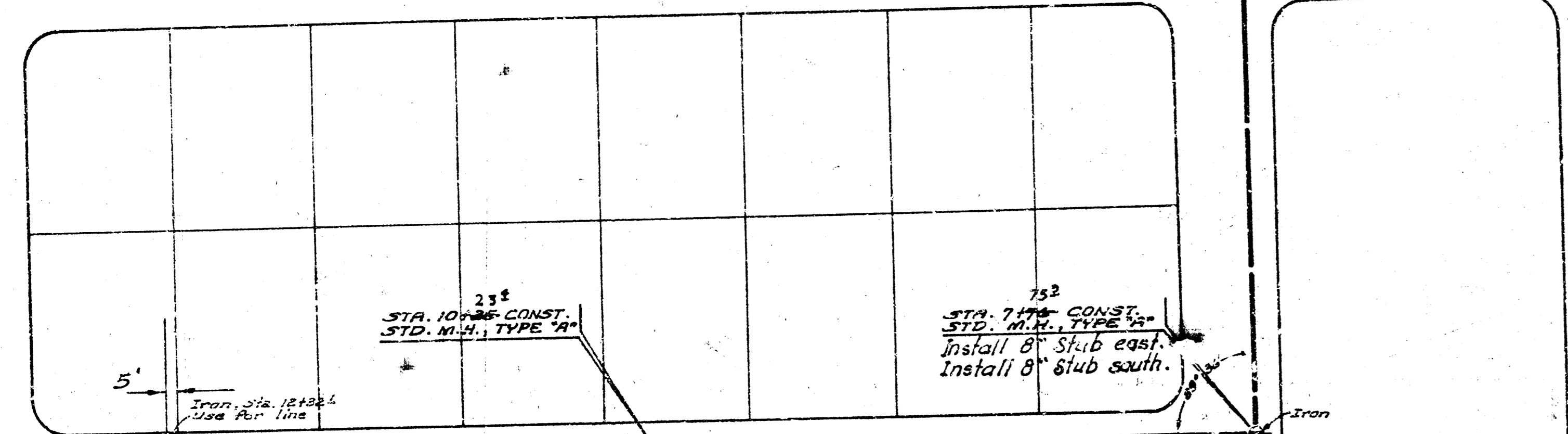
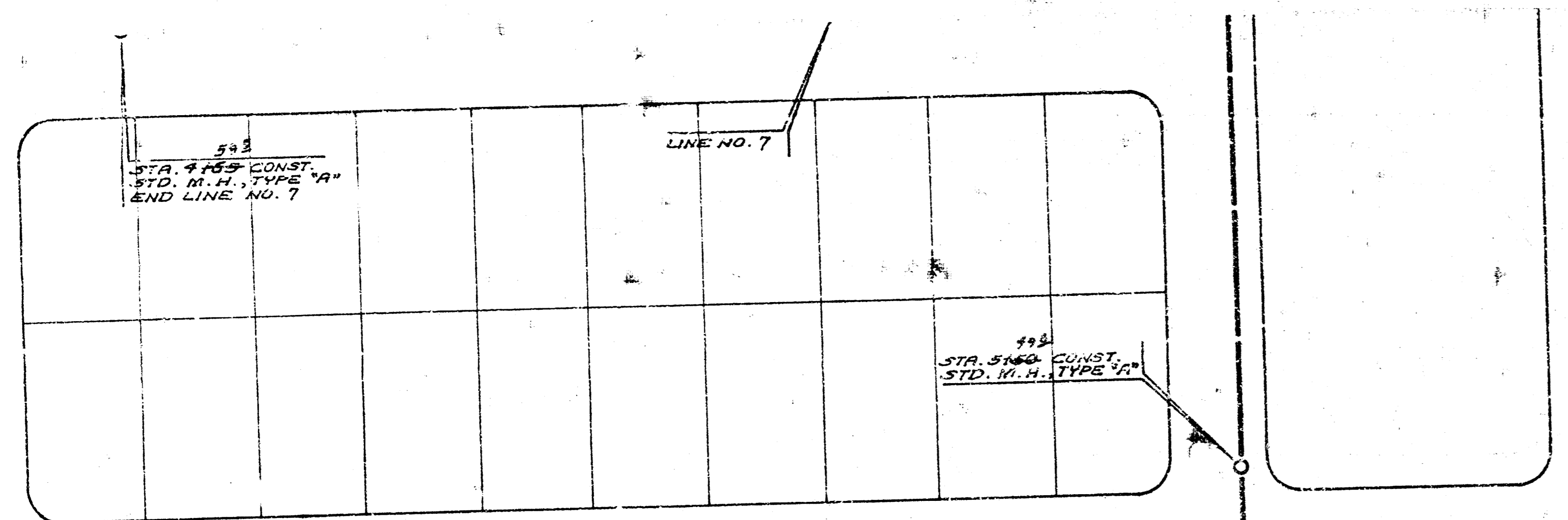

NOTE:
 Manholes # Sta. 12188, Line No. 1, Sta. 11908, Line No. 2, Sta. 11718, Line No. 3, Sta. 4108, Line No. 4, Sta. 918, Line No. 5, Sta. 12178, Line No. 6 and Sta. 4165, Line No. 7, shall be vented with 4" cast iron pipe. Location of riser on vent pipe to be determined by owner, B.A. Ruedabusch.

NOTE TO CONTRACTOR:
 This project will be constructed under the supervision of the CITY ENGINEER and conforming to the specifications of the CITY OF WICHITA. The CONTRACTOR will reimburse the City of Wichita for all cost of Engineering, Plans, and Inspection.

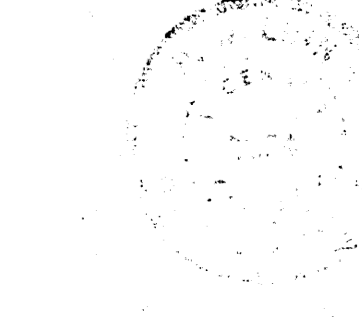
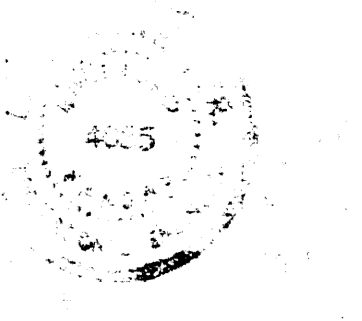

CLARENCE AVE.

As Built
 Final Plans
 5/13/30

**MOBIL MANOR MOBIL HOME PARK
 SANITARY SEWER
 CITY OF WICHITA, KANSAS
 R.W. LINN, CITY ENGINEER
 DATE: SEPT. 1930**

1/4