

CURVE TABLE - C2					
$\Delta = 13^{\circ}20'40''$ R = 500.00' T = 58.49' L = 116.45' LC = 116.19'					
CURVE DATA BASED ON CENTERLINE $\Delta / 2 = 06^{\circ}40'20''$					
STATION	ARC	CHORD LENGTH		DEFLECTION	TOTAL DEFLECTION
		8' Off LtCb	8' Off RtCb		
14+13.44	-	-	-	00°00'00"	00°00'00"
14+25.00	11.56'	11.05'	12.07'	00°39'44"	00°39'44"
14+50.00	25.00'	23.90'	26.10'	01°25'57"	02°05'41"
14+75.00	25.00'	23.90'	26.10'	01°25'57"	03°31'38"
15+00.00	25.00'	26.90'	26.10'	01°25'57"	04°57'34"
15+25.00	25.00'	23.90'	26.10'	01°25'57"	06°23'31"
15+29.89	4.89'	4.68'	5.11'	00°16'49"	06°40'20"

Def/Ft = 3.43775 Min.

PAVING PLANS FOR
CEDAR VIEW VILLAGE

BRISTOL CIRCLE PAVING
SHEET TITLE
PROJECT NUMBER
06189

DESIGN BY
SRS
DRAWN BY
TKL
CHECKED BY
MAB

ISSUED
AUGUST 2008
REVISED
9-11-08

SHEET NO.
6 of 18

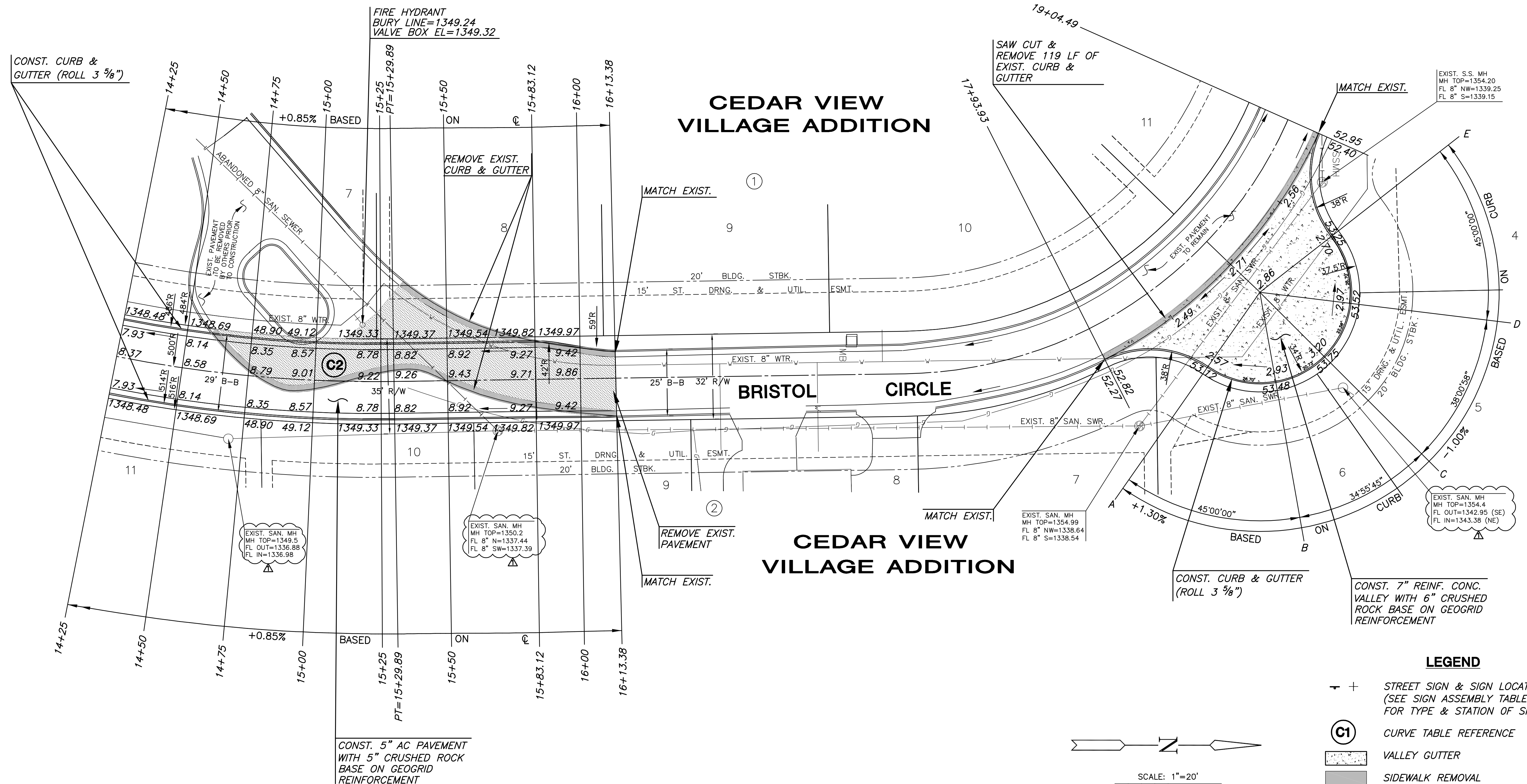

- LEGEND**
- \pm STREET SIGN & SIGN LOCATION (SEE SIGN ASSEMBLY TABLE FOR TYPE & STATION OF SIGN)
 - (C1) CURVE TABLE REFERENCE
 - [Pattern] VALLEY GUTTER
 - [Pattern] SIDEWALK REMOVAL
 - [Pattern] PAVEMENT REMOVAL
 - [Pattern] CURB REMOVAL

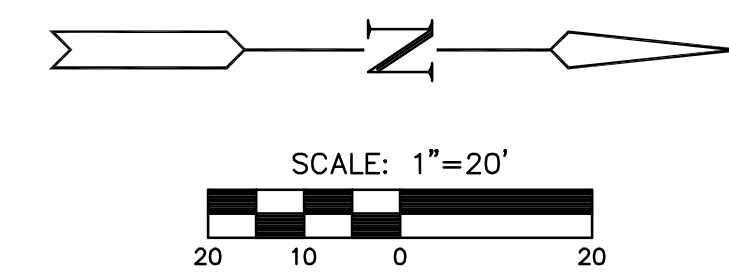

PLOTTER: Tuesday, September 16, 2008 @ 08:30AM

J:\CIVIL\06189\DWG\PAV\06189_EZ.DWG