

STATE	PROJECT NO.	YEAR	SHEET NO.	TOTAL SHEETS
KANSAS	87 N-0349-01	2009	1	133

INDEX OF SHEETS

SHEET NO	DESCRIPTION
1	TITLE SHEET
2	GENERAL NOTES
3-4	TYPICAL SECTIONS
5-13	PAVING PLAN AND PROFILES
14-17	PAVING BUBBLE MAPS
18-27	STORM SEWER PLAN AND PROFILE SHEETS
28-30	STORM SEWER BUBBLE MAPS
31-44	PAVING DETAILS
45-52	STORM SEWER DETAILS
53-54	RETAINING WALL DETAILS
55	MISCELLANEOUS DETAILS
56-59	WATER PLAN AND PROFILE SHEETS
60	WATER BUBBLE MAPS
61-63	WATER DETAILS
64-66	SANITARY SEWER PLAN AND PROFILE SHEETS
67-68	SUMMARY OF QUANTITIES
69-75	EROSION CONTROL
76-79	ROADSIDE IMPROVEMENT PLANS
80-86	TRAFFIC SIGNAL PLANS
87-91	PAVEMENT MARKING AND SIGNING PLANS
92	CONSTRUCTION SEQUENCE SUMMARY
93-106	TRAFFIC CONTROL PLAN
107	DRAINAGE MAP
108-133	CROSS SECTIONS

STATE OF KANSAS
DEPARTMENT OF TRANSPORTATION



PLAN AND PROFILE OF PROPOSED
17TH STREET
FROM GROVE TO HILLSIDE
FEDERAL AID PROJECT

WICHITA, SEDGWICK COUNTY, KANSAS
POPULATION = 335,562
CITY OF WICHITA PAVING PROJECT NO. 472-84766 (OCA# 706966)
CITY OF WICHITA SANITARY SEWER PROJECT NO. 468-84596 (OCA# 620543)
CITY OF WICHITA WATER PROJECT NO. 448-90432 (OCA# 636216)

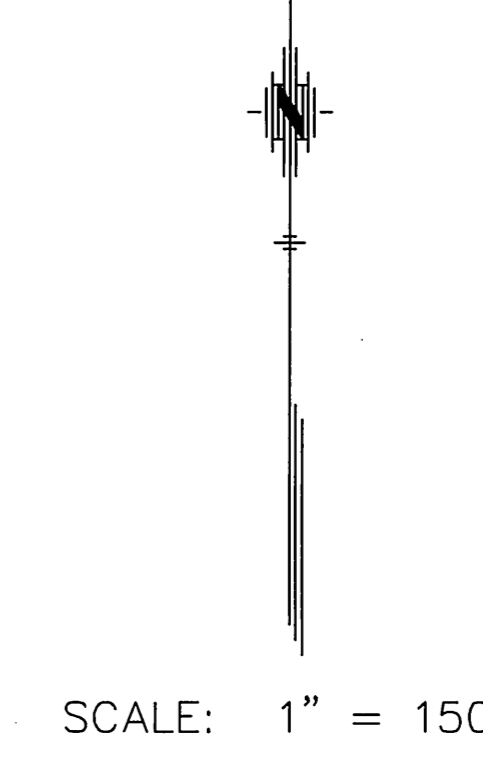

GRADING AND SURFACING
STORM SEWER
PAVEMENT MARKING
SEEDING

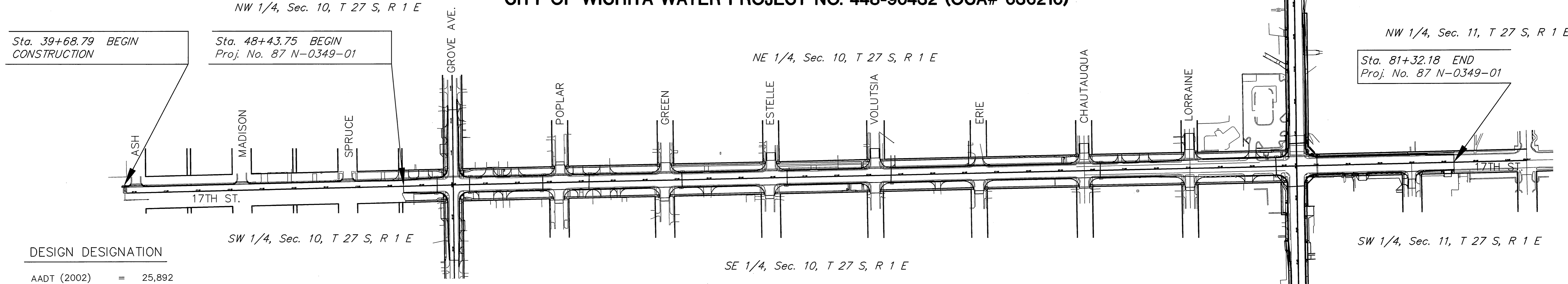
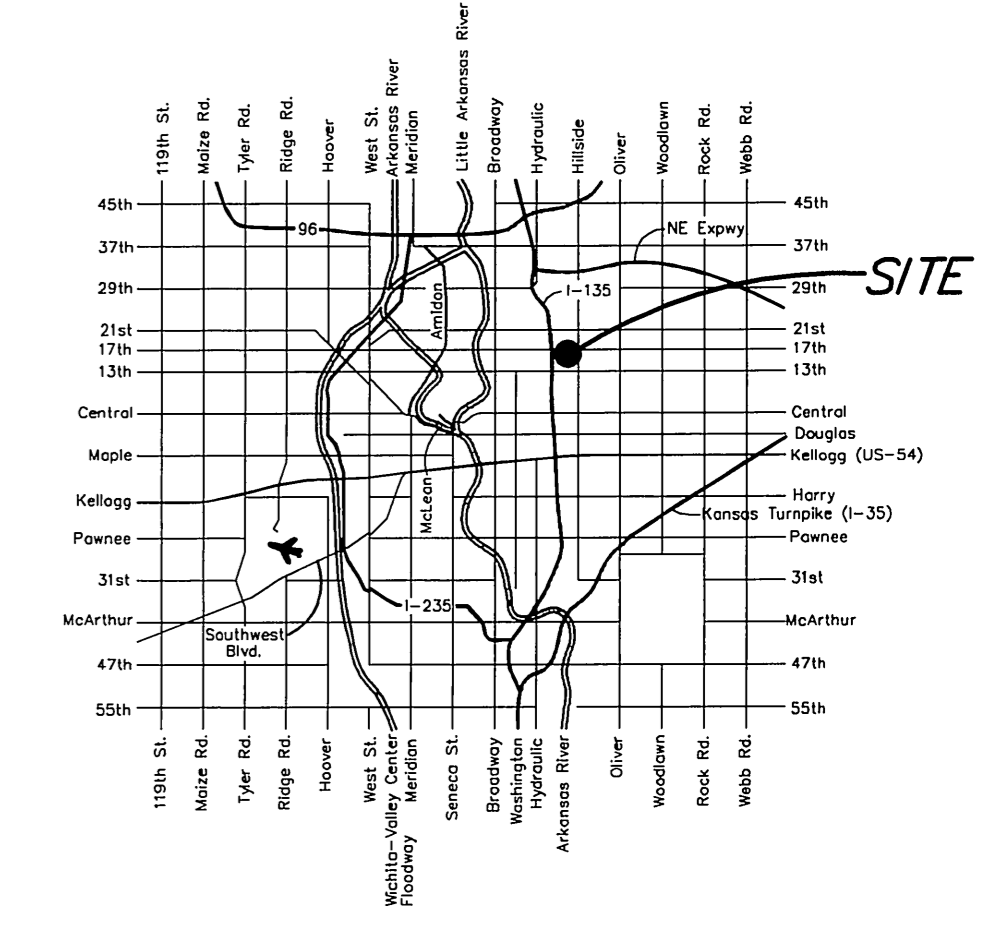

DESIGN DESIGNATION

AADT (2002)	=	25,892
AADT (2030)	=	31,000
DHV	=	10 %
D	=	60 %
T	=	3 %
V	=	35 M.P.H.
Control of Access	=	NONE
Clear Zone	=	6 FT.

CONVENTIONAL SIGNS

COUNTY LINE	---	CENTER LINE OF PROJECT	—+—
CITY LIMITS		TERRACE
STATE OR NATIONAL LINE	----	CULVERTS	— —
TOWNSHIP, SECTION or GRANT LINE	----	DROP INLET & STORM SEWER	— —
PROPERTY LINE	— —	ACCESS CONTROL	— —
HIGHWAY FENCE	— —	POWER POLE	— —
EXISTING FENCE	— —	TELEPHONE POLE	— —
GUARD FENCE	— —	MARSH	— —
CONSTRUCTION LIMITS	— —	HEDGE	— —
RIGHT OF WAY LINE	— —	TREES	— —
TRAVELED WAY	— —	PROFILE ELEVATION	— —
RAILROADS	— —	STREAM or CREEK	— —

GROSS LENGTH OF PROJECT	5,137.73 FT.	
EXCEPTIONS		
ADDITIONS		
NET LENGTH OF PROJECT	5,137.73 FT.	0.97 MILES
NET LENGTH OF BRIDGES	76.86 FT.	0.01 MILES
NET LENGTH OF ROAD	5,060.87 FT.	0.96 MILES

NOTE:
TWO WAY TRAFFIC TO BE CARRIED THROUGH CONSTRUCTION. LOCAL TRAFFIC WILL BE PERMITTED TO ADJACENT PROPERTIES.

PREPARED & SUBMITTED BY
MKEC ENGINEERING CONSULTANTS, INC.
WICHITA, KANSAS

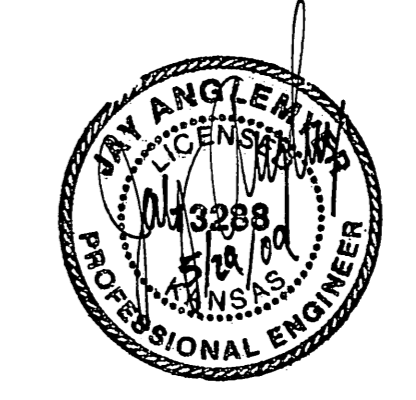

APPROVED — DATE
JIM ARMOUR, P.E.
CITY ENGINEER