

Sta. 10+13.41, Line 1
@ Sta. 47+60.69, 22.11' Lt.
1-8"x8" DIMJ Tee
1-8" Valve Assy. (E)
(MJ Gate)
1-8" Anch. Valve Assy. (S)
(MJ Gate)
6.00' of 8" DI CL Pipe (S)
1-2" Blowoff Assy. (S)
Valve Box Elev.=123.76

Sta. 12+17.91, Line 1
@ Sta. 49+65.19, 22.54' Lt.
Remove Exist. Fire Hydrant
1-Fire Hydrant Assy.
L=12.0'

Sta. 12+94.02, Line 1=
@ Sta. 50+41.31, 22.67' Lt.
1-8"x8" Tapping Sleeve &
Valve To Be Furnished and
Installed by C.O.W. Water
Dept.
Valve Box Elev.=123.58

Sta. 10+00.00, Line 1
@ Sta. 47+60.74, 8.70' Lt.
1-8"x6" 90° DIMJ Reducing Bend
Connect to Exist. 6" Water Line
1-6" DIMJ Cap (N)
Remove 5 L.F. of Existing 6"
(N). Cap exposed end.

Const. 11.0 S.Y. of
Permanent Pavement Patch
See Sh. No. 41

- NOTES:**
- Contractor to verify depth and location of existing utilities prior to construction.
 - All trenches to be sand flushed and vibrated.

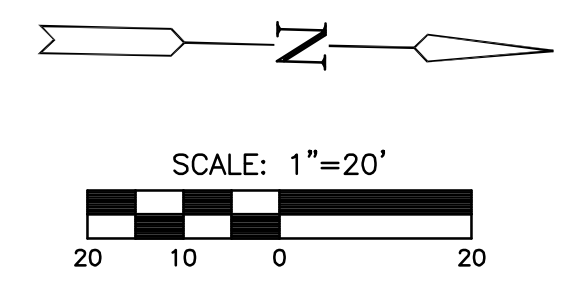

- LEGEND**
- Sidewalk Remove & Replace
 - Permanent Pavement Patch
 - XXXXXX Water Line to be Abandoned

Install new 1" service and connect to new 8" water main. Setter to be connected to existing customer's water service. The Contractor shall coordinate this work.
4-Long Services
1-Short Service

PLAN LINE 1

PROFILE LINE 1

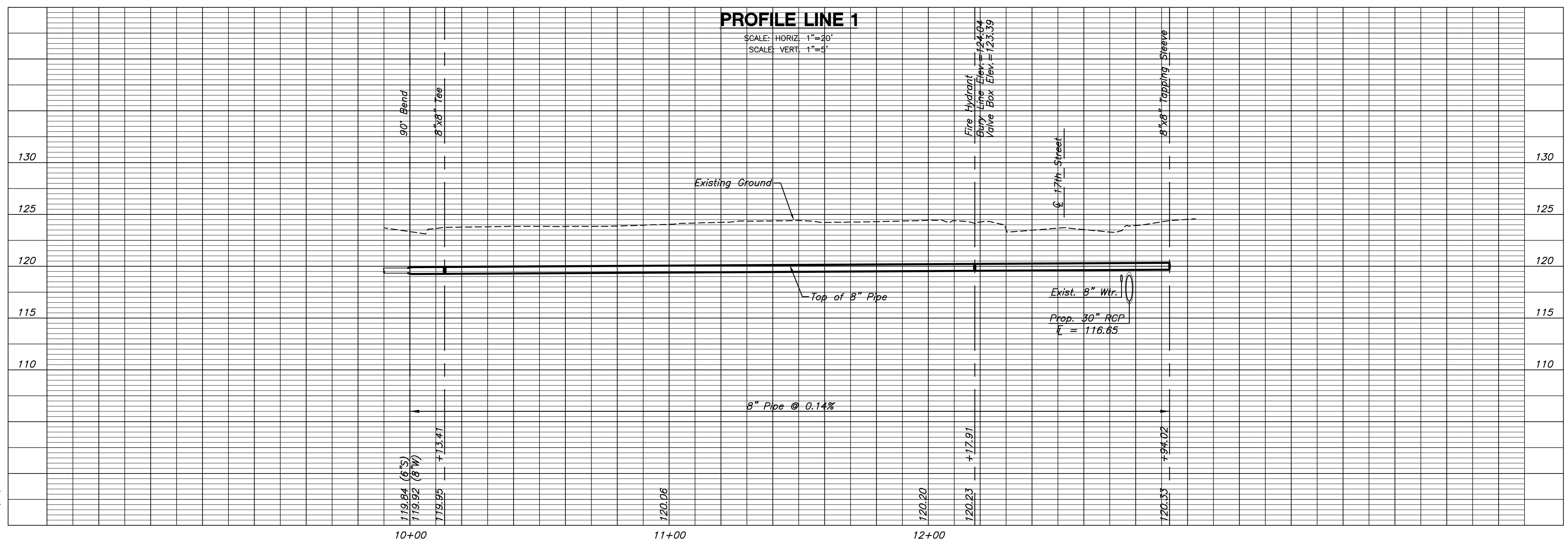

**17th STREET
FROM GROVE TO HILLSIDE**

Water Line 1
SHEET TITLE
87 N-0349-01
PROJECT NUMBER

DESIGN BY: DMU
DRAWN BY: DMU
CHECKED BY: JRA

ISSUED: May 28, 2009
REVISED:

SHEET NO.
56 of 133