

STATE	PROJECT NO.	YEAR	SHEET NO.	SHEETS
KANSAS	87N-0135-01	2005	98	137

PHASE	HANDLING OF TRAFFIC	MAJOR CONSTRUCTION ITEMS	REMARKS
I	Two-way traffic maintained at each location. Traffic control for each location to be maintained independently. Refer to standard traffic control sheets.	Construct sanitary sewer line 1 between manholes 1-2 and 1-3. Construct sanitary sewer line 3.	Construct 2 lanes at a time while traffic is maintained in other two lanes. Construction to proceed from downstream end to upstream end.
II	Two-way traffic maintained on two northern-most lanes of Central. No more than two consecutive side street approaches on the south side of Central may be closed at any given time. Access shall be maintained to either Rockwood Rd. or the west side of Brookside Pkwy at all times. Access shall be maintained to either the east side of Brookside Pkwy or Hillcrest at all times. Oliver and Edgemoor to remain open except as dictated in sub-phases II-A, B and C below.	Construct all water line improvements except those portions in conflict with open traffic lanes and the remainder of sanitary sewer line 1. Construct south extension of the triple 10'x 3' RCB and the south half of the quadruple 10'x5' RCB. Construct the south half of Central improvements including portions of the storm sewer system, driveway and side street approaches and sidewalk.	Asphalt surface courses will not be constructed until phase IV. Refer to general notes concerning access to businesses and drainage in milled areas. Construction of this project will occur concurrently with other construction projects at Central and Oliver and Central and Woodlawn. It will be necessary to coordinate construction with these projects and it may be necessary to alter the traffic control plan to allow for adjacent construction. Coordination will be managed by the City.
II-A	Phase II traffic control still in operation. Two-way traffic on Edgemoor maintained on the two eastern-most lanes of Edgemoor.	Construct the portions of the improvements within the work zone shown on sheet 100.	
II-B	Phase II traffic control still in operation. Two-way traffic on Edgemoor maintained on the two western-most lanes of Edgemoor.	Construct the portions of the improvements within the work zone shown on sheet 100.	
II-C	Phase II traffic control still in operation. Two-way traffic on Edgemoor maintained on the two outer lanes of Edgemoor.	Construct the portions of the improvements within the work zone shown on sheet 100.	This phase can be eliminated and the work completed during phase II-B if allowed by the Engineer.
III	Two-way traffic maintained on two Southern-most lanes of Central. No more than two consecutive side street approaches on the north side of Central may be closed at any given time. Access shall be maintained to either Battin or Old Manor at all times. Access shall be maintained to one of the entrances to Carriage Pkwy. at all times. Oliver and Edgemoor to remain open except as dictated in sub-phases III-A, B and C below.	Construct remaining portions of water line improvements and sanitary sewer line 2. Construct north extension of the triple 10'x 3' RCB and the north half of the quadruple 10'x5' RCB. Construct the north half of Central improvements including portions of the storm sewer system, driveway and side street approaches and sidewalk.	Asphalt surface courses will not be constructed until phase IV. Refer to general notes concerning access to businesses and drainage in milled areas. Construction of this project will occur concurrently with other construction projects at Central and Oliver and Central and Woodlawn. It will be necessary to coordinate construction with these projects and it may be necessary to alter the traffic control plan to allow for adjacent construction. Coordination will be managed by the City.
III-A	Phase III traffic control still in operation. Two-way traffic on Edgemoor maintained on the two outer lanes of Edgemoor.	Construct the portions of the improvements within the work zone shown on sheet 102.	This phase can be eliminated and the work completed during phase III-C if allowed by the Engineer.
III-B	Phase III traffic control still in operation. Two-way traffic on Edgemoor maintained on the two western-most lanes of Edgemoor.	Construct the portions of the improvements within the work zone shown on sheet 102.	
III-C	Phase III traffic control still in operation. Two-way traffic on Edgemoor maintained on the two eastern-most lanes of Edgemoor.	Construct the portions of the improvements within the work zone shown on sheet 102.	
IV	Perform all construction activities in this phase one lane at a time. Close traffic on lane being constructed over entire length of project. Switch traffic control from one lane to the next as required. Refer to standard traffic control sheets.	Construct asphalt surface course over entire project. Mill in areas designated and construct asphalt base courses if not done previously. Install permanent pavement markings and permanent signing.	Coordinate work in this phase with the Engineer in advance.

General Notes:

All signs and pavement markings conflicting with construction traffic control shall be covered or removed as directed by the Engineer. All conflicting markings removed outside of the work zone shall be reinstalled by the contractor at the project completion.

As the various construction activities progress, certain situations may arise that will preclude adhering to the original construction sequence or which, in the opinion of the Contractor, would readily adapt themselves to a more efficient phasing operation. Should this occur, the Contractor may submit to the Engineer an alternative plan for approval.

Contractor shall maintain existing drainage system during construction and address local drainage issues as necessary during construction. Temporary drainage measures will be subsidiary to other items in the contract. Contractor shall provide for drainage in milled areas opened to traffic. Ponded stormwater in milled areas will not be allowed.

Maintain access to all driveways and entrances within the project limits at all times. Driveways 16' wide and wider shall be constructed half at a time with the other half remaining open. Driveways less than 16' may be closed completely during construction. Where a grade differential is created due to milling, construct an asphalt wedge in order to maintain access.

Phase II of this project will directly conflict with Phases 4 and 5 of project 472-83874. Phase III of this project will directly conflict with phases 1 and 2 of project 472-83874.

A separate project (472-84362) will involve the reconstruction of the Central and Oliver intersection. The Contractor will be required to coordinate construction activities with the Contractor selected for project 472-84362. Restriction of traffic to one-lane in each direction will not be allowed on Oliver and Edgemoor at the same time.

LEGEND

- ▬▬▬ Type III Barricades with lights
- ◊ Mount On Type III Barricade
- Type B Warning Light
- One Post Sign
- ↔ Two Post Sign
- ▬ Traffic Lane
- ▨ Work Area
- Reflectorized Drum
- Tubular Marker
- ▬ Vertical Panel
- △ Mount Overhead on Signal Cross-arm

Note:
4" Solid White Edge Lines Are Required Along Existing Curbs.

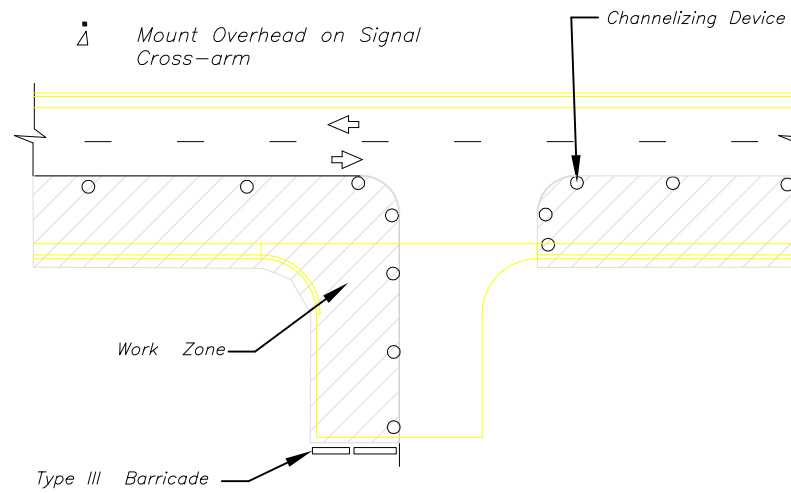

TYPICAL DRIVEWAY ENTRANCE CONSTRUCTION

Maintain access to businesses at all times. If a single property has multiple entrances, one entrance at a time may be closed for construction.

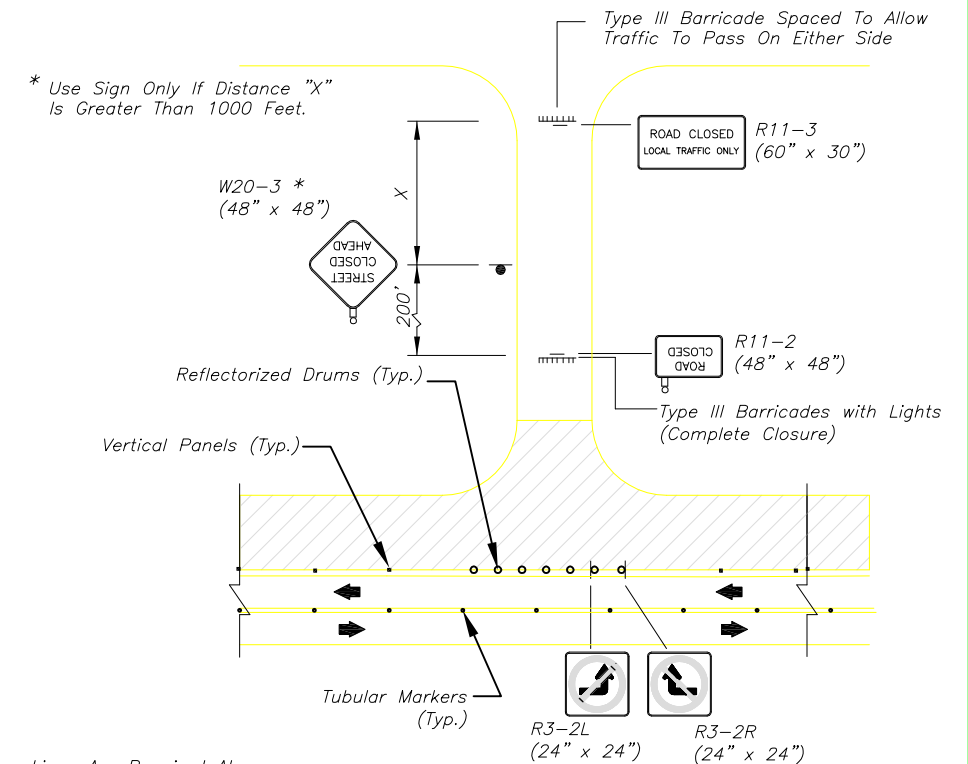

TYPICAL CLOSED SIDE STREET

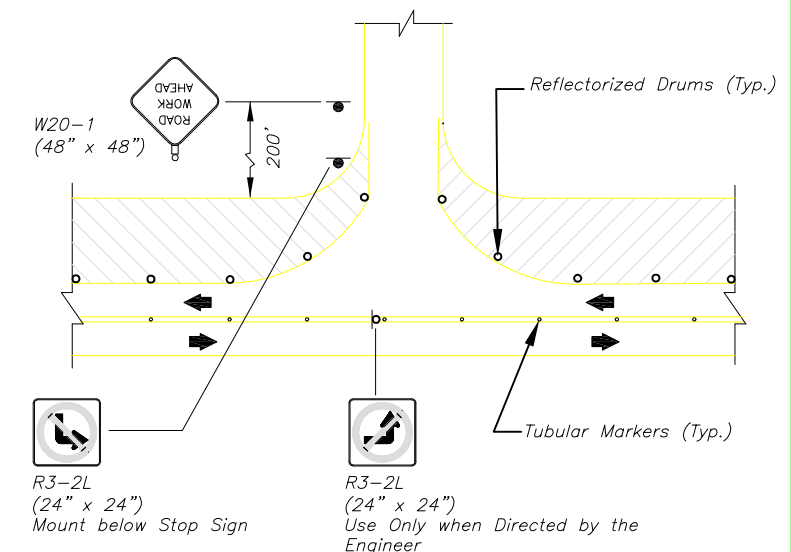

TYPICAL ENTRANCE AND SIDE STREET

H:\CIVIL\03149\dwg\Details\CONST_SEQ.dwg 07/06/2006 04:05:18 PM CST

KANSAS DEPARTMENT OF TRANSPORTATION

CONSTRUCTION SEQUENCE

PROJECT NO. 87N-0135-01 SEDGWICK CO.

MKEC ENGINEERING CONSULTANTS, INC.
WICHITA, KANSAS

DESIGNED BY: JRA	CHECKED BY: JRA
DRAWN BY: JSM	DATE: DEC 05 SHEET 98 OF 137