

FHWA REGION NO.	STATE	PROJECT NO.	FISCAL YEAR	SHEET NO.	TOTAL SHEETS
7	KANSAS	87N-0503-01	2009	14	101

FEDERAL Project No. ARRA-N050(301)

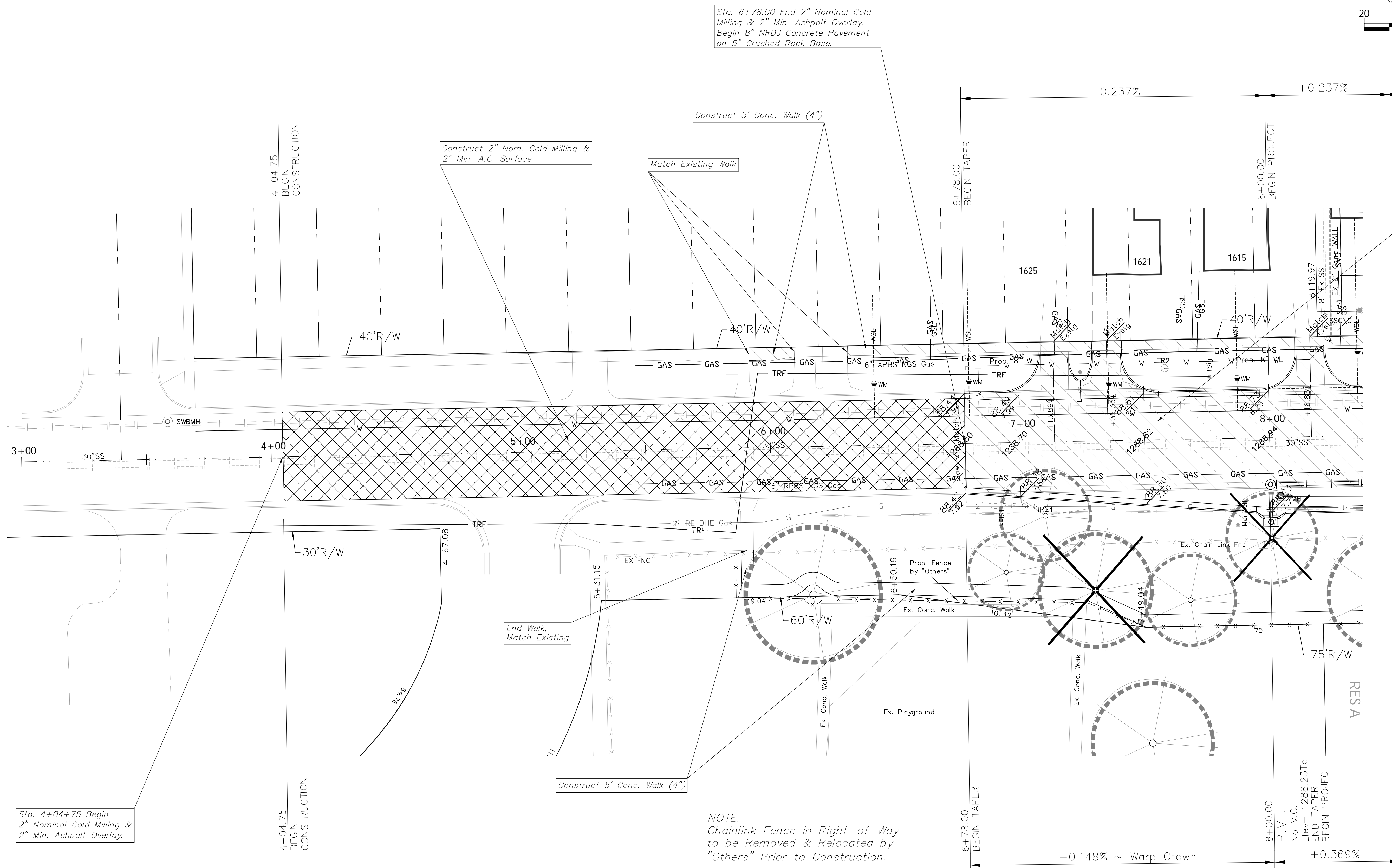
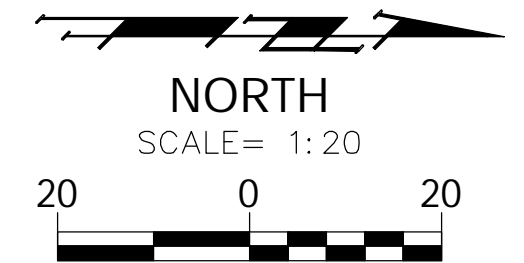

Sta. 6+78.00 End 2" Nominal Cold Milling & 2" Min. Asphalt Overlay. Begin 8" NRDJ Concrete Pavement on 5" Crushed Rock Base.

Construct 2" Nom. Cold Milling & 2" Min. A.C. Surface

Construct 5' Conc. Walk (4")

Match Existing Walk

Construct 8" NRDJ Conc. Pvmt. on 5" Crushed Rock Base

Sta. 4+04+75 Begin 2" Nominal Cold Milling & 2" Min. Asphalt Overlay.

NOTE:
Chainlink Fence in Right-of-Way to be Removed & Relocated by "Others" Prior to Construction.

- Note:** Trees/Shrubs to be removed are marked thus:
- Note:** Mill & Overlay are Indicated By:
- Note:** Pavement, Sidewalks, and Etc. To Be Removed Are Indicated By: