

FHWA REGION NO.	STATE	PROJECT NO.	FISCAL YEAR	SHEET NO.	TOTAL SHEETS
7	KANSAS	87N-0503-01	2009	15	101

FEDERAL Project No. ARRA-N050(301)

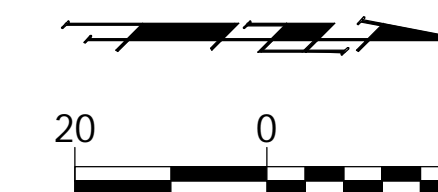

NOTE: See Joint Dimension Sheet for Intersection Details

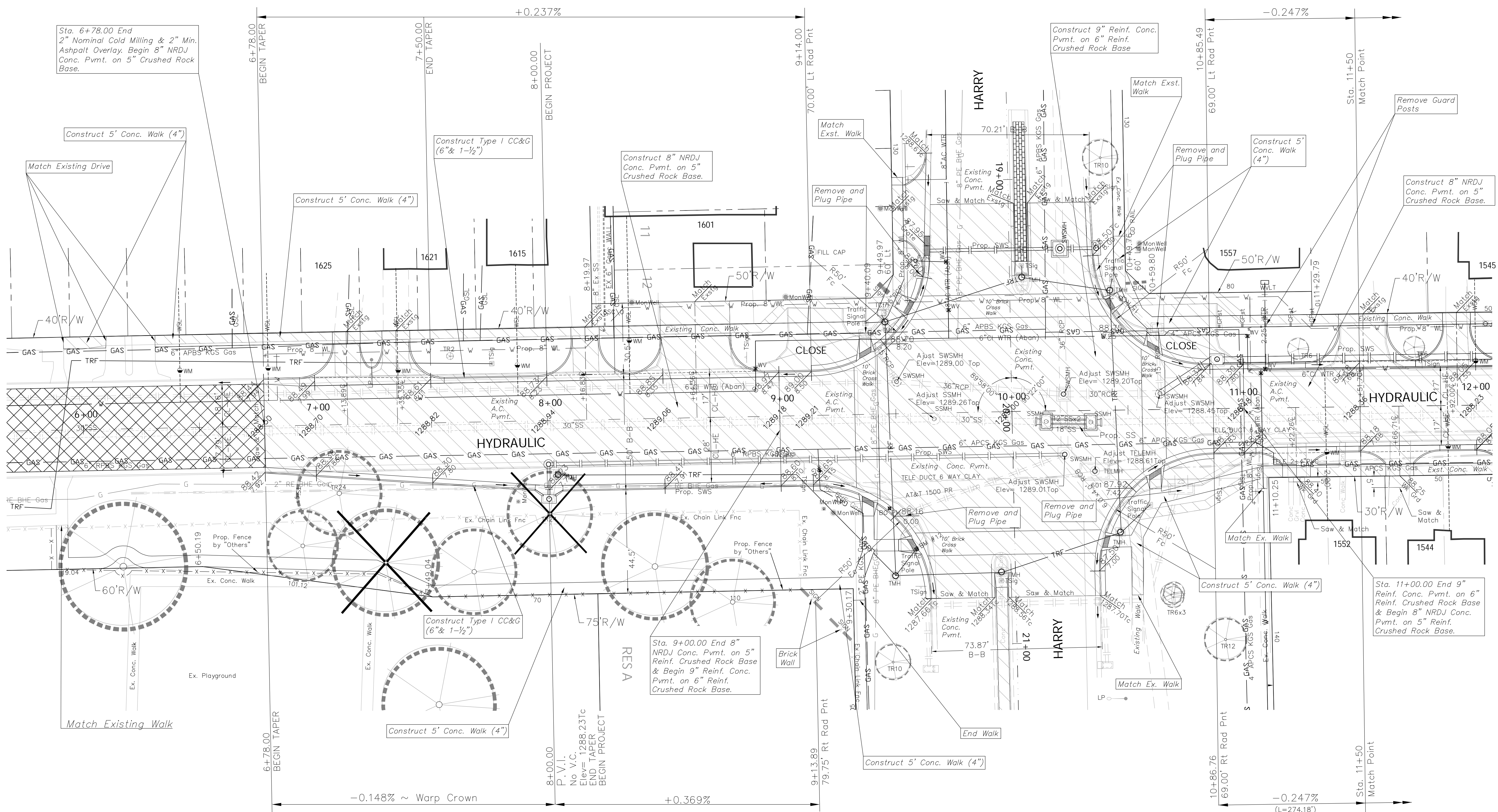

NOTE:
Chainlink Fence in Right-of-Way to be Removed & Relocated by "Others" Prior to Construction.

Note:
Trees/Shrubs to be removed are marked thus:

Note:
Mill & Overlay are Indicated By:

Note:
Pavement, Sidewalks, and Etc. To Be Removed Are Indicated By:

Drawing File: E:\eng\Hydraulic_Kellogg_to_Harry_Pave\Land\dwg\ACADBase.dwg
Project No. 0710 E 968 CAPITAL IMPROVEMENT PROJECT
Design: KK
Drawn: Staff
Approved: JFB
Scale: NOTED

HYDRAULIC AVENUE from HARRY to KELLOGG

Baughman Baughman Company, P.A.
315 Ellis St. Wichita, KS 67211 P 316-262-7271 F 316-262-0149
ENGINEERING | SURVEYING | PLANNING | LANDSCAPE ARCHITECTURE

September 2009
SHEET 15 OF 101