

FHWA REGION NO.	STATE	PROJECT NO.	FISCAL YEAR	SHEET NO.	TOTAL SHEETS
7	KANSAS	87N-0503-01	2009	19	101

FEDERAL Project No. ARRA-N050(301)

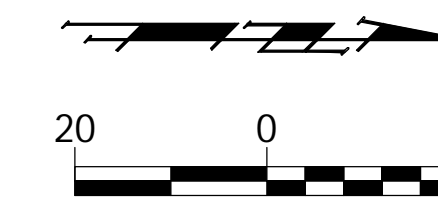

Construct 8" Reinf. Conc. V.G. Pvmt. on 5" Reinf. Crushed Rock Base W/Mono Edge Curb (6")

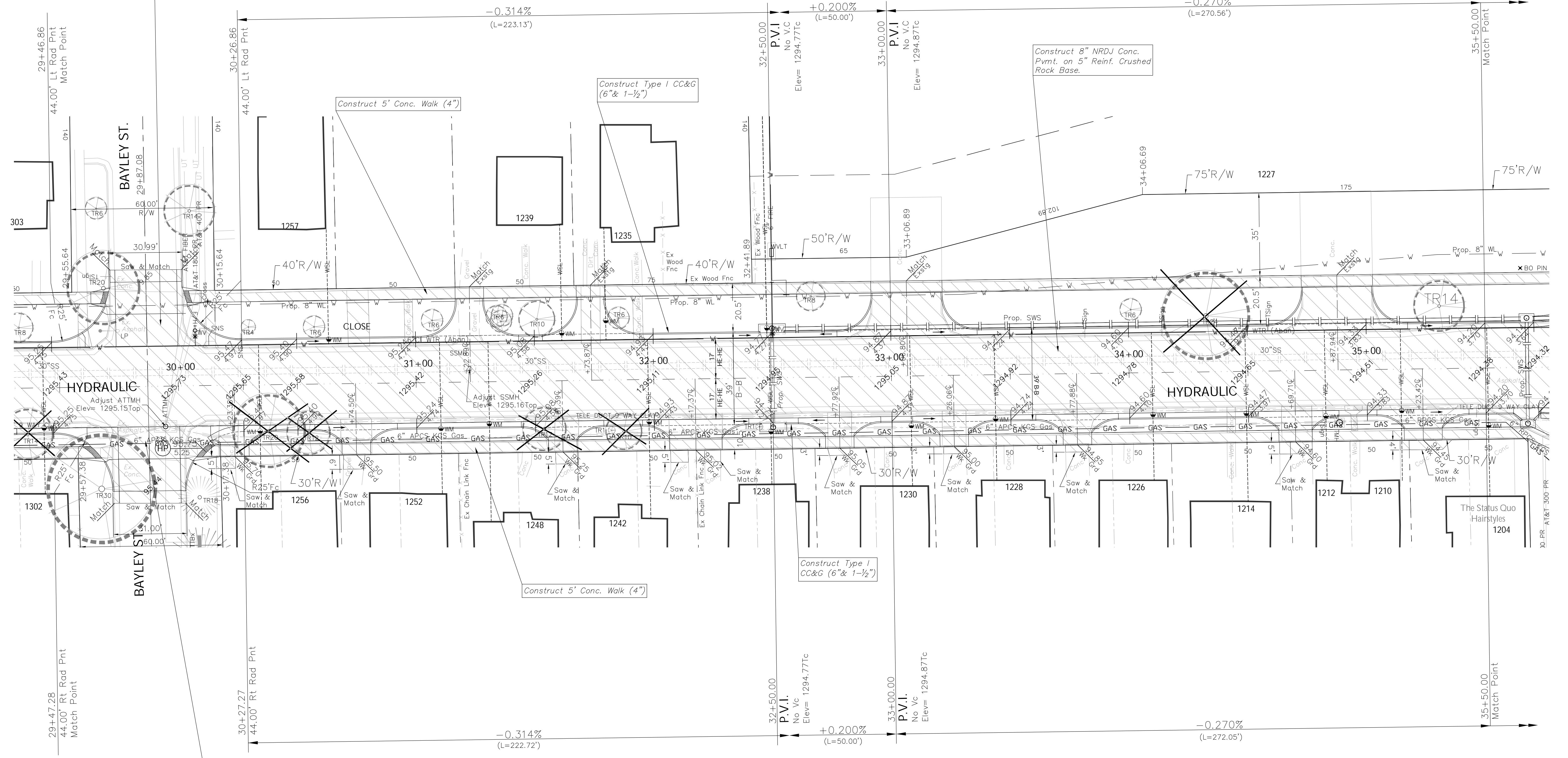

Construct 8" Reinf. Conc. V.G. Pvmt. on 5" Reinf. Crushed Rock Base W/Mono Edge Curb (6")

Note:
Trees/Shrubs to be removed are marked thus:

Note:
Pavement, Sidewalks, and Etc. To Be Removed Are Indicated By:

Drawing File: E:\eng\Hydraulic\Kellogg to Harry Pav\Land\dwg\ACAD Base.dwg
 Project No. 07-10 E 968 CAPITAL IMPROVEMENT PROJECT
HYDRAULIC AVENUE from HARRY to KELLOGG
 STA 29+50 to STA 35+50

Baughman Company, P.A.
 315 Ellis St. Wichita, KS 67211 P 316-262-7271 F 316-262-0149
 ENGINEERING | SURVEYING | PLANNING | LANDSCAPE ARCHITECTURE

September 2009
 SHEET 19 OF 101