

FHWA REGION NO.	STATE	PROJECT NO.	FISCAL YEAR	SHEET NO.	TOTAL SHEETS
7	KANSAS	87N-0503-01	2009	25	101

FEDERAL Project No. ARRA-N050(301)

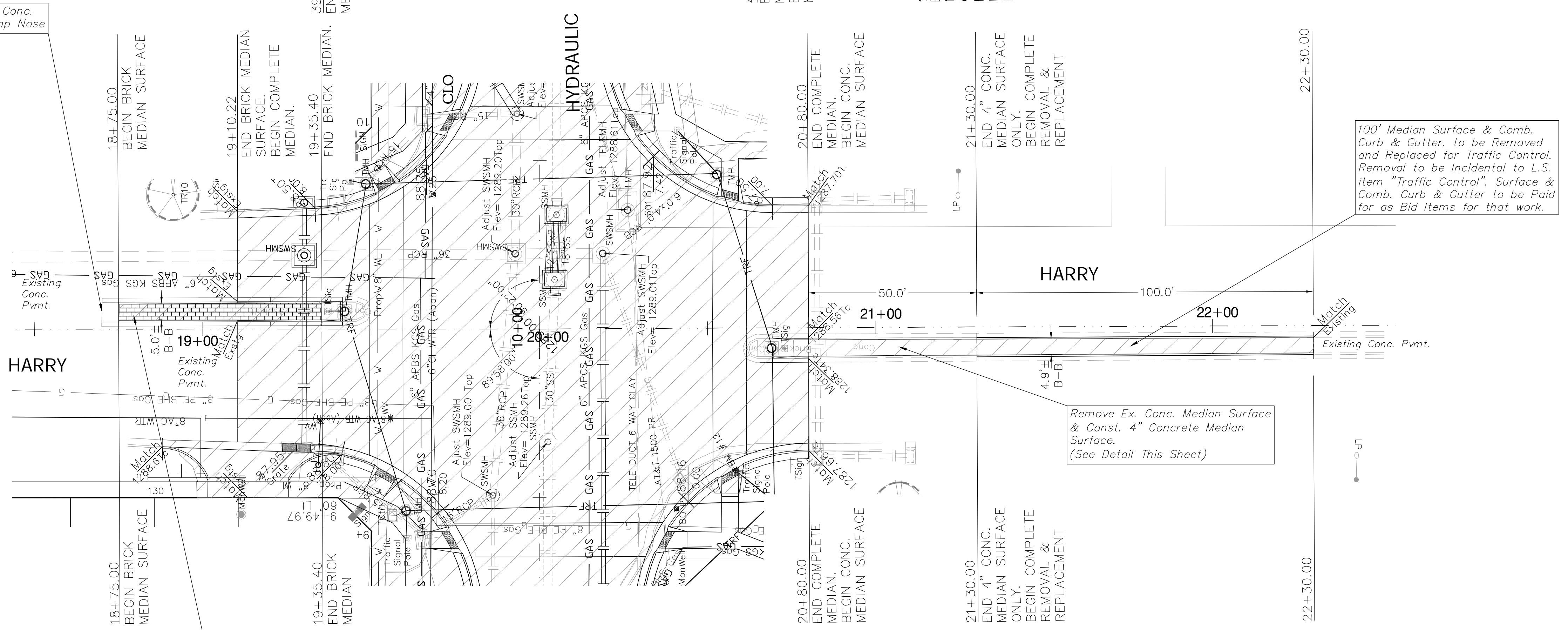
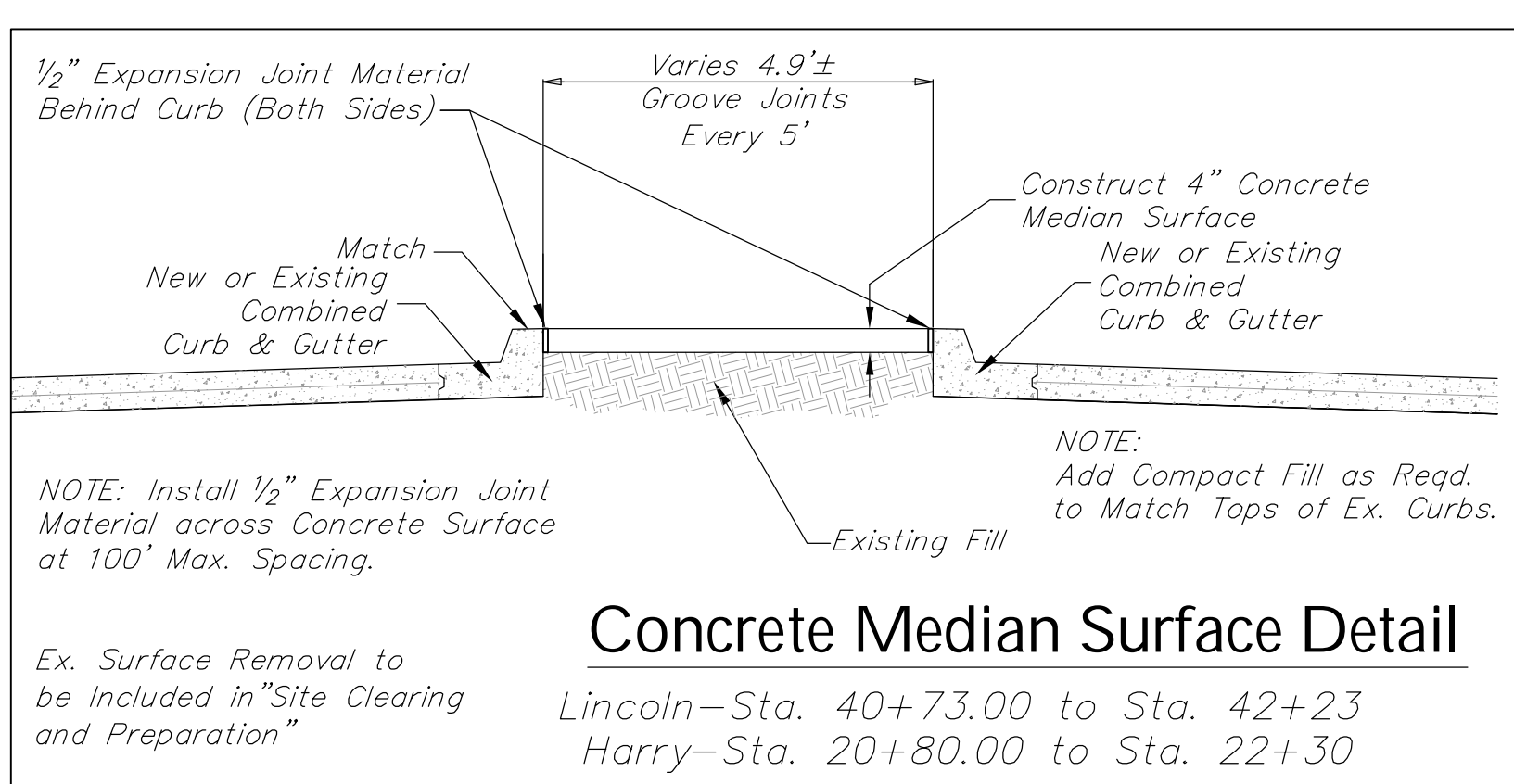
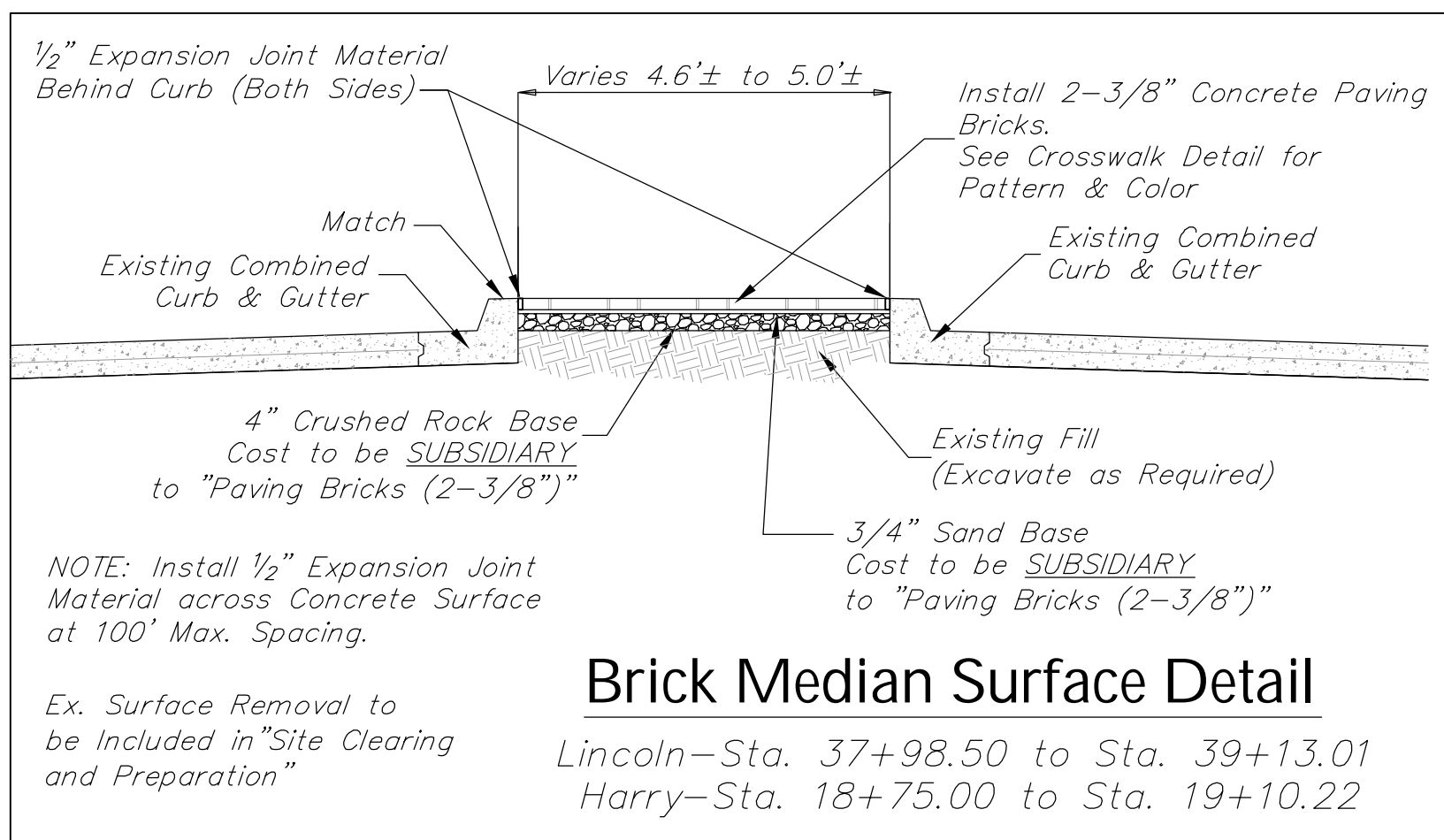
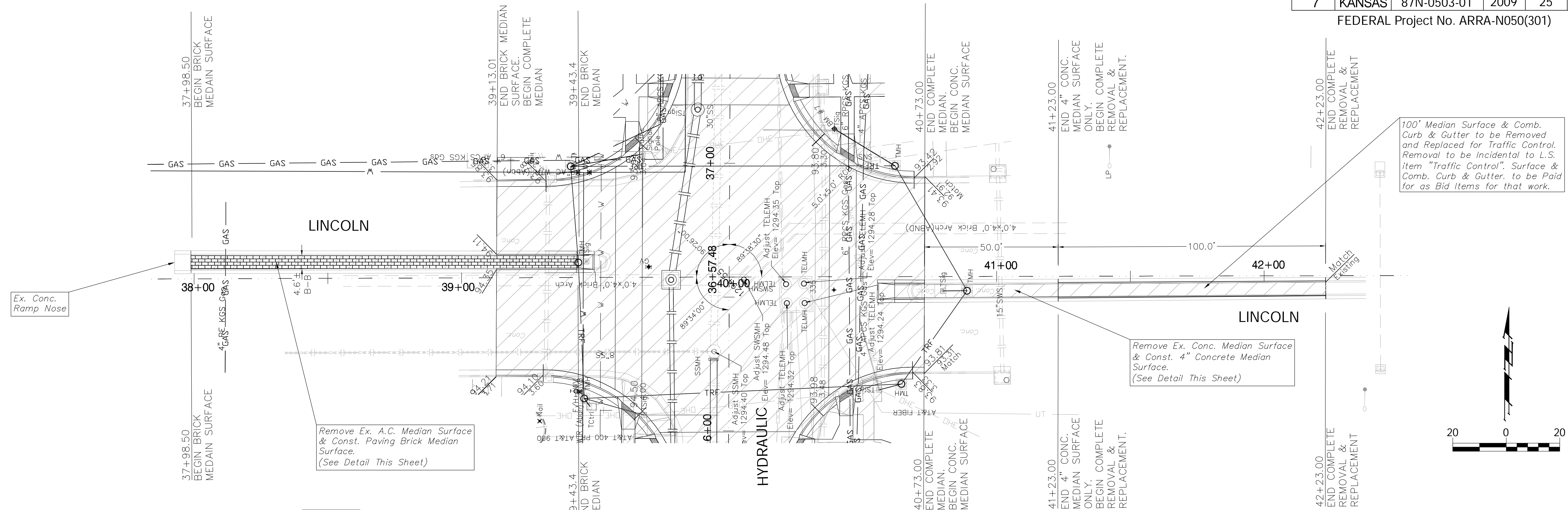

Remove Ex. A.C. Median Surface & Const. Paving Brick Median Surface. (See Detail This Sheet)

Note:
 Trees/Shrubs to be removed are marked thus:

Note:
 Pavement, Sidewalks, and Etc. To Be Removed Are Indicated By:

Drawing File: E:\eng\Hydraulic_Kellogg to Harry\Land\dwg\ACADBase.dwg
 Design: KK
 Drawn: Staff
 Approved: JFB
 Scale: NOTED

Project No. 0710 E 968 CAPITAL IMPROVEMENT PROJECT
HYDRAULIC AVENUE from HARRY to KELLOGG
 STA 57+50 to STA 61+00

Baughman **Baughman Company, P.A.**
 315 Ellis St. Wichita, KS 67211 P 316-262-7271 F 316-262-0149
 ENGINEERING | SURVEYING | PLANNING | LANDSCAPE ARCHITECTURE