

FHWA REG. NO.	STATE	PROJECT NO.:	YEAR	SHEET NUMBER	TOTAL SHEETS
7	KANSAS	87 N-0502-01	2009	138	226
A.R.R.A-N05(201)					

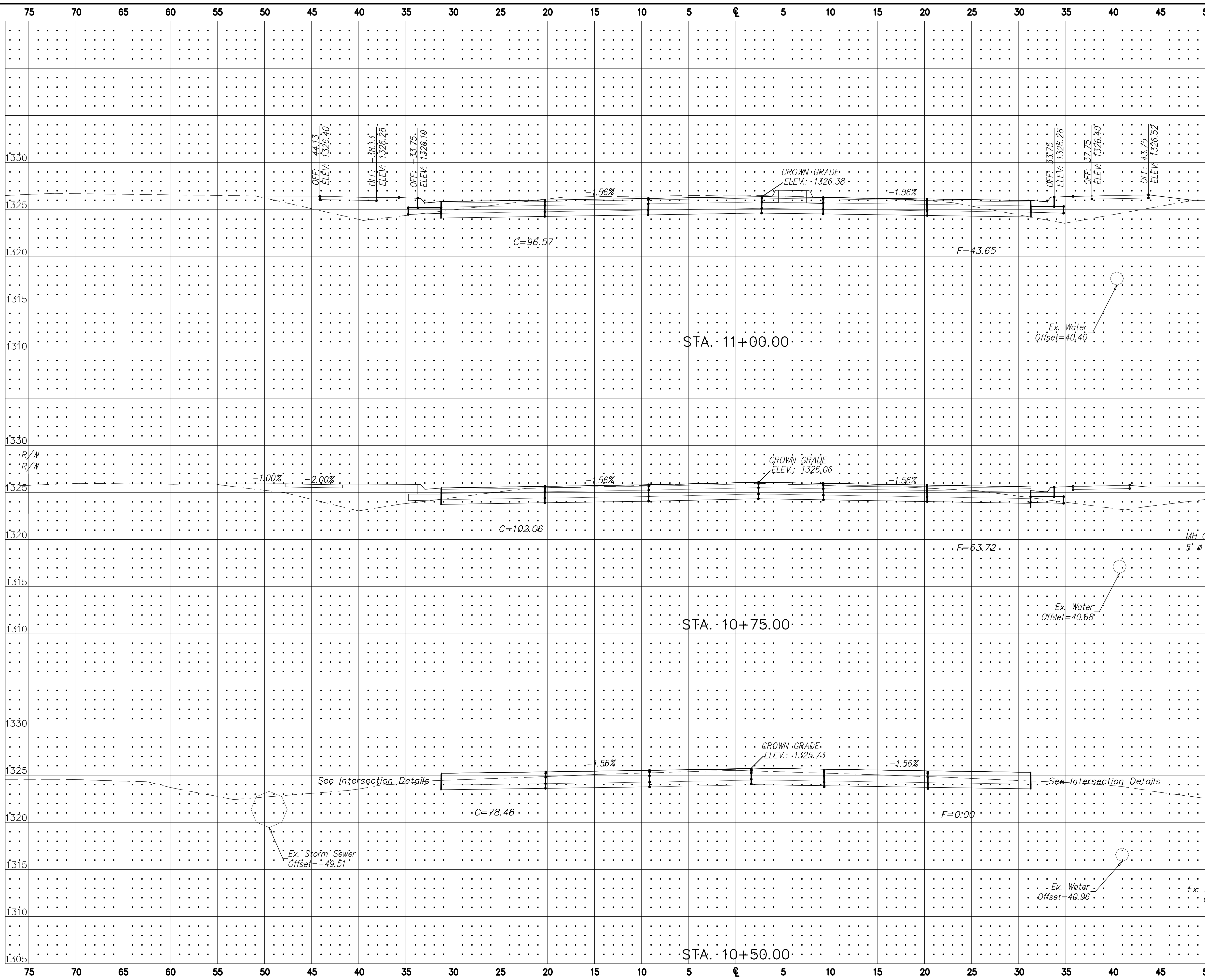

MAIZE ROAD	WEST KELLOGG AVE. TO PAWNEE AVE.	CITY OF WICHITA, KANSAS
POE & ASSOCIATES, INC.	CONSULTING ENGINEERS	5940 E. Central, Suite 200 • Wichita, KS 67208-0242
Engineer:	P. FERGUSON	Phone 316/685-4114 • FAX 316/685-4444
Designer:	K. WARREN	
KDOT Job No.:	87 N-0502-01	Proj. Job No.:
Date:	AUG 2008	