

FHWA REG. NO.	STATE	PROJECT NO.:	YEAR	SHEET NUMBER	TOTAL SHEETS
7	KANSAS	87 N-0502-01	2009	WL11	WL15
A.R.R.A-N05(201)					

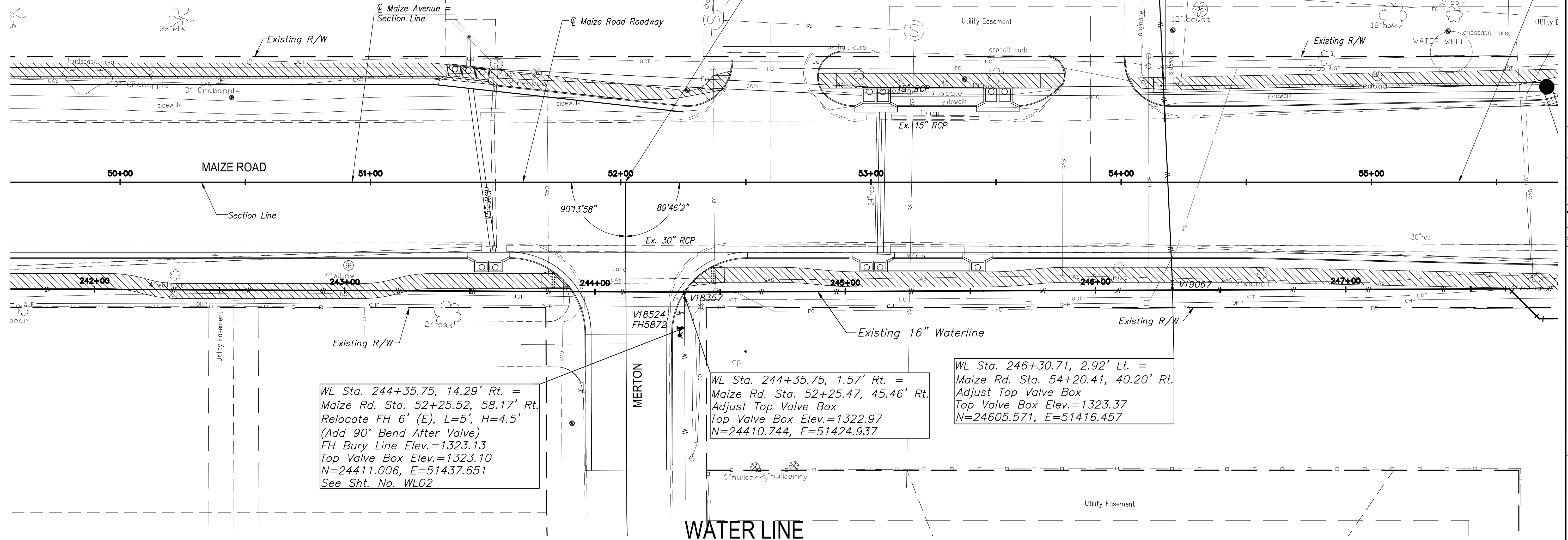
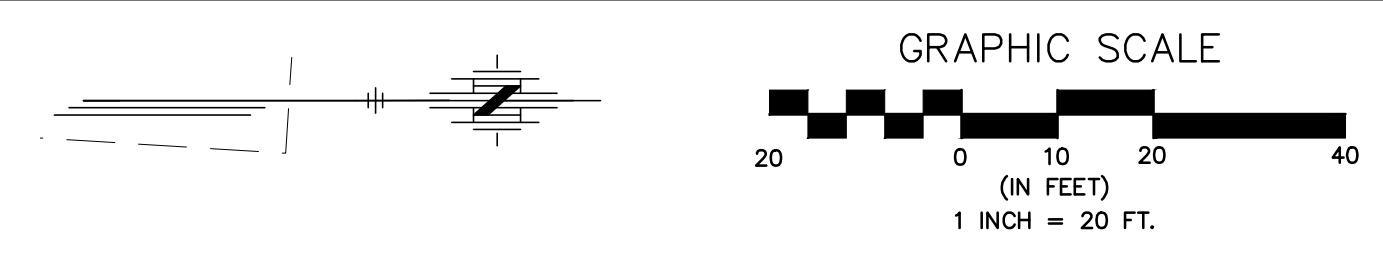

WL Sta. 244+35.75, 14.29' Rt. =
 Maize Rd. Sta. 52+25.52, 58.17' Rt.
 Relocate FH 6' (E), L=5', H=4.5'
 (Add 90° Bend After Valve)
 FH Bury Line Elev.=1323.13
 Top Valve Box Elev.=1323.10
 N=24411.006, E=51437.651
 See Sht. No. WL02

WL Sta. 244+35.75, 1.57' Rt. =
 Maize Rd. Sta. 52+25.47, 45.46' Rt.
 Adjust Top Valve Box
 Top Valve Box Elev.=1322.97
 N=24410.744, E=51424.937

WL Sta. 246+30.71, 2.92' Lt. =
 Maize Rd. Sta. 54+20.41, 40.20' Rt.
 Adjust Top Valve Box
 Top Valve Box Elev.=1323.37
 N=24605.571, E=51416.457

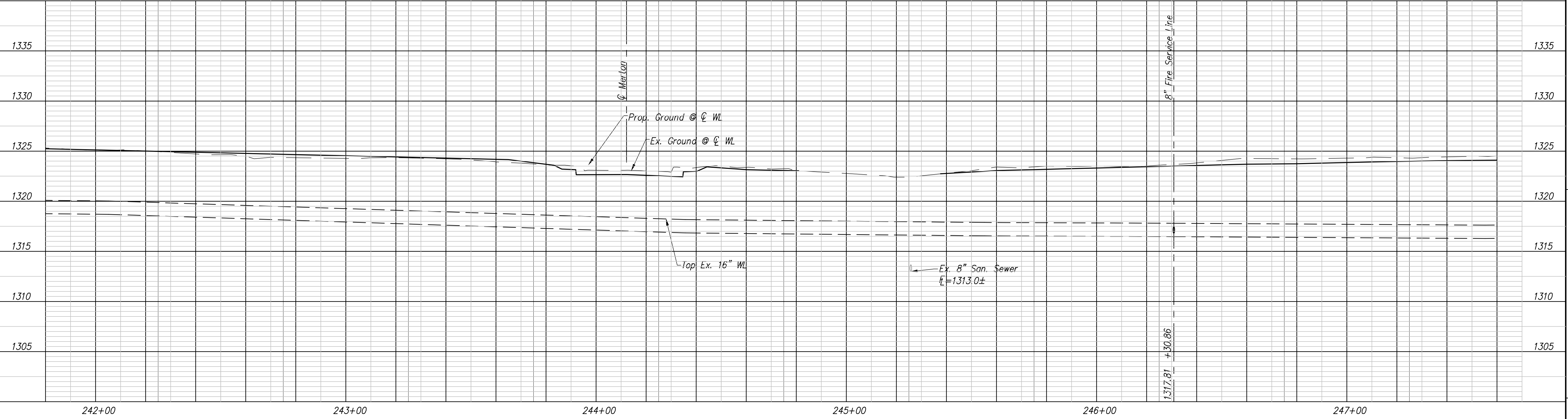

No.	Date	By	Approved	Revision

MAIZE ROAD
 WEST KELLOGG AVE. TO PAWNEE AVE.
 CITY OF WICHITA, KANSAS
 WATER PLAN P & P 241+80 to 247+60

POE & ASSOCIATES, INC.
 CONSULTING ENGINEERS
 5940 E. Central, Suite 200 • Wichita, KS 67208-4242
 Phone 316/685-4114 • FAX 316/685-4444

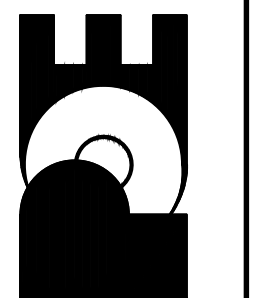

Engineer: P. FERGUSON
 Designer: K. WARREN
 KDOT Job No.: 87 N-0502-01 PoE Job No.: 1935
 Date: SEPTEMBER 2009
 Sheet
 WL11 of WL15