

FHWA Reg. No.	State	Project Number	Year	Sheet Number	Total Sheets
7	Kansas	87 N-0502-01	2009	LS 9	11
A.R.R.A. - N05(201)					

**Maize Road Streetscape / Pawnee to Kellogg**  
Landscape Plan — SP 46+71 to SP 52+59

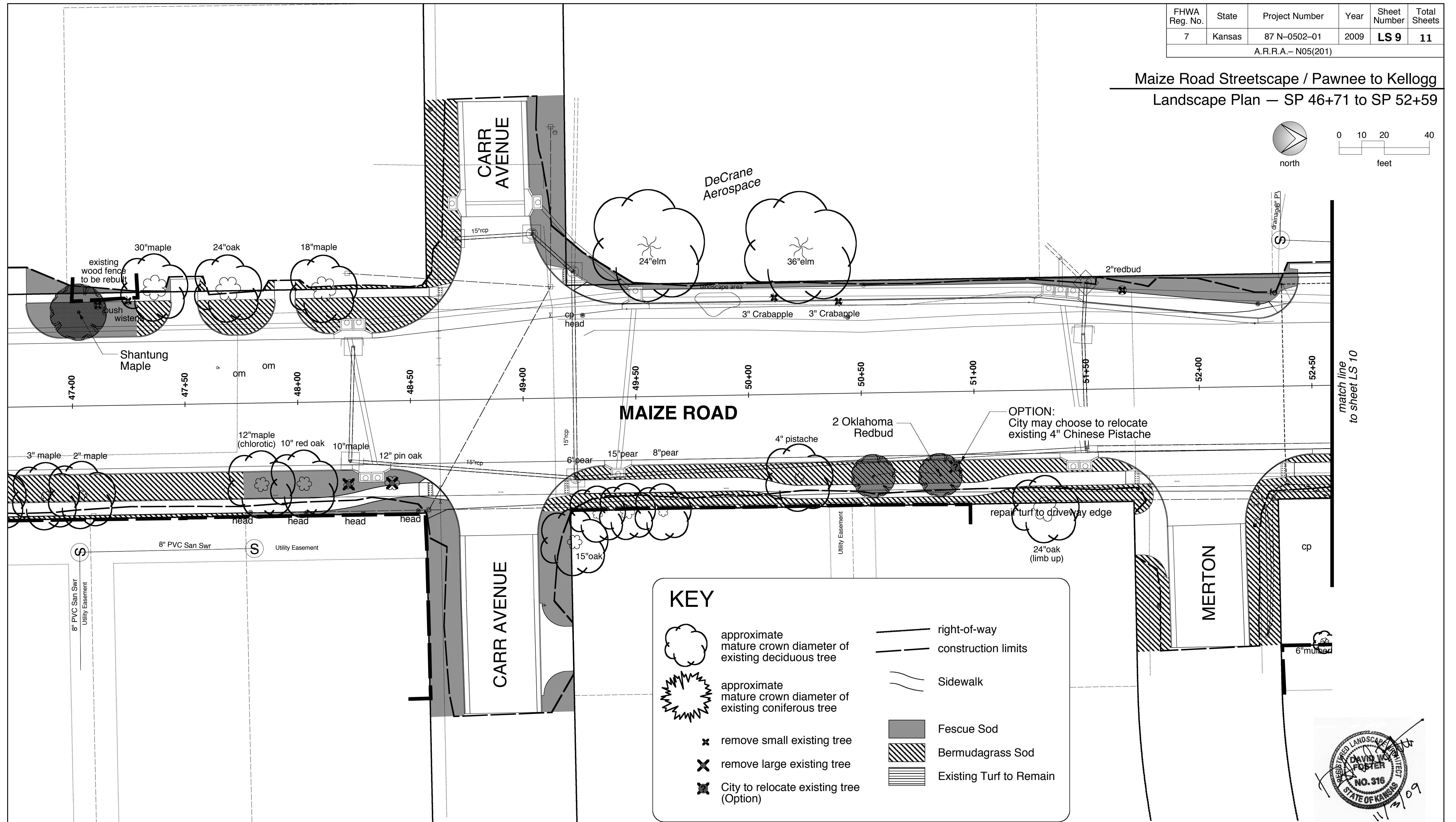
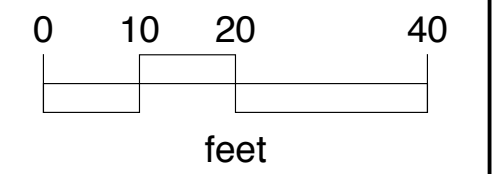
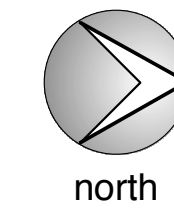

**KEY**

- approximate mature crown diameter of existing deciduous tree
- approximate mature crown diameter of existing coniferous tree
- remove small existing tree
- remove large existing tree
- City to relocate existing tree (Option)
- right-of-way
- construction limits
- Sidewalk
- Fescue Sod
- Bermudagrass Sod
- Existing Turf to Remain

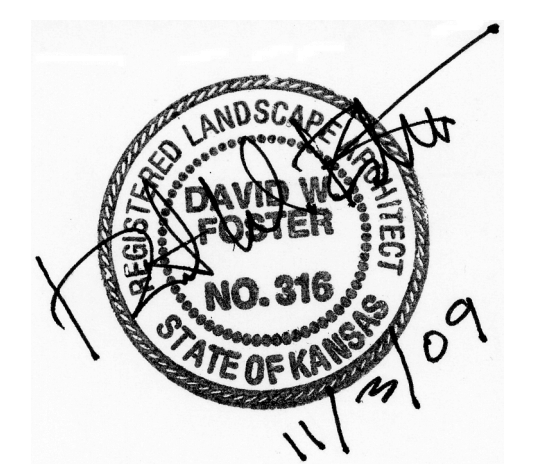

Plotted: November 3, 2009  
Project: 09020

**POE & ASSOCIATES OF KANSAS, INC.**  
CONSULTING ENGINEERS  
5940 E. Central, Suite 200 ■ Wichita, KS 67208-4242  
Phone 316/685-4114 ■ FAX 316/685-4444

**LANDSCAPE ARCHITECTS PLANNERS**  
**rice-foster associates**  
1415 East 2nd Street  
Wichita, KS 67214  
phone 316-262-4525  
fax 316-262-7316