

COUNTY	STATE	PROJECT NO.	YEAR	SHEET NO.	TOTAL SHEETS
SEDGWICK	KANSAS	87 N-0386-01	2009	177	255

Phase IB - Greenwich Road

With one-way northbound traffic on the existing southbound lane and temporary pavement, construct the eastern half of the Greenwich Road improvements north of Sta. 134+66.64. Greenwich Road, Sta. 85+00.00 to Sta. 133+00.00 Temporary pavement marking and signing same as Phase 1A. For intersection signing, see Harry Street, Phase 1B

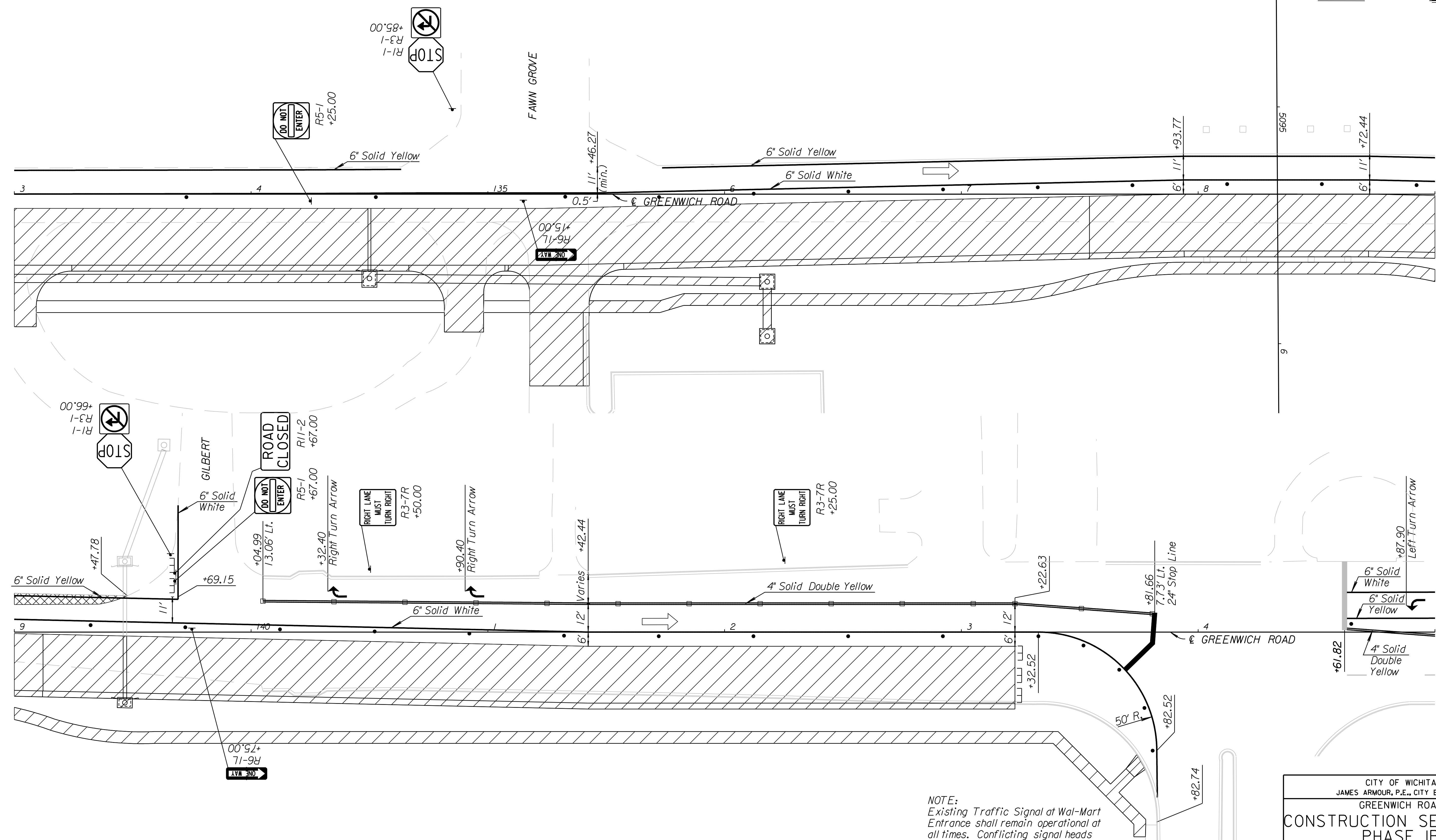

NOTE:
Existing Traffic Signal at Wal-Mart Entrance shall remain operational at all times. Conflicting signal heads shall be covered.

CITY OF WICHITA JAMES ARMOUR, P.E., CITY ENGINEER	
GREENWICH ROAD	
CONSTRUCTION SEQUENCING PHASE IB	
STA. 133+00.00 TO STA. 145+00.00	
SCALE 1"=20'	DATE 11/23/2009
DWG. NO. 35751A	

K:\35751A\CADD\SHEETS\TRAFFIC\SEQUENCE\PHASE IB\GRNWHPH05B.dgn
 SURV. PLOT CADD DES. RAN DR. CKD. JRI TR. JRI APP.