

# STORM SEWER IMPROVEMENTS SELTZER ELEMENTARY SCHOOL LOT 2, BLOCK 1, CEDAR VIEW ADDITION PROJECT NUMBER 1996 PPS (607861)

## As Built Plans:

CONTRACTOR: Ewerz Excavation  
INSPECTOR: Larry Gann,  
CONTRACTOR: K E Miller Engineering  
PDF by: NWS, 04-13-2010

### GENERAL NOTES

- Contractor will be required to provide a minimum advance notice of seventy-two (72) hours to utility companies prior to starting any excavation as follows:  
  

Kansas One-Call	687-2470
-----------------	----------

The Contractor must notify the following in case of an emergency:

Cox Communications	262-0661
Kansas Gas Service	383-8600
Westar	383-8600
AT&T	1-800-286-8313
City of Wichita Water Utility	262-6000
City of Wichita Sewer Maintenance	262-6000
- Existing utilities and their location, as shown on the plans, represent the best information obtainable for design. Location information has been obtained from the various utility companies and is either from company record drawings or company-provided field locations. The Contractor will be required to work around existing utilities within the right-of-way which do not conflict with proposed construction.
- A saw cut of the full depth of existing surface courses or pavement thickness shall be provided at locations where proposed construction abuts an existing surface course or pavement for which partial removal of that surface or pavement is required, except when such saw cuts are within three (3) feet of an existing joint the limits of removal shall be extended to the existing joint.
- This project is located within the limits of a larger project which will include building construction. The General Contractor for the project will submit a Storm Water Pollution Prevention Plan for the entire project prior to beginning any work on this project.
- This project is to be constructed in accordance with City of Wichita Standard Specifications for the Construction of City Projects, and Policy on Construction of Public Works Improvements by Private Contract.
- No work shall begin on this project before required bonds are submitted to the City of Wichita, and the project inspector has been notified.
- All areas of public R/W disturbed by construction of this project are to be restored in accordance with Administrative Regulation AR 6.5 of the City of Wichita.

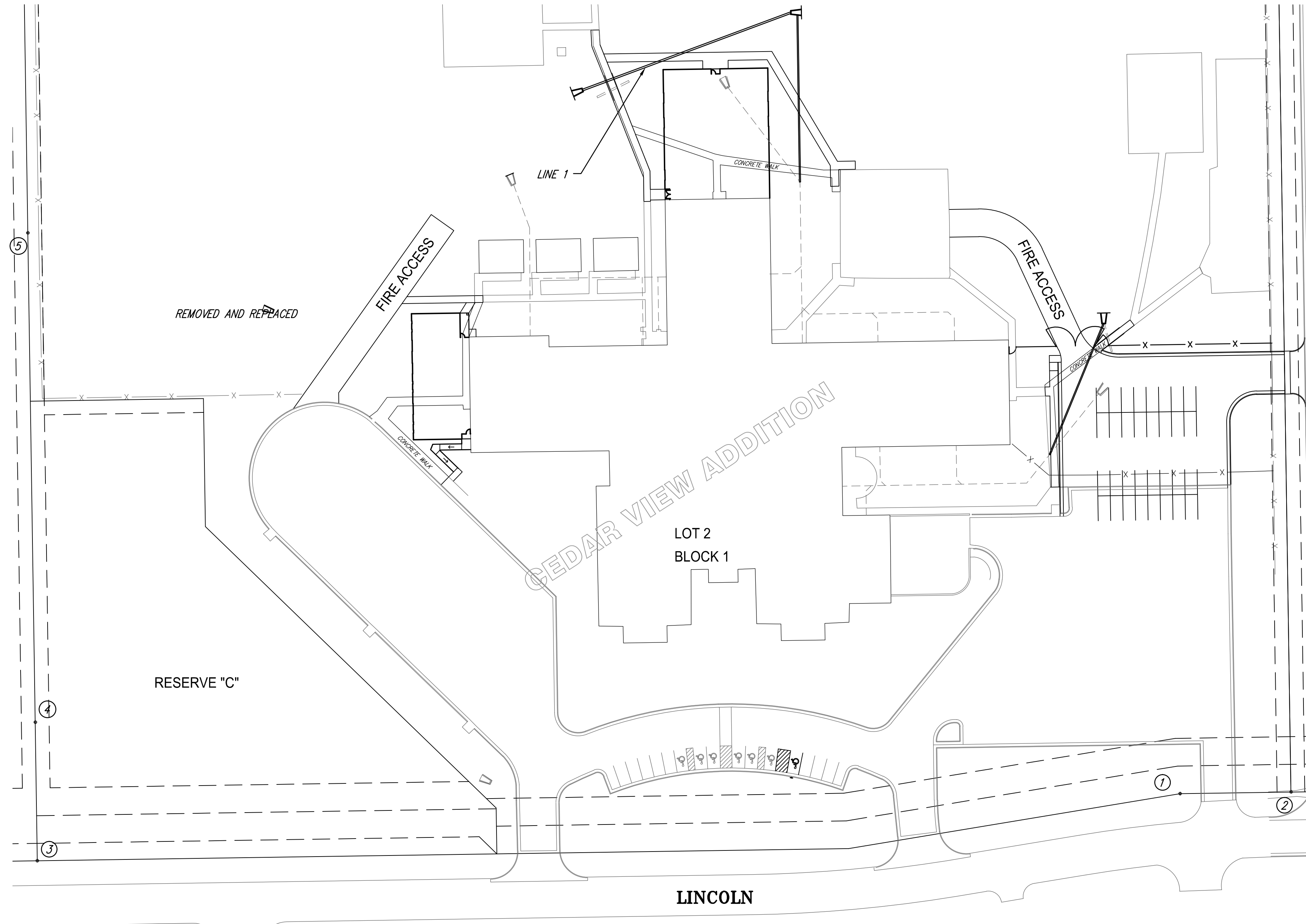

### INDEX OF SHEETS

- (CITY SUBMITTAL INDEX)
- TITLE SHEET
  - SWS PLAN & PROFILE

### BENCHMARKS

B.M.: CHISELED SQUARE ON TOP OF CURB AT THE NORTH CURB RETURN ON THE WEST SIDE OF THE WEST DRIVE ENTRANCE TO SELTZER ELEMENTARY SCHOOL 34' N. OF THE CENTERLINE OF LINCOLN & 200' E. OF THE CENTERLINE OF ROMNEY.  
ELEVATION = 1353.96 (NGVD29)

APPROVED AS NOTED  
BY CITY ENGINEER OF WICHITA

Sanitary Sewers	
Storm Sewers	<i>Julianne Kelleman 9-15-09</i>
Driveway Approaches	
Water Mains	
Paving	

NOTE TO CONTRACTORS

Inspection and testing for this project are to be provided by a Licensed Consulting Engineering Firm under contract with the Owner/Developer. Said inspection to be in accordance with the City of Wichita standard construction engineering practices and certified by a Licensed Professional Engineer. No work shall be performed in dedicated easements or public right-of-way by the Contractor without such inspection, nor shall any work be commenced without written authorization by the City Engineer.

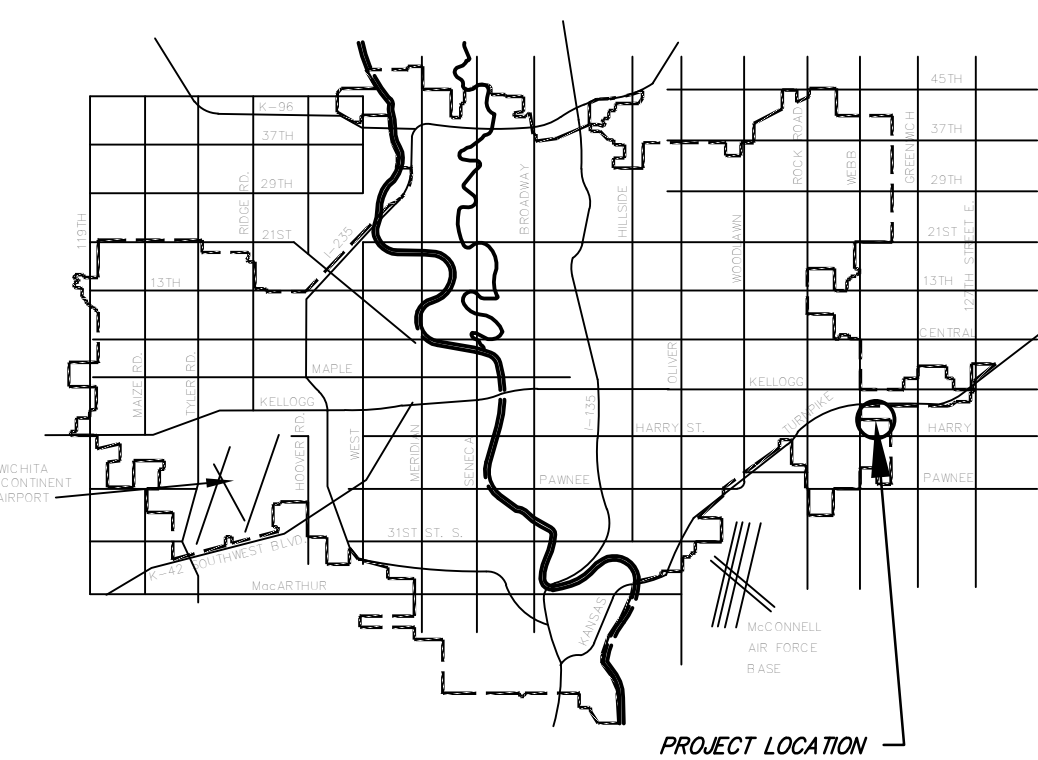

COORDINATE CONTROL TABLE				
CONTROL NO.	LOCATION	DESCRIPTION	NORTHING	EASTING
①	N. SIDE OF LINCOLN W. OF BEDFORD CIRCLE	(MKE 5/8")	20000.00	20000.00
②	NW CORNER OF LINCOLN & BEDFORD CIRCLE	(+F)	20001.24	20080.15
③	SW CORNER OF RESERVE "C"	(MKE 5/8")	19951.56	19174.58
④	WEST LINE OF RESERVE "C" N. OF PT #3	(MKE 5/8")	20051.60	19173.22
⑤	WEST LINE OF LOT 2, BLOCK 1, CEDAR VIEW ADD.	(MKE 5/8")	20405.07	20405.07

**CITY OF WICHITA, KANSAS**  
**JAMES L. ARMOUR, P.E., CITY ENGINEER**

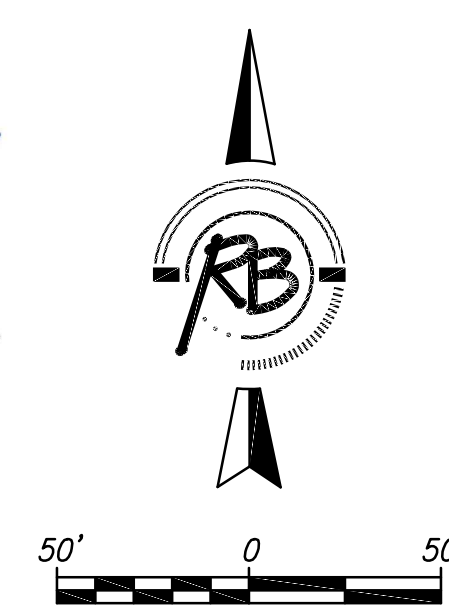
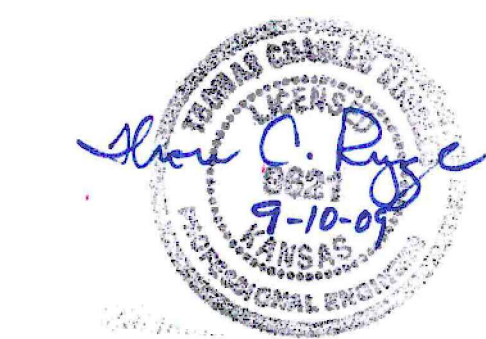

**Ruggles & Bohm, P.A.**  
Engineering, Surveying, Land Planning

924 North Main (316) 264-8008  
Wichita, Kansas 67203 (316) 264-4621 fax  
www.rbkansas.com E-mail: info@rbkansas.com