

PLAN LINE 2

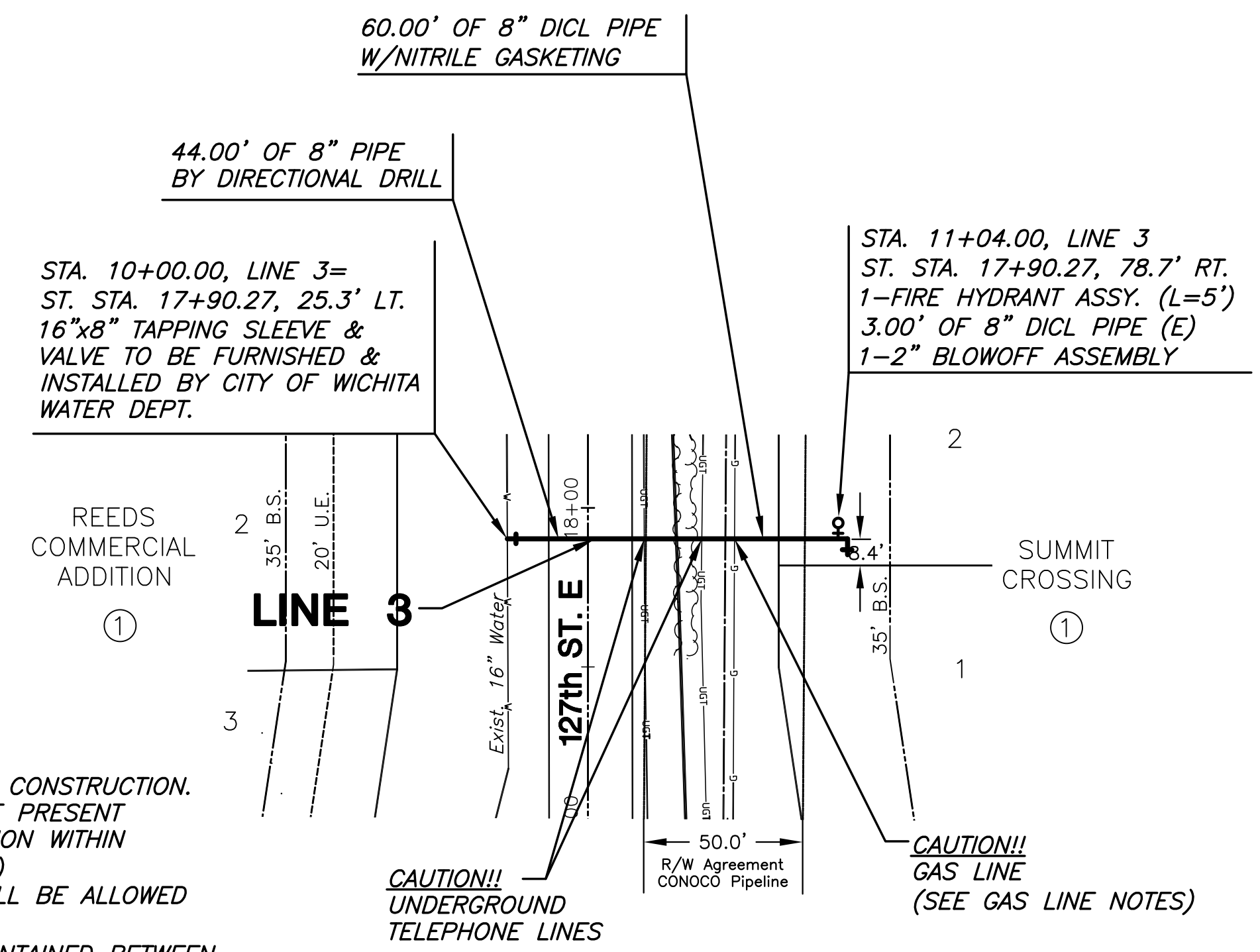

PLAN LINE 3

- GAS LINE NOTES**
1. CONTRACTOR TO POTHOLE GAS LINE PRIOR TO CONSTRUCTION.
 2. A CONOCOPHILIPS REPRESENTATIVE MUST BE PRESENT DURING POTHOLE OPERATIONS AND ALL CONSTRUCTION WITHIN PIPELINE R/W. (SCOTT SALISBURY 316-737-4164)
 3. NO STOCKPILING OR EQUIPMENT STORAGE SHALL BE ALLOWED WITHIN PIPELINE R/W.
 4. A MINIMUM OF 18" SEPARATION SHALL BE MAINTAINED BETWEEN THE WATER LINE AND GAS LINE CROSSINGS.
 5. ALL COST ASSOCIATED WITH GAS LINE CROSSING SHALL BE SUBSIDIARY TO THE PROJECT.

CONTRACTOR TO VERIFY LOCATION AND DEPTH OF EXIST. 16" WATER PRIOR TO CONSTRUCTION.

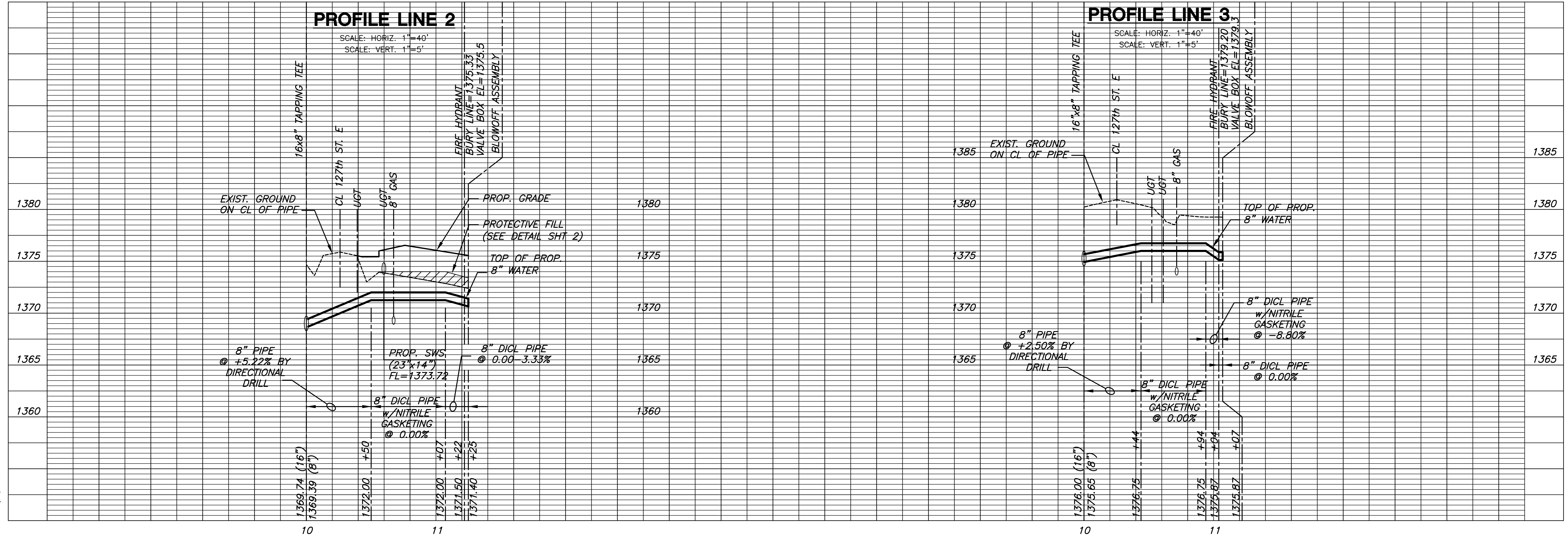

PLOT DATE: Thursday, April 06, 2010 @ 02:00PM

J:\CIVIL\08542\WDC\WTR\08542_C3.DWG

LINES 2 & 3
SHEET TITLE
448-90423
PROJECT NUMBER

DESIGN BY: DFL
DRAWN BY: KKL
CHECKED BY: GJA

ISSUED: March 2010
REVISED:

SHEET NO.
5 of 12