

PLAN - GENERATOR PAD
Scale: 3/16" = 1'-0"

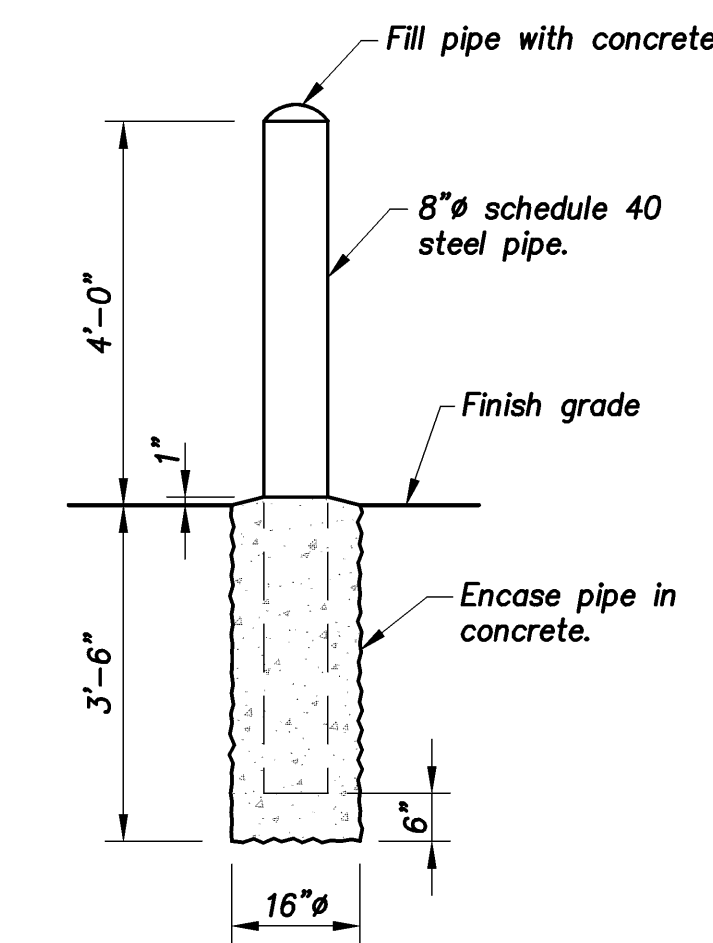

PIPE BOLLARD DETAIL
1/2" = 1'-0"

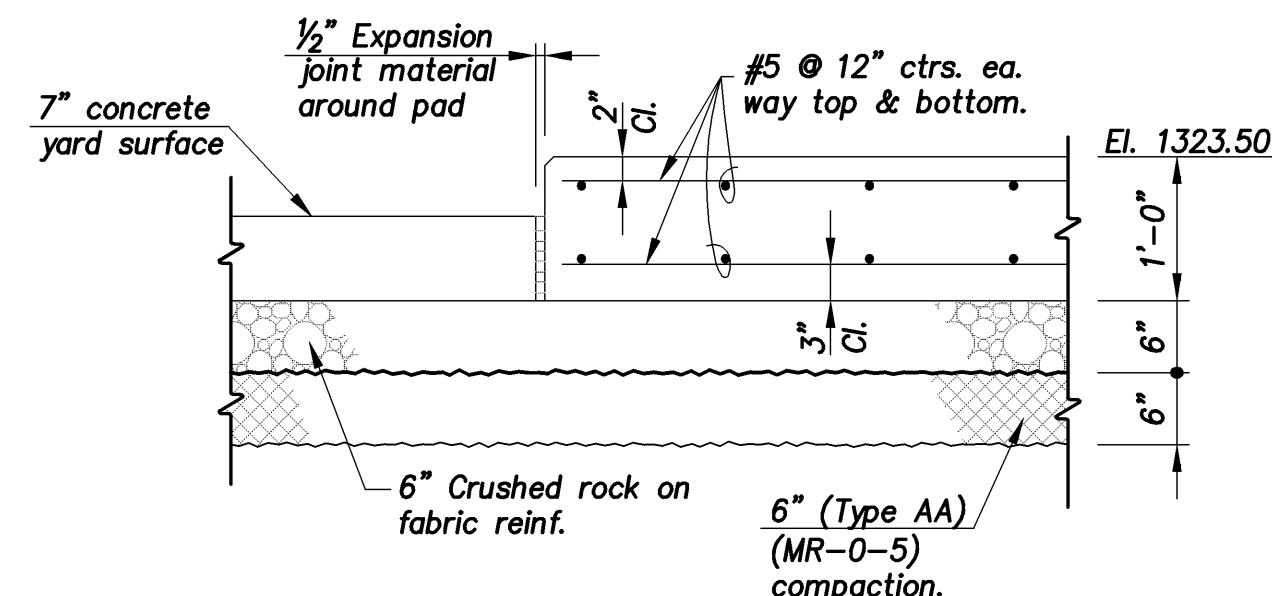

SECTION A
3/4" = 1'-0" C11

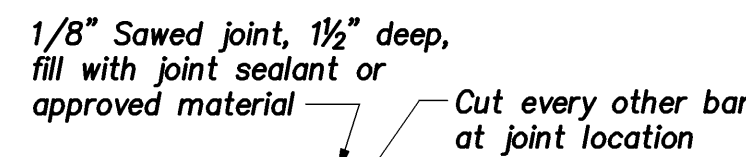

CONTROL JOINT (C.J.)
No Scale

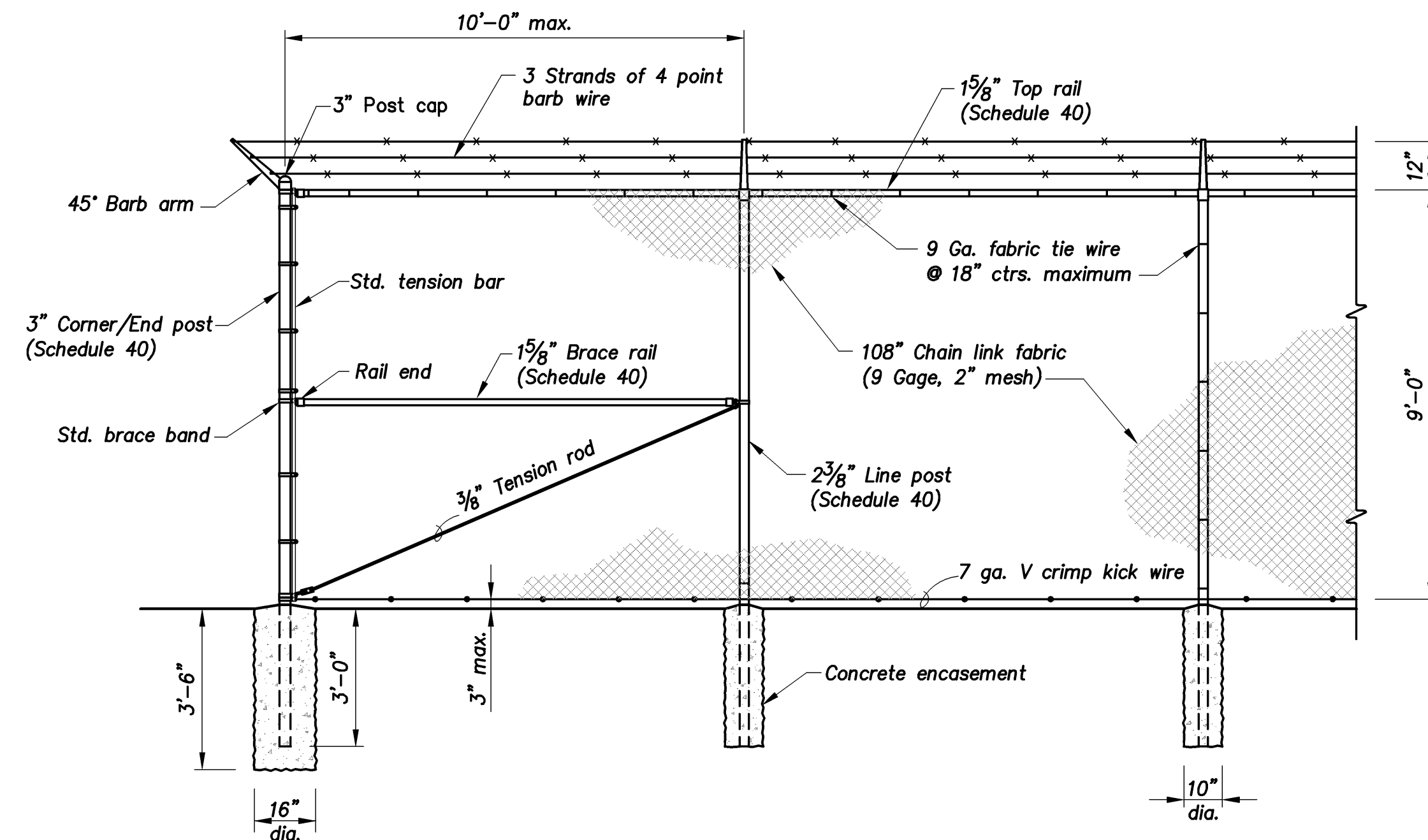

10' HIGH CHAIN LINK FENCE DETAIL
Scale: 3/8" = 1'-0"

CHAIN LINK FENCE NOTES

- All chain link fabric shall be zinc coated (galvanized).
- All steel line, pull, corner and end posts shall be galvanized. Diameters shown for steel posts are nominal. Weight tolerances shall be as shown in the Specifications.
- All bolts, including eyebolts and turnbuckles, shall be coated in accordance with the weight of coating requirements of ASTM A153 and shall conform to ASTM A307 or A36.
- Miscellaneous plates, bars and shapes, including tension rods, shall conform to ASTM A36.
- All concrete used in the post footings shall be cast-in-place concrete.

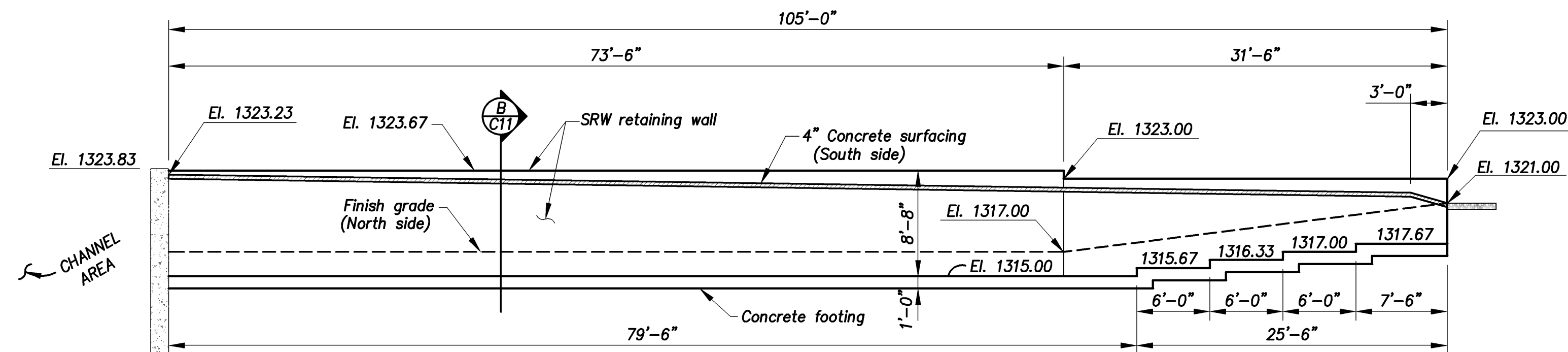

SRW RETAINING WALL ELEVATION (LOOKING NORTH)
Scale: 1/8" = 1'-0"

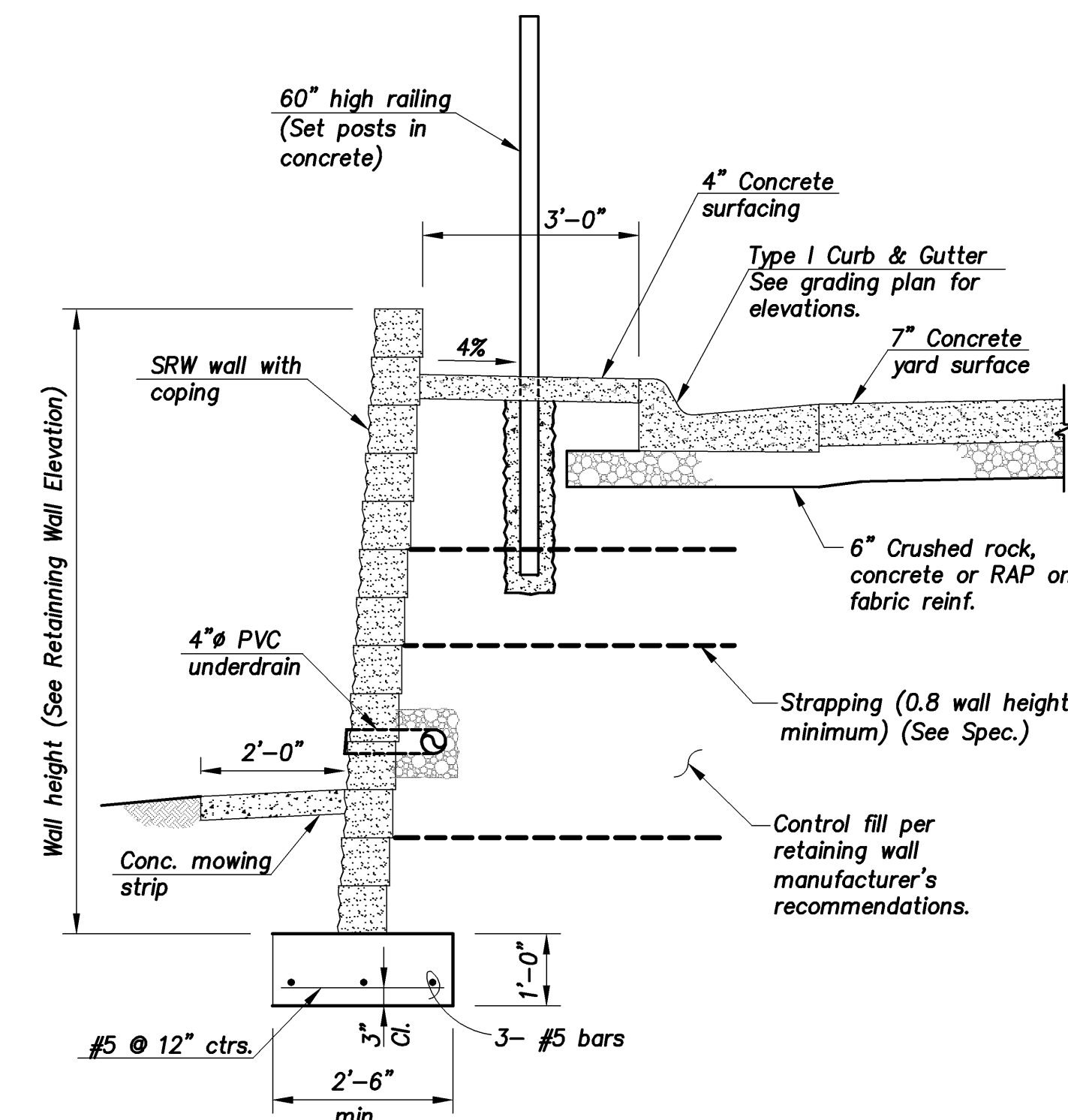

SECTION B
1/2" = 1'-0" C11

CITY OF WICHITA, KANSAS		CFS Cook, Flatt & Strobel ENGINEERS, P.A.
PUMP STATION NO. 11		
CIVIL		DESIGNED MDC SCALE As Shown
PUMP STATION		DATE 3-10-2010
FENCING, PAD & RETAINING WALL DETAILS		CHECKED HAP SHEET C11 OF C31