

COUNTY	STATE	PROJECT NO.	YEAR	SHEET NO.	TOTAL SHEETS
SEDGWICK	KANSAS	472-84702	2010	3	36

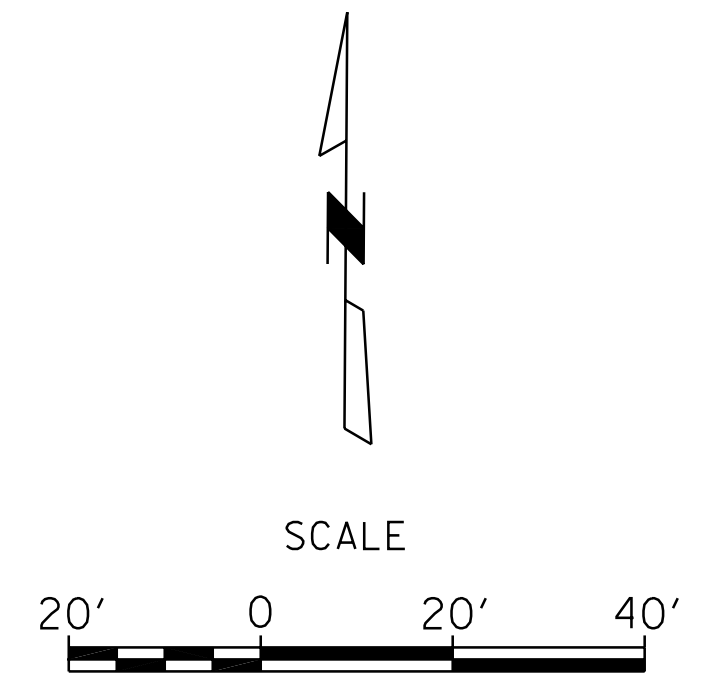

See sheet #10
for utility
CAUTION notes.

NOTE:
The location and depth of the existing siphon and force main are approximate.
It is the Contractor's responsibility to contact each of the utility companies involved, prior to beginning any excavation or construction work on this project, for accurate field location of their utility and to coordinate the work with any necessary utility adjustment or relocation.
Elevations are top of pavement unless otherwise specified. (Add 1200 to establish true elevations).

See Sh. No. 18-20 for Sanitary Sewer Siphon.

CITY OF WICHITA JAMES ARMOUR, P.E., CITY ENGINEER 31ST STREET BRIDGE AT GLENN	
PLAN	
PB PARSONS BRINCKERHOFF Wichita, Kansas	
SCALE	DATE 4/28/2010
DWG. NO. 35768A	

HCP-2 @ Sta. 196+51.43, 43.46' Rt.
1/2" Rebar with Orange PBOD Cap
Nail & tin in LP 47.8' NW
€ Euclid Street 23.0' W
N. Edge Sidewalk 2.5' S

HCP-3 @ Sta. 199+05.27, 59.85' Lt.
1/2" Rebar with Orange PBOD Cap
Nail & tin in PP 34.2' SSW
SE Corner Pump Sta. 61.5' NNW
€ Glenn Street 38.0' E

HCP-1 @ Sta. 200+39.62, 46.09' Rt.
1/2" Rebar with Orange PBOD Cap
Nail & tin in PP 60.5' NE
In line with N. edge sidewalk to East
€ 31st Street 46.0' N

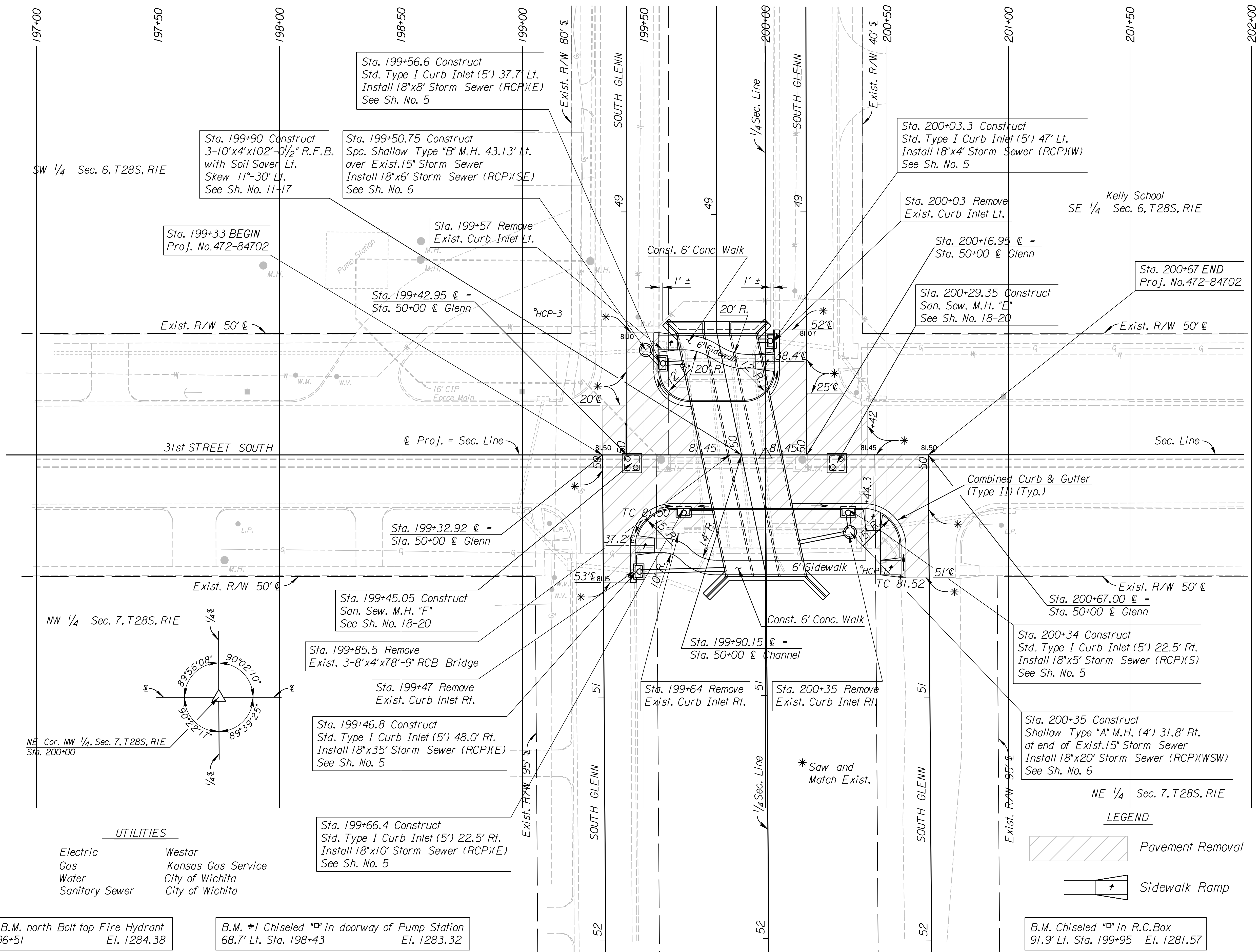

UTILITIES

- | | |
|----------------|--------------------|
| Electric | Westar |
| Gas | Kansas Gas Service |
| Water | City of Wichita |
| Sanitary Sewer | City of Wichita |

City of Wichita B.M. north Bolt top Fire Hydrant
51.2' Lt. Sta. 196+51 El. 1284.38

B.M. #1 Chiseled "□" in doorway of Pump Station
68.7' Lt. Sta. 198+43 El. 1283.32

LEGEND

	Pavement Removal
	Sidewalk Ramp
	B.M. Chiseled "□" in R.C.Box 91.9' Lt. Sta. 199+95 El. 1281.57

T:\35768A\CADD\SHEETS\ROADWAY\31STPL.dgn SURV. PLOT CADD DES. DR. TR. CKD. APP.