

STATE	PROJECT NO.	YEAR	SHEET NO.	TOTAL SHEETS
KANSAS	87 N-0240-01	2004	3	42

Utility	Location	Owner-Address
Telephone	As shown on plans (Underground N. of Br.) (Overhead S. of Br.)	Southwestern Bell Attn: Bob Alley (316) 268-2245
Gas	As shown on plans (Line N. side of Br.)	KS Gas Service Attn: Charlene Lawless (316) 832-3121
Electric	Right thru Project (Overhead South of Br.)	Kansas Gas & Electric Attn: Shane Price (316) 261-6865
Water	Left thru Project	City of Wichita Attn: Bill Perkins (316) 268-4555
Storm Sewer & San. Sewer	As shown on plans	City of Wichita Attn: Shawn Bryant (316) 268-4555

- Ref. SW Cor. Sec 4 T27S R1E= Sta. 1+656.022
- Fnd. 21 mm Iron Pipe in Thimble
 - "X" cut top West curb of traffic island
 - "X" cut top Conc. curb
 - "X" cut top Conc. curb
 - To N.W. Cor. of brick Bldg.
 - In C of Broadway North to South

- Ref. P.O.T. @ Sta. 1+889.868
- Set 13 mm rebar @ P.O.T.
 - "□" cut top Conc. curb (BM #1)
 - Spike & washer in power pole
 - Spike & washer in power pole

- Ref. P.O.T. @ Sta. 2+081.621
- Set 13 mm rebar @ P.O.T.
 - "□" cut top Conc. curb (BM #2)
 - Spike & washer in power pole
 - To the S.E. Cor. of Bldg.

- Ref. S 1/4 Cor. Sec 4 T27S R1E = Sta. 2+471.489
- Fnd. 21 mm Iron Pipe in Thimble
 - "X" cut top S.W. Cor. Conc. block @ S.W. Cor. Bldg.
 - Nail & shiner in power pole
 - 60 d nail in power & light pole
 - To East rail of East set of tracks
 - C.O.W. brass disk in S.W. Cor. R.R. signal base
 - In C E-W asphalt street

FOR INFORMATION ONLY
Large trees & stumps to be grubbed this sheet: 1-1 m
Total = 1

STA. 1+960.37; BEGIN
K.D.O.T. Project No.
87 N-0240-01

SEC. 4 T27S R1E

Note: The Contractor shall construct Concrete Safety Barriers (Special)(AE) as follows:
Sta. 1+960.37 to Sta. 1+970.27 Rt.
Sta. 1+963.07 to Sta. 1+970.27 Lt.
Sta. 1+985.73 to Sta. 1+995.63 Lt. & Rt.
Total = 36.9 m

The last 2 m of the concrete safety barriers shall transition to match existing curb & gutter/sidewalks. (Maintain 1.8 m sidewalk width.)

The Contractor shall remove the existing fence within the channel Sta. 1+968 to Sta. 1+994, 18 m Lt.
Total = 26.0 m

The Contractor shall remove and reset chain link fence as close to its original location as practical.
Sta. 1+968, 18 m Lt. to Sta. 1+972.5, 20.8 m Lt.
Sta. 1+986, 9.2 m Lt. to Sta. 1+994.2, 17.6 m Lt.
Sta. 1+986, 9.2 m Lt. to Sta. 1+994.2, 8.2 m Lt.
Total = 24.3 m

The Contractor shall remove the existing structure (Br. No. 430400876500020) (10.36 m Steel Beam Span with concrete substructure and wingwalls, 14.94 m asphalt roadway on concrete deck and 1.52 m concrete walkway and concrete rails.) and excavate the channel improvements within the vicinity of the new structure, prior to its construction.

The existing structure shall become the property of the Contractor and shall be removed from the site.

Stream flow shall be carried through the project by the Contractor. This work shall not be paid for directly, but shall be considered Subsidiary to other items on the Contract.

Note: Connect Exist. 750 mm R.C.P. on West side & Exist. 600 mm R.C.P. on East side thru wall of new R.F.B. with 750 mm x 1.2 m Stm. Sew. (R.C.P.) with Conc. Collar & 600 mm x .600 m Stm. Sew. (R.C.P.) with Conc. Collar. See Detail of Collar Sh. No. 2
Remove 2.2 m of 750 mm R.C.P. & 3.7 m of 600 mm R.C.P.

LEGEND

Removal of Existing Asphalt Surfacing, Curb & Gutter and sidewalks (Rock Excavation)

Note: Saw cuts shall not be paid for directly, but shall be considered Subsidiary to other items of the contract. All saw cuts shall be full depth.

Note: All elevations shown on this project are based on U.S.G.S. Datum, C.O.W. B.M. Brass rod Concrete post North end of traffic island N.E. Cor. of Broadway and 21st Street North.
Elevation 399.873

SCALE IN METERS

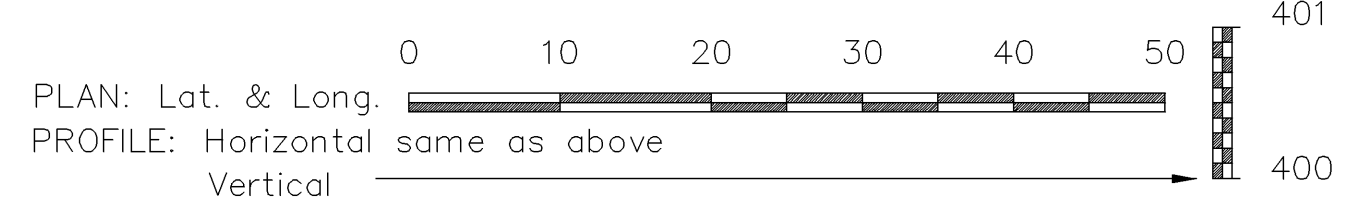

Note: The Contr. shall construct Slope Protection (Riprap Stone)(Light 600 mm) on the down stream side as shown.
See Sh. No. 5 Total = 72 cu m

Note: "All trees and woody shrubs not shown to be removed and located between the construction limits and the right-of-way line or easement line shall be spared unless directed by the Engineer to be removed"

Webb Road Development Inc.
1223 N. Rock Road
Bldg. E. Suite 100
Wichita, Ks. 67206

B.M. #1 - "□" cut at C inlet South side 21st St.
7.4 m Rt. Sta. 1+889.868
Elev. = 399.265

SEC. 9 T27S R1E

B.M. #2 - "□" cut top back of curve at W. end of curb inlet N. side 21st St.
7.4 m Lt. Sta. 2+081.621
Elev. = 399.178

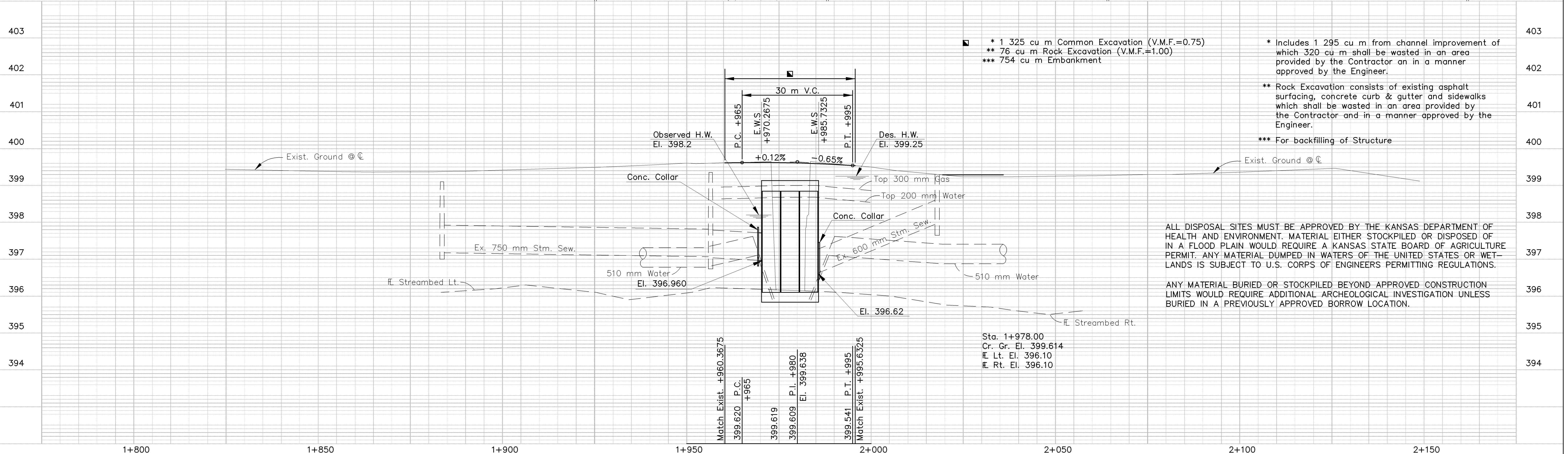

- * 1 325 cu m Common Excavation (V.M.F.=0.75)
- ** 76 cu m Rock Excavation (V.M.F.=1.00)
- *** 754 cu m Embankment

* Includes 1 295 cu m from channel improvement of which 320 cu m shall be wasted in an area provided by the Contractor and in a manner approved by the Engineer.

** Rock Excavation consists of existing asphalt surfacing, concrete curb & gutter and sidewalks which shall be wasted in an area provided by the Contractor and in a manner approved by the Engineer.

*** For backfilling of Structure

ALL DISPOSAL SITES MUST BE APPROVED BY THE KANSAS DEPARTMENT OF HEALTH AND ENVIRONMENT. MATERIAL EITHER STOCKPILED OR DISPOSED OF IN A FLOOD PLAIN WOULD REQUIRE A KANSAS STATE BOARD OF AGRICULTURE PERMIT. ANY MATERIAL DUMPED IN WATERS OF THE UNITED STATES OR WETLANDS IS SUBJECT TO U.S. CORPS OF ENGINEERS PERMITTING REGULATIONS.

ANY MATERIAL BURIED OR STOCKPILED BEYOND APPROVED CONSTRUCTION LIMITS WOULD REQUIRE ADDITIONAL ARCHEOLOGICAL INVESTIGATION UNLESS BURIED IN A PREVIOUSLY APPROVED BORROW LOCATION.

02518/DWGS/PP01 Scale 1:500

PLAN SUPERVISED, PLOTTED, ALIGNED, CHECKED, RT. BY WAY CHECKER

PROFILE SUPERVISED, PLOTTED, GRADES CHECKED, B.M.'S NOTED, SUBSTATIONS INDICATED, CHECKED