

FHWA REG. NO.	STATE	PROJECT NO.:	YEAR	SHEET NUMBER	TOTAL SHEETS
7	KANSAS	87N-0211-01	2001	2	44

GENERAL NOTES:

- UTILITY SERVICE LINES, POLES, VALVE BOXES, METERS AND ETCETERA ARE TO BE ADJUSTED AS NECESSARY BY OTHERS PRIOR TO CONSTRUCTION UNLESS THE PLANS SPECIFICALLY CALL FOR THEIR ADJUSTMENT BY THE CONTRACTOR OR UNLESS THE PLANS SPECIFICALLY IDENTIFY A UTILITY TO BE ADJUSTED BY ITS OWNER DURING CONSTRUCTION. EXISTING UTILITIES AND THEIR LOCATION, AS SHOWN ON THE PLANS REPRESENT THE BEST INFORMATION OBTAINABLE FOR DESIGN. THE CONTRACTOR WILL BE REQUIRED TO WORK AROUND EXISTING UTILITIES WITHIN THE RIGHT-OF-WAY WHICH DO NOT CONFLICT WITH PROPOSED CONSTRUCTION.
- THE CONTRACTOR SHALL PROVIDE A MINIMUM OF SEVENTY TWO (72) HOURS ADVANCE NOTICE TO ALL UTILITY OWNERS PRIOR TO WORK IN ANY AREA WHERE EXISTING UTILITIES WILL BE UNCOVERED TO ALLOW THE UTILITY OWNERS TO INSPECT THE UNCOVERING OF THEIR UTILITY. ANY UTILITY CARELESSLY DAMAGED BY CONSTRUCTION OPERATION SHALL BE REPAIRED OR REPLACED AT CONTRACTOR'S EXPENSE. THE CONTRACTOR SHALL COORDINATE WITH CONTRACTORS FOR UTILITY COMPANIES AND OTHER AGENCIES FOR MINIMUM INCONVENIENCE THE GENERAL PUBLIC.
- CONTRACTOR SHALL AVOID UNCOVERING THE EXISTING WATERLINES UNLESS ABSOLUTELY NECESSARY. UNCOVERING SHALL BE DONE ONLY IN THE PRESENCE OF THE ENGINEER.
- ALL ADJACENT BUILDINGS, STRUCTURES, PARKING LOTS, DRIVES, STREET PAVEMENTS, UTILITY LINES UTILITY STRUCTURES AND APPURTENANCES, OTHER THAN SHOWN FOR REPLACEMENT SHALL BE PROTECTED FROM DAMAGE DURING CONSTRUCTION OF THE PROJECT. ITEMS DAMAGED BEYOND THE LIMITS SHOWN ON THE DRAWINGS SHALL BE REMOVED AND REPLACED BY THE CONTRACTOR AT THE CONTRACTOR'S EXPENSE.
- A SAW CUT OF FULL DEPTH OF EXISTING SURFACE COURSES SHALL BE PROVIDED AT LOCATIONS WHERE PROPOSED CONSTRUCTION ABUTS AN EXISTING SURFACE COURSE OR PAVEMENT FOR WHICH PARTIAL REMOVAL OF THAT SURFACE OR PAVEMENT IS REQUIRED. SAWED JOINTS TO FACILITATE REMOVAL WITHIN ONE METER OF AN EXISTING JOINT WILL NOT BE PERMITTED, AND FOR SUCH INSTANCES THE LIMITS OF REMOVAL SHALL EXTEND TO THE EXISTING JOINT. SQUIG SAW CUTS WILL NOT BE PAID FOR DIRECTLY AND THIS COST SHALL BE CONSIDERED AS SUBSIDIARY TO THE REMOVAL OF THE SURFACE OR PAVEMENT.
- RUBBLE RESULTING FROM THE REMOVAL OF MISCELLANEOUS STRUCTURES AND EXCAVATION WHICH IS TO BE WASTED OR DISPOSED OF ON SITES TO BE PROVIDED BY THE CONTRACTOR. THESE SITES SHALL BE APPROVED BY THE ENGINEER AS TO SUITABILITY, APPEARANCE AND SITE LOCATION. LOCATIONS THAT, IN THE OPINION OF THE ENGINEER, LEAVE AN UNSIGHTLY APPEARANCE WILL NOT BE APPROVED.
- ALL DISPOSAL SITES MUST BE APPROVED BY THE KANSAS DEPARTMENT OF HEALTH AND ENVIRONMENT. MATERIAL EITHER STOCKPILED OR DISPOSED OF IN A FLOOD PLAIN WOULD REQUIRE A KANSAS STATE BOARD OF AGRICULTURE PERMIT. ANY MATERIAL DUMPED IN WATERS OF THE UNITED STATES OR WETLANDS IS SUBJECT TO U.S. CORPS OF ENGINEERS PERMITTING REGULATIONS. ANY MATERIAL BURIED OR STOCKPILED BEYOND APPROVED CONSTRUCTION LIMITS WOULD REQUIRE ADDITIONAL ARCHAEOLOGICAL INVESTIGATIONS UNLESS BURIED IN A PREVIOUSLY APPROVED BORROW LOCATION.
- THE CONTRACTOR SHALL BE RESPONSIBLE FOR PRESERVING PROPERTY IRONS SHOWN ON THE PLANS. THE CONTRACTOR WILL BE REQUIRED TO RE-ESTABLISH ANY SHOWN PROPERTY IRONS WHICH ARE DAMAGED OR DESTROYED BY CONSTRUCTION OPERATIONS. SUCH IRONS SHALL BE RE-ESTABLISHED BY A LICENSED LAND SURVEYOR IN ACCORDANCE WITH STATE LAW. THIS WORK SHALL BE SUBSIDIARY TO OTHER ITEMS IN CONTRACT.
- CONSTRUCTION STAKING FOR THIS PROJECT SHALL BE PROVIDED BY CITY OF WICHITA. THE CITY OF WICHITA WILL ALSO FURNISH THE CONTRACTOR ONE MONUMENT BOX. CONTRACTOR SHALL VERIFY TIES TO THE SECTION CORNER SHOWN ON THE PLAN SHEET, TAKE ADDITIONAL TIES, IF NEEDED, AND INSTALL THE MONUMENT BOX AND A 15MM X 600MM REBAR INSIDE THE MONUMENT BOX AT THE TRUE LOCATION OF SECTION CORNER UPON COMPLETION OF CONSTRUCTION.
- REESTABLISHING OF SECTION CORNER SHALL BE DONE BY A LICENSED LAND SURVEYOR IN ACCORDANCE WITH STATE LAW. THIS WORK SHALL BE PAID FOR AT THE CONTRACT UNIT PRICE FOR MONUMENT BOX.
- ALL SALVAGEABLE DRAINAGE PIPES, MANHOLE RINGS AND COVERS, INLET GRATES, TRAFFIC SIGNALS AND TRAFFIC SIGNS SHALL BE CAREFULLY REMOVED AND STOCKPILED AT LOCATIONS WITHIN THE RIGHT-OF-WAY, AS DIRECTED BY THE ENGINEER, FOR REMOVAL BY CITY PERSONNEL.
- THE CONTRACTOR WILL BE REQUIRED TO PROVIDE A MINIMUM ADVANCE NOTICE OF SEVENTY TWO (72) HOURS TO EACH OF THE FOLLOWING UTILITIES PRIOR TO THE BEGINNING OF CONSTRUCTION AND REQUEST THAT ANY EXISTING LINES BE FLAGGED:
 SOUTHWESTERN BELL TELEPHONE CO.
 154 N BROADWAY
 WICHITA, KANSAS 67202
 GREG SHARPE
 316-268-2245

 KANSAS GAS & ELECTRIC CO.
 1900 EAST CENTRAL
 WICHITA, KANSAS 67214
 RUSS CHITWOOD
 316-261-6251
 (ELECTRIC)

 WESTAR
 1021 EAST 26TH STREET NORTH
 WICHITA, KANSAS 67219
 JIM STOLTZ
 316-832-3122
 (GAS)

 WICHITA WATER AND SEWER DEPARTMENT
 8TH FLOOR - CITY HALL
 455 N. MAIN STREET
 WICHITA, KANSAS 67202
 BILL PERKINS
 316-268-4555

 KANSAS ONE-CALL
 1-800-344-7233

 DIG SAFE
 687-2470

 MULTIMEDIA CABLEVISION INC.
 701 E. DOUGLAS
 WICHITA, KS 67202
 DARRELL GORSUCK
 316-262-4270
- IN ACCORDANCE WITH OVERHEAD POWER LINE PREVENTION ACT, THE CONTRACTOR SHALL NOTIFY WESTAR TO ARRANGE FOR APPROPRIATE SAFETY PRECAUTIONS BEFORE WORKING WITHIN 3 METERS OF AN OVERHEAD HIGH VOLTAGE LINE.
- ALL TREES, HEDGE ROWS, SHELTER BELTS, AND WOODY SHRUBS NOT SHOWN TO BE REMOVED AND LOCATED BETWEEN THE CONSTRUCTION LIMITS AND THE RIGHT-OF-WAY LINE OR EASEMENT LINE SHALL BE SPARED UNLESS DIRECTED BY THE ENGINEER TO BE REMOVED. ALL TREES WITHIN THE APPROPRIATE CLEAR ZONE SHALL BE REMOVED.
- THE CONTRACTOR SHALL NOTIFY PROPERTY OWNERS WHO HAVE SPRINKLER SYSTEMS OR OTHER IMPROVEMENTS IN CONFLICT WITH THE NEW CONSTRUCTION. THE CONTRACTOR WILL BE REQUIRED TO REMOVE SUCH IMPROVEMENTS, SHOULD THEY NOT BE REMOVED BY THE OWNER AT THE TIME OF CONSTRUCTION. THE CONTRACTOR WILL BE REQUIRED TO SALVAGE SPRINKLER HEADS AND/OR VALVES AND PLACE IN PROPERTY OWNER'S YARD.
- SPRINKLER SYSTEMS OR OTHER IMPROVEMENTS NOT IN CONFLICT WITH THE NEW CONSTRUCTION SHALL BE PROTECTED FROM DAMAGE AND SHALL REMAIN IN PLACE. ALL WORK IN CONNECTION WITH SAID IMPROVEMENTS SHALL BE CONSIDERED SUBSIDIARY TO OTHER ITEMS OF WORK.

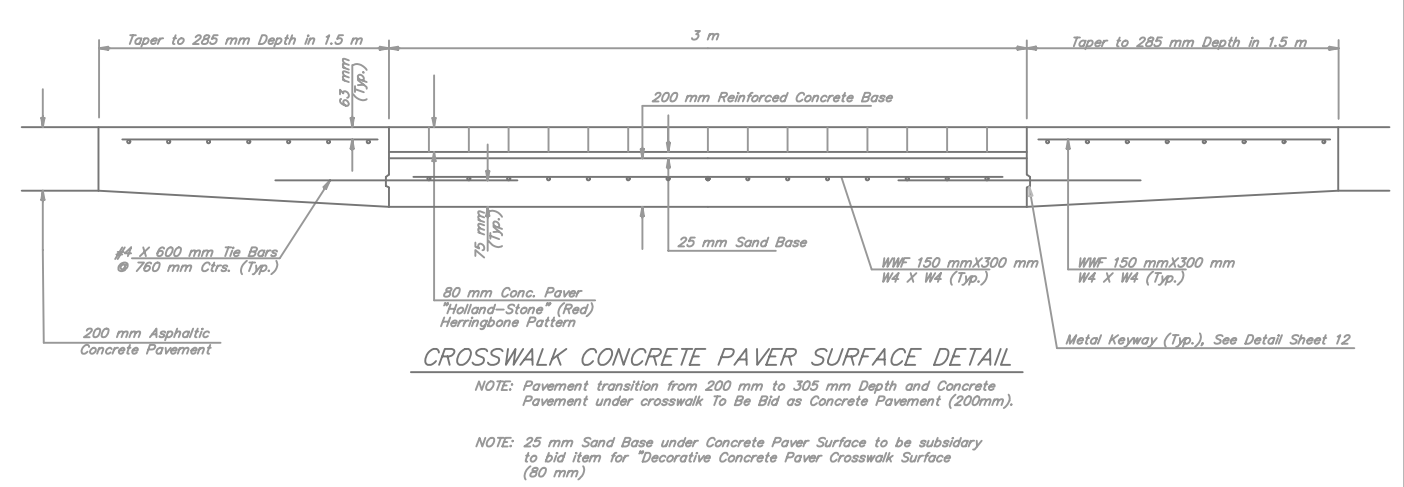
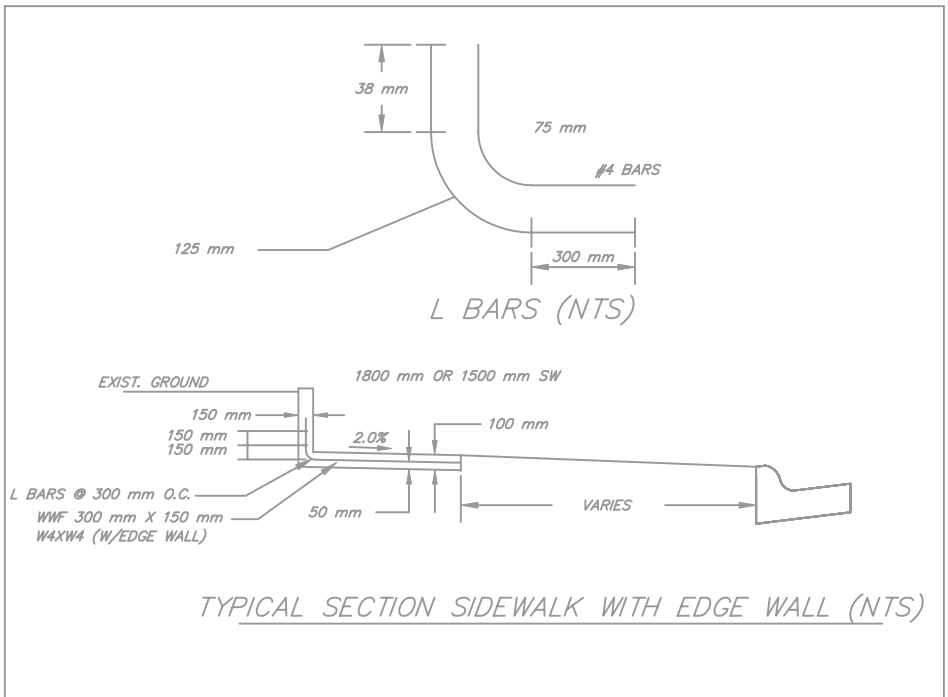
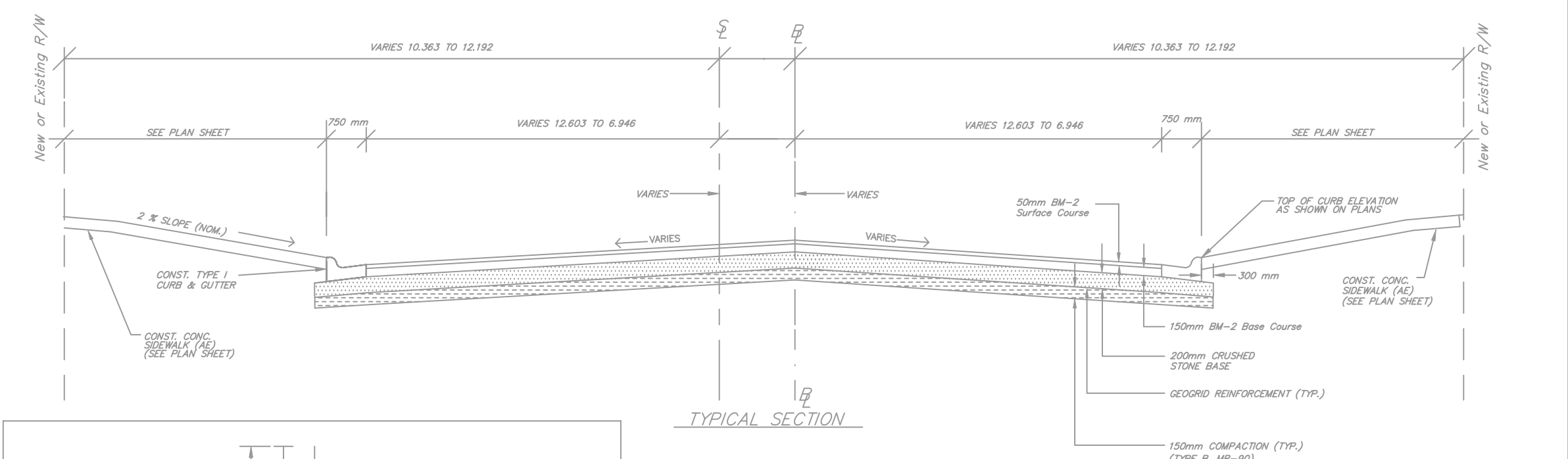

CROSSWALK CONCRETE PAVER SURFACE DETAIL (NTS)

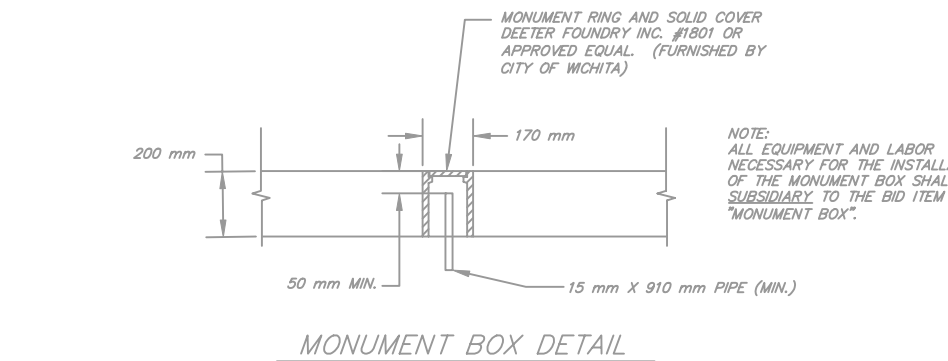

TYPICAL SECTION GENERAL NOTES:
 ALL DISTURBED AREAS TO BE SODDED EXCEPT WHERE SHOWN ON PLANS
 SEE PLAN AND PROFILE SHEETS FOR TOP OF CURB AND CROWN ELEVATIONS
 SAWCUTS ARE TO BE FULL DEPTH AND WILL BE SUBSIDIARY TO THE BID ITEM ROCK EXCAVATION
 SIDEWALK THROUGH DRIVEWAYS BUILT AT 200 mm THICKNESS PAY ITEM INCLUDED AS 200 MM DRIVE BY CONCRETE PAVEMENT