

LEGEND:

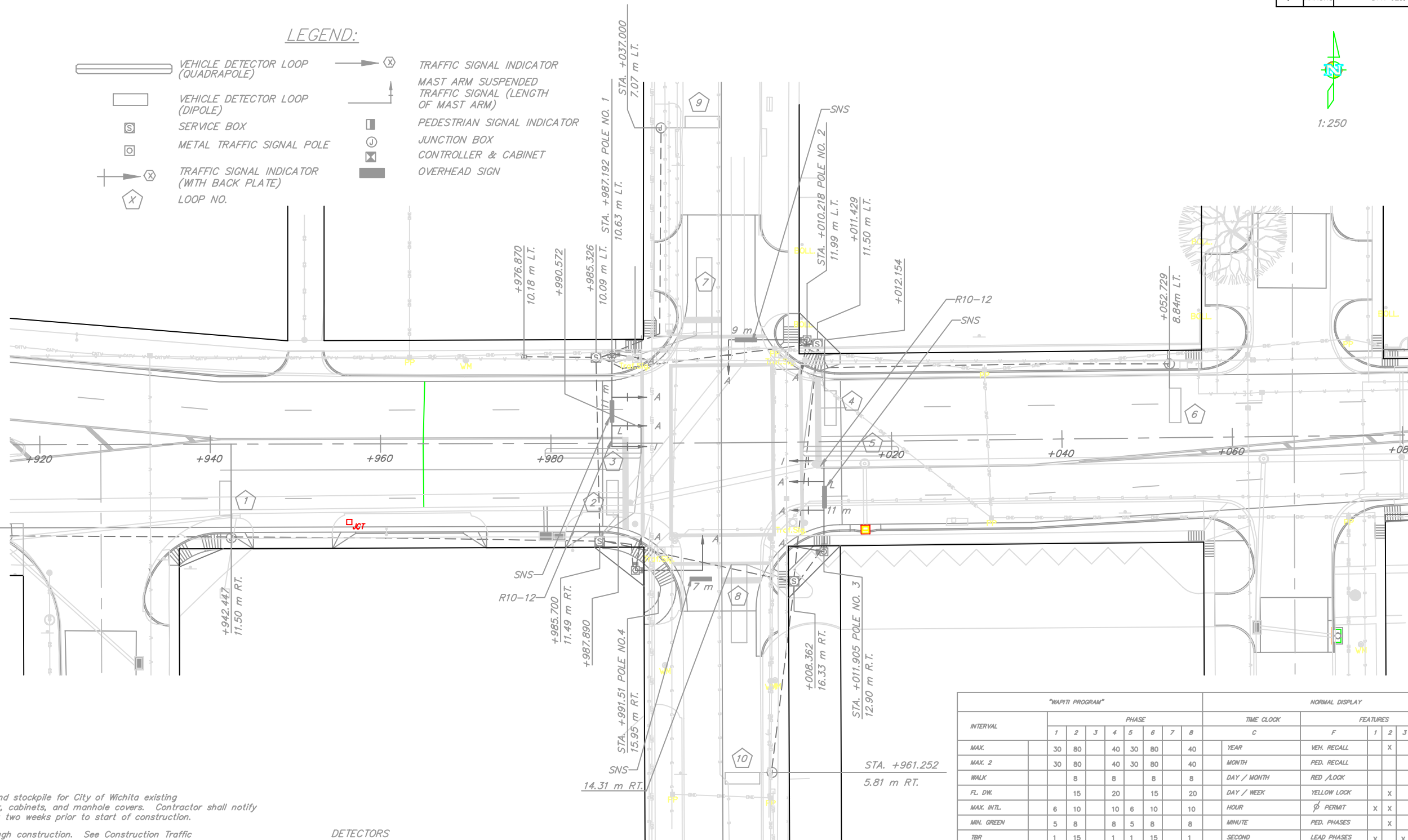
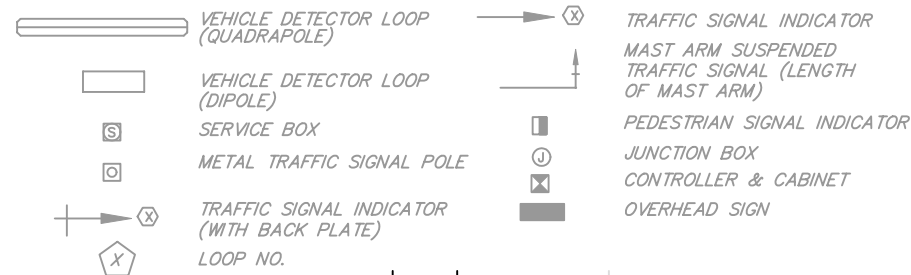

Existing Serving Box

NOTES:

- Contractor shall remove and stockpile for City of Wichita existing signals, signal poles, controller, cabinets, and manhole covers. Contractor shall notify Traffic Engineering Department two weeks prior to start of construction.
- Traffic to be carried through construction. See Construction Traffic Control Plan.
- Contractor shall contact all utility companies which may be affected by this construction prior to beginning of construction.
- Service Box, Junction Box and conduit runs are typical only and should be adjusted during installation to clear obstructions and facilitate wiring.
- The traffic signal system shall be complete and the Contractor shall furnish and install all equipment necessary for the satisfactory operation of electrical apparatus and for the complete operation of traffic signal system whether specifically mentioned or not.
- Longitudinal orientation of loops shall be adjusted so that no loop begins or ends within 0.3048 m of a transverse joint.
- Install continuous 6-PR cable from controller @ I-135 : 13th (East Int.) to controller @ 13th: Hydraulic.

DETECTORS

LOOP NO.	SIZE	NO. OF TURNS	MOVEMENT CALLED
1	2 m x 5 m	4	
2	2 m x 5 m	4	
3	1.6 m x 15 m	2-4-2	
4	2 m x 5 m	4	
5	1.6 m x 15 m	2-4-2	
6	2 m x 5 m	4	
7	1.6 m x 9 m	3	
8	1.6 m x 5 m	4	
9	2 m x 6 m	4	
10	2 m x 4 m	4	

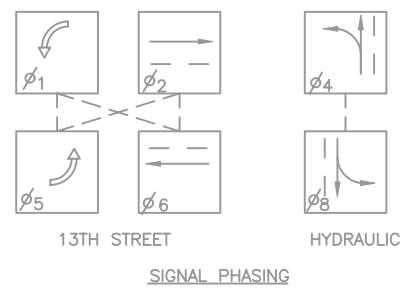

INTERVAL	"WAPITI PROGRAM"								NORMAL DISPLAY									
	PHASE								TIME CLOCK		FEATURES							
	1	2	3	4	5	6	7	8	C	F	1	2	3	4	5	6	7	8
MAX.	30	80	40	30	80	40		YEAR	VEH. RECALL		X					X		
MAX. 2	30	80	40	30	80	40		MONTH	PED. RECALL									
WALK	8	8	8	8	8	8	8	DAY / MONTH	RED / LOCK									
FL. DW.	15	20	15	20	15	20	20	DAY / WEEK	YELLOW LOCK		X				X			
MAX. INTL.	6	10	10	6	10	10	10	HOUR	PERMIT	X	X	X	X	X	X	X	X	
MIN. GREEN	5	8	8	5	8	8	8	MINUTE	PED. PHASES	X	X							
TBR	1	15	1	1	15	1	1	SECOND	LEAD PHASES	X	X	X	X	X	X	X	X	
TTR	1	25	1	1	25	1	1		DBL. ENTRY	X	X	X	X	X	X	X	X	
									SEQUENTIAL									
PASSAGE	1	2.0	1.5	1	2.0	1.5	1.5		STARTUP									
MIN. GAP	1	1.0	1.5	1	1.0	1.5	1.5		OVERLAP A									
ADD ACT	1	1.5	1.5	1	1.5	1.5	1.5		OVERLAP B									
YELLOW	3	3.5	3.0	3	3.5	3.0	3.0		OVERLAP C									
RED CLR.	1	1.5	1.5	1	1.5	1.5	1.5		OVERLAP D									
RED REV.									EXCLUSIVE									
WALK II									SIM GAP									