

TRAFFIC CONTROL SIGNS & SIGN POST *

Station	Location from C	Classification - Each										Sign Post Length		
		R1-1	R2-1	R3-7	R3-9b	W4-2	① SNS						Breakaway 1-3/4"x1-3/4"	U-Channel
27+77.5	Lt.	1												
27+67.5	Rt.						1							
28+16.7	Rt.	1												
28+40.9	Lt.						1							
35+15.8	Rt.		1											
Total		2	1				2							

* All are existing signs

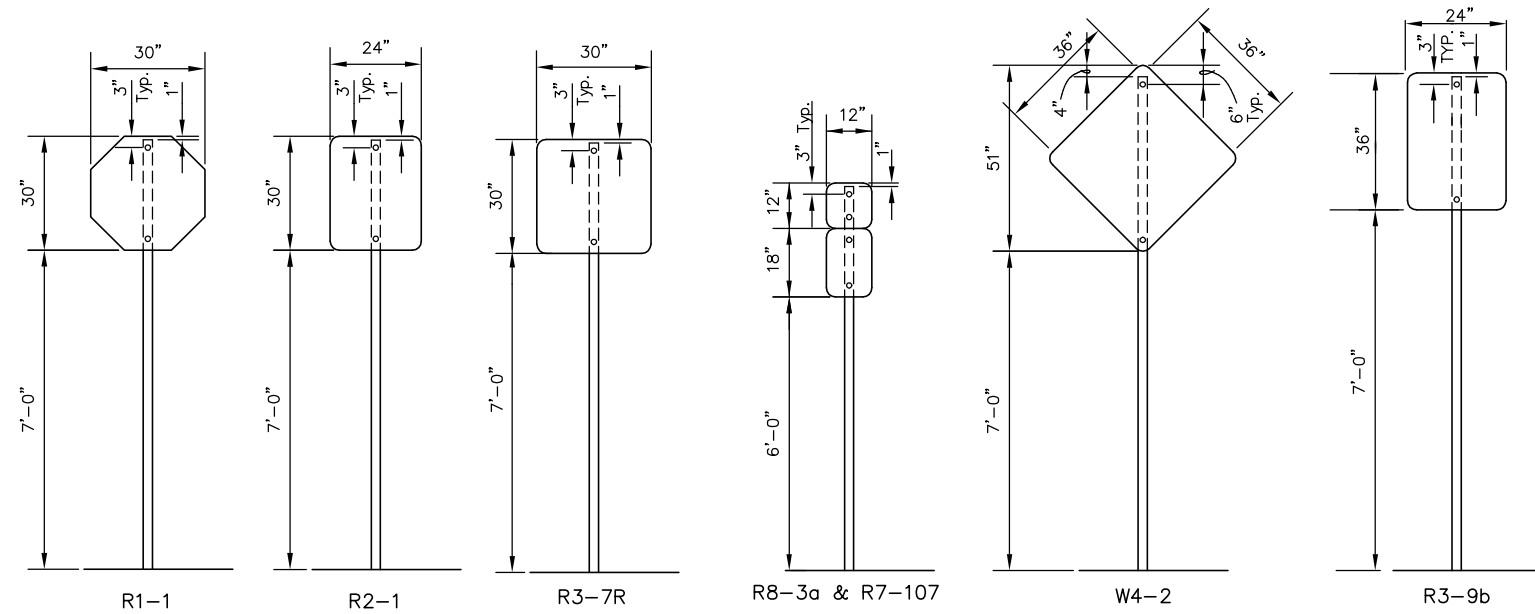

STATE	PROJECT NO.	YEAR	SHEET NO.	TOTAL SHEETS
KANSAS	87 N-0308-01	2005	24	37

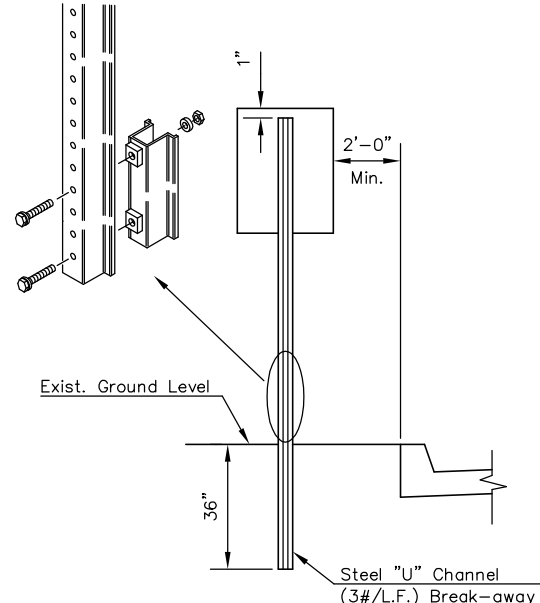

TRAFFIC SIGN INSTALLATION DETAIL FOR SIGNS NOT GREATER THAN 12" WIDE

SIGN POST LENGTH SUMMARY	
ITEM	EACH
BREAKAWAY SIGN POST:	
2-1/4"x2-1/4"x18" Anchor Sleeve	3
2"x2"x36" Sign Post Anchor	3
1 3/4"x1 3/4"x 10'-6" Traffic Sign Post	
STREET SIGN POST:	
2 3/8" O.D. x 9'-0" Street Sign Post	
U-CHANNEL	
LENGTH	EACH
STUBS 3'	
POSTS 8'	
POSTS 9'	
POSTS 9-1/2'	
POSTS 11'	

RECAPITULATION OF MATERIALS		
ITEMS	TOTAL	UNIT
Traffic Sign Face, (High Intensity HA Reflective Sheeting)		S.F.
Street Sign Face, (High Intensity Reflective Sheeting)		S.F.
Breakaway Sign Post, 1-3/4" x 1-3/4" x 10'-6"		L.F.
Breakaway Anchor Sleeve, 2-1/4" x 2-1/4" x 18"	4.5	L.F.
Breakaway Sign Post Anchor, 2" x 2" x 36"	9.0	L.F.
2 3/8" O.D. x 9'-0" Street Sign Post		

RECAPITULATION OF MATERIALS		
BID ITEMS	TOTAL	UNIT
Signing	LUMP SUM	S.F.

SIGN DESCRIPTION			
CLASSIFICATION	TYPE	SIZE	AREA
R1-1	STOP SIGN	30"x30"	5.18 SQ. FT.
R2-1	SPEED LIMIT	24"x30"	5.00 SQ. FT.
R3-7R	RT. LANE MUST TURN RT.	30"x30"	6.25 SQ. FT.
R3-9b	TWO WAY LEFT TURN ONLY	24"x36"	6.00 SQ. FT.
R7-107	NO PARKING BUS STOP	12"x18"	1.50 SQ. FT.
W4-2	LANE REDUCTION TRANSITION	36"x36"	9.00 SQ. FT.

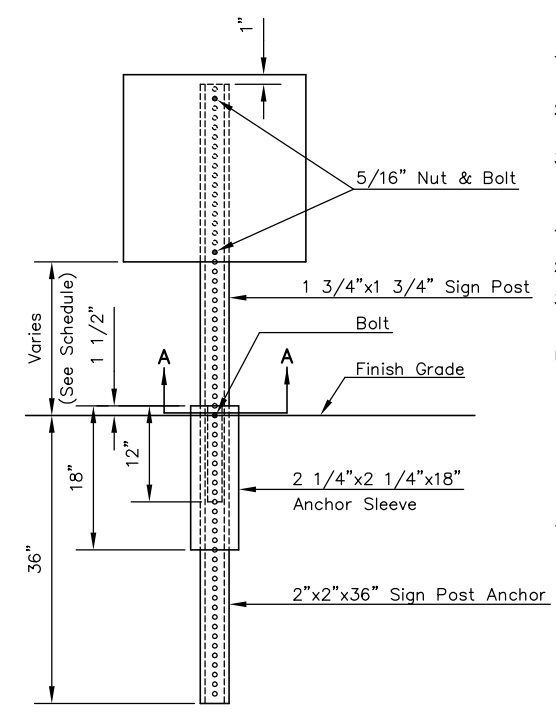

BREAK-AWAY SIGN POST DETAIL SECTION A-A

- PAVEMENT INSTALLATION SEQUENCE**
- SIGN POST ANCHOR DRIVEN INTO SUBGRADE PRIOR TO THE PLACEMENT OF THE PAVEMENT.
 - ANCHOR SLEEVE DRIVEN INTO SUBGRADE OVER THE SIGN POST ANCHOR PRIOR TO THE PLACEMENT OF THE PAVEMENT.
 - INSERT SIGN POST INTO THE SIGN POST ANCHOR AND BOLT IN PLACE.
- GROUND INSTALLATION SEQUENCE**
- SIGN POST ANCHOR DRIVEN INTO THE GROUND.
 - ANCHOR SLEEVE DRIVEN INTO THE GROUND OVER THE SIGN POST ANCHOR.
 - INSERT SIGN POST INTO THE SIGN POST ANCHOR AND BOLT IN PLACE.

NOTE: IN ALL INSTALLATIONS THE FIRST HOLE ABOVE THE FINISHED GRADE LEVEL IN ALL THREE UNITS MUST BE IN LINE FOR INSERTION OF THE BOLT.

ALL BOLTS AND NUTS FOR FASTENING THE SIGNS AND SIGN POST ASSEMBLY SHALL COMPLY WITH SECTION 1614 AND ALL WASHERS SHALL COMPLY WITH SECTION 1614 OF THE STANDARD SPECIFICATION FOR STATE ROAD AND BRIDGE CONSTRUCTION (1990 EDITION) AND SHALL BE SUBSIDIARY ITEM.

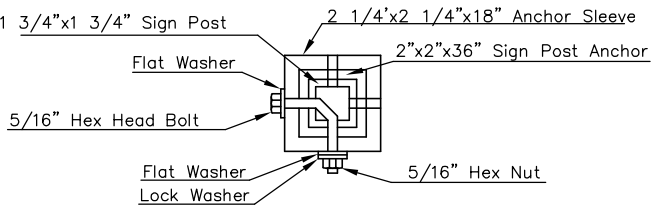

NOTE: ALL LETTER, NUMBER, & SYMBOL SIZES, SPACING, & COLORS AND THE SIGN COLORS SHALL CONFORM TO THE CURRENT "MANUAL ON UNIFORM TRAFFIC CONTROL DEVICES."

ALL SIGN MATERIAL TO BE 0.080" ALUMINUM.

J:\Civil\03431\dwg\Details\03431sn1.dwg 2/9/2005 2:54:55 PM CST

KANSAS DEPARTMENT OF TRANSPORTATION

SIGNING DETAILS

PROJECT NO. 87 N-0308-01 SEDGWICK CO.

M K E C ENGINEERING CONSULTANTS, INC.
WICHITA, KANSAS

DESIGNED BY: JRA	CHECKED BY: JRA
DRAWN BY: DPG	DATE: 6/30/04 SHEET 24 OF 37