

BENCHMARKS:
 BM #1: "□" Cut on Top of Curb at West Line of Lot 7, Block A, Auburn Hills 5th Addition. Elev. = 207.73 (City Datum)

BM #2: Disc in Back of Curb, North of Front Corner Common to Lots 23 and 24, Block D, Auburn Hills 12th Addition. Elev. = 191.84 (City Datum)

BM #3: "□" Cut in Middle of Curb Inlet Top Adjacent to the South Corner of Lot 15, Block B. Elev. = 196.44 (City Datum)

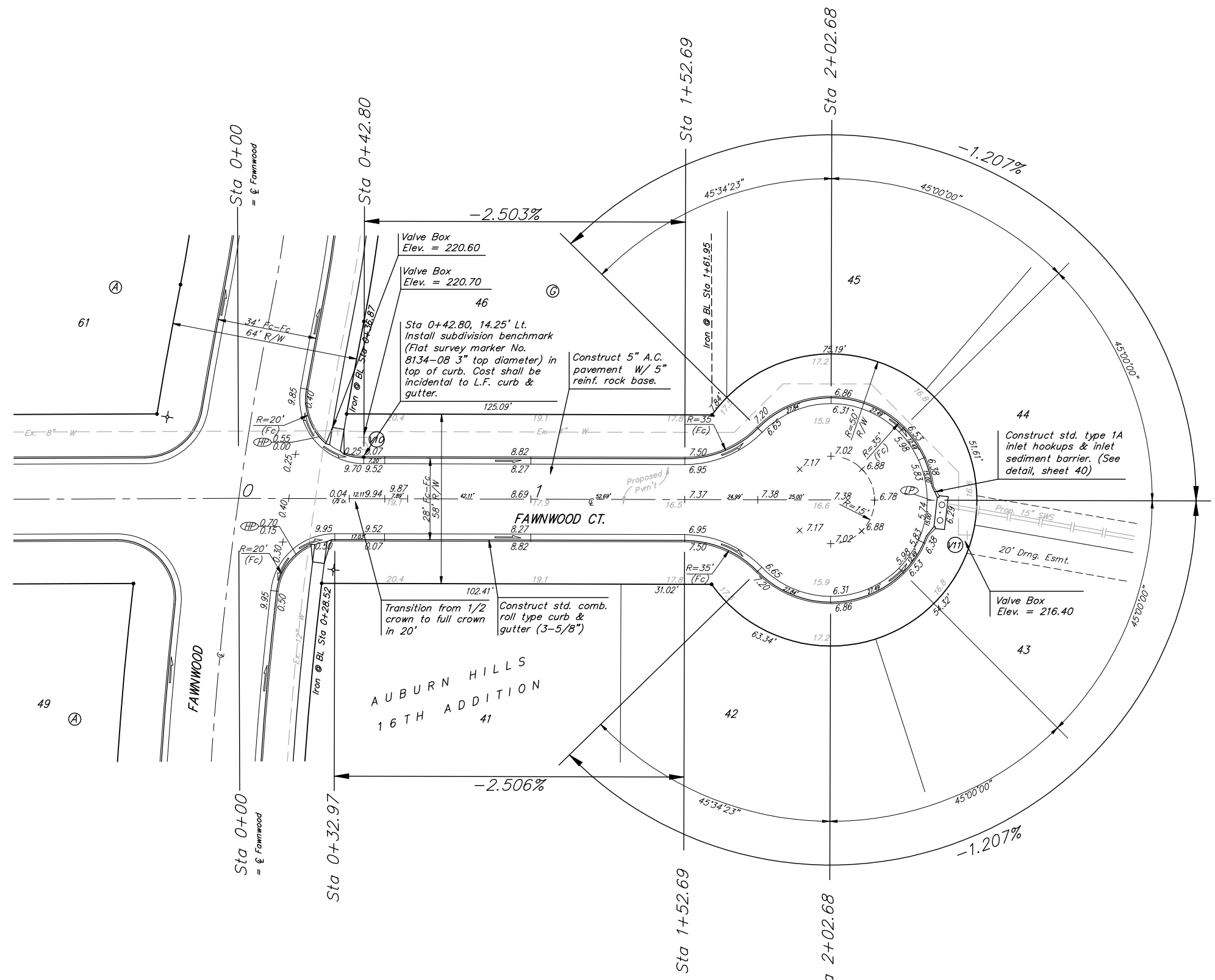
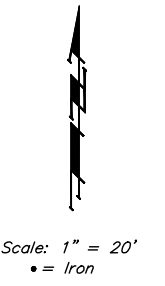

P.V.I. Elev. = 216.20
 30' V.C.

NOTE: ROLL TYPE CURB & GUTTER TO BE CONSTRUCTED ON THE PAVEMENT SHOWN ON THIS SHEET. TOP OF CURB ELEVATIONS ARE GIVEN FOR FULL HEIGHT CURB.

WATER VALVE LOCATION TABLE

VALVE NUMBER	BASELINE STATION	OFFSET DISTANCE	OFFSET DIRECTION
V10	0+42.80	21'	Lt.
V11	2+46.41	11.9'	Rt.

Paving contractor will be responsible to operate all water valves on the project, in the presence of the inspector, to ensure accessibility to the valves, and that all valves are left in the "ON" position when the project is completed.

Trees and shrubs in public right-of-way which are in direct conflict with proposed new construction shall be removed by the Contractor ONLY with the Developer or Baughman Company approval. Trees and shrubs which are not in direct conflict with proposed new construction shall be saved and protected from damage.

Baughman		AUBURN HILLS 16TH ADD. - PH. II FAWNWOOD CT. LOTS 41-46, BLOCK G Sta 0+00 to Sta 2+02.68	
Baughman Company, P.A. 315 8th St. W. W. 48069, MI 48069 P 313-262-7271 F 313-262-0149 ENGINEERING SURVEYING PLANNING LANDSCAPE ARCHITECTURE			
PROJECT NUMBER 472-64291	DESIGN AEO	DRAWN TMS	
REVISIONS:	APPROVED	DATE 06/06	
	SCALE Noted	SHEET 15 OF 61	
AuburnHills16th_PhaseII_Sct9		06-02-E502	