

POLE/CONTROLLER LOCATIONS		
POLE NO.	STATION	OFFSET
1	62+25.13	37.0' Lt.
2	62+18.45	55.5' Rt.
3	63+21.22	54.5' Rt.
4	63+28.16	54.5' Lt.

SIGNAL FACES

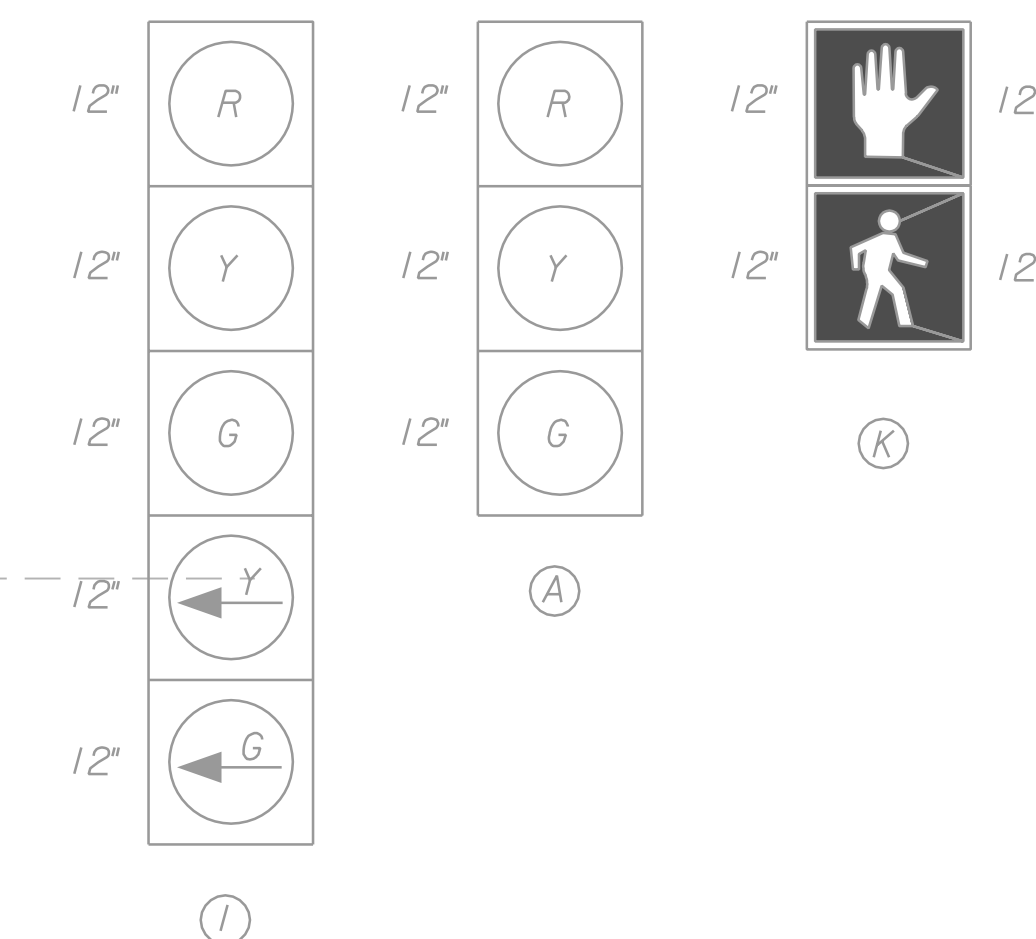

Scale
1" = 10' (Horizontal)

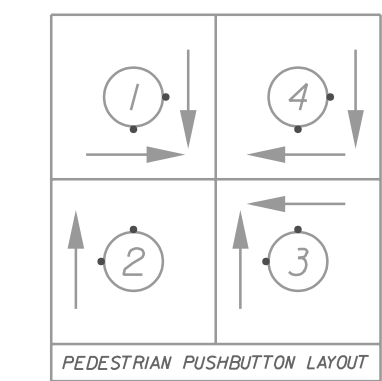

LEGEND

- METAL TRAFFIC SIGNAL POLE
- ⊕ METAL TRAFFIC SIGNAL PEDESTAL
- ⊕ PEDESTRIAN SIGNAL INDICATION
- TRAFFIC SIGNAL INDICATION
- + TRAFFIC SIGNAL WITH BACKPLATE
- (8') MAST ARM SUSPENDED TRAFFIC SIGNAL
- ▣ 24" SERVICE BOX
- 18" SERVICE BOX
- ⊙ JUNCTION BOX
- CONDUIT (TRENCHED)
- - - CONDUIT (BORED)
- CONTROLLER AND CABINET (POLE MOUNTED)
- ⊗ EXISTING CONTROLLER AND CABINET
- ⊙ SECONDARY SERVICE POINT
- ⊙ DETECTOR NUMBER
- ▭ VEHICLE DETECTOR LOOP
- ⊙ LUMINAIRE
- P.B. PEDESTRIAN PUSH BUTTON
- ⊙ POLE NUMBER
- ⊙ SIGN
- ▨ VIDEO DETECTION ZONES

SIGNAL PHASING

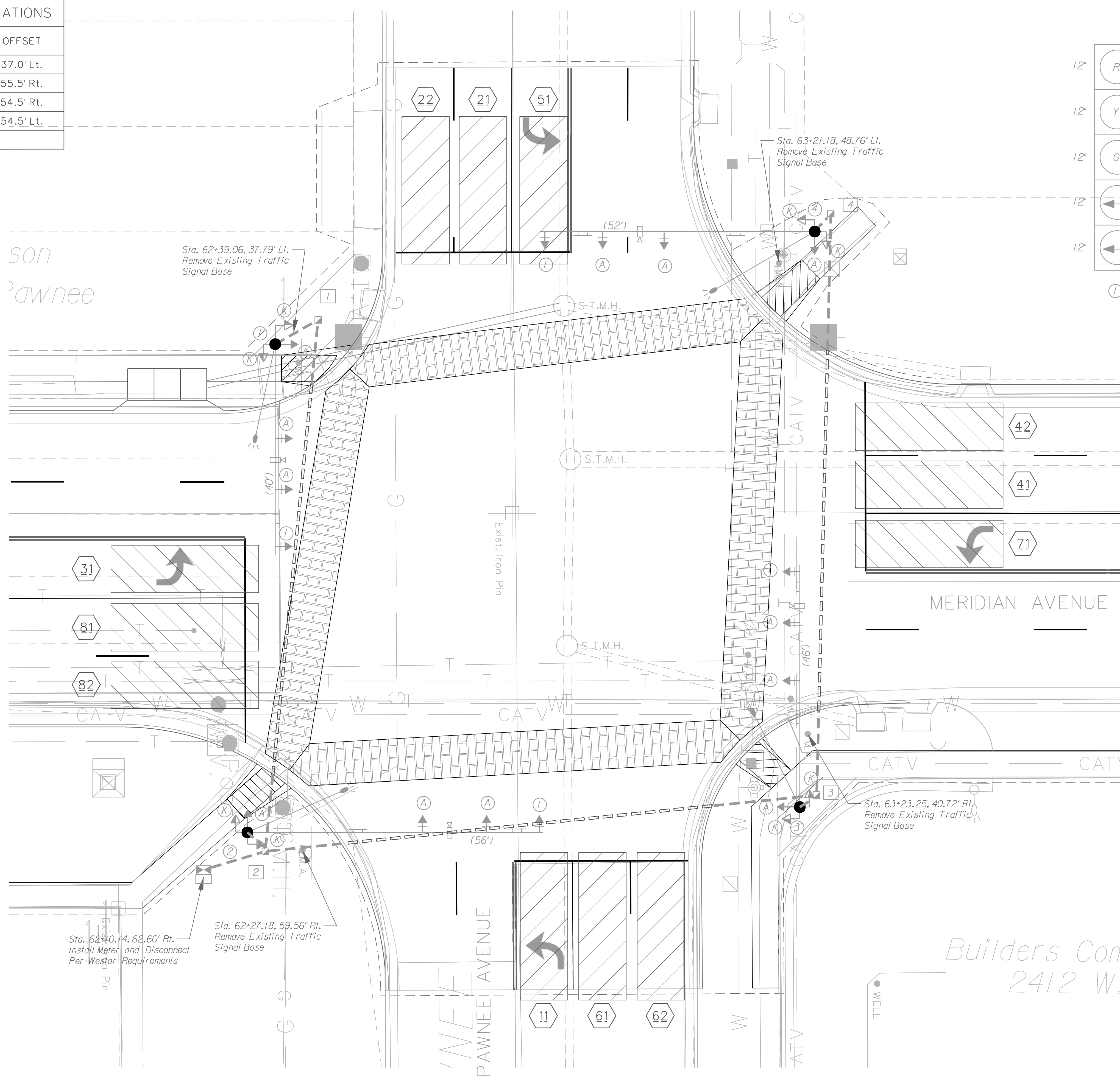
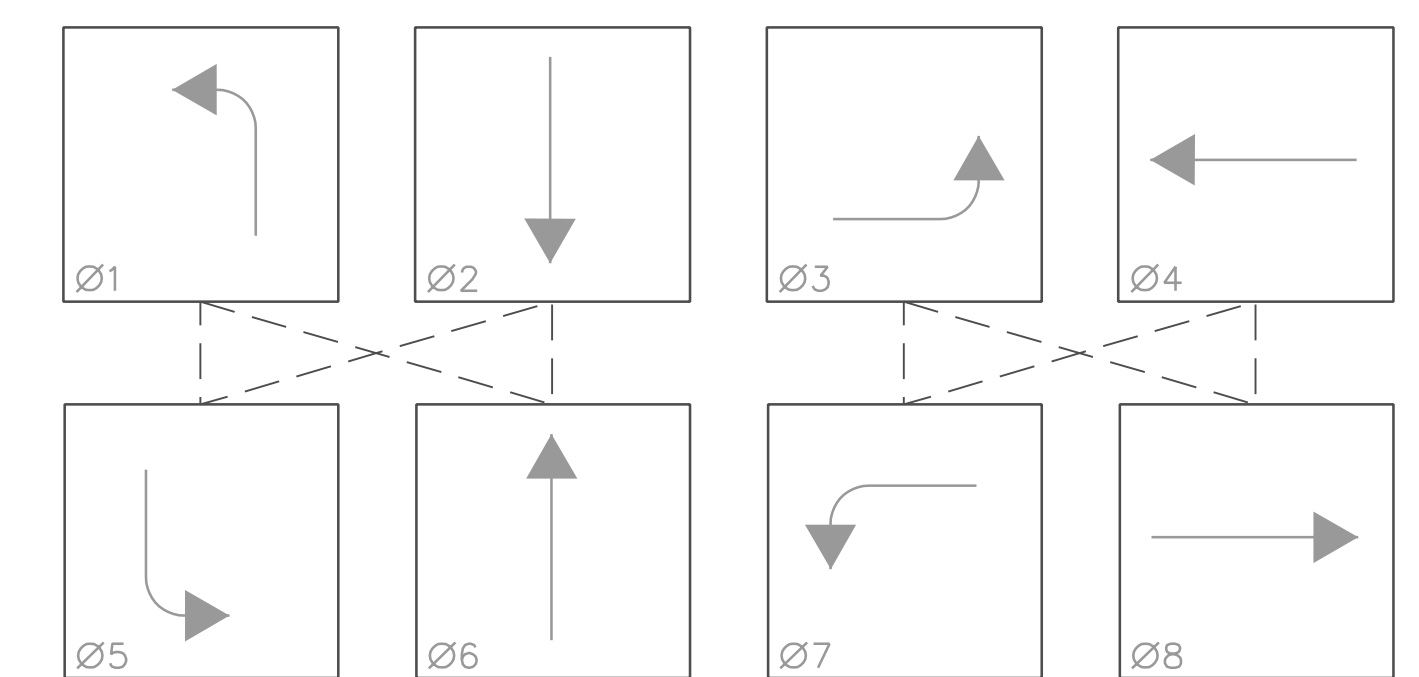

CITY OF WICHITA		PROJECT NO. 472-2012	
MERIDIAN AVENUE 31ST TO PAWNEE			
MERIDIAN AND PAWNEE INTERSECTION			
TRAFFIC SIGNAL INSTALLATION			
WICHITA		KANSAS	
DESIGNED BY	J.R.L.	DRAWN BY	J.R.L.
CHECKED BY	B.A.L.	DATE	3/2005
SCALE	1" = 10'	SHEET NO.	69

8: \\w03\0005\road\paw03.dht