

NOTE: SBC POLES ON NORTH SIDE OF CENTRAL TO BE RELOCATED IN PHASES 5 & 6.

STATE	PROJECT NUMBER	FISCAL YEAR	SHEET NUMBER	TOTAL SHEETS
KANSAS	87N-0251-01	2006	10	106

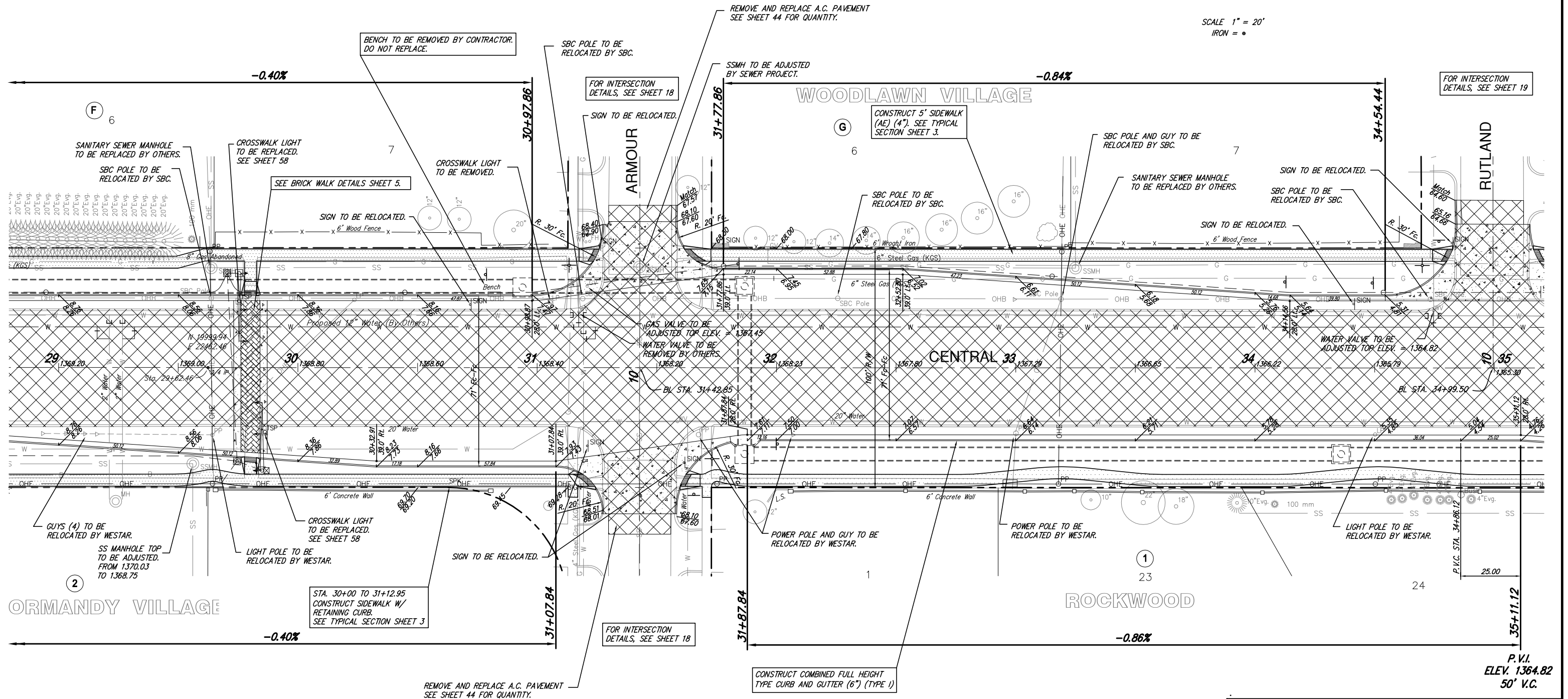

SCALE 1" = 20'  
IRON = •



PAVING IMPROVEMENTS  
CENTRAL STA. 29+00 TO 35+00  
WICHITA, KANSAS

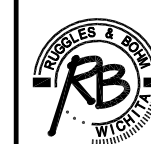

Ruggles & Bohm, P.A.  
Engineering, Surveying, Land Planning  
924 North Main  
Wichita, Kansas 67203  
www.rbkansas.com  
(316) 264-8008  
(316) 264-4621 fax  
E-mail: info@rbkansas.com

DESIGN	KWL	SHEET 10 OF 106
DRAWN	RA	
REVIEW		
UTILITY		

DRAWING FILE: paving {SHT 5} PROJECT NUMBER: 472-87506 DATE: July 10, 2006