

STA. 34+30.17 LINE 1
BL STA. 9+97.16, 32.0' LT.
CONSTRUCT STD. TYPE P MANHOLE
(5.0' DIA.) TOP = 1374.63

STA. 38+00.17 LINE 1
BL STA. 6+27.16, 32.0' LT.
CONSTRUCT STD. TYPE P MANHOLE
(5.0' DIA.) TOP = 1378.05

STA. 38+09.13 LINE 1
BL STA. 6+24.49, 39.5' LT.
CONSTRUCT STD. TYPE 1 INLET
(DOUBLE) L = 10'-0" W = 3'-0"
TOP = 1378.18

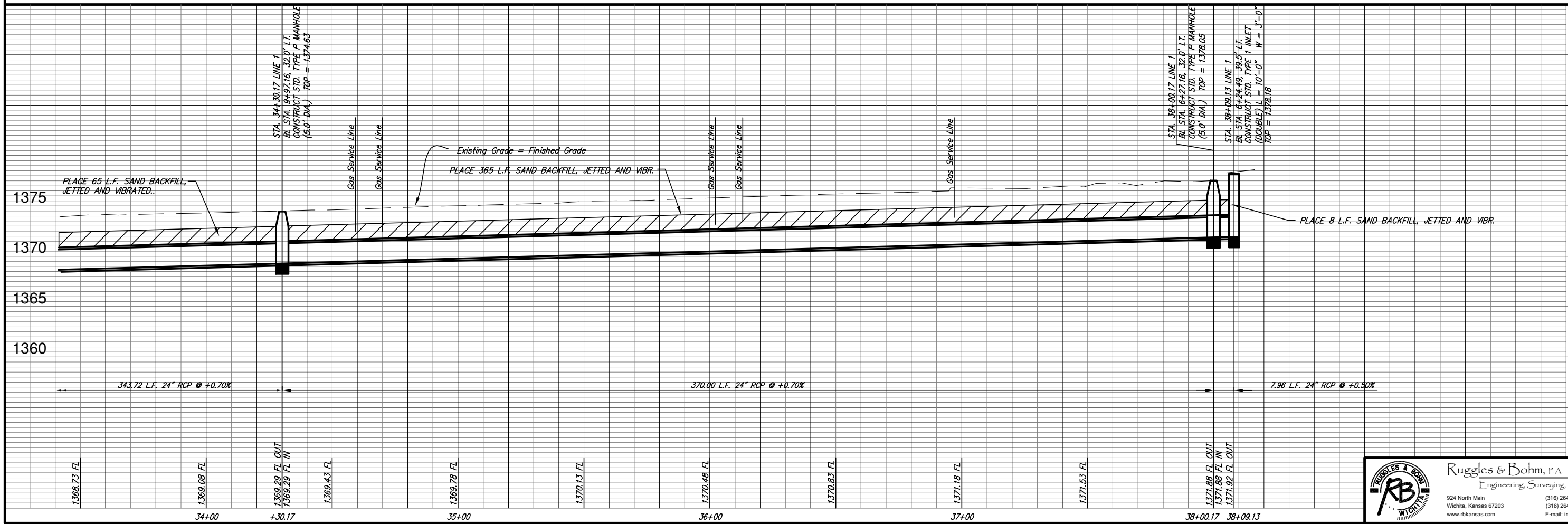

PROJECT NUMBER 472-83874	DESIGN KWL	DRAWN RA	REVIEW RA
DRAWING FILE storm sewer (line 1-7)	UTILITY	DATE July 10, 2006	REVIEW
PAVING IMPROVEMENTS STORM SEWER LINE 1		33	
WICHITA, KANSAS		OF	
		106	

Ruggles & Bohm, P.A.
Engineering, Surveying, Land Planning

924 North Main
Wichita, Kansas 67203
www.rbkansas.com

(316) 264-8008
(316) 264-4621 fax
E-mail: info@rbkansas.com