

BENCHMARK:
 BM #8 - Steel T-Post Driven 4' Deep
 Sta. 18+00, 25' Rt.
 Elev. = 1337.73 MSL

SCALE:
 HORIZONTAL: 1" = 20'
 VERTICAL: 1" = 5'

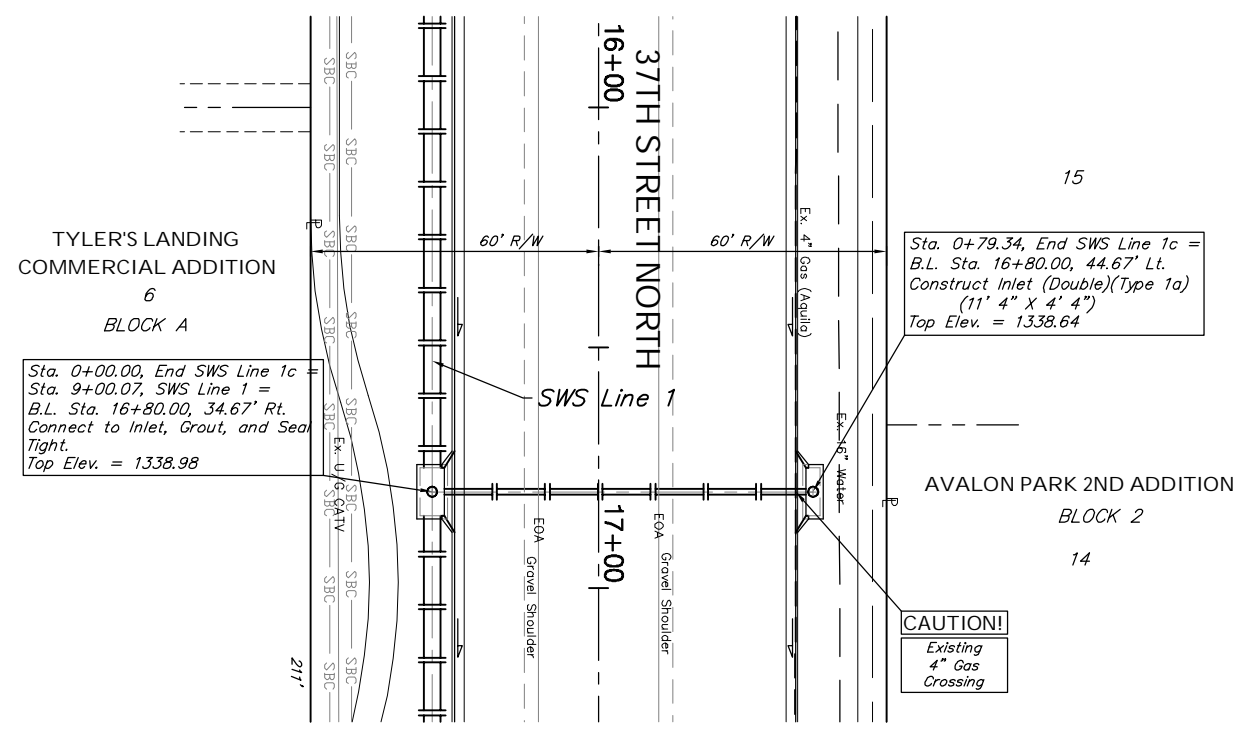

Sta. 0+00.00, End SWS Line 1c =
 Sta. 9+00.07, SWS Line 1 =
 B.L. Sta. 16+80.00, 34.67' Rt.
 Connect to Inlet, Grout, and Seal
 Tight.
 Top Elev. = 1338.98

Sta. 0+79.34, End SWS Line 1c =
 B.L. Sta. 16+80.00, 44.67' Lt.
 Construct Inlet (Double)(Type 1a)
 (11' 4" X 4' 4")
 Top Elev. = 1338.64

CAUTION!
 Existing
 4" Gas
 Crossing

FHWA NO. REGION	STATE	PROJECT NO.	FISCAL YEAR	SHEET NO.	TOTAL SHEETS
7	KANSAS	87 N-0346-01	2006	62	146

BENCHMARK:
 BM #8 - Steel T-Post Driven 4' Deep
 Sta. 18+00, 25' Rt.
 Elev. = 1337.73 MSL

SCALE:
 HORIZONTAL: 1" = 20'
 VERTICAL: 1" = 5'

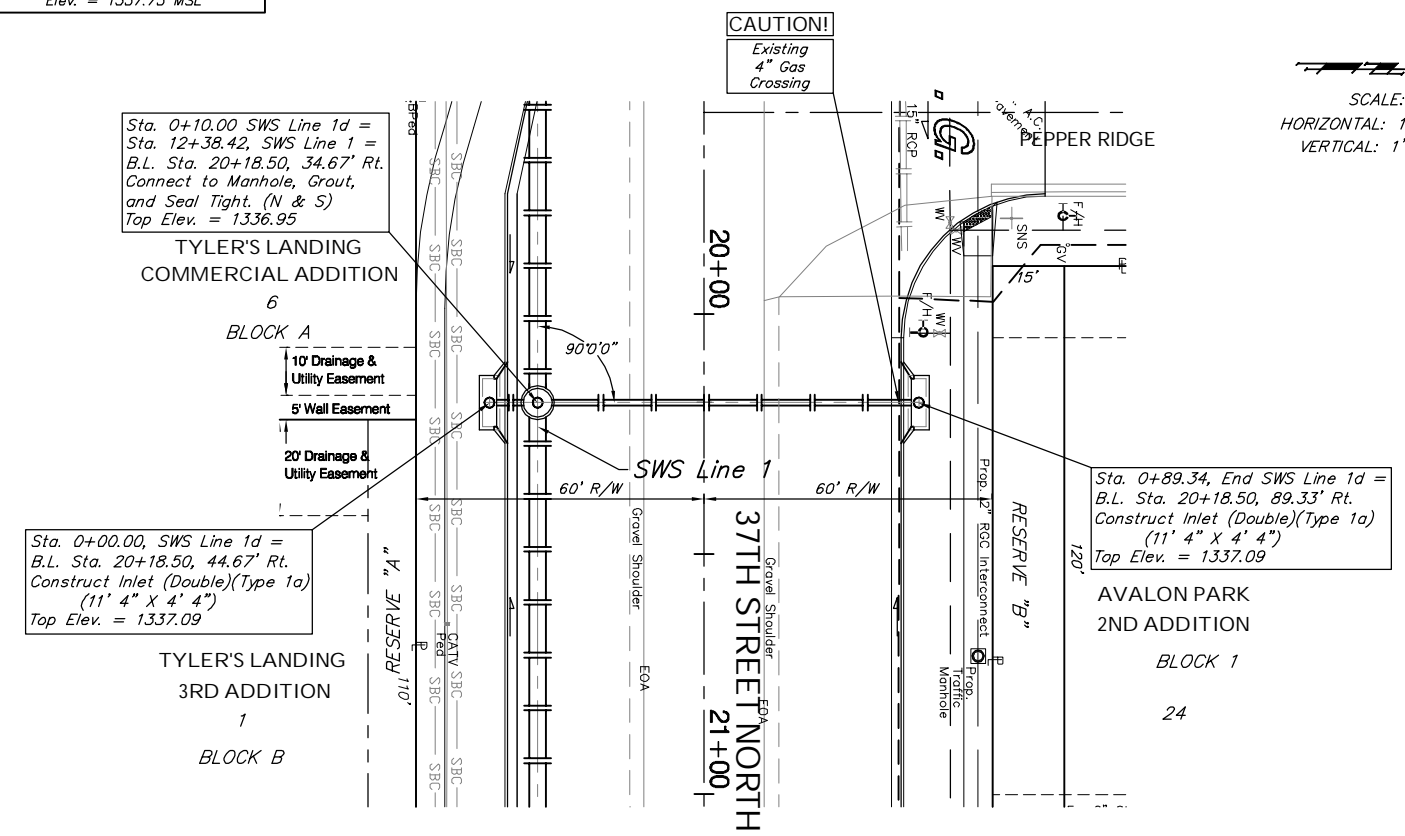

Sta. 0+10.00, SWS Line 1d =
 Sta. 12+38.42, SWS Line 1 =
 B.L. Sta. 20+18.50, 34.67' Rt.
 Connect to Manhole, Grout,
 and Seal Tight. (N & S)
 Top Elev. = 1336.95

Sta. 0+00.00, SWS Line 1d =
 B.L. Sta. 20+18.50, 44.67' Rt.
 Construct Inlet (Double)(Type 1a)
 (11' 4" X 4' 4")
 Top Elev. = 1337.09

Sta. 0+89.34, End SWS Line 1d =
 B.L. Sta. 20+18.50, 89.33' Rt.
 Construct Inlet (Double)(Type 1a)
 (11' 4" X 4' 4")
 Top Elev. = 1337.09

CAUTION!
 Existing
 4" Gas
 Crossing

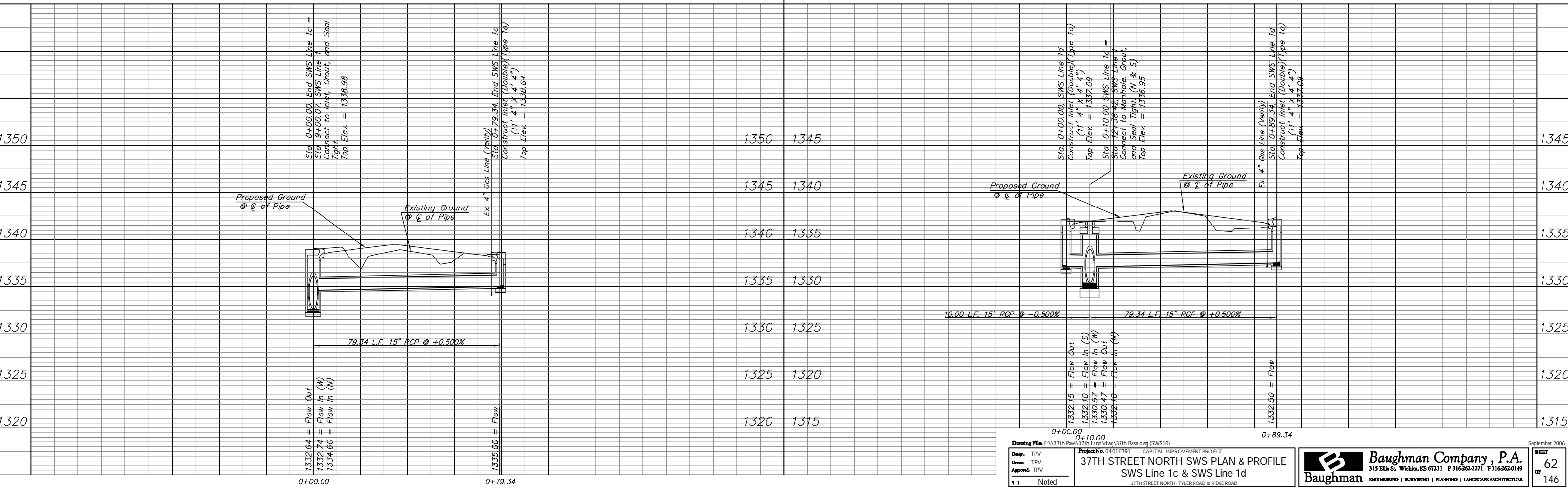

Sta. 0+00.00, End SWS Line 1c =
 Sta. 9+00.07, SWS Line 1 =
 Connect to Inlet, Grout, and Seal
 Tight.
 Top Elev. = 1338.98

Sta. 0+79.34, End SWS Line 1c =
 Construct Inlet (Double)(Type 1a)
 (11' 4" X 4' 4")
 Top Elev. = 1338.64

Proposed Ground
 @ C of Pipe

Existing Ground
 @ C of Pipe

1332.64 = Flow Out
 1332.74 = Flow In (W)
 1334.60 = Flow In (N)

1335.00 = Flow

Sta. 0+10.00, SWS Line 1d
 Construct Inlet (Double)(Type 1a)
 (11' 4" X 4' 4")
 Top Elev. = 1337.09

Sta. 0+10.00, SWS Line 1d =
 Sta. 12+38.42, SWS Line 1 =
 Connect to Manhole, Grout,
 and Seal Tight. (N & S)
 Top Elev. = 1336.95

Proposed Ground
 @ C of Pipe

Existing Ground
 @ C of Pipe

1332.15 = Flow Out
 1332.10 = Flow In (S)
 1330.57 = Flow In (W)
 1330.47 = Flow Out
 1332.10 = Flow In (N)

1332.50 = Flow

Drawing File: F:\37th Pave\37th Land\dwg\37th Base.dwg (SWS10)
 Design: TPV
 Drawn: TPV
 Approved: TPV
 1 Noted

37TH STREET NORTH SWS PLAN & PROFILE
 SWS Line 1c & SWS Line 1d
 37TH STREET NORTH - TYLER ROAD TO RIDGE ROAD

Baughman Company, P.A.
 315 Ellis St. Wichita, KS 67211 P 316-262-7271 F 316-262-0149
 ENGINEERING | SURVEYING | PLANNING | LANDSCAPE ARCHITECTURE

September 2006
 SHEET
 62
 OF
 146