

BENCHMARK:
 BM #1a - Railroad Spike in the North Face of the Second Power Pole East of Ridge Road on the South Side of 37th Street North
 Sta. 64+43, 59' Rt.
 Elev. = 1330.54 MSL

Sta. 13+85.25, End SWS Line 2 =
 B.L. Sta. 61+89.00, 49.42' Lt.
 Construct Inlet (Single)(Type 1a)
 (11' 4" X 5' 4")
 Top Elev. = 1329.72

Sta. 15+00.11, End SWS Line 2 =
 B.L. Sta. 62+74.60, 112.19' Rt.
 Install 24" Concrete End Section
 and 5.3 S.Y. Light Stone Rip Rap.

Sta. 14+83.95, SWS Line 2 =
 B.L. Sta. 62+74.65, 96.13' Lt.
 Construct Std. Shallow Type
 "P" Manhole (4' Dia.)
 Top Elev. = 1331.80

Sta. 13+01.08, SWS Line 2 =
 B.L. Sta. 61+89.00, 35.75' Rt.
 Construct Inlet (Double)(Type 1)
 (11' 4" X 6' 4")
 Top Elev. = 1329.64

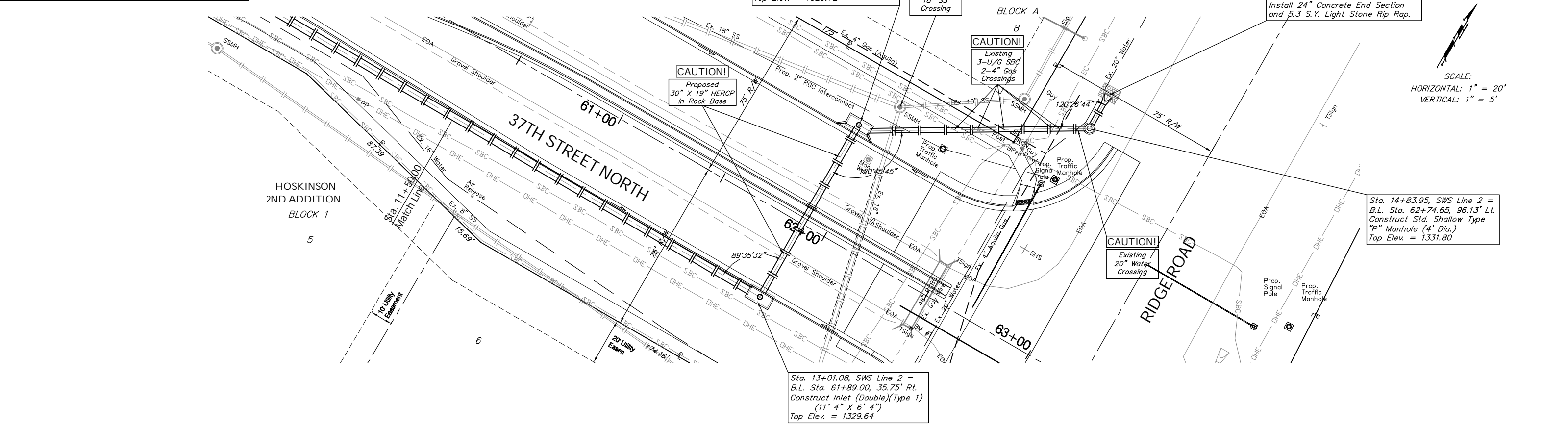

SCALE:
 HORIZONTAL: 1" = 20'
 VERTICAL: 1" = 5'

