

N-1,684,252.4027, E-1,648,558.6831
@ Waterman Ave., Sta. 100+11.14, 19.6' Rt.=
Adjust Existing Water Valve
Existing Top of Box Elev.= 1298.3
Proposed Top of Box Elev.= 1298.2
Difference = -0.1'

N-1,684,306.7851, E-1,648,563.7725
@ Waterman Ave., Sta. 100+17.41, 34.6' Lt.=
Adjust Existing Water Valve
Existing Top of Box Elev.= 1298.1
Proposed Top of Box Elev.= 1298.0
Difference = -0.1'

N-1,684,326.6236, E-1,648,904.5509
@ Market St., Sta. 300+48.41, 24.2' Lt.=
Adjust Existing Water Valve (C.O.W. #14784)
Existing Top of Box Elev.= 1296.9
Proposed Top of Box Elev.= 1297.1
Difference = +0.2'

N-1,684,328.7558, E-1,649,282.2063
@ Broadway Ave., Sta. 400+42.03, 19.0' Lt.=
Adjust Existing Water Valve (C.O.W. #8388)
Existing Top of Box Elev.= 1996.9
Proposed Top of Box Elev.= 1297.0
Difference = +0.1'

N-1,684,330.3103, E-1,649,284.1764
@ Broadway Ave., Sta. 400+43.55, 17.0' Lt.=
Adjust Existing Water Valve (C.O.W. #35416)
Existing Top of Box Elev.= 1297.3
Proposed Top of Box Elev.= 1297.1
Difference = -0.2'

@ Main St., Sta. 200+00.00=
@ Waterman St., Sta. 100+00.00

N-1,684,269.3018, E-1,648,633.9709
@ Waterman Ave., Sta. 100+86.80, 4.2' Rt.=
Adjust Existing Water Valve
Existing Top of Box Elev.= 1298.2
Proposed Top of Box Elev.= 1298.3
Difference = +0.1'

@ Waterman St., Sta. 103+82.61=
@ Market St., Sta. 300+00.00

@ Waterman St., Sta. 107+55.04=
@ Broadway Ave., Sta. 400+00.00

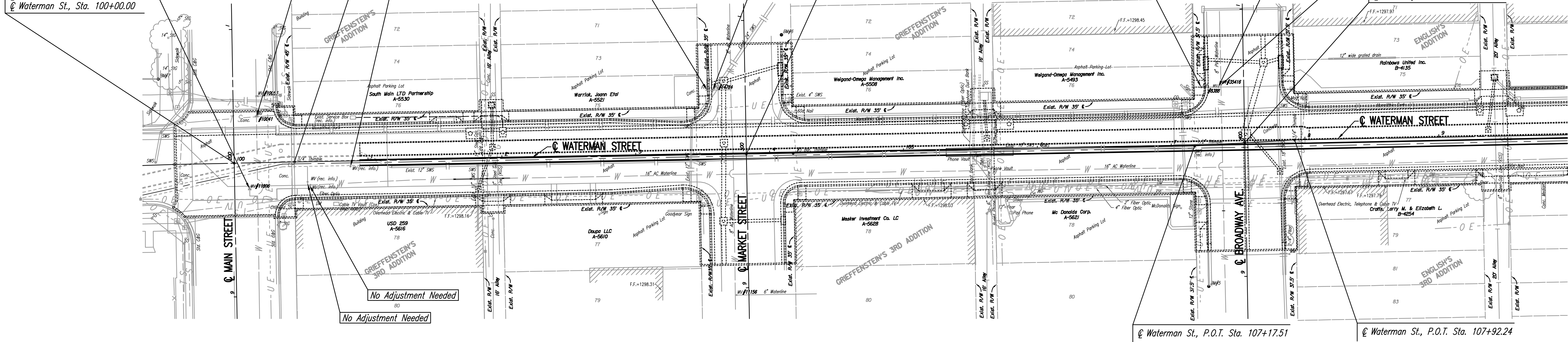

N-1,684,253.1580, E-1,649,652.7375
@ Topeka St., Sta. 499+58.11, 27.2' Lt.=
Adjust Existing Fire Hydrant (C.O.W. #631)
Exist. Bury Line El.= 1296.7
Proposed Bury Line El.= 1296.9
Difference = +0.2'
Install 1- Fire Hydrant Extension

N-1,684,356.1685, E-1,650,049.7086
@ Emporia St., Sta. 600+53.34, 8.4' Lt.=
Existing Water Valve
Remove and Salvage to the City

N-1,684,355.0895, E-1,650,088.6770
@ Emporia St., Sta. 500+51.54, 30.5' Rt.=
Adjust Existing Water Meter Vault (C.O.W. #4783)
Existing Top of Box Elev.= 1294.4
Proposed Top of Box Elev.= 1294.3
Difference = -0.1'

N-1,684,291.3000, E-1,650,404.5271
@ Waterman St., Sta. 118+57.50, 18.5' Rt.=
Existing Water Valve (C.O.W. #20877)
Close Valve, Remove Box and Salvage to the City

@ Waterman St., Sta. 111+32.35=
@ Topeka St., Sta. 500+00.00

@ Waterman St., Sta. 115+12.40=
@ Emporia St., Sta. 600+00.00

@ Waterman St., Sta. 118+96.65=
@ St. Francis St., Sta. 700+00.00

@ Waterman St., P.O.T. Sta. 119+32.65

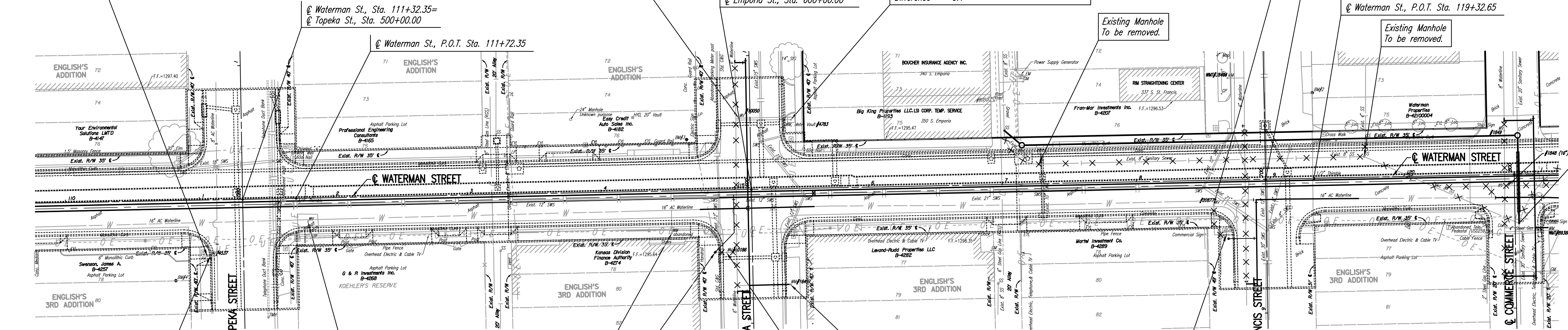

N-1,684,253.1762, E-1,649,654.8827
@ Topeka St., Sta. 499+58.09, 25.0' Lt.=
Adjust Existing Water Valve (C.O.W. #4537)
Existing Top of Box Elev.= 1296.6
Proposed Top of Box Elev.= 1296.9
Difference = + 0.3'

N-1,684,278.7648, E-1,649,727.9873
@ Topeka St., Sta. 111+80.76, 17.7' Rt.=
Adjust Existing Water Valve
Existing Top of Box Elev.= 1296.3
Proposed Top of Box Elev.= 1296.1
Difference = -0.2'

N-1,684,255.9374, E-1,650,032.1307
@ Emporia St., Sta. 599+53.45, 27.9' Lt.=
Existing Fire Hydrant (C.O.W. #626)
Remove Fire Hydrant and Salvage to the City

N-1,684,270.3036, E-1,649,999.7568
@ Emporia St., Sta. 114+52.39, 31.5' Rt.=
Existing Water Meter
Remove and Salvage to the City

N-1,684,328.7558, E-1,649,282.2063
@ Broadway Ave., Sta. 599+59.12, 19.3' Lt.=
Existing Water Valve (C.O.W. #10186)
Remove Valve and Salvage to the City

N-1,684,269.1562, E-1,650,413.9878
@ Emporia St., Sta. 699+59.12, 30.0' Lt.=
Existing Fire Hydrant (C.O.W. #6630)
Remove Fire Hydrant and Salvage to the City

Adjust MH top
See sheet no. W28

X = Denotes Pipe to be removed. (See Paving and Storm Sewer Plans also.)

Save 02-27-2007 10:21:14 AM by CSI
Plot Scale 1:40 02-27-2007 10:56:10 AM by BEJ
J:\SENTOUT\2006\06237\2007-02-28 Final to DOW\DWG\W28-MiscAdjustments-Plans

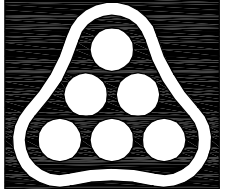

No.	Revision	By	Date
	SOUTHEAST 48" WATERLINE - PHASE 1B		
MISCELLANEOUS ADJUSTMENT PLANS WATERMAN ST. STA 100+00 TO STA 121+00			
JAMES L. ARMOUR, P.E. - CITY ENGINEER CITY OF WICHITA PROJECT NO. 448-90182			
Professional Engineering Consultants, P.A. 303 S. TOPEKA • WICHITA, KANSAS 67202 316-262-2691 • FAX 316-262-3003			
Designed by	MDK	Job No.	35-05787-001-42
Drawn by	CSL	Date	March 2006
			Sht. W26 of 31