

STATE	PROJECT NO.	YEAR	SHEET NO.	TOTAL SHEETS
KANSAS	87 N-0353-01	2005	1	162
STP-N035(301)				

**STATE OF KANSAS  
DEPARTMENT OF TRANSPORTATION**

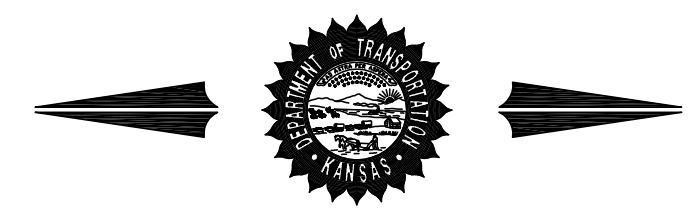

**PLAN AND PROFILE OF PROPOSED  
PAWNEE AVENUE  
119TH TO MAIZE**

**FEDERAL AID PROJECT  
SEDGWICK COUNTY**

**CITY OF WICHITA  
POPULATION 354,617**

**CITY OF WICHITA PROJECT NO. 472 84357**

**OCA NO. 706951**

**PROJECT NO. 87 N-0353-01  
F.A. NO. STP-N035(301)**

*GRADING  
SURFACING  
TRAFFIC SIGNALIZATION  
SIGNING AND PAVEMENT MARKINGS*

INDEX OF SHEETS

- 1 TITLE SHEET
- 2-3 TYPICAL SECTIONS & GENERAL NOTES
- 4-24 PLAN SHEETS
- 25-33 INTERSECTION DETAILS
- 34-36 PAVEMENT DETAILS
- 37 MISCELLANEOUS DETAILS
- 38-52 INLET & MANHOLE DETAILS
- 53-65 STORM SEWER PLAN & PROFILE
- 66 SCHEDULE OF INLETS AND MANHOLES
- 67-68 CONCRETE END SECTIONS
- 69 DRAINAGE CALCULATIONS
- 70-71 CULVERT DETAILS
- 72-80 RCB DETAILS
- 81 SUMMARY OF QUANTITIES
- 82-87 EROSION CONTROL
- 88-89 TRAFFIC SIGNALS
- 90-98 PAVEMENT MARKING & SIGNING
- 99 CONSTRUCTION SEQUENCE
- 100-117 TRAFFIC CONTROL
- 118 DRAINAGE MAP
- 119-158 CROSS SECTIONS
- 159-162 WATERLINE PLANS
- LS1-LS14 LANDSCAPING PLANS

DATE	
BY	
SURVEY	
CADD TECHNICIAN	
DESIGNERS	
SQUAD	

**STA. 10+71.44, BEGIN PROJECT**  
PROJ. 87 N-0353-01

**STA. 5+63.26, BEGIN CONSTRUCTION**  
PROJ. 87 N-0353-01

**STA. 54+55.22, END CONSTRUCTION**  
PROJ. 87 N-0353-01

**STA. 54+27.97, END CONSTRUCTION**  
PROJ. 87 N-0353-01

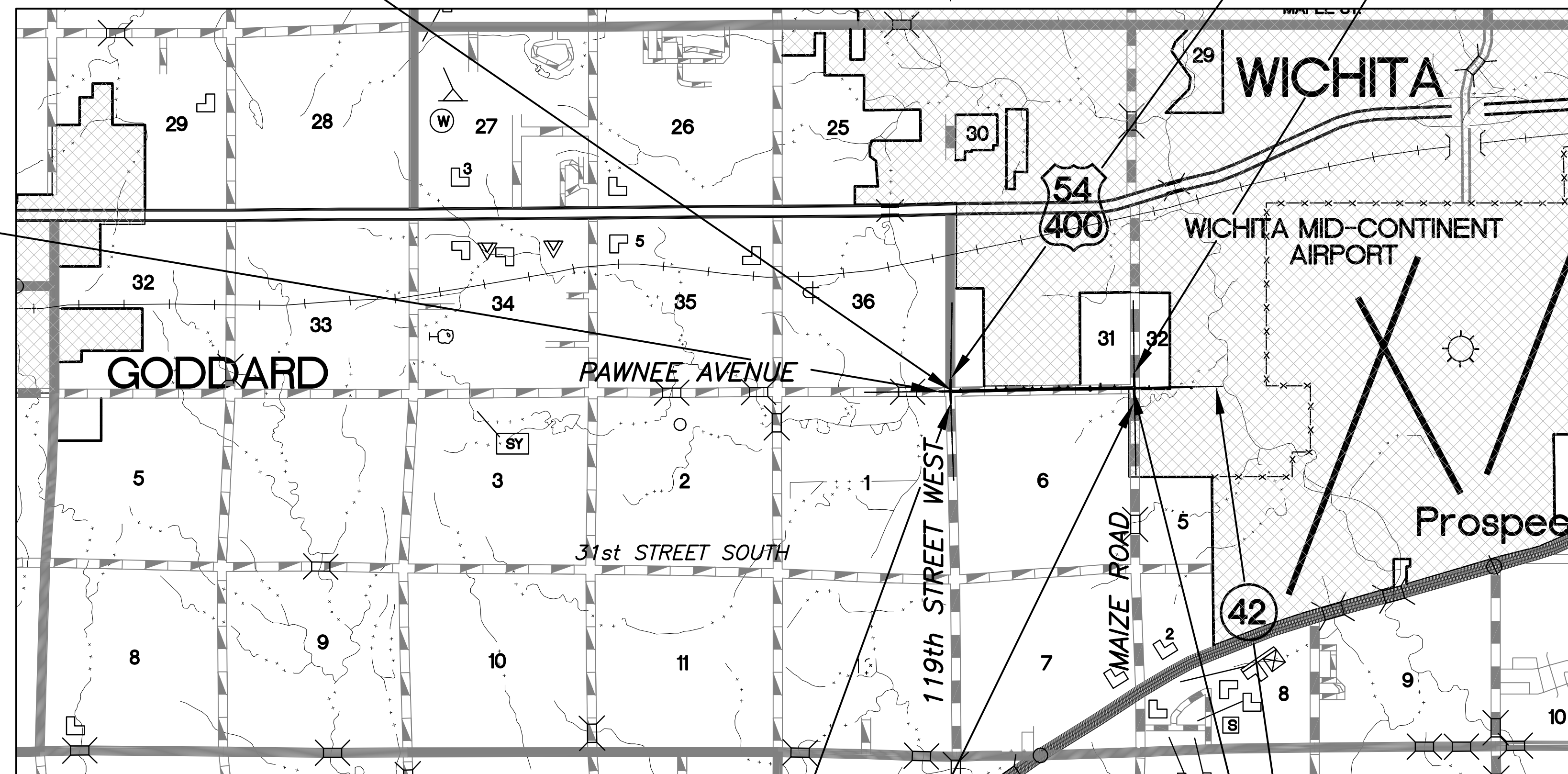

**PAWNEE AVENUE  
DESIGN DESIGNATION**

AADT (2006)	600
AADT (2030)	5,000
DHV	11%
V	40 mph
C of A	Partial
Clear Zone	6 ft.

Scale: 1" = 2500'

NOTE:  
Local traffic to be carried  
through construction.

REVISED:  
FEBRUARY 14, 2007

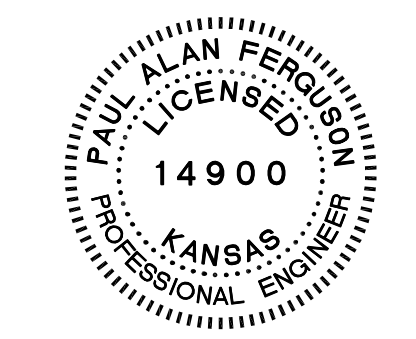

**POE and ASSOCIATES, INC.**  
CONSULTING ENGINEERS  
5940 E. Central, Suite 200 ■ Wichita, KS 67208-4242  
Phone 316/685-4114 ■ FAX 316/685-4444

CONVENTIONAL SIGNS

COUNTY LINE	.....	CENTER LINE OF PROJECT	.....
CITY LIMITS	.....	TERRACE	.....
STATE OR NATIONAL LINE	.....	CULVERTS	.....
TOWNSHIP, SECTION or GRANT LINE	.....	DROP INLET & STORM SEWER	.....
PROPERTY LINE	.....	ACCESS CONTROL	.....
HIGHWAY FENCE	.....	POWER POLE	.....
EXISTING FENCE	.....	TELEPHONE POLE	.....
GUARD FENCE	.....	MARSH	.....
CONSTRUCTION LIMITS	.....	HEDGE	.....
RIGHT OF WAY LINE	.....	TREES	.....
TRAVELED WAY	.....	PROFILE ELEVATION	.....
RAILROADS	.....	STREAM or CREEK	.....

GROSS LENGTH OF PROJECT 5,349.26 ft.  
EXCEPTIONS - ft.

NET LENGTH OF PROJECT 5,349.26 ft.  
NET LENGTH OF BRIDGES - ft.  
NET LENGTH OF ROAD 5,349.26 ft.

**STA. 89+55.64, END CONSTRUCTION**  
PROJ. 87 N-0353-01

**STA. 64+20.70, END PROJECT**  
PROJ. 87 N-0353-01

**STA. 45+72.32, BEGIN CONSTRUCTION**  
PROJ. 87 N-0353-01

**STA. 45+46.06, BEGIN CONSTRUCTION**  
PROJ. 87 N-0353-01

APPROVED - DATE  
  
JAMES L. ARMOUR, P.E.  
CITY ENGINEER  
CITY OF WICHITA PROJECT NO. 472 84357

RECOM. FOR APPROVAL-DATE  
  
CHIEF, BUREAU OF LOCAL PROJECTS  
KANSAS DEPARTMENT OF TRANSPORTATION  
  
APPROVED - DATE  
  
STATE TRANSPORTATION ENGINEER  
KANSAS DEPARTMENT OF TRANSPORTATION