

FHWA REGION NO.	STATE	PROJECT NO.	FISCAL YEAR	SHEET NO.	TOTAL SHEETS
7	KANSAS	87 N-0394-01	2010	1	129

### Index

1	Title Sheet	GRADING
2	Keysheet	SURFACING
3	General Notepage	STORM SEWER
4-7	Typical Sections	SEEDNG
8-9	Paving Details	TRAFFIC SIGNALS
10	Standard Drive Details	
11-21	47th Street South Paving Plans	
22-23	Meridian Avenue Paving Plans	
24	47th Street & Meridian Intersection Joint Plan	
25	47th Street & Meridian Intersection Grading Plan	
26-27	Valley Gutter Details	
28-46	Storm Water Sewer Plan/Profiles	
47-57	Storm Water Sewer Details	
58	Drainage Channel Details & Typical Section	
59-61	Drainage Channel Plan/Profiles	
62-69	Water Line Plan/Profiles	
70	Water Valve & Water Meter Adjustment Details	
71	Standard Water Assembly Details	
72	47th Street & Meridian Signalization Plan	
73	47th Street & Meridian Wiring Plan	
74-75	Traffic Signalization Details	
76-79	Marking & Signing Plan	
80	Marking & Signing Details	
81	47th Street South Detour Plan	
82-88	Construction Sequencing Traffic Control Plan	
89-92	Traffic Control Details	
93-94	Recapitulation of Quantities	
95	47th Street South Seeding/Sodding Plan	
96-109	Landscaping Plans	
110	Erosion Control Plan	
111-114	Erosion Control Details	
115	Drainage Plan	
116-125	47th Street South Cross Sections	
126-128	Meridian Avenue Cross Sections	
129	Earthwork Quantities	

STATE OF KANSAS  
DEPARTMENT OF TRANSPORTATION

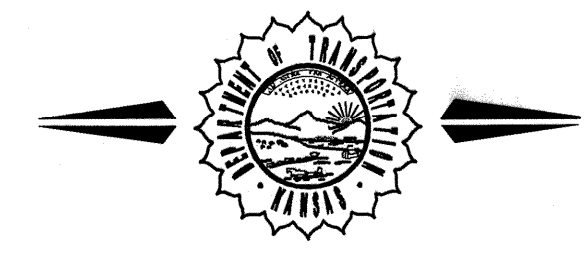

CONSTRUCTION PLANS FOR PROPOSED  
**47th STREET SOUTH**  
FROM MERIDIAN AVENUE to SENECA STREET

FEDERAL AID URBAN SYSTEM PROJECT

FOR  
THE CITY OF WICHITA,  
SEDGWICK COUNTY, KANSAS

James L. Armour, P.E., City Engineer

Paving Project  
City Project No. 472-84296  
O.C.A. No. 706935

12" Water Line  
City Project No. 448-90492  
O.C.A. No. 636239

AUGUST 2010

VICINITY MAP

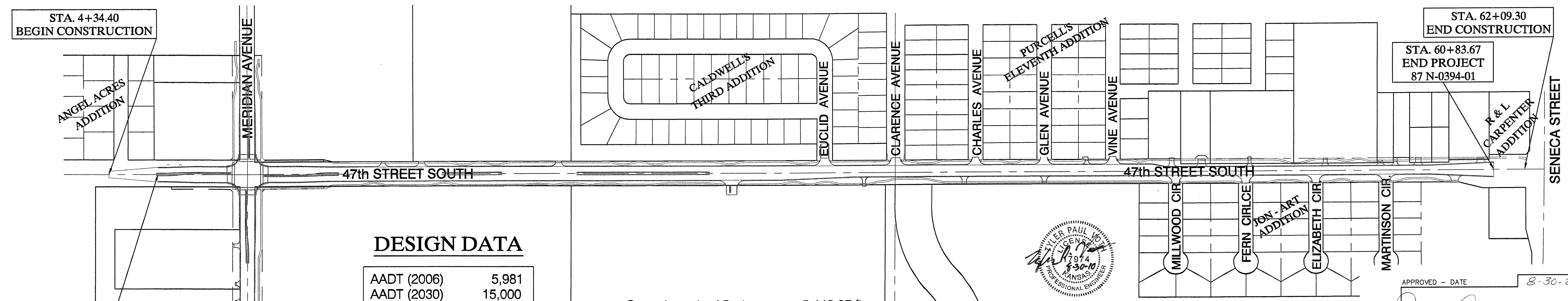
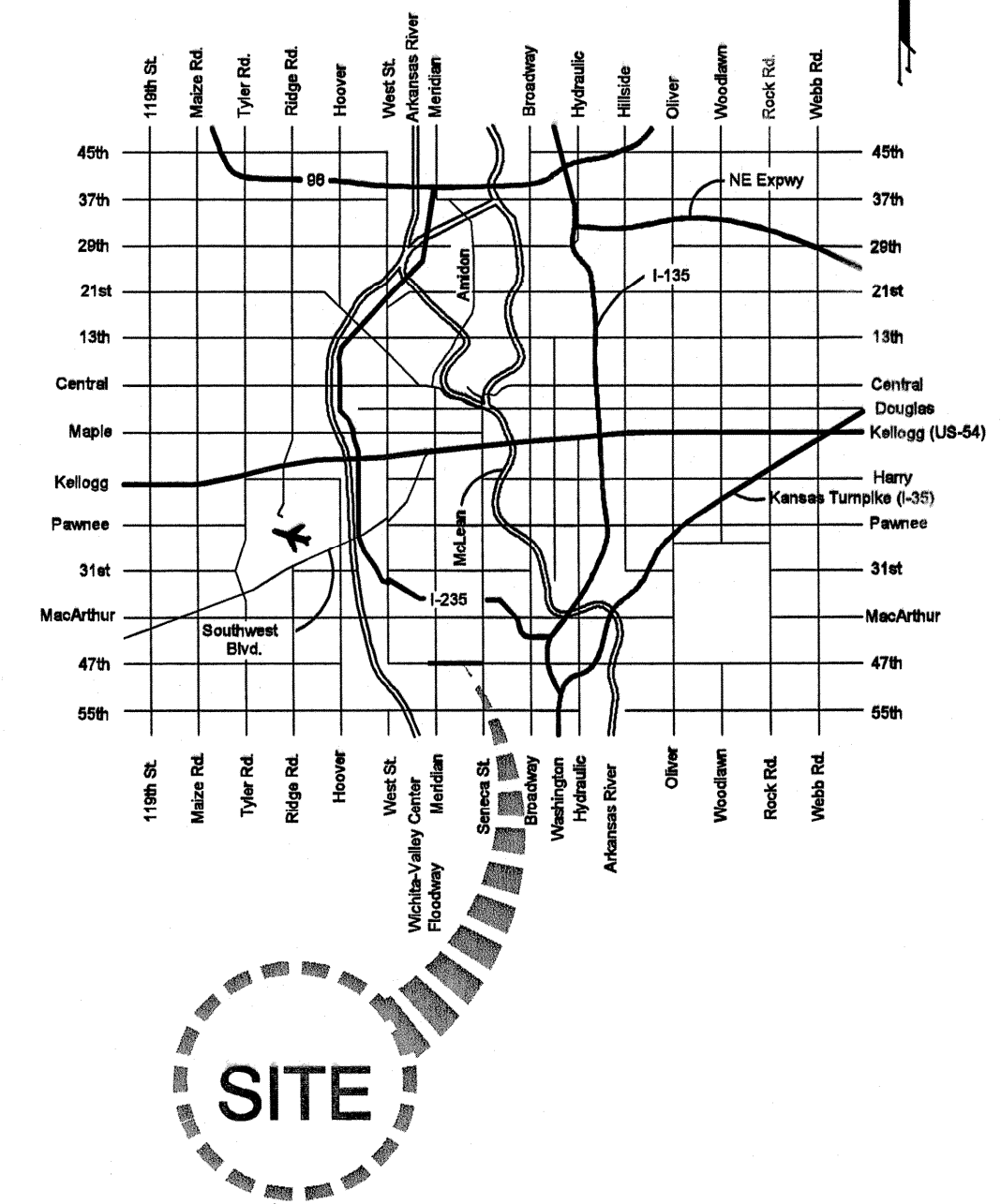

**DESIGN DATA**

AADT (2006)	5,981
AADT (2030)	15,000
DHV	10%
T	3%
V	40 mph
C of A	N/A
Clear Zone	6'

Gross Length of Project	5,449.27 ft.
Exceptions	0.00 ft.
Additions	0.00 ft.
Net Length of Project	5,449.27 ft.
Net Length of Bridges	0.00 ft.
Net Length of Road	5,449.27 ft.



APPROVED - DATE 8-30-2010

*Jim Armour*  
JIM ARMOUR, P.E., CITY ENGINEER  
CITY OF WICHITA, KANSAS

Drawing File: E:\eng\47th South\Title.dwg August 2010  
  
**Baughman Company, P.A.**  
 315 Ellis St. Wichita, KS 67211 P 316-262-7271 F 316-262-0149  
 ENGINEERING | SURVEYING | PLANNING | LANDSCAPE ARCHITECTURE

THE PIPES ON THIS PROJECT ARE IN ACCORDANCE WITH THE CURRENT KDOT PIPE POLICY OR LOCAL PIPE POLICY THAT HAS BEEN APPROVED BY KDOT. ALL PIPES SHALL BE INSTALLED PER MANUFACTURER'S SPECIFICATIONS.

SCALE: 1" = 200'