

STATE	PROJECT NO.	YEAR	SHEET NO.	TOTAL SHEETS
KANSAS	87 N-0361-01	2011	78	169

**MKEC**  
ENGINEERING  
CONSULTANTS, INC.  
411 N. WEBB ROAD  
WICHITA, K.S. 67206  
316-684-9600

Point	Dam Sta./Offset	Northing	Easting	Elevation
1	Sta. 52+26.02/154.10' Lt.	1680504.32	1647393.58	1296.50
2	Sta. 48+15.09/68.04' Lt.	1680493.84	1646973.85	1294.75
3	Sta. 48+66.81/21.51' Rt.	1680396.42	1647008.57	1282.60
4	Sta. 48+59.42/763.75' Lt.	1681170.12	1647143.01	1286.12
13	Sta. 62+32.80/388.68' Lt.	1680553.35	1648426.15	1296.84
40	Sta. 52+12.60/332.22' Rt.	1680028.40	1647292.61	1296.32
100	Sta. 52+45.61/206.42' Lt.	1680552.24	1647422.28	1296.77
107	Sta. 55+00.75/276.60' Lt.	1680575.23	1647685.90	1293.25
108	Sta. 55+12.47/217.41' Lt.	1680514.90	1647686.75	1293.43

Project Vertical Datum is NAVD88.

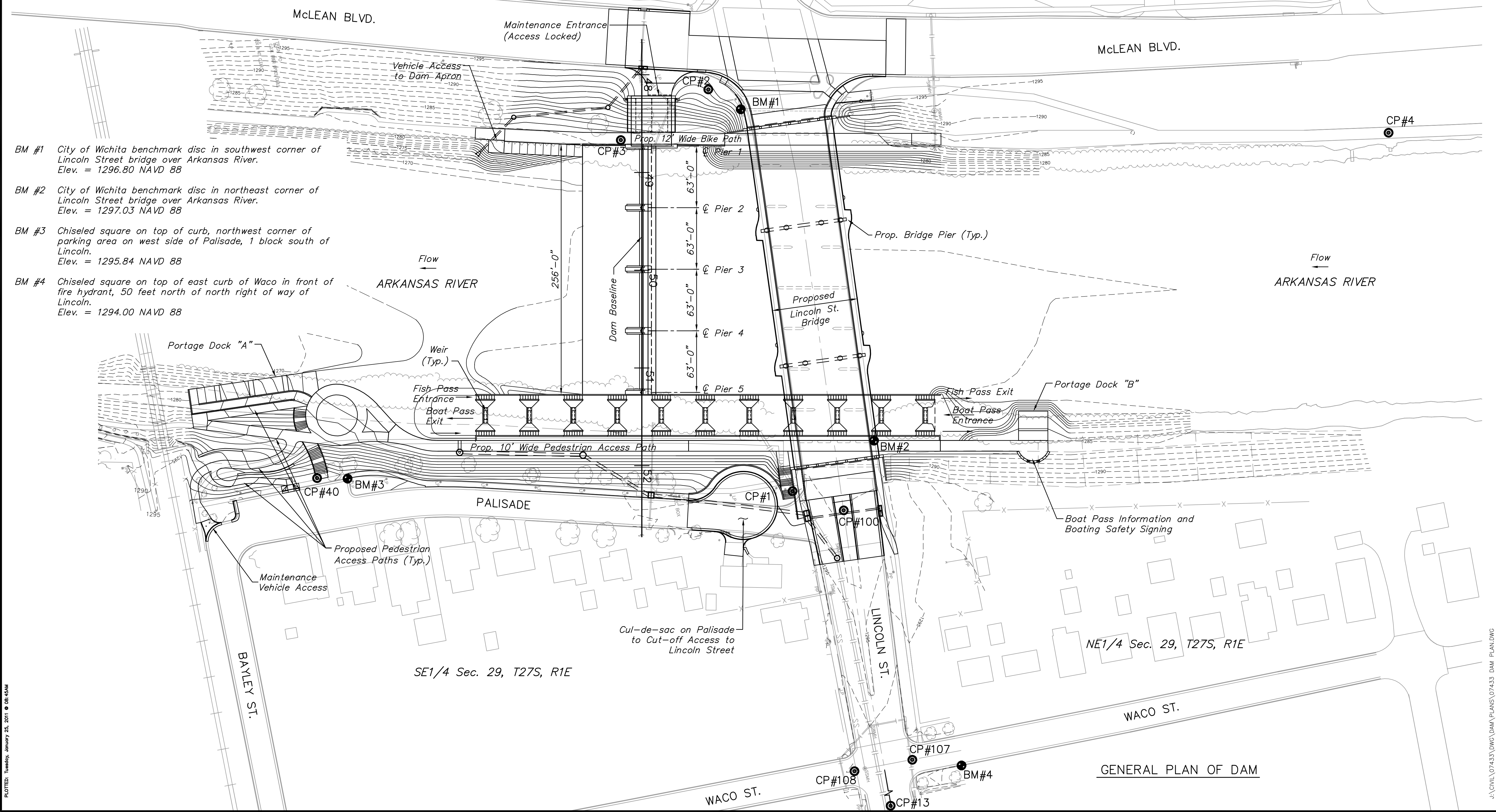
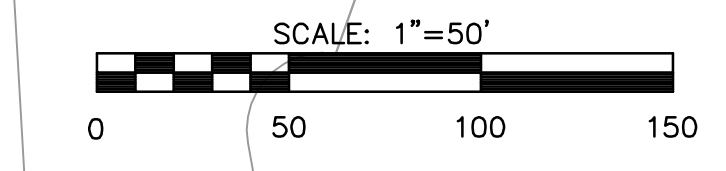

PLOTED: Tuesday, January 25, 2011 8:45 AM

**LINCOLN STREET BRIDGE AND  
DAM IMPROVEMENTS OVER  
ARKANSAS RIVER**

**GENERAL  
PLAN  
OF DAM**  
SHEET TITLE  
472-84883  
PROJECT NUMBER

DESIGN BY: JAG  
DRAWN BY: DPG  
CHECKED BY: JRA

ISSUED: 1/24/2011  
REVISED:

SHEET NO.  
**78 of 169**

J:\CIVIL\07433\DWG\PLANS\07433 DAM PLAN.DWG