

STATE	PROJECT NO.	YEAR	SHEET NO.	TOTAL SHEETS
KANSAS	472 84614	-	106	534

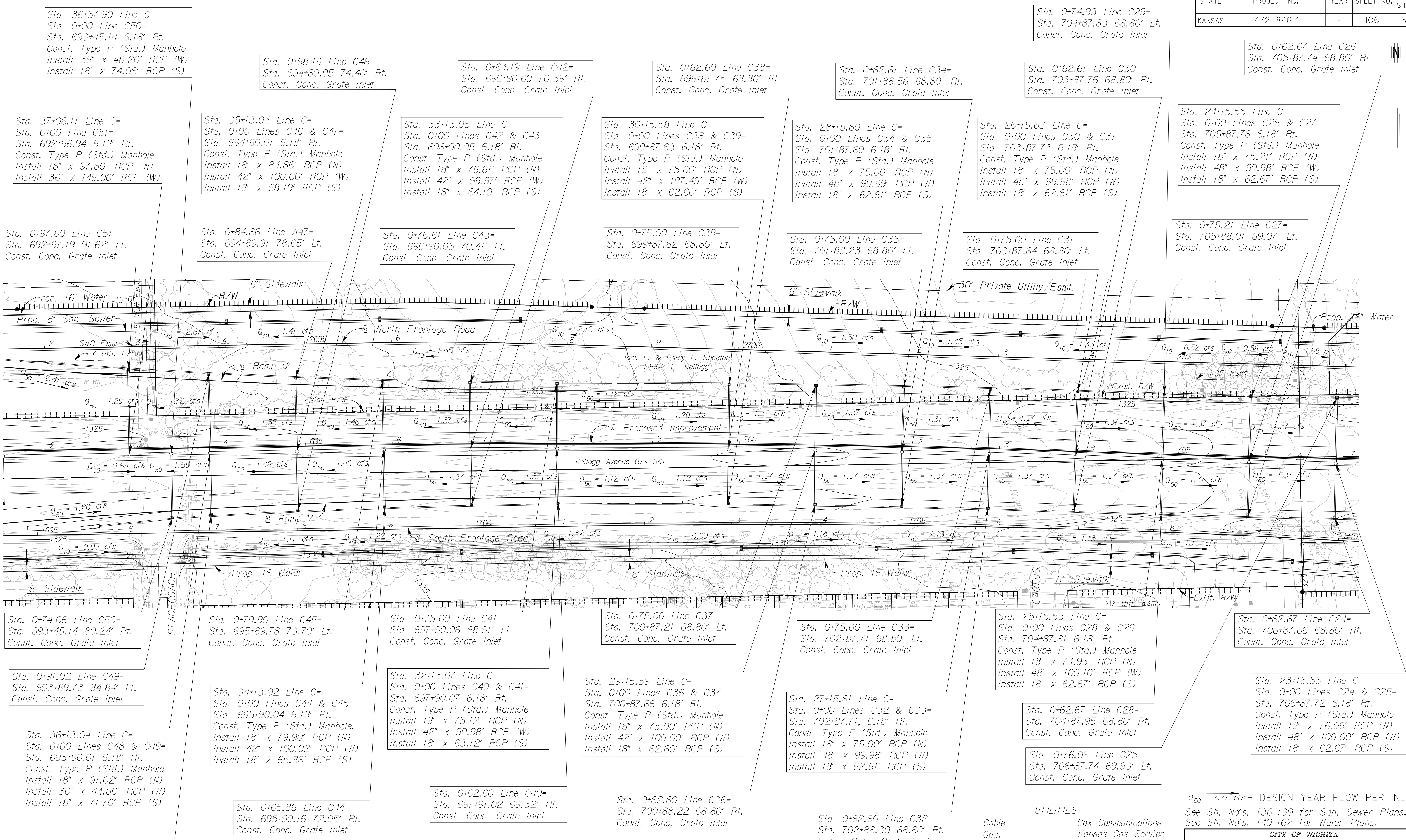

Sta. 36+57.90 Line C=  
Sta. 0+00 Line C50=  
Sta. 693+45.14 6.18' Rt.  
Const. Type P (Std.) Manhole  
Install 36" x 48.20' RCP (W)  
Install 18" x 74.06' RCP (S)

Sta. 0+68.19 Line C46=  
Sta. 694+89.95 74.40' Rt.  
Const. Conc. Grate Inlet

Sta. 0+64.19 Line C42=  
Sta. 696+90.60 70.39' Rt.  
Const. Conc. Grate Inlet

Sta. 0+62.60 Line C38=  
Sta. 699+87.75 68.80' Rt.  
Const. Conc. Grate Inlet

Sta. 0+62.61 Line C34=  
Sta. 701+88.56 68.80' Rt.  
Const. Conc. Grate Inlet

Sta. 0+74.93 Line C29=  
Sta. 704+87.83 68.80' Lt.  
Const. Conc. Grate Inlet

Sta. 0+62.61 Line C30=  
Sta. 703+87.76 68.80' Rt.  
Const. Conc. Grate Inlet

Sta. 0+62.67 Line C26=  
Sta. 705+87.74 68.80' Rt.  
Const. Conc. Grate Inlet

Sta. 37+06.11 Line C=  
Sta. 0+00 Line C51=  
Sta. 692+96.94 6.18' Rt.  
Const. Type P (Std.) Manhole  
Install 18" x 97.80' RCP (N)  
Install 36" x 146.00' RCP (W)

Sta. 35+13.04 Line C=  
Sta. 0+00 Lines C46 & C47=  
Sta. 694+90.01 6.18' Rt.  
Const. Type P (Std.) Manhole  
Install 18" x 84.86' RCP (N)  
Install 42" x 100.00' RCP (W)  
Install 18" x 68.19' RCP (S)

Sta. 33+13.05 Line C=  
Sta. 0+00 Lines C42 & C43=  
Sta. 696+90.05 6.18' Rt.  
Const. Type P (Std.) Manhole  
Install 18" x 76.61' RCP (N)  
Install 42" x 99.97' RCP (W)  
Install 18" x 64.19' RCP (S)

Sta. 30+15.58 Line C=  
Sta. 0+00 Lines C38 & C39=  
Sta. 699+87.63 6.18' Rt.  
Const. Type P (Std.) Manhole  
Install 18" x 75.00' RCP (N)  
Install 42" x 197.49' RCP (W)  
Install 18" x 62.60' RCP (S)

Sta. 28+15.60 Line C=  
Sta. 0+00 Lines C34 & C35=  
Sta. 701+87.69 6.18' Rt.  
Const. Type P (Std.) Manhole  
Install 18" x 75.00' RCP (N)  
Install 48" x 99.98' RCP (W)  
Install 18" x 62.61' RCP (S)

Sta. 26+15.63 Line C=  
Sta. 0+00 Lines C30 & C31=  
Sta. 703+87.73 6.18' Rt.  
Const. Type P (Std.) Manhole  
Install 18" x 75.00' RCP (N)  
Install 48" x 99.98' RCP (W)  
Install 18" x 62.61' RCP (S)

Sta. 24+15.55 Line C=  
Sta. 0+00 Lines C26 & C27=  
Sta. 705+87.76 6.18' Rt.  
Const. Type P (Std.) Manhole  
Install 18" x 75.21' RCP (N)  
Install 48" x 99.98' RCP (W)  
Install 18" x 62.67' RCP (S)

Sta. 0+97.80 Line C51=  
Sta. 692+97.19 91.62' Lt.  
Const. Conc. Grate Inlet

Sta. 0+84.86 Line A47=  
Sta. 694+89.91 78.65' Lt.  
Const. Conc. Grate Inlet

Sta. 0+76.61 Line C43=  
Sta. 696+90.05 70.41' Lt.  
Const. Conc. Grate Inlet

Sta. 0+75.00 Line C39=  
Sta. 699+87.62 68.80' Lt.  
Const. Conc. Grate Inlet

Sta. 0+75.00 Line C35=  
Sta. 701+88.23 68.80' Lt.  
Const. Conc. Grate Inlet

Sta. 0+75.00 Line C31=  
Sta. 703+87.64 68.80' Lt.  
Const. Conc. Grate Inlet

Sta. 0+75.21 Line C27=  
Sta. 705+88.01 69.07' Lt.  
Const. Conc. Grate Inlet

Sta. 0+74.06 Line C50=  
Sta. 693+45.14 80.24' Rt.  
Const. Conc. Grate Inlet

Sta. 0+79.90 Line C45=  
Sta. 695+89.78 73.70' Lt.  
Const. Conc. Grate Inlet

Sta. 0+75.00 Line C41=  
Sta. 697+90.06 68.91' Lt.  
Const. Conc. Grate Inlet

Sta. 0+75.00 Line C37=  
Sta. 700+87.21 68.80' Lt.  
Const. Conc. Grate Inlet

Sta. 0+75.00 Line C33=  
Sta. 702+87.71 68.80' Lt.  
Const. Conc. Grate Inlet

Sta. 25+15.53 Line C=  
Sta. 0+00 Lines C28 & C29=  
Sta. 704+87.81 6.18' Rt.  
Const. Type P (Std.) Manhole  
Install 18" x 74.93' RCP (N)  
Install 48" x 100.10' RCP (W)  
Install 18" x 62.67' RCP (S)

Sta. 0+62.67 Line C24=  
Sta. 706+87.66 68.80' Rt.  
Const. Conc. Grate Inlet

Sta. 0+91.02 Line C49=  
Sta. 693+89.73 84.84' Lt.  
Const. Conc. Grate Inlet

Sta. 34+13.02 Line C=  
Sta. 0+00 Lines C44 & C45=  
Sta. 695+90.04 6.18' Rt.  
Const. Type P (Std.) Manhole,  
Install 18" x 79.90' RCP (N)  
Install 42" x 100.02' RCP (W)  
Install 18" x 65.86' RCP (S)

Sta. 32+13.07 Line C=  
Sta. 0+00 Lines C40 & C41=  
Sta. 697+90.07 6.18' Rt.  
Const. Type P (Std.) Manhole  
Install 18" x 75.12' RCP (N)  
Install 42" x 99.98' RCP (W)  
Install 18" x 63.12' RCP (S)

Sta. 29+15.59 Line C=  
Sta. 0+00 Lines C36 & C37=  
Sta. 700+87.66 6.18' Rt.  
Const. Type P (Std.) Manhole  
Install 18" x 75.00' RCP (N)  
Install 42" x 100.00' RCP (W)  
Install 18" x 62.60' RCP (S)

Sta. 27+15.61 Line C=  
Sta. 0+00 Lines C32 & C33=  
Sta. 702+87.71, 6.18' Rt.  
Const. Type P (Std.) Manhole  
Install 18" x 75.00' RCP (N)  
Install 48" x 99.98' RCP (W)  
Install 18" x 62.61' RCP (S)

Sta. 0+62.67 Line C28=  
Sta. 704+87.95 68.80' Rt.  
Const. Conc. Grate Inlet

Sta. 23+15.55 Line C=  
Sta. 0+00 Lines C24 & C25=  
Sta. 706+87.72 6.18' Rt.  
Const. Type P (Std.) Manhole  
Install 18" x 76.06' RCP (N)  
Install 48" x 100.00' RCP (W)  
Install 18" x 62.67' RCP (S)

Sta. 36+13.04 Line C=  
Sta. 0+00 Lines C48 & C49=  
Sta. 693+90.01 6.18' Rt.  
Const. Type P (Std.) Manhole  
Install 18" x 91.02' RCP (N)  
Install 36" x 44.86' RCP (W)  
Install 18" x 71.70' RCP (S)

Sta. 0+65.86 Line C44=  
Sta. 695+90.16 72.05' Rt.  
Const. Conc. Grate Inlet

Sta. 0+62.60 Line C40=  
Sta. 697+91.02 69.32' Rt.  
Const. Conc. Grate Inlet

Sta. 0+62.60 Line C36=  
Sta. 700+88.22 68.80' Rt.  
Const. Conc. Grate Inlet

Sta. 0+62.60 Line C32=  
Sta. 702+88.30 68.80' Rt.  
Const. Conc. Grate Inlet

Sta. 0+76.06 Line C25=  
Sta. 706+87.74 69.93' Lt.  
Const. Conc. Grate Inlet

UTILITIES

Cable	Cox Communications
Gas	Kansas Gas Service
Power	Westar
Sanitary Sewer	Wichita Water & Sewer
Storm Water Sewer	Wichita Water & Sewer
Telephone	AT&T
Water	Wichita Water & Sewer

Q<sub>50</sub> = x.xx cfs - DESIGN YEAR FLOW PER INLET  
See Sh. No's. 136-139 for San. Sewer Plans.  
See Sh. No's. 140-162 for Water Plans.

CITY OF WICHITA  
EAST KELLOGG  
STORM WATER SEWER PLAN  
STA. 692+00 TO STA. 707+00

8:25 AM  
 2/22/2011  
 J:\CIVIL\07432\DWG\SWS\EK2ML\PLAN\EK2ML\_SWPLO6.DWG  
 SURV. - PLOT CADD DES. - DR. - APP. - CKD. - TR.