

STATE	PROJECT NO.	YEAR	SHEET NO.	TOTAL SHEETS
KANSAS	472 84614	.	107	534

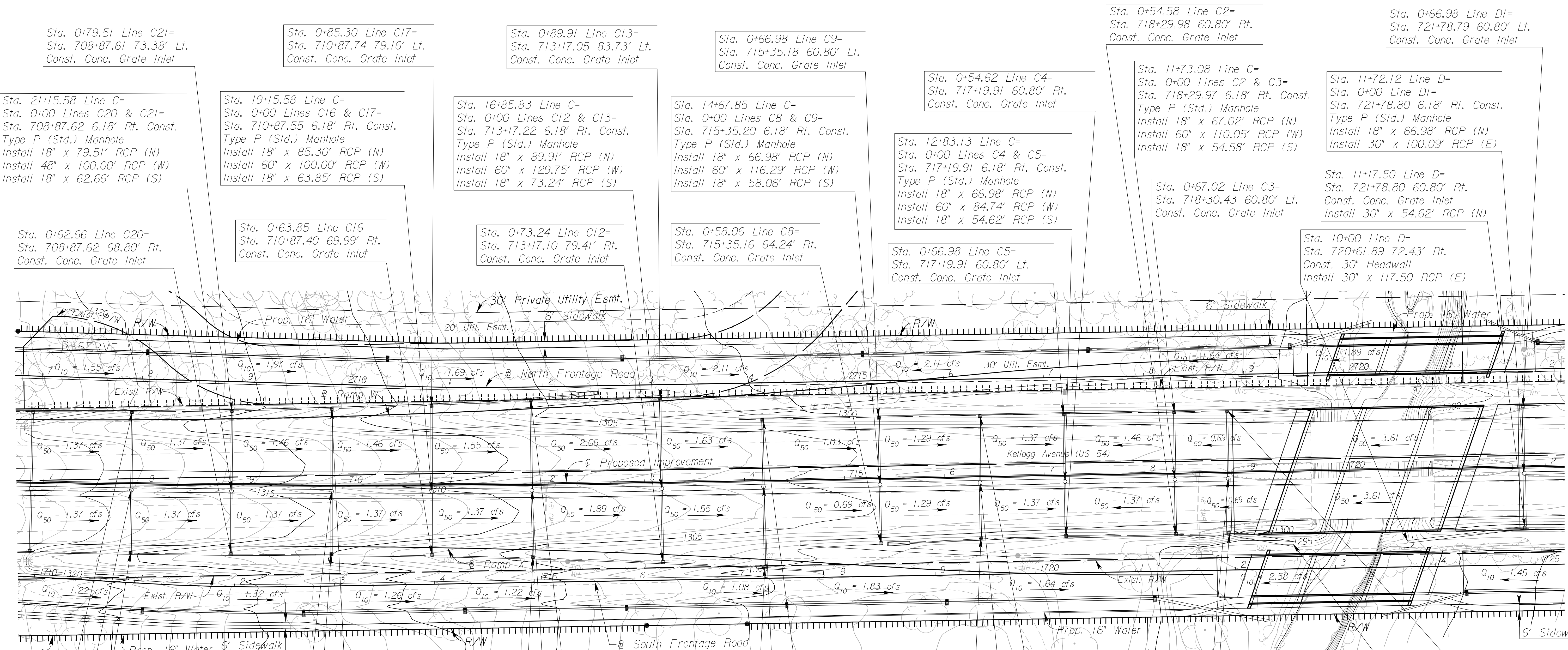

Sta. 0+79.51 Line C21=
Sta. 708+87.61 73.38' Lt.
Const. Conc. Grate Inlet

Sta. 0+85.30 Line C17=
Sta. 710+87.74 79.16' Lt.
Const. Conc. Grate Inlet

Sta. 0+89.91 Line C13=
Sta. 713+17.05 83.73' Lt.
Const. Conc. Grate Inlet

Sta. 0+66.98 Line C9=
Sta. 715+35.18 60.80' Lt.
Const. Conc. Grate Inlet

Sta. 0+54.58 Line C2=
Sta. 718+29.98 60.80' Rt.
Const. Conc. Grate Inlet

Sta. 0+66.98 Line D1=
Sta. 721+78.79 60.80' Lt.
Const. Conc. Grate Inlet

Sta. 21+15.58 Line C=
Sta. 0+00 Lines C20 & C21=
Sta. 708+87.62 6.18' Rt. Const.
Type P (Std.) Manhole
Install 18" x 79.51' RCP (N)
Install 48" x 100.00' RCP (W)
Install 18" x 62.66' RCP (S)

Sta. 19+15.58 Line C=
Sta. 0+00 Lines C16 & C17=
Sta. 710+87.55 6.18' Rt. Const.
Type P (Std.) Manhole
Install 18" x 85.30' RCP (N)
Install 60" x 100.00' RCP (W)
Install 18" x 63.85' RCP (S)

Sta. 16+85.83 Line C=
Sta. 0+00 Lines C12 & C13=
Sta. 713+17.22 6.18' Rt. Const.
Type P (Std.) Manhole
Install 18" x 89.91' RCP (N)
Install 60" x 129.75' RCP (W)
Install 18" x 73.24' RCP (S)

Sta. 14+67.85 Line C=
Sta. 0+00 Lines C8 & C9=
Sta. 715+35.20 6.18' Rt. Const.
Type P (Std.) Manhole
Install 18" x 66.98' RCP (N)
Install 60" x 116.29' RCP (W)
Install 18" x 58.06' RCP (S)

Sta. 0+54.62 Line C4=
Sta. 717+19.91 60.80' Rt.
Const. Conc. Grate Inlet

Sta. 12+83.13 Line C=
Sta. 0+00 Lines C4 & C5=
Sta. 717+19.91 6.18' Rt. Const.
Type P (Std.) Manhole
Install 18" x 66.98' RCP (N)
Install 60" x 84.74' RCP (W)
Install 18" x 54.62' RCP (S)

Sta. 11+73.08 Line C=
Sta. 0+00 Lines C2 & C3=
Sta. 718+29.97 6.18' Rt. Const.
Type P (Std.) Manhole
Install 18" x 67.02' RCP (N)
Install 60" x 110.05' RCP (W)
Install 18" x 54.58' RCP (S)

Sta. 11+72.12 Line D=
Sta. 0+00 Line D1=
Sta. 721+78.80 6.18' Rt. Const.
Type P (Std.) Manhole
Install 18" x 66.98' RCP (N)
Install 30" x 100.09' RCP (E)

Sta. 0+62.66 Line C20=
Sta. 708+87.62 68.80' Rt.
Const. Conc. Grate Inlet

Sta. 0+63.85 Line C16=
Sta. 710+87.40 69.99' Rt.
Const. Conc. Grate Inlet

Sta. 0+73.24 Line C12=
Sta. 713+17.10 79.41' Rt.
Const. Conc. Grate Inlet

Sta. 0+58.06 Line C8=
Sta. 715+35.16 64.24' Rt.
Const. Conc. Grate Inlet

Sta. 0+66.98 Line C5=
Sta. 717+19.91 60.80' Lt.
Const. Conc. Grate Inlet

Sta. 0+67.02 Line C3=
Sta. 718+30.43 60.80' Lt.
Const. Conc. Grate Inlet

Sta. 11+17.50 Line D=
Sta. 721+78.80 60.80' Rt.
Const. Conc. Grate Inlet
Install 30" x 54.62' RCP (N)

Sta. 10+00 Line D=
Sta. 720+61.89 72.43' Rt.
Const. 30" Headwall
Install 30" x 117.50 RCP (E)

Sta. 0+62.66 Line C22=
Sta. 707+87.65 68.80' Rt.
Const. Conc. Grate Inlet

Sta. 0+82.11 Line C19=
Sta. 709+87.53 75.97' Lt.
Const. Conc. Grate Inlet

Sta. 0+90.41 Line C15=
Sta. 711+87.31 84.26' Lt.
Const. Conc. Grate Inlet

Sta. 0+66.98 Line C11=
Sta. 714+18.89 60.80' Lt.
Const. Conc. Grate Inlet

Sta. 0+67.03 Line C7=
Sta. 716+36.00 60.80' Lt.
Const. Conc. Grate Inlet

Sta. 10+65.23 Line C=
Sta. 718+83.19 60.80' Rt.
Const. Conc. Grate Inlet
Install 60" x 54.62' RCP (N)

Sta. 0+66.98 Line C1=
Sta. 718+83.19 60.80' Lt.
Const. Conc. Grate Inlet

Sta. 22+15.58 Line C=
Sta. 0+00 Lines C22 & C23=
Sta. 707+87.66 6.18' Rt. Const.
Type P (Std.) Manhole
Install 18" x 77.50' RCP (N)
Install 48" x 99.97' RCP (W)
Install 18" x 62.66' RCP (S)

Sta. 0+62.68 Line C18=
Sta. 709+87.58 68.80' Rt.
Const. Conc. Grate Inlet

Sta. 18+15.59 Line C=
Sta. 0+00 Lines C14 & C15=
Sta. 711+87.51 6.18' Rt. Const.
Type P (Std.) Manhole
Install 18" x 90.41' RCP (N)
Install 60" x 99.99' RCP (W)
Install 18" x 66.82' RCP (S)

Sta. 15+84.14 Line C=
Sta. 0+00 Lines C10 & C11=
Sta. 714+18.91 6.18' Rt. Const.
Type P (Std.) Manhole
Install 18" x 66.98' RCP (N)
Install 60" x 101.70' RCP (W)
Install 18" x 80.02' RCP (S)

Sta. 13+67.86 Line C=
Sta. 0+00 Lines C6 & C7=
Sta. 716+35.19 6.18' Rt. Const.
Type P (Std.) Manhole
Install 18" x 67.03' RCP (N)
Install 60" x 99.99' RCP (W)
Install 18" x 55.42' RCP (S)

Sta. 11+19.86 Line C=
Sta. 0+00 Line C1=
Sta. 718+83.20 6.18' Rt. Const.
Type P (Std.) Manhole
Install 18" x 66.98' RCP (N)
Install 60" x 53.22' RCP (W)

Sta. 10+00 Line C=
Sta. 719+47.43 72.65' Rt.
Const. 60" Headwall
Install 60" x 65.24 RCP (W)

Sta. 0+77.50 Line C23=
Sta. 707+87.61 71.36' Lt.
Const. Conc. Grate Inlet

Sta. 20+15.58 Line C=
Sta. 0+00 Lines C18 & C19=
Sta. 709+87.59 6.18' Rt. Const.
Type P (Std.) Manhole
Install 18" x 82.11' RCP (N)
Install 48" x 100.00' RCP (W)
Install 18" x 62.68' RCP (S)

Sta. 0+66.82 Line C14=
Sta. 711+88.04 72.96' Rt.
Const. Conc. Grate Inlet

Sta. 0+80.02 Line C10=
Sta. 714+18.78 86.20' Rt.
Const. Conc. Grate Inlet

Sta. 0+55.42 Line C6=
Sta. 716+35.09 61.64' Rt.
Const. Conc. Grate Inlet

$Q_{50} = x.xx$ cfs - DESIGN YEAR FLOW PER INLET
See Sh. No's. 136-139 for San. Sewer Plans.
See Sh. No's. 140-162 for Water Plans.

UTILITIES

- | | |
|-------------------|-----------------------|
| Cable | Cox Communications |
| Power | Westar |
| Sanitary Sewer | Wichita Water & Sewer |
| Storm Water Sewer | Wichita Water & Sewer |
| Telephone | AT&T |
| Water | Wichita Water & Sewer |

CITY OF WICHITA
EAST KELLOGG
STORM WATER SEWER PLAN
STA. 707+00 TO STA. 722+00

2:41 PM
 2/18/2011
 J:\CIVIL\07432\DWG\SWS\EK2\ML_PLAN\EK2\ML_SWPLOT.DWG
 SURV. - PLOT CADD DES. - DR. - TR. - CKD. - APP.