

STATE	PROJECT NO.	YEAR	SHEET NO.	TOTAL SHEETS
KANSAS	472 84614	.	164	534

PROJ. 54-87 KA-1164-01

- GRADING
- SURFACING
- CONCRETE PAVEMENT
- STORM SEWER
- SANITARY SEWER
- WATERLINE
- GUARDRAIL
- WALLS
- BRIDGES
- FENCING
- SIGNING

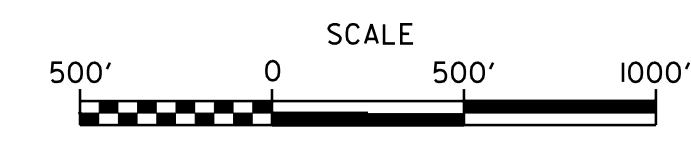

STATE OF KANSAS
DEPARTMENT OF TRANSPORTATION

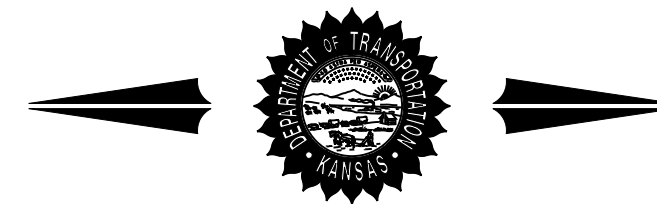

PLAN AND PROFILE OF PROPOSED
STATE HIGHWAY

CITY OF WICHITA
SEDGWICK COUNTY
US-54 (KELLOGG) 127TH TO 159TH

Sta. 660+15.49
Br. No.
46'-56'-46'
Continuous Prestressed Concrete
Beam Spans; Pile Bent Abutments & Column Bent Piers
1-60' & 1-68' Roadway, 17° Skew Lt.

Sta. 680+14.13
Br. No.
120'-130'-120'
Continuous Prestressed Concrete
Beam Spans; Pile Bent Abutments & Column Bent Piers
1-80' & 1-60' Roadway, 0° Skew

Sta. 2728+49.61 North Frontage Rd.
Br. No.
75'-85'-75'
Continuous Prestressed Concrete
Beam Spans; Pile Bent Abutments & Column Bent Piers
1-28' Roadway, 1-6' Sidewalk, 0° Skew

Sta. 2720+66.14 North Frontage Rd.
Br. No.
48'-64'-48'
Reinforced Concrete Haunched Slab Spans
Pile Bent Abutments & Column Bent Piers
1-28' Roadway, 1-6' Sidewalk, 20° Skew Rt.

Sta. 730+88.26
Br. No.
85'-90'-100'-100'-120'-122'-120'
Continuous Prestressed Concrete
Beam Spans; Pile Bent Abutments & Column Bent Piers
2-60' Roadways, 0° Skew

STA. 748+20 END
Proj. 472 84614

Sta. 746+72.83
Br. No.
20'x10'x559' RCB
60° Skew Rt.

Sta. 1731+61.25 South Frontage Rd.
Br. No.
75'-85'-75'
Continuous Prestressed Concrete
Beam Spans; Pile Bent Abutments & Column Bent Piers
1-64' Roadway, 1-6' Sidewalk, 0° Skew

Sta. 720+30.99
Br. No.
52'-65'-52'
Continuous Prestressed Concrete
Beam Spans; Pile Bent Abutments & Column Bent Piers
2-60' Roadways, 20° Skew Rt.

Sta. 1723+06.72 South Frontage Rd.
Br. No.
48'-64'-48'
Reinforced Concrete Haunched Slab Spans
Pile Bent Abutments & Column Bent Piers
1-40' Roadway, 1-6' Sidewalk, 20° Skew Rt.

Sta. 56+50.56, 21.00' Lt. 143rd St. East
Br. No.
42'-56'-42'
Reinforced Concrete Haunched Slab Spans
Pile Bent Abutments & Column Bent Piers
1-39' Roadway, 1-10' Sidewalk, 0° Skew

Sta. 56+50.56, 5.00' Rt. 143rd St. East
Br. No.
42'-56'-42'
Reinforced Concrete Haunched Slab Spans
Pile Bent Abutments & Column Bent Piers
1-37' Roadway, 1-6' Sidewalk, 0° Skew

Sta. 1663+61.08 South Frontage Rd.
Br. No.
42'-56'-42'
Reinforced Concrete Haunched Slab Spans
Pile Bent Abutments & Column Bent Piers
1-40' Roadway, 1-6' Sidewalk, 16°21'08" Skew Lt.

Sta. 1621+80.88 South Frontage Rd.
Br. No.
122'-122' Continuous Prestressed Concrete
Beam Spans; Pile Bent Abutments & Column Bent Piers
1-40' Roadway, 1-6' Sidewalk, 26°17'31" Skew Rt.

STA. 631+00 BEGIN
Proj. 472 84614 -
Sta. 631+00 END
Proj. 472 84615

Sta. 659+92.76, 74.00' Lt.
Br. No.
42'-56'-42'
Reinforced Concrete Haunched Slab Spans
Pile Bent Abutments & Column Bent Piers
1-50' Roadway, 17°04'36" Skew Lt.

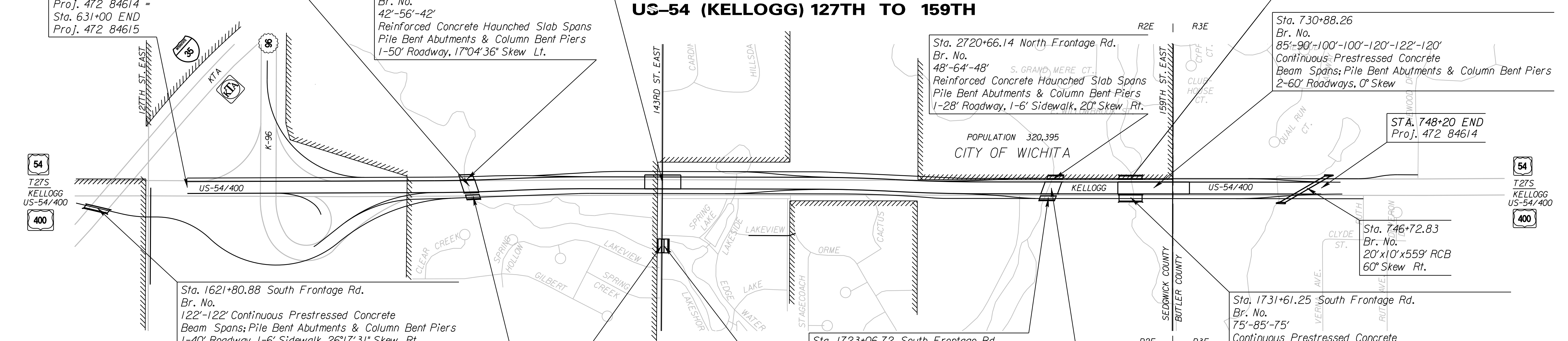

DESIGN DESIGNATION

- AADT (2010) = 31,100
- AADT (2040) = 99,900
- DHV = 7640 (EB&WB)
- D = 0.52 (EB)
- T = 8%
- V = 70 MPH (US-54)
- C of A = FULL
- Clear Zone = 34' (US-54), 6' from Back Curb (Fr. Rds. & Sideroads)

CONVENTIONAL SIGNS

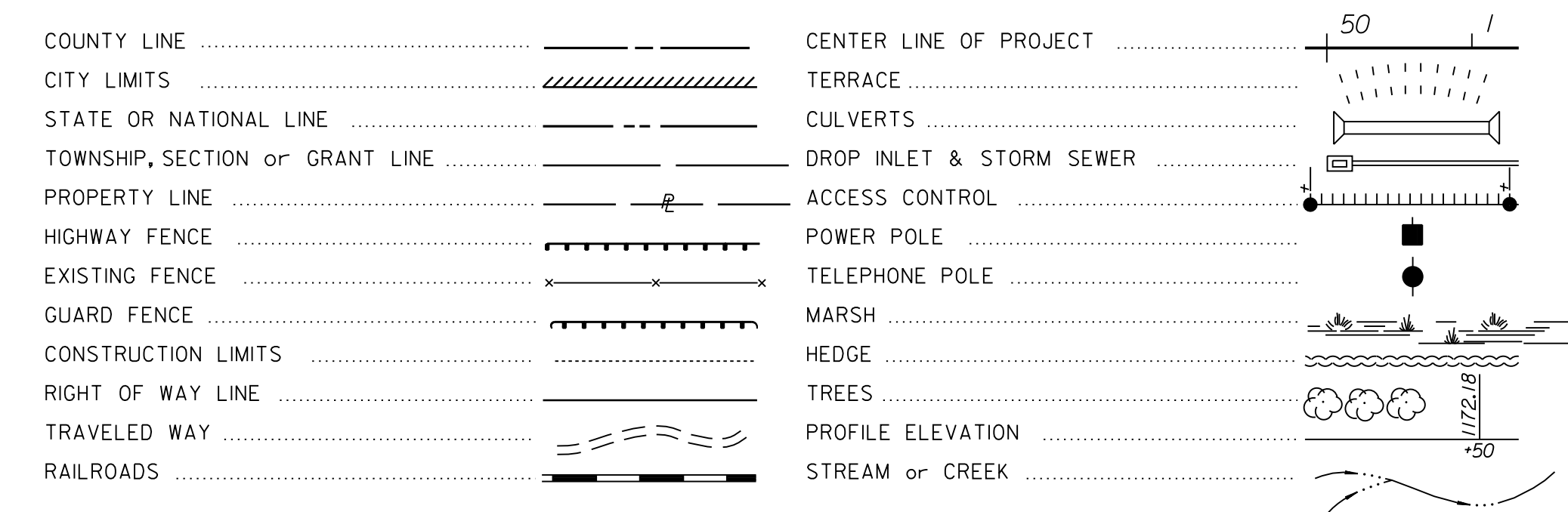

GROSS LENGTH OF PROJECT	11,720.00 FT.	
EXCEPTIONS	0.00 FT.	
ADDITIONS	0.00 FT.	
NET LENGTH OF PROJECT	11,720.00 FT.	2.220 MILES
NET LENGTH OF BRIDGES	1,436.33 FT.	0.272 MILES
NET LENGTH OF ROAD	10,283.67 FT.	1.948 MILES

NOTE:
Traffic for US-54 to be carried through construction.
See Sheet No's. 235 - 260 for Construction Sequence.

APPROVED - DATE
JIM ARMOUR, P.E., CITY ENGINEER
CITY OF WICHITA, KANSAS

DATE	BY

Drawn By: [Name]
File: T:\357666\Road\Sheets\General\K2\MLT\SH02.dgn