

STATE	PROJECT NO.	YEAR	SHEET NO.	TOTAL SHEETS
KANSAS	472 84614	.	193	534



Sta. 2720+66.14 Construct
Br. No. ()
48'-64'-48'
Reinforced Concrete Haunched Slab Spans;
Pile Bent Abutments and Column Bent Piers,
1-28' Roadway, 1-6' Sidewalk
20° Skew Rt.

Sta. 720+30.99 Construct
Br. No. ()
52'-65'-52'
Continuous Prestressed Concrete Beam Spans;
Pile Bent Abutments and Column Bent Piers,
2-60' Roadways, 20° Skew Rt.

Sta. 720+27.50 Remove
Exist. Bridges. See
Notes this sheet.

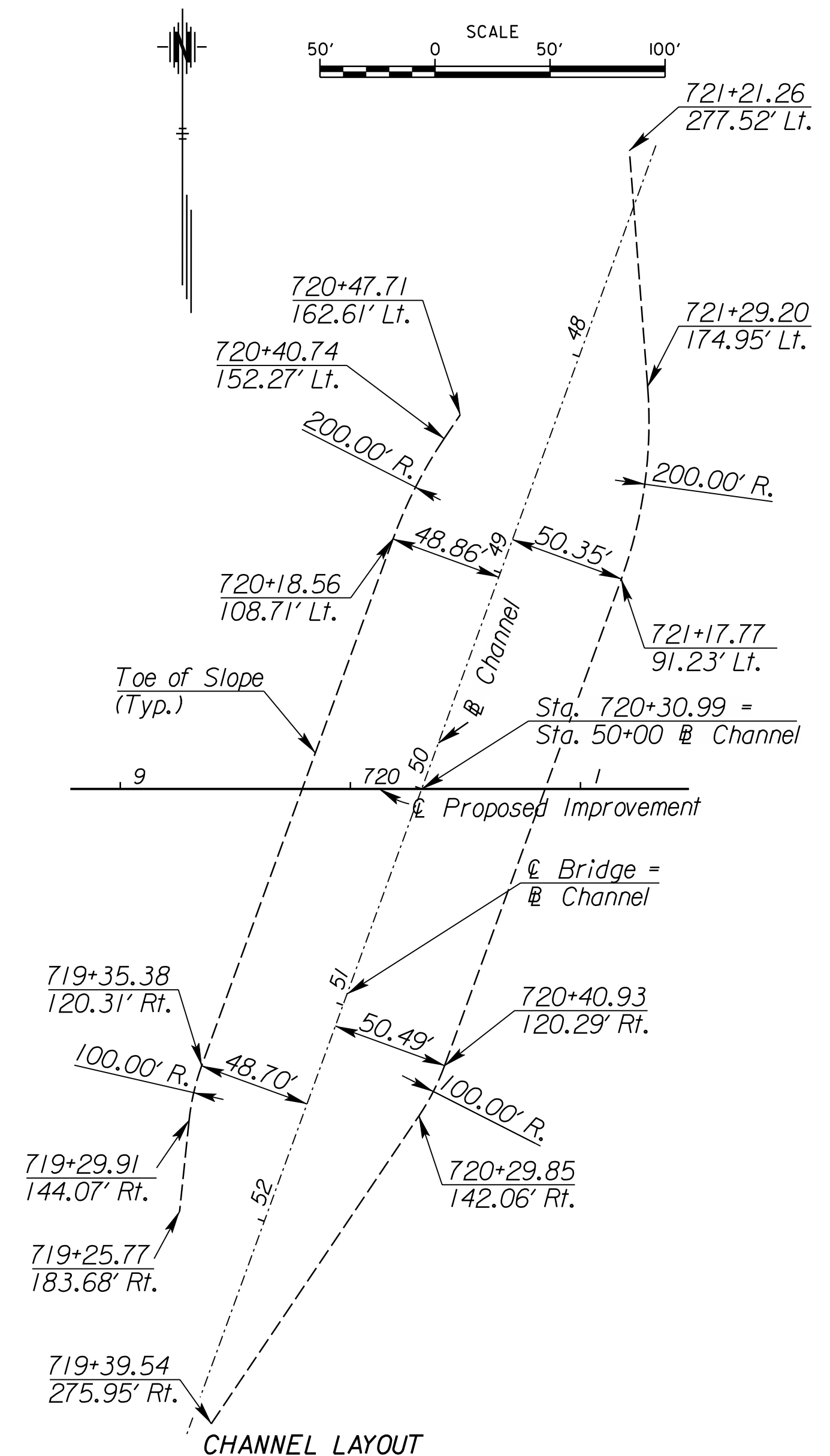
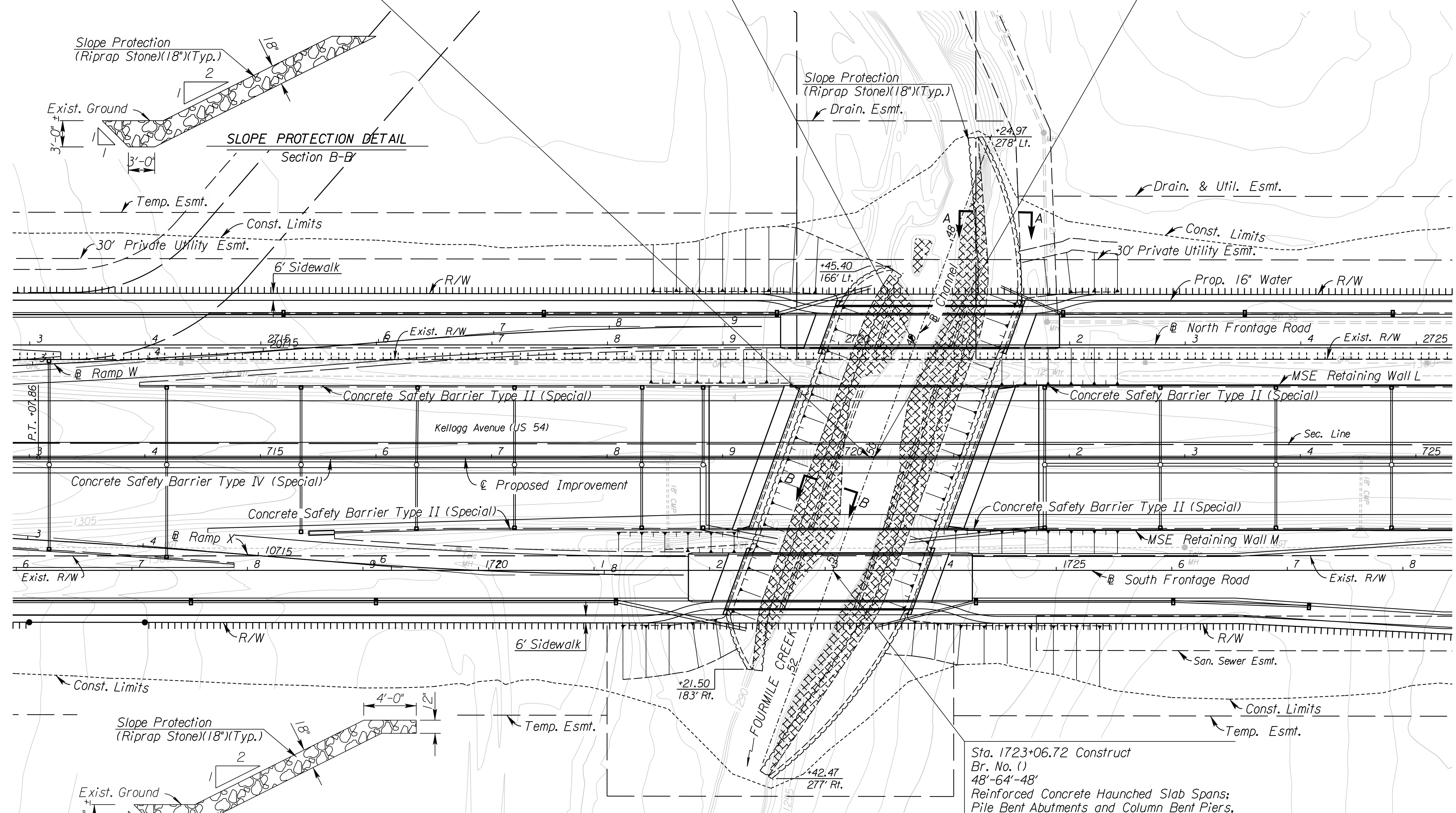

CHANNEL LAYOUT
(Stations/Offsets from \ominus Proposed Improvement)
REMOVAL OF EXISTING STRUCTURE
The Contractor shall remove the existing bridges (K.D.O.T. No. XXXXX) consisting of 2-41' Roadways, Haunched Slab Bridges.
All material removed shall become the property of the Contractor and shall be removed from the project site by the Contractor. Remove all portions of the substructure (pilings, footings, etc.) at least 3' below the existing streambed.
All labor and work is included in the bid item "Removal of Existing Structures", Lump Sum.

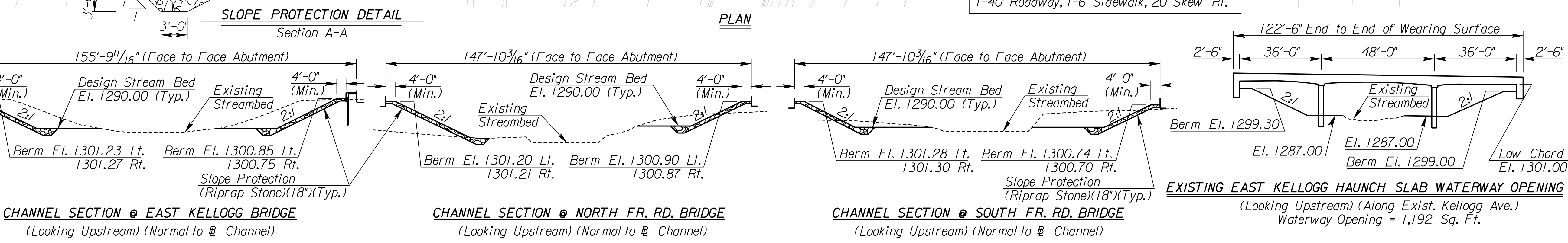

- UTILITIES**
- | | |
|-------------------|-----------------------|
| Cable | Cox Communications |
| Power | Westar |
| Sanitary Sewer | Wichita Water & Sewer |
| Storm Water Sewer | Wichita Water & Sewer |
| Telephone | AT&T |
| Water | Wichita Water & Sewer |
- See Sh. No's. 102-130 for SWS Plans.
See Sh. No's. 136-139 for San. Sewer Plans.
See Sh. No's. 140-162 for Water Plans.

CITY OF WICHITA
EAST KELLOGG AND FRONTAGE ROADS OVER
FOURMILE CREEK
CONTOUR MAP
BR. NO. STA. 2720+66.14
BR. NO. STA. 720+30.99
BR. NO. STA. 1723+06.72

I:\4106 AM
 2/9/2011
 T:\35766A\Cadd\Sheets\Structures\Bridge\4Mile\EK2FMCTM.dgn
 SURV. PLOT CADD DES. DR. TR. CKD. APP.