

STATE	PROJECT NO.	YEAR	SHEET NO.	TOTAL SHEETS
KANSAS	472 84614	.	204	534

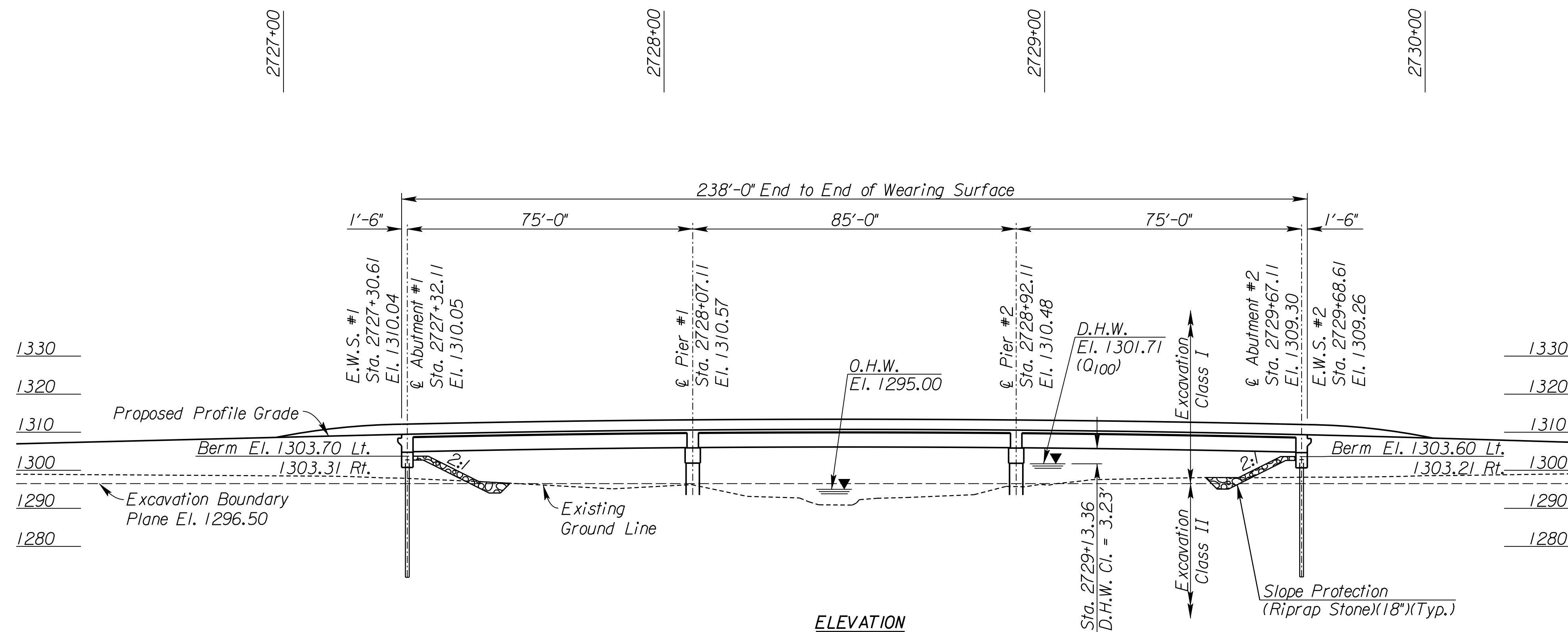

**DESIGN LOADING:**  
 HL-93

**UNIT STRESSES:**  
 Concrete  $f'_c = 4,000$  psi  
 Reinforcing Steel  $f_y = 60,000$  psi

75'-85'-75'  
 Continuous Prestressed Concrete Beam Spans;  
 Pile Bent Abutments & Column Bent Piers,  
 1-28' Roadway, 1-6' Sidewalk, 0° Skew

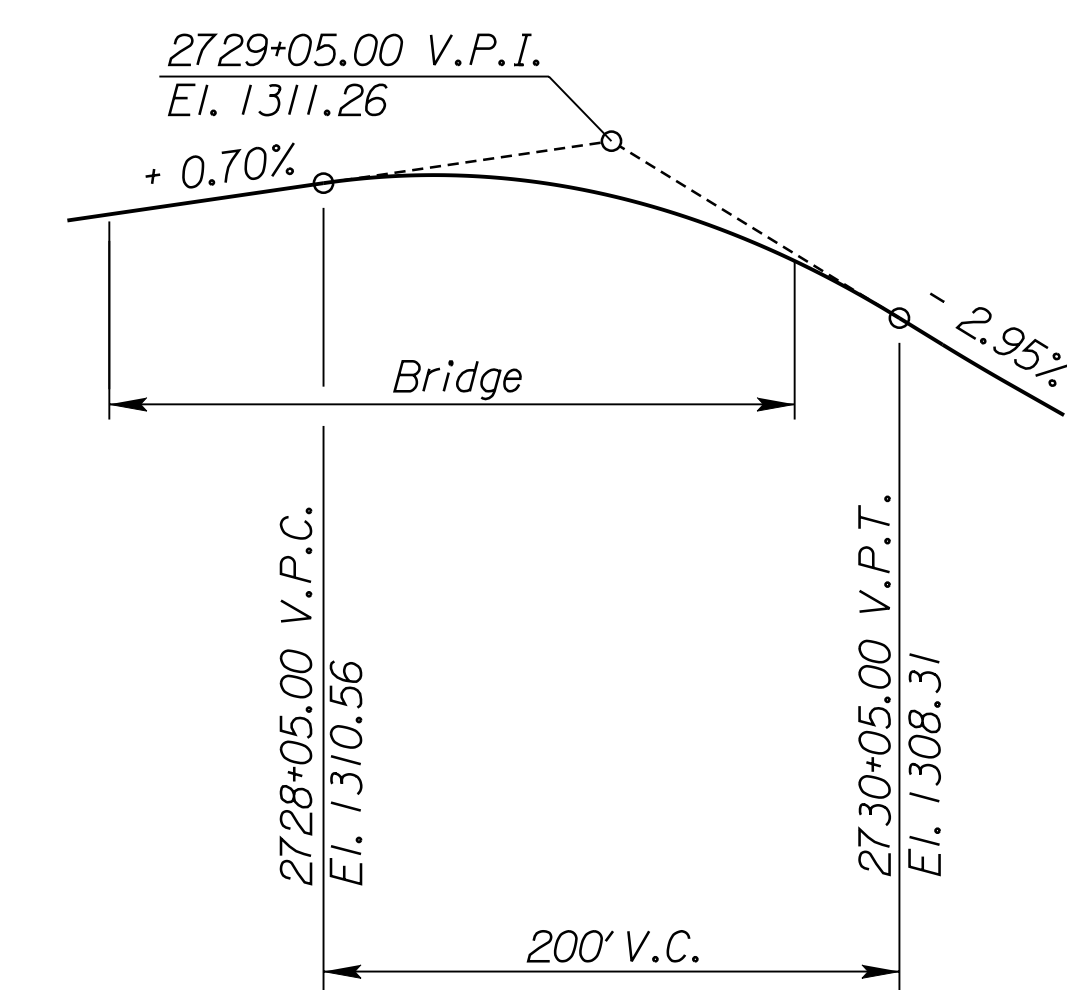

**VERTICAL PROFILE**

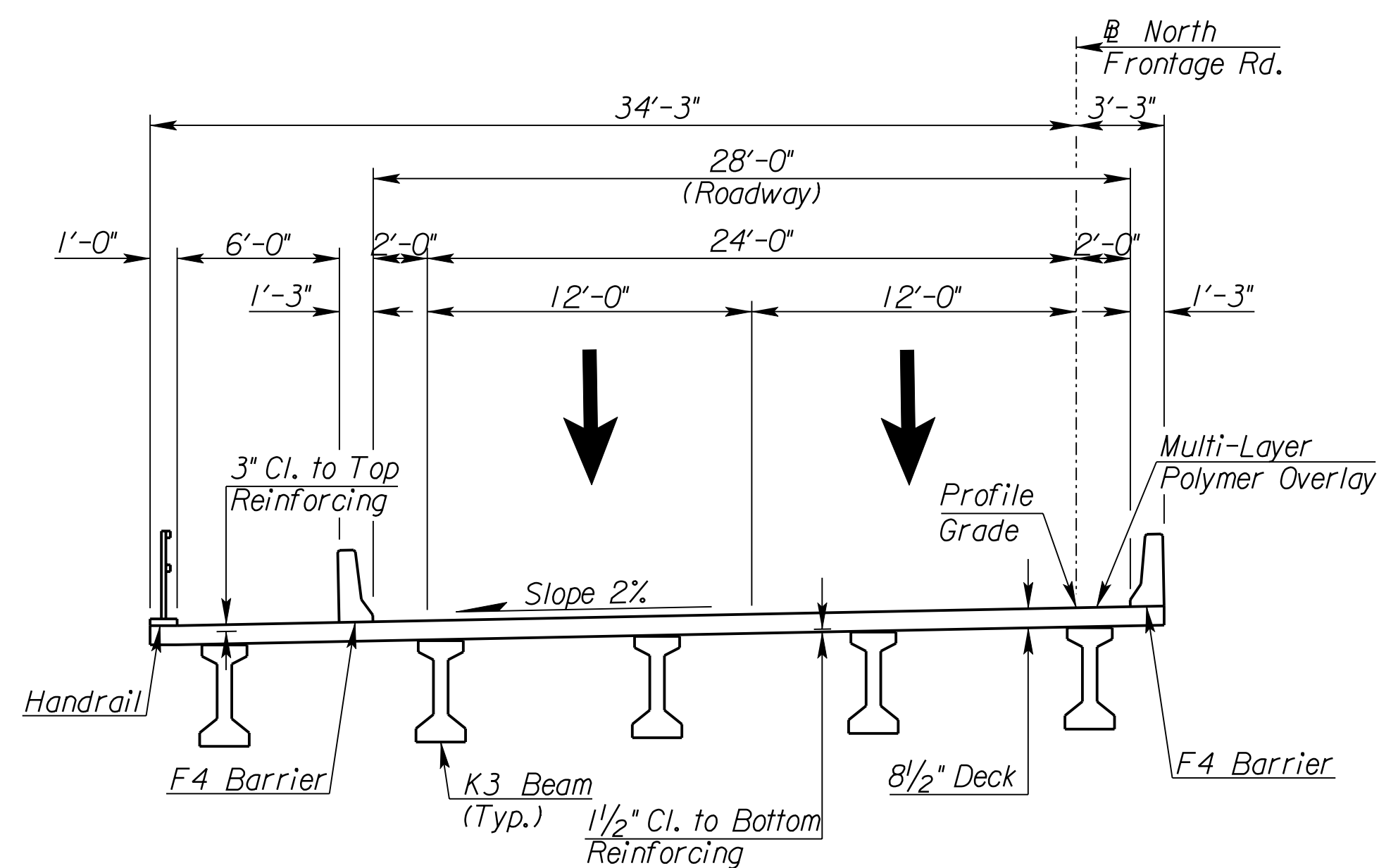

**NORTH FRONTAGE ROAD OVER BROOKHAVEN CREEK**  
 Proposed Section

CITY OF WICHITA  
 NORTH FRONTAGE ROAD OVER BROOKHAVEN CREEK  
 CONSTRUCTION LAYOUT II  
 BR. NO. STA. 2728+49.61