

**PLAZA HARDSCAPE AND
FENCING IMPROVEMENTS
BOTANICA - THE WICHITA GARDENS**

SIDEWALK POINT TABLE			
Point No.	Northing	Eastng	Description
1	1688761.749	1640810.122	PI
2	1688766.792	1640812.302	PI
3	1688762.587	1640853.335	PC
4	1688767.586	1640853.238	PC
5	1688787.582	1640852.851	RADIUS POINT
6	1688787.582	1640852.851	RADIUS POINT
7	1688787.693	1640886.300	PC
8	1688790.941	1640882.498	PC
9	1688770.725	1640871.313	PT
10	1688774.096	1640867.620	PT
11	1688781.198	1640893.903	RADIUS POINT
12	1688791.167	1640893.117	PT
13	1688795.577	1640889.631	PT
14	1688791.300	1640894.867	RAMP
15	1688791.698	1640899.852	RAMP
16	1688796.286	1640894.489	RAMP
17	1688796.684	1640899.473	RAMP
18	1688792.076	1640904.647	RAMP
19	1688797.101	1640904.265	RAMP
20	1688815.127	1640893.056	RAMP
21	1688815.718	1640898.025	RAMP
22	1688822.710	1640892.479	RAMP
23	1688823.221	1640897.455	RAMP
24	1688916.938	1640885.312	RADIUS POINT
25	1688843.090	1640944.276	PRC
66	1688868.819	1640813.731	PRC
67	1688852.959	1640776.455	RADIUS POINT
68	1688850.133	1640816.866	PT
69	1688815.970	1640815.290	BC
70	1688815.509	1640825.279	BC
71	1688849.672	1640826.856	PT
72	1688881.166	1640816.389	PC
73	1688889.189	1640794.578	MATCH EXIST.
74	1688883.995	1640797.637	PC
75	1688894.328	1640803.157	ME
76	1688937.117	1640833.685	RADIUS POINT
77	1688892.905	1640862.114	PRC
78	1688887.966	1640865.520	PRC
79	1688825.767	1640908.406	RADIUS POINT
80	1688900.948	1640915.870	PRC
81	1688906.919	1640916.463	PRC
82	1689011.384	1640926.834	RADIUS POINT
83	1688909.796	1640953.298	PT
84	1688904.064	1640955.094	PT
167	1688894.451	1640815.395	RADIUS POINT
168	1688875.983	1640806.252	PRC
169	1688860.490	1640798.583	RADIUS POINT
170	1688873.940	1640822.325	PRC

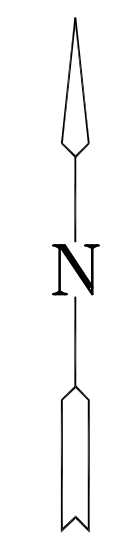
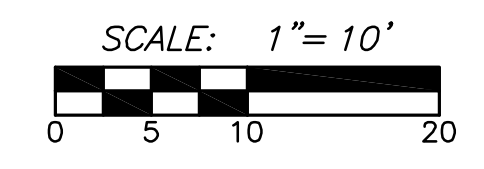
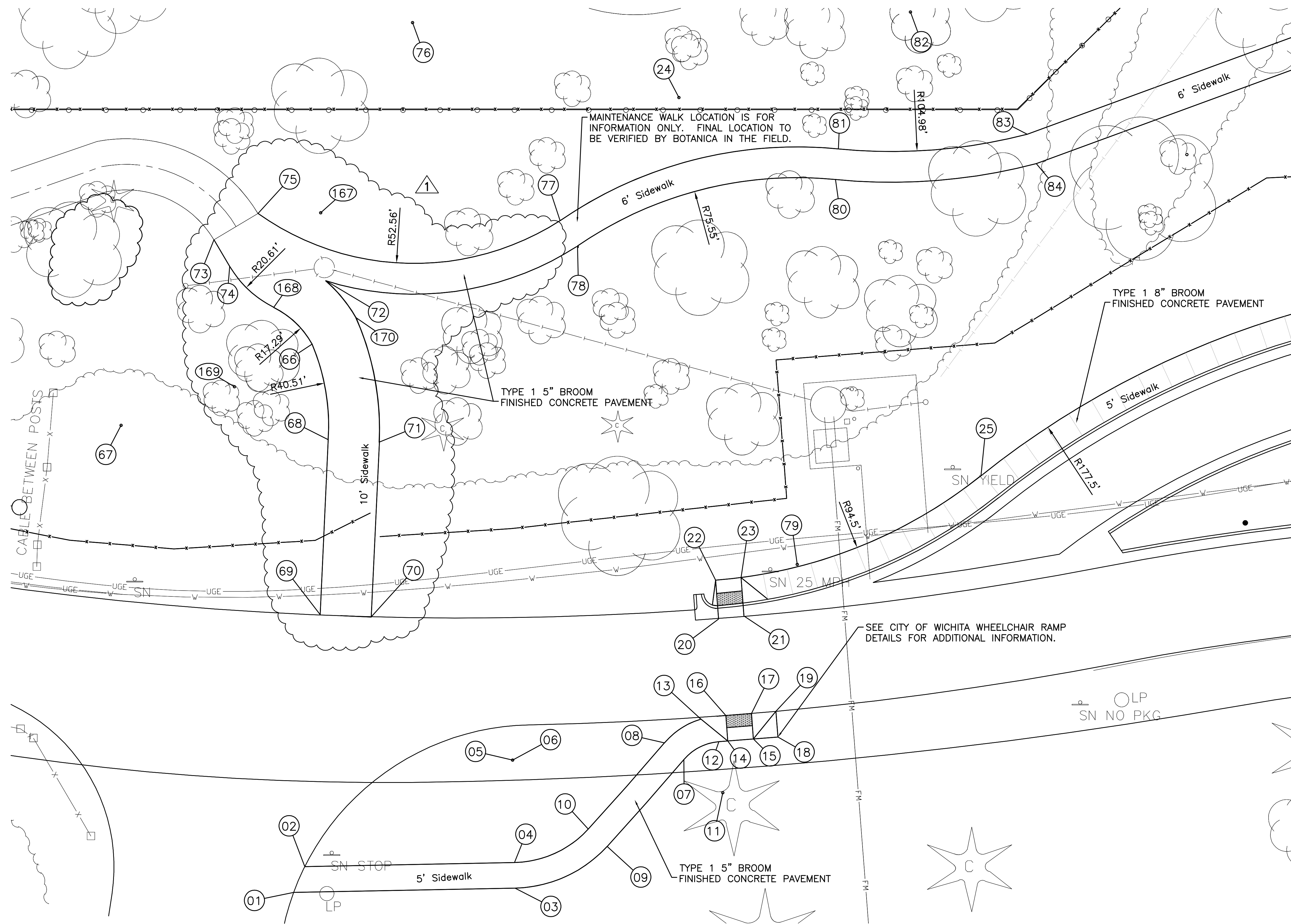

PLOT: 11/14/11, March 22, 2011 © 0114/11

F:\PROJECTS\2008\08603\CAD\CIVIL\CD\05\08603_EZAD.DWG

**SIDEWALK
DIMENSION
PLAN**
SHEET TITLE
472-84977
PROJECT NUMBER

DESIGN BY: **BJH**
DRAWN BY: **DG**
CHECKED BY: **JAG**

ISSUED: **MARCH 8, 2011**
REVISED: **MARCH 22, 2011**

SHEET NO.
6 of 21