

STATE	PROJECT NO.	YEAR	SHEET NO.	TOTAL SHEETS
KANSAS	87 N-0349-01	2009	1	133

STATE OF KANSAS  
DEPARTMENT OF TRANSPORTATION



PLAN AND PROFILE OF PROPOSED  
**17TH STREET**  
FROM GROVE TO HILLSIDE

FEDERAL AID PROJECT

WICHITA, SEDGWICK COUNTY, KANSAS

POPULATION = 335,562

CITY OF WICHITA PAVING PROJECT NO. 472-84766 (OCA# 706966)

CITY OF WICHITA SANITARY SEWER PROJECT NO. 468-84596 (OCA# 620543)

CITY OF WICHITA WATER PROJECT NO. 448-90432 (OCA# 636216)

INDEX OF SHEETS

SHEET NO	DESCRIPTION
1	TITLE SHEET
2	GENERAL NOTES
3-4	TYPICAL SECTIONS
5-13	PAVING PLAN AND PROFILES
14-17	PAVING BUBBLE MAPS
18-27	STORM SEWER PLAN AND PROFILE SHEETS
28-30	STORM SEWER BUBBLE MAPS
31-44	PAVING DETAILS
45-52	STORM SEWER DETAILS
53-54	RETAINING WALL DETAILS
55	MISCELLANEOUS DETAILS
56-59	WATER PLAN AND PROFILE SHEETS
60'	WATER BUBBLE MAPS
61-63	WATER DETAILS
64-66	SANITARY SEWER PLAN AND PROFILE SHEETS
67-68	SUMMARY OF QUANTITIES
69-75	EROSION CONTROL
76-79	ROADSIDE IMPROVEMENT PLANS
80-86	TRAFFIC SIGNAL PLANS
87-91	PAVEMENT MARKING AND SIGNING PLANS
92	CONSTRUCTION SEQUENCE SUMMARY
93-106	TRAFFIC CONTROL PLAN
107	DRAINAGE MAP
108-133	CROSS SECTIONS

GRADING AND SURFACING  
STORM SEWER  
PAVEMENT MARKING  
SEEDING

SCALE: 1" = 150'

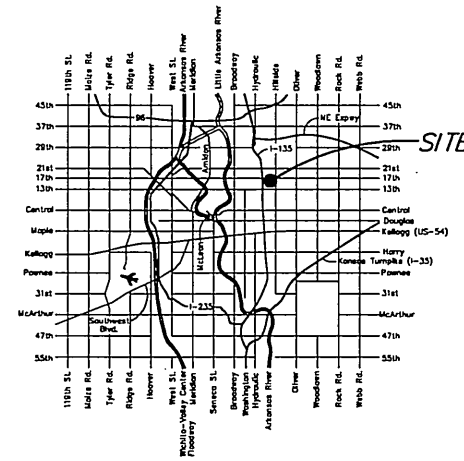

LOCATION MAP

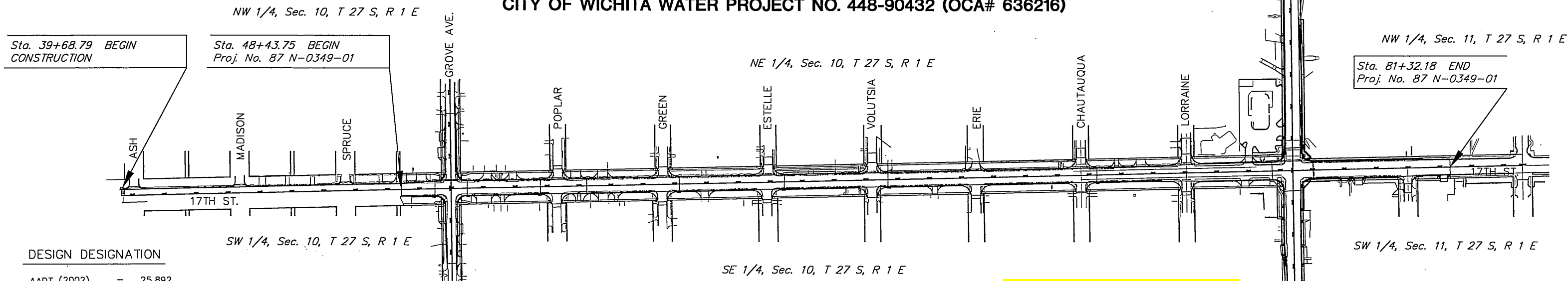

DESIGN DESIGNATION

AADT (2002)	=	25,892
AADT (2030)	=	31,000
DHV	=	10 %
D	=	60 %
T	=	3 %
V	=	35 M.P.H.
Control of Access	=	NONE
Clear Zone	=	6 FT.

CORNEJO & SONS/W B CARTER - CONTRACTOR  
J. WAGNER - FIELD PROJECT ENGINEER, CITY OF WICHITA  
J. JASO & J. SMITH - INSPECTORS, CITY OF WICHITA  
AS-BUILT  
RELEASE DATE: 3/26/2011  
:PDF APRosas 3/25/2011

NOTE:  
TWO WAY TRAFFIC TO BE CARRIED  
THROUGH CONSTRUCTION. LOCAL  
TRAFFIC WILL BE PERMITTED TO  
ADJACENT PROPERTIES.

CONVENTIONAL SIGNS

COUNTY LINE	-----	CENTER LINE OF PROJECT	-----
CITY LIMITS	-----	TERRACE	-----
STATE OR NATIONAL LINE	-----	CULVERTS	-----
TOWNSHIP, SECTION or GRANT LINE	-----	DROP INLET & STORM SEWER	-----
PROPERTY LINE	-----	ACCESS CONTROL	-----
HIGHWAY FENCE	-----	POWER POLE	-----
EXISTING FENCE	-----	TELEPHONE POLE	-----
GUARD FENCE	-----	MARSH	-----
CONSTRUCTION LIMITS	-----	HEDGE	-----
RIGHT OF WAY LINE	-----	TREES	-----
TRAVELED WAY	-----	PROFILE ELEVATION	-----
RAILROADS	-----	STREAM or CREEK	-----

GROSS LENGTH OF PROJECT	5,137.73 FT.	
EXCEPTIONS		
ADDITIONS		
NET LENGTH OF PROJECT	5,137.73 FT.	0.97 MILES
NET LENGTH OF BRIDGES	76.86 FT.	0.01 MILES
NET LENGTH OF ROAD	5,060.87 FT.	0.96 MILES

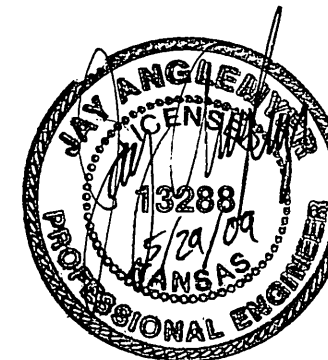

PREPARED & SUBMITTED BY  
MKEC ENGINEERING CONSULTANTS, INC.  
WICHITA, KANSAS

APPROVED - DATE  
  
JIM ARMOUR, P.E.  
CITY ENGINEER