

Plotted By: svb Date: 1/24/2011 6:05:00 PM  
 FILE: I:\2008\08208\Traffic Control\08208-TC Stage 2 Frontage Rd (I).dgn

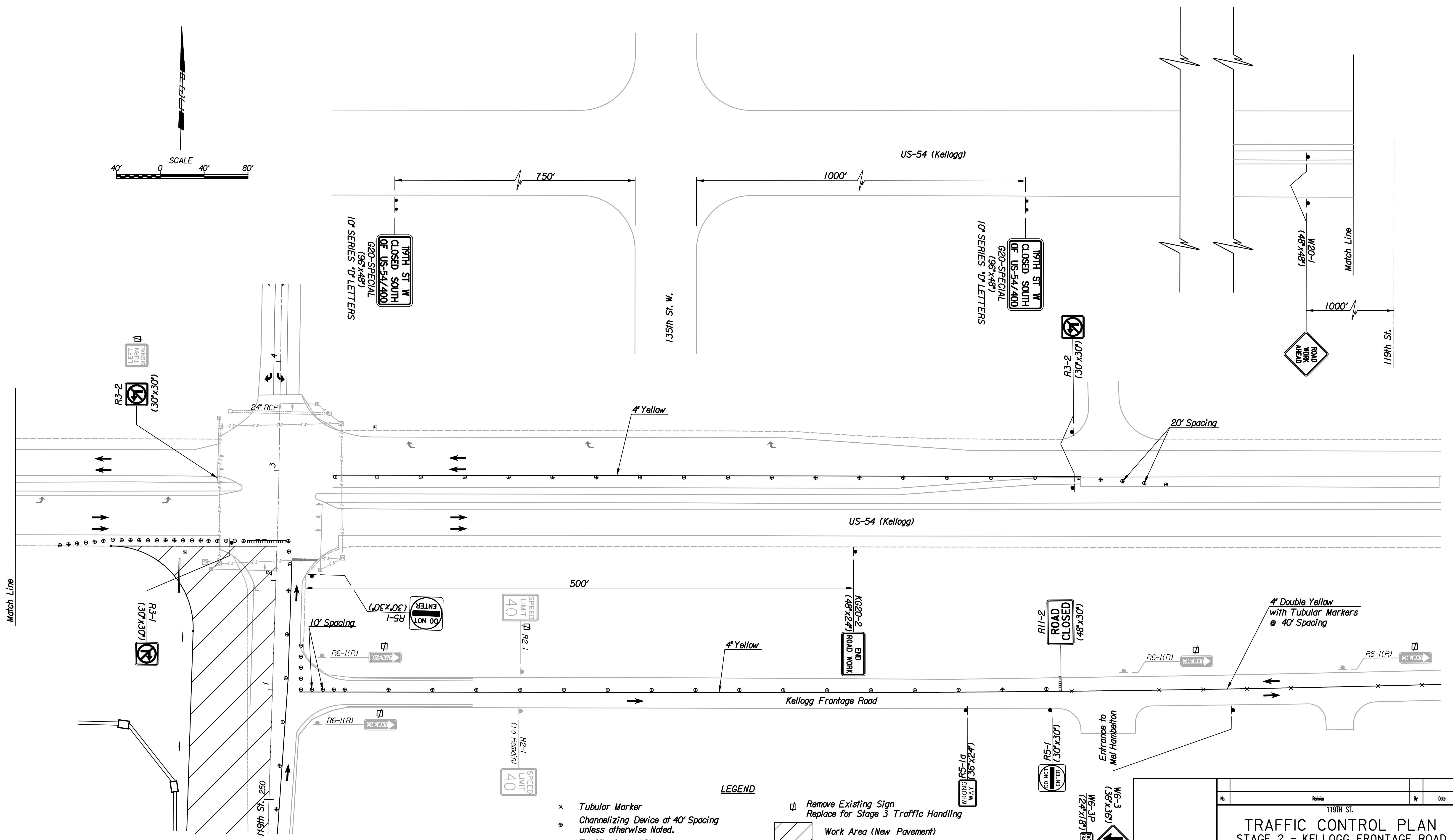
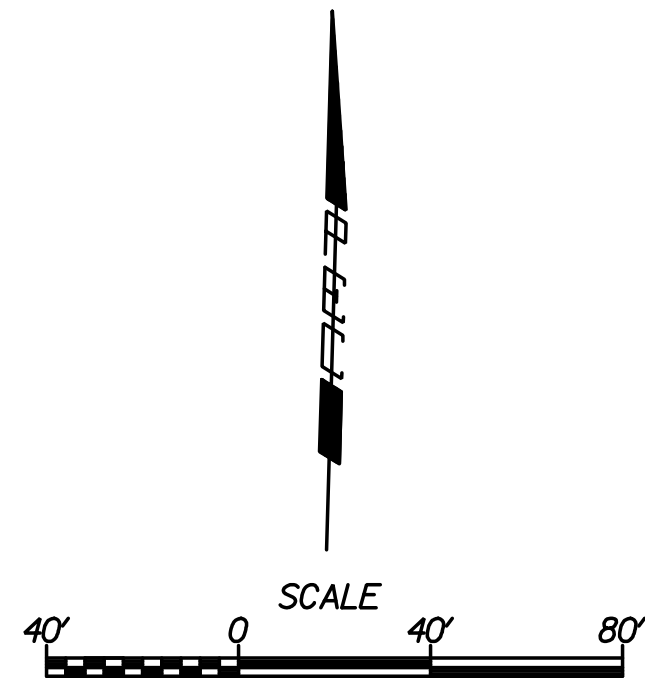

Note: Utilities are not shown on Traffic Control Plans. The Contractor is responsible for verification as to type and location of underground utilities as may be necessary to avoid damage thereto. The Contractor is responsible for repairing any damage to underground utilities.

- LEGEND**
- × Tubular Marker
  - Channelizing Device at 40' Spacing unless otherwise Noted.
  - Traffic Control Sign
  - TTTTT Type III Barricades
  - ☐ Remove Existing Sign  
Replace for Stage 3 Traffic Handling
  - ▨ Work Area (New Pavement)
  - Direction of Traffic

Note: Signs and barricades are shown diagrammatically only. Contractor will be responsible to install the required number of posts to support the installation.

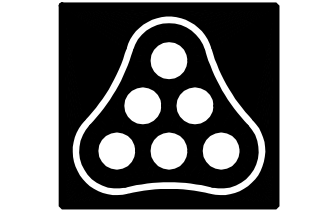

No.	Revision	By	Date
119TH ST.			
<b>TRAFFIC CONTROL PLAN</b>			
<b>STAGE 2 - KELLOGG FRONTAGE ROAD</b>			
JAMES L. ARMOUR, P.E. - CITY ENGINEER CITY OF WICHITA PROJECT NO. 472-84694			
<b>Professional Engineering Consultants, P.A.</b>			
303 S. TOPEKA - WICHITA, KANSAS 67202 316-262-2691 • FAX 316-262-3003			
Designed by	JPS	Job No.	08208
Drawn by	SVB	Date	Sept., 2010
			Sht. 98 of 149