

Walden Gardens

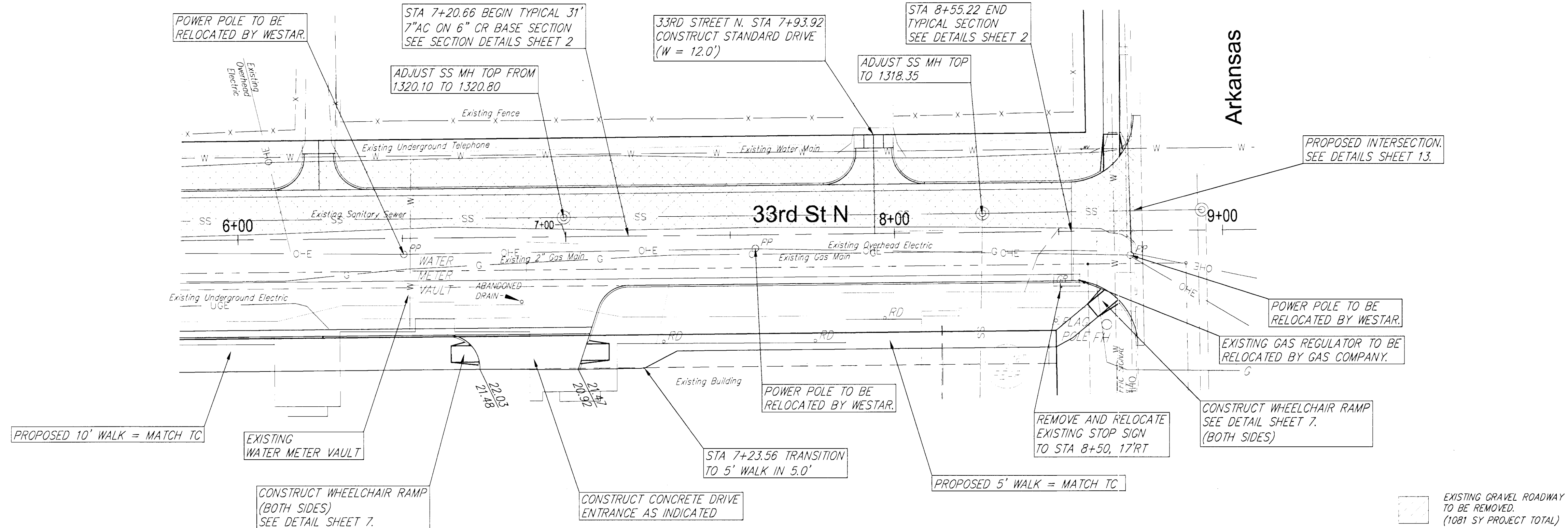

North Elementary School Addition

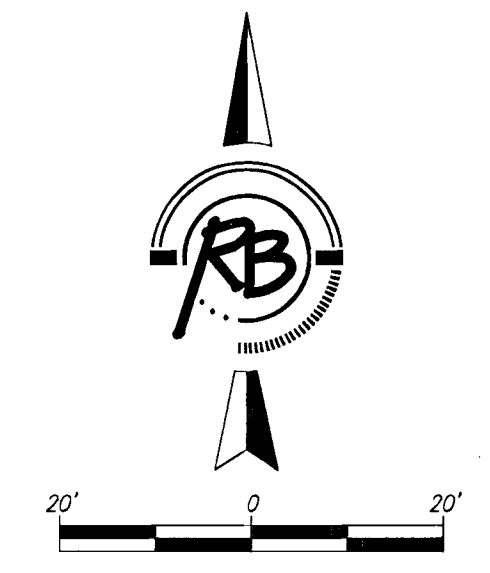

EXISTING GRAVEL ROADWAY TO BE REMOVED. (1081 SY PROJECT TOTAL)

EXISTING ASPHALT PAVEMENT TO BE REMOVED. (1732 SY PROJECT TOTAL)

Ruggles & Bohm, P.A.
 Professional Engineer
 License No. 000000000
 State of Kansas
 1000 West 10th Street
 Wichita, Kansas 67202
 Phone: 316-261-1111
 Fax: 316-261-1112
 www.rugglesandbohm.com

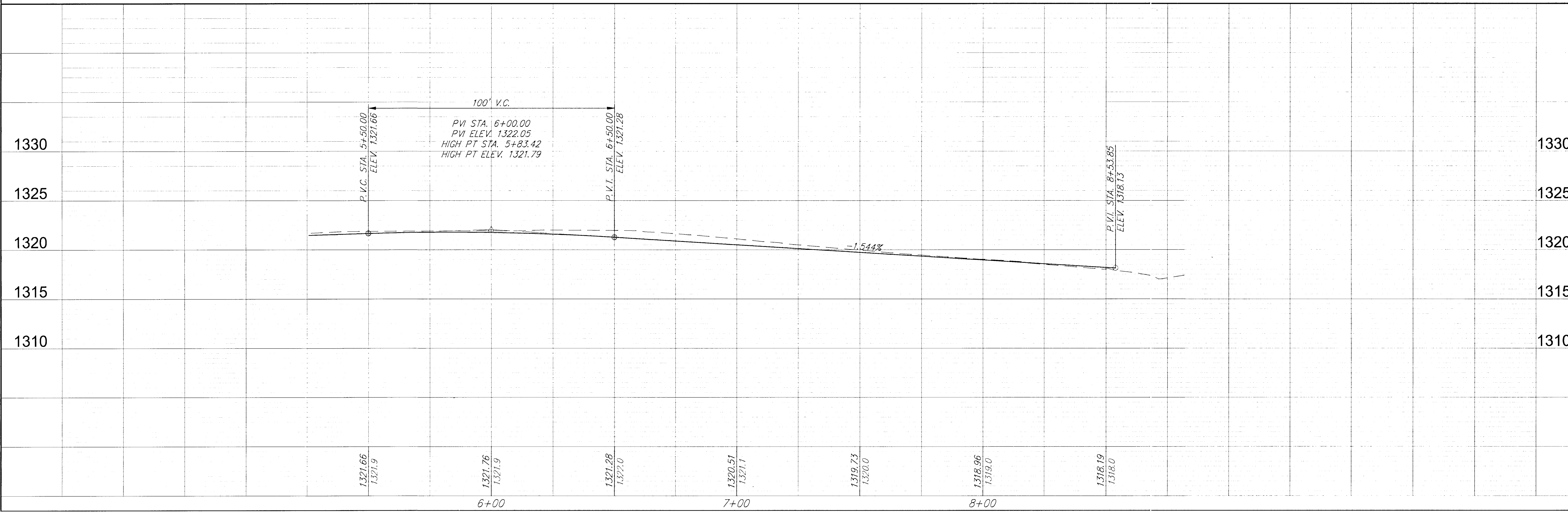

PAVING IMPROVEMENTS
33rd Street North
WICHITA, KANSAS

PROJECT NUMBER: 472-84901
 DRAWING FILE: ENGINEERING BASE (33RD P-P)
 DESIGN: EJC
 CHECK: EJC
 DATE: JUNE 4, 2010
 REVIEW: EJC
 DATE: JUNE 4, 2010

1330
1325
1320
1315
1310

1330
1325
1320
1315
1310

1321.66
1321.9
1321.76
1321.9
1321.28
1321.0
1320.51
1321.1
1319.73
1320.0
1318.96
1319.0
1318.19
1318.0

6+00 7+00 8+00

10
30