

**NOTES**

1. THE CONTRACTOR SHALL GRADE THE DITCH TO MAINTAIN POSITIVE DRAINAGE. ALL COSTS SHALL BE SUBSIDIARY TO OTHER BID ITEMS.
2. THE CULVERT PIPES SHALL BE REMOVED AND REPLACED AS NECESSARY TO FACILITATE CONSTRUCTION OF THE WATER LINE PROJECT. IF IN THE OPINION OF THE AREA ENGINEER THAT A CULVERT PIPE CAN BE REUSED, THE EXISTING CULVERT PIPE SHALL BE CLEANED OUT AND RESET. IF REPLACEMENT OF THE CULVERT PIPE IS REQUIRED, THE CULVERT PIPE SHALL BE OF THE SAME GAUGE AS REQUIRED FOR CITY OF WICHITA PAVING PROJECTS. COSTS FOR SUCH REMOVAL AND REPLACEMENT SHALL BE CONSIDERED SUBSIDIARY TO THE SITE RESTORATION BID ITEM AND NOT BE BID OR PAID FOR SEPARATELY.

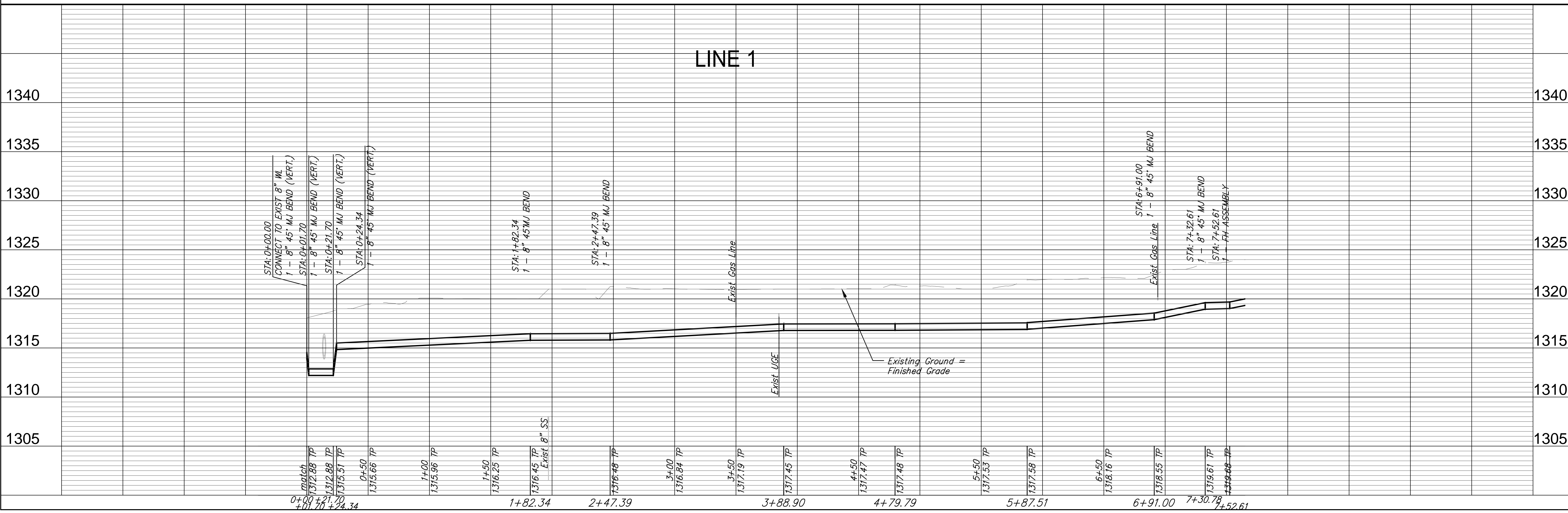

REVISIONS

REVISION	DATE	BY
REVIEW	Apr. 20, 2011	AML

DESIGN: AML  
 DRAWN: AML  
 PROJECT NUMBER: 448-90500  
 UTILITY: WATER  
 DRAWING FILE: engineeringbase\03 Line 1  
 Ruggles & Bolm, P.A.  
 Engineering, Surveying, Land Planning  
 924 North Main Street, Suite 200  
 Wichita, Kansas 67203  
 Phone: 316-261-4444  
 Email: info@ruggles.com

WATER LINE IMPROVEMENTS  
 MCEVOY ADDITION  
 WICHITA, KANSAS

RB JOB: 3752W  
 SHEET: 3 OF 15