

Point Table			
Point #	Northing	Easting	Description
100	1699517.20	1691576.91	COR
101	1699528.99	1692044.81	COR
102	1699568.81	1692044.21	COR
103	1699583.92	1692644.02	COR
104	1699010.63	1692652.49	COR
105	1698995.86	1692052.81	COR
106	1699157.01	1692050.40	COR
107	1699145.22	1691582.49	COR
108	1699368.70	1691579.14	COR
109	1699369.96	1691629.12	COR
110	1699367.32	1691683.25	COR
111	1699375.83	1692021.09	COR
112	1699332.28	1692163.40	COR
113	1699323.56	1692175.63	COR

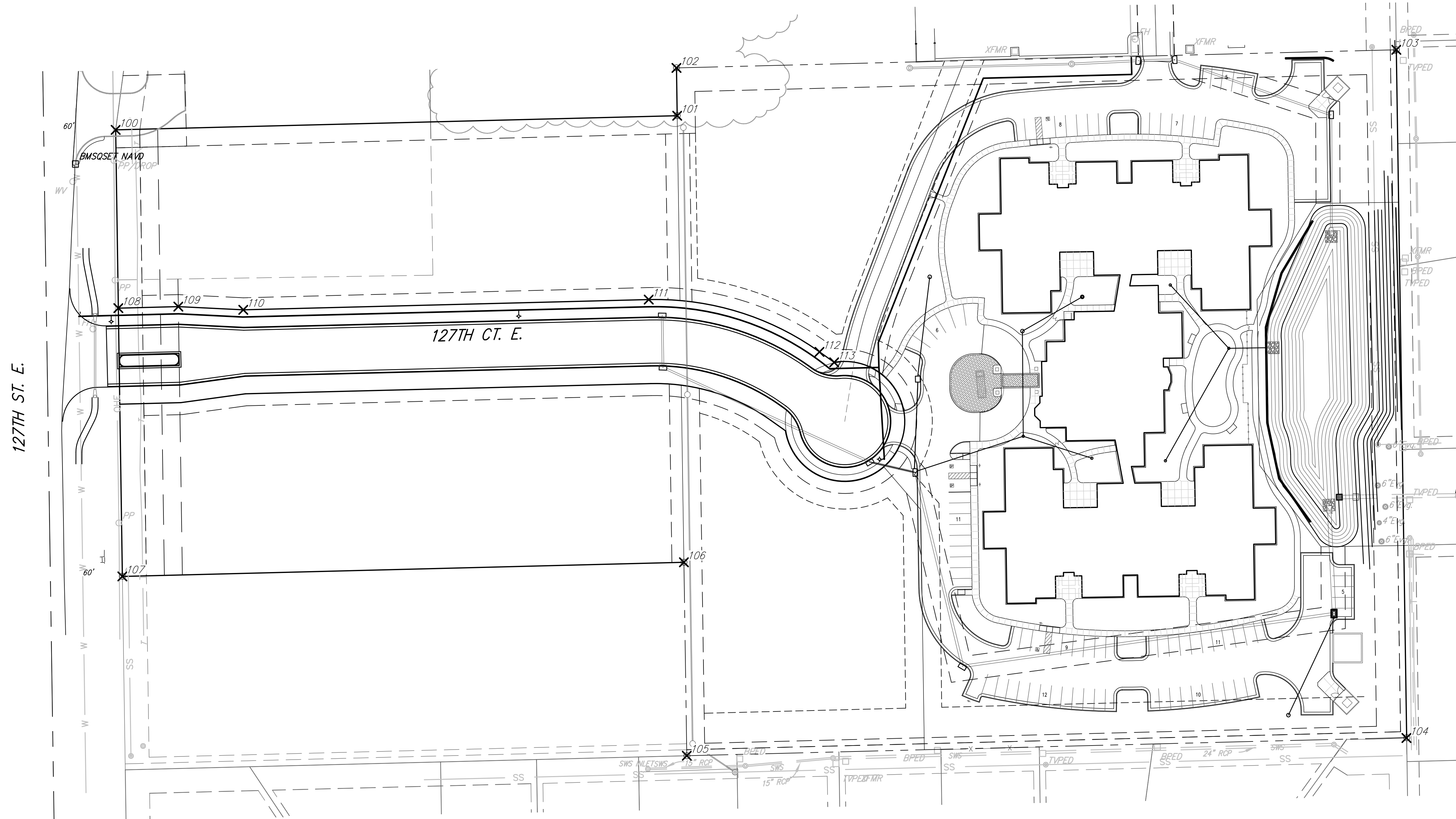

REEDS COVE MEDICAL CAMPUS
Coordinate Map
WICHITA, KANSAS

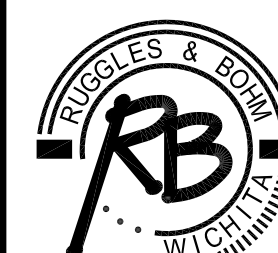

Ruggles & Bohm, F.A.
Engineering, Surveying, Land Planning
924 North Main
Wichita, Kansas 67203
www.rbkansas.com
(316) 264-8008
(316) 264-4621 fax
E-mail: info@rbkansas.com

DESIGN	KWL
DRAWN	RA
REVIEW	
UTILITY	
DATE	
PROJECT NUMBER	
DRAWING FILE	Water Details [Coordinate Sheet]

RES. JOB
3743E
SHEET
10
OF
11